



BK 0850 PG 223



MISC 1988 08594

THIS PAGE INCLUDED FOR
INDEXING
PAGE DOWN FOR BALANCE OF INSTRUMENT

1402-16 ✓

AMENDMENT TO MASTER DEED

This is an amendment to the Master Deed and Declaration made the 27th day of December, 1983 by Twin Towers Limited Partnership, a Nebraska limited partnership, its successors and assigns, including Midwest Granite, Inc., doing business as Twin Towers Development Company, an Iowa corporation.

WHEREAS, the Master Deed provides for and contemplates the right to subdivide and combine units and the right to construct connecting doors and hallways between abutting units and to thereby combine apartment units subject to approval of any such activity by the Association Board, and,

WHEREAS, the Association Board has approved the combining and reconfiguration in part of units S6A, S6B and S6R into new units S6A and S6R provided the resulting units bear pro rata the percentage of basic value assigned to the original space.

NOW, THEREFORE, the Master Deed is deemed amended in the following manner.

1. Units S6A, S6B, and S6R shall be deemed reconfigured and relabeled as units S6A and S6R as shown on Exhibit "A" and attached hereto and incorporated by reference.

2. The resulting basic value of each apartment, the percentage share and the expenses and rights in the common elements as well as the votes each unit is entitled to are also shown and depicted on Exhibit "B" attached hereto and incorporated by reference.

AGREED to this 18th day of May, 1988.

8594
Mead

RECEIVED
1988 MAY 27 PM 12:30
GEORGE J. LEBLANCZ
REGISTER OF DEEDS
DOUGLAS COUNTY, NEBR.

OWNERS OF UNITS S6A, S6B and S6R IN THE TWIN TOWERS CONDOMINIUM, PURSUANT TO A MASTER DEED AND DECLARATION MADE THE 27th DAY OF DECEMBER, 1983, AS AMENDED

By: N. Michael Cutler

MIDWEST GRANITE, INC., an Iowa corporation, d/b/a TWIN TOWERS DEVELOPMENT COMPANY

BK 850 N 89-73 C/O _____ FEE 100.00 By: N. Michael Cutler
PG 223-228 N _____ DEL 1/2 MG MC President
OF Mead COMP CT FIB 16-39391

CERTIFICATION

The undersigned is the secretary of the Twin Towers Condominium Association, a Nebraska nonprofit corporation and certifies that the foregoing Amendment to the Master Deed has been authorized and approved by the Association Board.

By: Betty P. Cutler
Secretary

STATE OF NEBRASKA)
) SS.
COUNTY OF DOUGLAS)

The foregoing Amendment to Master Deed was acknowledged before me this 24 day of May, 1988 by Betty F. Cutler, Secretary of ^{Twin Towers} and H. Michael Cutler, ~~President of Midwest Granite, Inc.~~ ^{the Condominium Association}, the voluntary act and deed of the same, as such, on behalf of said corporations.

Linda M. Lowe
Notary Public

My Commission Expires:

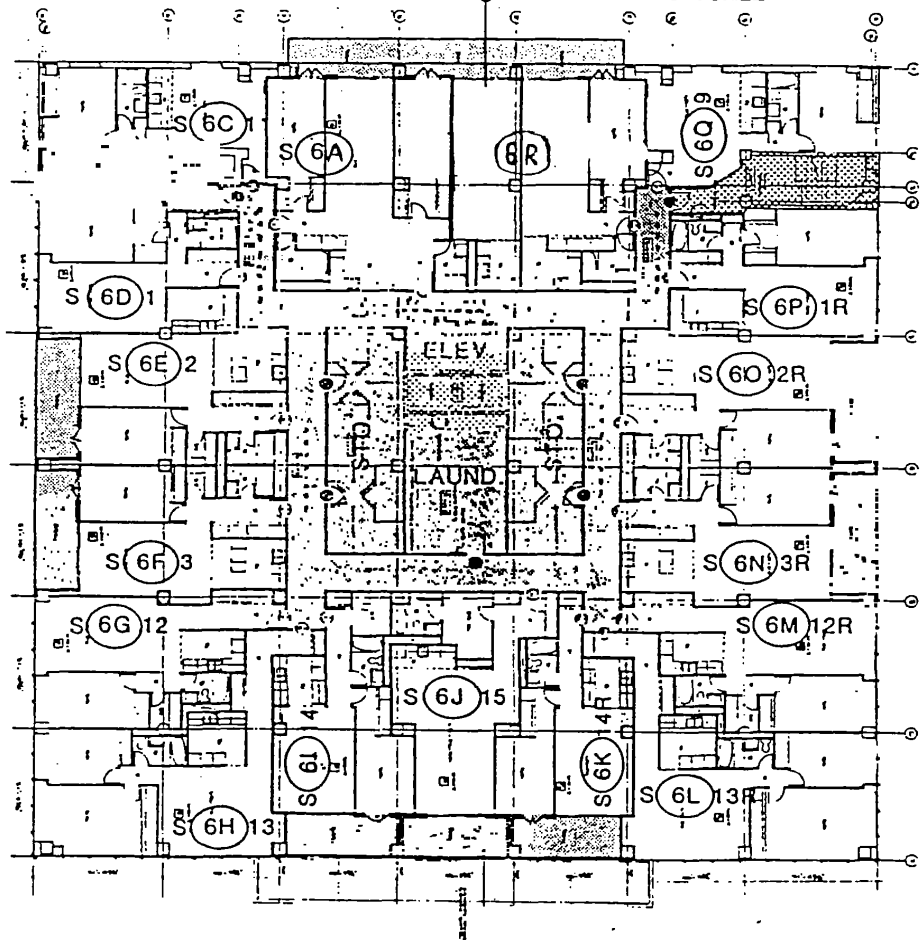

EXHIBIT "A"

TWIN TOWERS CONDOMINIUM

PROPERTY REGIME

BUILDING S
6TH FLOOR



TYPICAL UNIT DESIGNATION

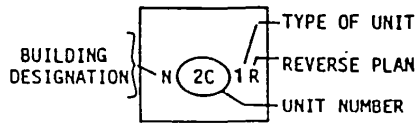

LEGEND

- Apartment Unit Number
- Limited Common Elements
- General Common Elements

The total basic value of the entire Condominium Regime is \$734,045; and the basic value of each apartment in the Condominium Regime; the percentage which each apartment shall share in the expenses of, and the rights in, common elements; the votes each unit owner(s) is entitled to; and the approximate square feet of each apartment in The Twin Tower Condominium Association, Inc., are as follows:

| APARTMENT UNIT NO. | UNIT TYPE | BASIC VALUE | PERCENT | VOTES | APPRO SQ.FT |
|-----------------------|--------------|----------------|---------|-------|----------------|
| SBA | COMM | 1720 | 0.23 | 23 | 860 |
| SBC | COMM | 4960 | 0.68 | 68 | 2480 |
| SCB | COMM | 14060 | 1.92 | 192 | 7030 |
| S1A | COMM | 2678 | 0.36 | 36 | 595 |
| S1B | COMM | 27000 | 3.68 | 368 | 6000 |
| S1C | COMM | 21150 | 2.88 | 288 | 4700 |
| S1D | COMM | 4635 | 0.63 | 63 | 1030 |
| S2A | 8 | 4485 | 0.61 | 61 | 690 |
| S2B | 10 | 4290 | 0.59 | 59 | 660 |
| S2C | 11 | 3445 | 0.47 | 47 | 530 |
| S2D | 1 | 4583 | 0.62 | 62 | 705 |
| S2E | 2 | 4583 | 0.62 | 62 | 705 |
| S2F | 3 | 4583 | 0.62 | 62 | 705 |
| S2G | 4 | 4453 | 0.61 | 61 | 685 |
| S2H | 5 | 6045 | 0.82 | 82 | 930 |
| S2I | 6 | 4095 | 0.56 | 56 | 630 |
| S2J | 7 | 4615 | 0.63 | 63 | 710 |
| S2K | 6R | 4095 | 0.56 | 56 | 630 |
| S2L | 5R | 6045 | 0.82 | 82 | 930 |
| S2M | 4R | 4453 | 0.61 | 61 | 685 |
| S2N | 3R | 4583 | 0.62 | 62 | 705 |
| S2O | 2R | 4583 | 0.62 | 62 | 705 |
| S2P | 1R | 4583 | 0.62 | 62 | 705 |
| S2Q | 9 | 3575 | 0.49 | 49 | 550 |
| S2R | 10R | 4290 | 0.59 | 59 | 660 |
| S3A | 8 | 4160 | 0.57 | 57 | 640 |
| S3B | 10 | 4290 | 0.58 | 58 | 660 |
| S3C | 11 | 3445 | 0.47 | 47 | 530 |
| S3D | 1 | 4583 | 0.62 | 62 | 705 |
| S3E | 2 | 4583 | 0.62 | 62 | 705 |
| S3F | 3 | 4583 | 0.62 | 62 | 705 |
| S3G | 4 | 4453 | 0.61 | 61 | 685 |
| S3H | 5 | 6045 | 0.82 | 82 | 930 |
| S3I | 6 | 4095 | 0.56 | 56 | 630 |
| S3J | 7 | 4615 | 0.63 | 63 | 710 |
| S3K | 6R | 4095 | 0.56 | 56 | 630 |
| S3L | 5R | 6045 | 0.82 | 82 | 930 |
| S3M | 4R | 4453 | 0.61 | 61 | 685 |
| S3N | 3R | 4583 | 0.62 | 62 | 705 |
| S3O | 2R | 4583 | 0.62 | 62 | 705 |
| S3P | 1R | 4583 | 0.62 | 62 | 705 |
| S3Q | 9 | 3575 | 0.49 | 49 | 550 |
| S3R | 10R | 4290 | 0.59 | 59 | 660 |
| S4A | 8 | 4485 | 0.61 | 61 | 690 |
| S4B | 10 | 4290 | 0.59 | 59 | 660 |
| S4C | 11 | 3445 | 0.47 | 47 | 530 |
| S4D | 1 | 4583 | 0.62 | 62 | 705 |
| S4E | 2 | 4583 | 0.62 | 62 | 705 |
| S4F | 3 | 4583 | 0.62 | 62 | 705 |
| S4G | 4 | 4453 | 0.61 | 61 | 685 |
| S4H | 5 | 6045 | 0.82 | 82 | 930 |
| S4I | 6 | 4095 | 0.56 | 56 | 630 |
| S4J | 7 | 4615 | 0.63 | 63 | 710 |
| S4K | 6R | 4095 | 0.56 | 56 | 630 |
| S4L | 5R | 6045 | 0.82 | 82 | 930 |
| S4M | 4R | 4453 | 0.61 | 61 | 685 |
| S4N | 3R | 4583 | 0.62 | 62 | 705 |

| | | | | | |
|------------------|-----|-------|------|-----|------|
| S40* | 2R | 4583 | 0.62 | 62 | 705 |
| S4P | 1R | 4583 | 0.62 | 62 | 705 |
| S4Q | 9 | 3575 | 0.49 | 49 | 550 |
| S4R* | 10R | 4290 | 0.59 | 59 | 660 |
| S5A* | 8 | 4485 | 0.61 | 61 | 690 |
| S5B* | 10 | 4290 | 0.59 | 59 | 660 |
| S5C | 11 | 3445 | 0.47 | 47 | 530 |
| S5D* | 1 | 4583 | 0.62 | 62 | 705 |
| S5E* | 2 | 4583 | 0.62 | 62 | 705 |
| S5F* | 3 | 4583 | 0.62 | 62 | 705 |
| S5G | 4 | 4453 | 0.61 | 61 | 685 |
| S5H | 5 | 6045 | 0.82 | 82 | 930 |
| S5I* | 6 | 4095 | 0.56 | 56 | 630 |
| S5J* | 7 | 4615 | 0.63 | 63 | 710 |
| S5K* | 6R | 4095 | 0.56 | 56 | 630 |
| S5L* | 5R | 6045 | 0.82 | 82 | 930 |
| S5M | 4R | 4453 | 0.61 | 61 | 685 |
| S5N* | 3R | 4583 | 0.62 | 62 | 705 |
| S5O* | 2R | 4583 | 0.62 | 62 | 705 |
| S5P | 1R | 4583 | 0.62 | 62 | 705 |
| S5Q | 9 | 3575 | 0.49 | 49 | 550 |
| S5R* | 10R | 4290 | 0.59 | 59 | 660 |
| S6A* | | 6500 | 0.89 | 89 | 1000 |
| S6C | 11 | 3445 | 0.47 | 47 | 530 |
| S6D | 1 | 4583 | 0.62 | 62 | 705 |
| S6E* | 2 | 4583 | 0.62 | 62 | 705 |
| S6F* | 3 | 4583 | 0.62 | 62 | 705 |
| S6G | 12 | 7833 | 1.07 | 107 | 1205 |
| S6H | 13 | 9523 | 1.30 | 130 | 1465 |
| S6I* | 14 | 7508 | 1.02 | 102 | 1155 |
| S6J* | 15 | 7280 | 0.99 | 99 | 1120 |
| S6K* | 14R | 7508 | 1.02 | 102 | 1155 |
| S6L | 13R | 9523 | 1.30 | 130 | 1465 |
| S6M | 12R | 7833 | 1.07 | 107 | 1205 |
| S6N* | 3R | 4583 | 0.62 | 62 | 705 |
| S6O* | 2R | 4583 | 0.62 | 62 | 705 |
| S6P | 1R | 4583 | 0.62 | 62 | 705 |
| S6Q | 9 | 3575 | 0.49 | 49 | 550 |
| S6R* | | 6565 | 0.90 | 90 | 1010 |
| S7A* | 16 | 5038 | 0.69 | 69 | 775 |
| S7B | 21 | 5915 | 0.81 | 81 | 910 |
| S7C* | 20 | 8028 | 1.09 | 109 | 1235 |
| S7D* | 19 | 4453 | 0.61 | 61 | 685 |
| S7E* | 18 | 9360 | 1.28 | 128 | 1440 |
| S7F* | 18R | 9360 | 1.28 | 128 | 1440 |
| S7G* | 19R | 4453 | 0.61 | 61 | 685 |
| S7H* | 20R | 8028 | 1.09 | 109 | 1235 |
| S7I | 22 | 6175 | 0.84 | 84 | 950 |
| S8A* | 16 | 5038 | 0.69 | 69 | 775 |
| S8B* | 21 | 5915 | 0.81 | 81 | 910 |
| S8C | 20 | 8028 | 1.09 | 109 | 1235 |
| S8D | 19 | 4453 | 0.61 | 61 | 685 |
| S8E | 18 | 9360 | 1.28 | 128 | 1440 |
| S8F | 18R | 9360 | 1.28 | 128 | 1440 |
| S8G | 19R | 4453 | 0.61 | 61 | 685 |
| S8H | 20R | 8028 | 1.09 | 109 | 1235 |
| S8I* | 22 | 6175 | 0.84 | 84 | 950 |
| S9A* | 16 | 5038 | 0.69 | 69 | 775 |
| S9B | 21 | 5915 | 0.81 | 81 | 910 |
| S9C* | 20 | 8028 | 1.09 | 109 | 1235 |
| S9D | 23 | 4095 | 0.56 | 56 | 630 |
| S9D1 | 24 | 3445 | 0.46 | 46 | 530 |
| S9E | 17 | 5655 | 0.77 | 77 | 870 |
| S9F | 18R | 9360 | 1.28 | 128 | 1440 |
| S9G* | 19R | 4453 | 0.61 | 61 | 685 |
| S9H* | 20R | 8028 | 1.09 | 109 | 1235 |
| S9I* | 22 | 6175 | 0.84 | 84 | 950 |
| S10A* | 25 | 21770 | 2.97 | 297 | 3110 |
| S10B* | 25R | 21770 | 2.97 | 297 | 3110 |

| | | | | | |
|-----|---------|-----|-------|------|-----|
| P1 | PARKING | 192 | .0265 | 2.65 | 162 |
| P2 | PARKING | 192 | .0265 | 2.65 | 162 |
| P3 | PARKING | 192 | .0265 | 2.65 | 162 |
| P4 | PARKING | 192 | .0265 | 2.65 | 162 |
| P5 | PARKING | 192 | .0265 | 2.65 | 162 |
| P6 | PARKING | 192 | .0265 | 2.65 | 162 |
| P7 | PARKING | 192 | .0265 | 2.65 | 162 |
| P8 | PARKING | 192 | .0265 | 2.65 | 162 |
| P9 | PARKING | 192 | .0265 | 2.65 | 162 |
| P10 | PARKING | 192 | .0265 | 2.65 | 162 |
| P11 | PARKING | 192 | .0265 | 2.65 | 162 |
| P12 | PARKING | 192 | .0265 | 2.65 | 162 |
| P13 | PARKING | 192 | .0265 | 2.65 | 162 |
| P14 | PARKING | 192 | .0265 | 2.65 | 162 |

TOTALS = 734,045 100.00 10,000 125,273

*** Indicates a balcony in this unit!!

10