

Warranty

I-280-9 (97)

R-174b

Tract 9

E A S E M E N T

1963, THIS INDENTURE, Made this 26 day of November,  
 between Arthur L. Peterson and Ruby H. Peterson, husband and wife

hereinafter called the Grantors, whether one or more, and The State of  
 Nebraska, hereinafter called the Grantee:

WITNESSETH, That the Grantors, in consideration of the sum of  
 - - - - - Twenty-five and 00/100 - - - - - (\$25.00) - - - - - DOLLARS in  
 hand paid, the receipt of which is hereby acknowledged, and the further  
 consideration that the premises herein conveyed shall be used for the  
 control of outside advertising signs, displays, and other advertising  
 devices adjacent to the National System of Interstate and Defense High-  
 ways, do hereby grant, convey, and confirm unto the Grantee a permanent  
 easement in and to a tract of land situated in Douglas County,  
 Nebraska, described as follows:

All that part of the east 35/100 (North Half of  
 the Northwest Quarter and the Triangular Northeast Half of  
 the Southeast Quarter of the Northwest Quarter) of Section  
 9, Township 15 North, Range 12 East of the 6th P.M., Douglas  
 County, Nebraska, lying within 660 feet of the Interstate  
 Highway Right of Way Controlled Access line as measured at  
 right angles to the centerline of said Interstate Highway,  
 being in accordance with the Rules and Regulations Relating  
 to the Control of Advertising in Areas Adjacent to the  
 National System of Interstate and Defense Highways in Nebr-  
 aska, which were adopted pursuant to Section 39-1320.03,  
 R. S. Supp., 1961 and in accordance with Section 84-907,  
 R. R. S. 1943; approved and filed on June 15, 1961, and as  
 illustrated on the attached plat.

The Grantors, for themselves, their heirs, successors and  
 assigns, do hereby covenant with the Grantee and its assigns, that the  
 Grantors are lawfully seized of said premises and that the Grantors  
 have good right and lawful authority to convey said permanent easement;  
 and that the Grantors warrant and will defend the title to said premises  
 against the lawful claims of all persons whomsoever.

IN WITNESS WHEREOF, The Grantors have hereunto set their  
 hands this 26 day of November, 1963.

Grantors  
 x Arthur L. Peterson  
 x Ruby H. Peterson

STATE OF Nebraska )  
Douglas COUNTY ) ss.

On this 26<sup>th</sup> day of November, A.D., 1963,  
before me, the undersigned Philip R. Kieff  
a Notary Public, duly commissioned and qualified ~~for~~ and residing in said  
County, personally came Arthur L. Peterson and Ruby H. Peterson,  
husband and wife

known to be the identical persons whose names are affixed to the fore-  
going instrument as Grantors and acknowledged the same to be their vol-  
untary act and deed.

WITNESS my hand and Notarial Seal the day and year last above

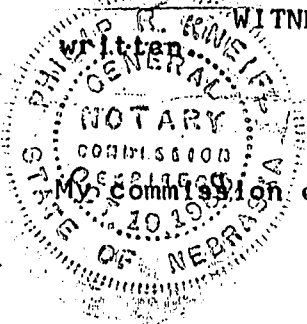

Philip R. Kieff  
Notary Public

My commission expires the 19<sup>th</sup> day of October, 1969.

Project No. \_\_\_\_\_  
AFE \_\_\_\_\_  
Easement  
for  
Control of Advertising  
From \_\_\_\_\_

\_\_\_\_\_

To

THE STATE OF NEBRASKA

STATE OF NEBRASKA )  
County ) ss.

Entered in numerical index and  
filed for record in the office of the  
Register of Deeds of said County, the  
day of \_\_\_\_\_, 19\_\_\_\_,  
at \_\_\_\_\_ o'clock and \_\_\_\_\_ minutes  
of \_\_\_\_\_ M., and duly recorded in Book \_\_\_\_\_  
of \_\_\_\_\_ Page \_\_\_\_\_.

\_\_\_\_\_ County Clerk  
\_\_\_\_\_ Deputy

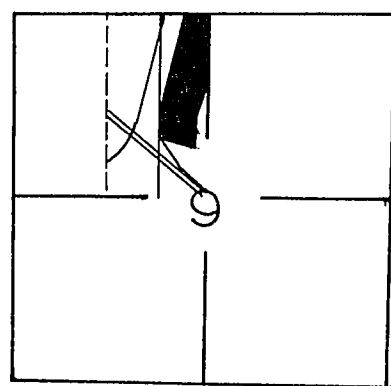
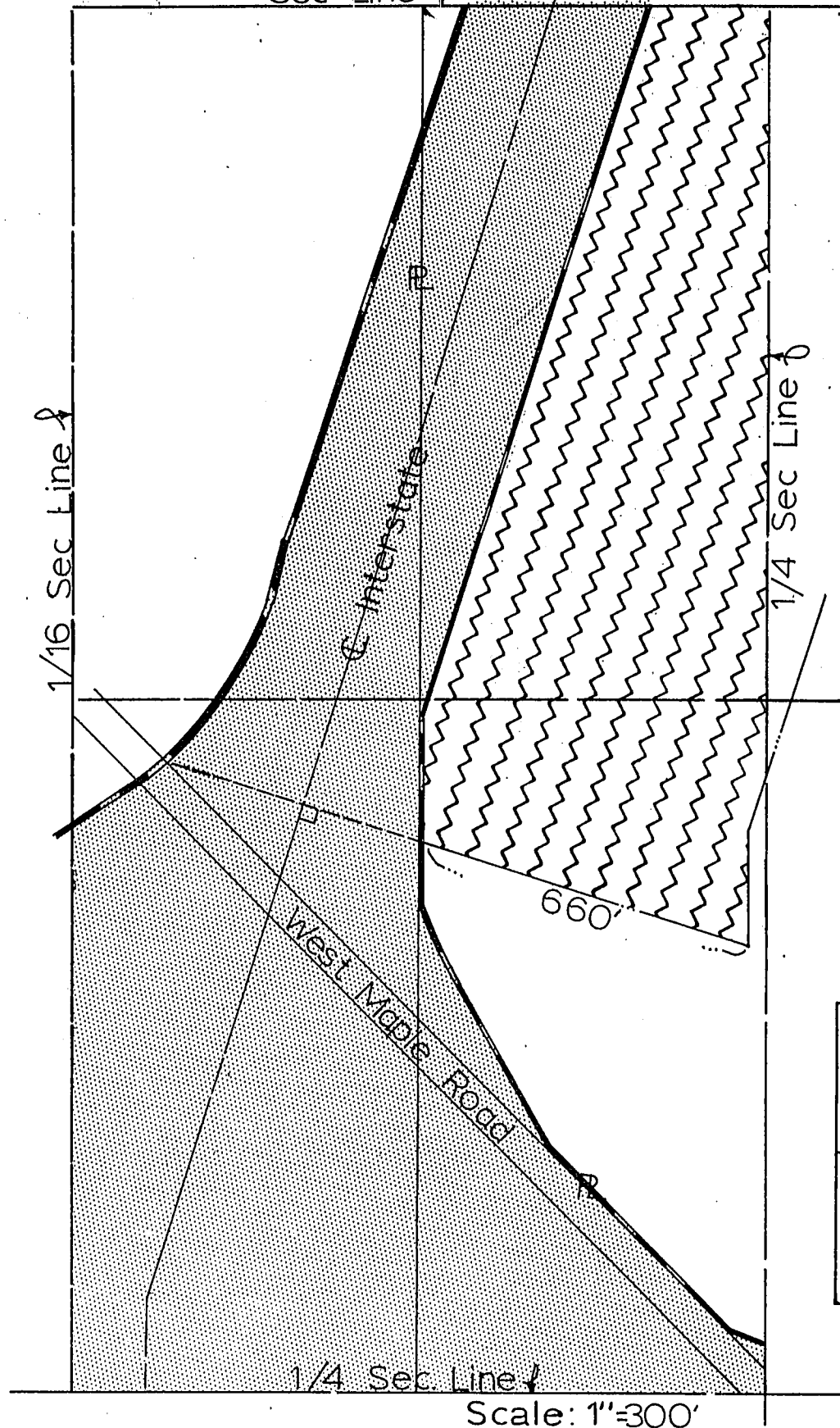

Scale: 1"=300'

Advertising Control  
 to be acquired for Interstate Highway purposes  
 Project: I-280-9(97) Douglas County A.F.E.R.-174b  
 Tract: 9  
 Holder of Record: Arthur L. Peterson  
 Location: E 35/100 of N<sup>2</sup>NW<sup>4</sup> & triangular  
 NE<sup>2</sup>SE<sup>4</sup>NW<sup>4</sup> Sec. 9 T15N R12E

drawn: CPB  
 checked: PJP  
 written:  
 checked:

- Total ROW =
- Old ROW =
- New ROW =
- Controlled Access =
- Channel Ease. =
- Advertising Easement =

I.288-9(97) Q1942

Account for

Postal of Advertising

Arthur J. Peterson  
Ruby H. Peterson

To  
State of Nebraska  
State of Nebraska  
Douglas County

BOOK 408 PAGE 318

8  
Mrs

RECEIVED

1964 FEB 7 AM 10 33

THOMAS J. O'CONNOR  
REGISTER OF DEEDS  
DOUGLAS COUNTY, NEBR.

THE STATE OF NEBRASKA ) ss.  
Douglas County )

Entered in Permanent Index and filed  
for Record in the office of the Register of  
Deeds of said County and recorded in  
Book 408 of Nebraska.

Page 315

*James J. Peterson*  
Register of Deeds

By Arthur J. Peterson Deputy  
Register of Deeds  
Date 9-15-12 6 P.M.  
Book 408

9-15-12

14518

RECEIVED

NOV 29 1963

R.O.M. DIVISION