

232 Wilson → Spencer Realty Co 851/483-349 31/561 R-Om Comm Dev 2098/569-11/74

DEPARTMENT OF HOUSING & COMMUNITY DEVELOPMENT
PERMITS & INSPECTION DIVISION

BOOK 570 PAGE 217

CONDEMNATION OF BUILDINGS

WORK SHEET

ADDRESS 2008-16 Spencer STRUCTURE Wd Brn - D. K. V. C.
TYPE Apt Bldg. SIZE 120 X 34 X 20
BASEMENT yes STORIES 2
OCCUPANT 2 Vacant Apts # 14 & 214 in 2008 Sec.
CONDITION OF BUILDING: Unsafe - Van Linder

LOCATION: SHOW LOCATION OF STRUCTURE ON THE PLATTED BLOCK AS MEASURED FROM CENTER LINES OF STREETS TO CENTER LINE OF STRUCTURE.

This structure is unsafe and unfit for occupancy or use and ordered closed by the Permits and Inspection Division of the Public Safety Department City of Omaha

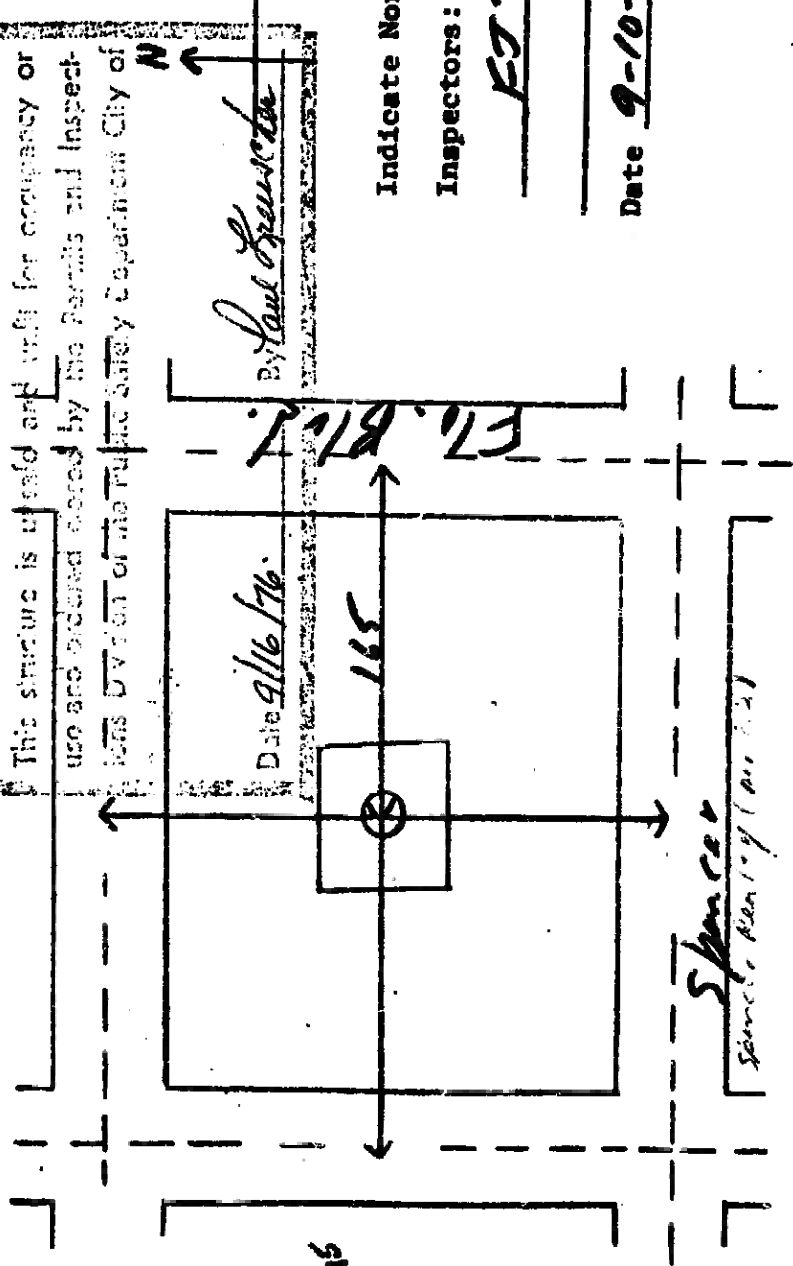

Indicate North.

Inspectors: EJR

Date 9-10-76

LEGAL DESCRIPTION E 250 S 1/2 Reserve Lot w of 20 St Countryside

OWNER: SPENCER REALTY CO.

ADDRESS: 2605 FARMACI

MP1-164 08 Inty - Omaha Community Development Corp.

Min Aug. ?

RECEIVED

1976 SEP 16 AM 11:33

REGISTER OF DEEDS
DOUGLAS COUNTY, NEBR.

Book 570
Page 217
of 217

Fee
Index
Copied
31-626

31

Spencer
9/16/76