

DEDICATION:  
KNOW ALL MEN BY THE  
REVOCABLE TRUST, BE  
REPLATED INTO THE  
COUNTY, NEBRASKA.

IN WITNESS WHEREOF,  
12 DAY OF  
*Billie L.*  
BILLIE L. STEAVENSON  
*Billie L.*

- Ⓐ 507°24'03"E 117.73'(P#M)
- Ⓑ 513°27'57"W 105.73'(P#M)
- Ⓒ 522°31'18"E 119.36'(P#M)
- Ⓓ 501°30'35"E 32.26'(P#M)
- Ⓔ 540°18'30"E 73.83'(P#M)
- Ⓕ 500°17'13"W 97.86'(P#M)
- Ⓖ 532°14'04"W 50.11'(P#M)
- Ⓗ 531°59'21"E 63.16'(P#M)
- Ⓘ 506°21'34"W 39.18'(P#M)
- Ⓢ 533°42'55"E 113.25'(P#M)
- Ⓚ 541°03'52"E 39.76'(P#M)

WASHINGTON COUNTY SURF  
THIS ADMINISTRATIVE LOT LINE.  
WASHINGTON COUNTY SURVEY  
*Richard L. Hansen*  
RICHARD L. HANSEN, WASHINGTON COUNTY SURVEYOR

SURVEYOR'S STATEMENT:  
I, GARY L. SIEDSCHLAG, HEREBY CERTIFY  
ME OR UNDER MY SUPERVISION AND  
KNOWLEDGE, AND THAT I AM A DULY  
LICENSED SURVEYOR OF THE STATE OF NEBRASKA.

*Gary L. Siedschlag*  
GARY L. SIEDSCHLAG, LS 517  
FEBRUARY 11, 2002

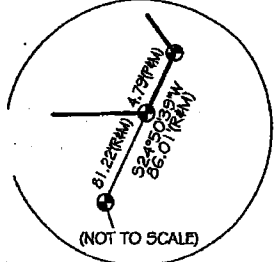

- A 507°24'03"E 117.73(P#M)
- B 513°27'57"W 105.73(P#M)
- C 522°31'18"E 119.36(P#M)
- D 501°30'35"E 32.26(P#M)
- E 540°18'30"E 73.83(P#M)
- F 500°17'13"W 97.86(P#M)
- G 532°14'04"W 50.11(P#M)
- H 531°59'21"E 63.16(P#M)
- I 506°21'34"W 39.18(P#M)
- J 533°42'55"E 113.25(P#M)
- K 541°03'52"E 39.76(P#M)

LINE EK

TAX LOT 39

CENTERLINE OF CREEK

12

DISTANCE OF 210.89 FEET; THENCE N69°44'43"E, A DISTANCE OF 532.29 FEET; THENCE S07°24'03"E, A DISTANCE OF 212.53 FEET TO THE TRUE POINT OF BEGINNING, CONTAINING 12.95 ACRES, MORE OR LESS.

**DEDICATION:**  
 KNOW ALL MEN BY THESE PRESENTS THAT: BILLIE L. STEAVENSON, SUCCESSOR TRUSTEE OF THE WILLIAM A. STEAVENSON II REVOCABLE TRUST, BEING THE OWNER OF THE TRACT OF LAND SHOWN AND DESCRIBED HEREON, HAS CAUSED THE SAME TO BE REPLATTED INTO TWO LOTS TO BE KNOWN AS REVISED LOT 2 AND REVISED LOT 3, OF OAK POINT FARMS, WASHINGTON COUNTY, NEBRASKA. THIS REPLAT IS MADE WITH THE FREE CONSENT AND IN ACCORDANCE WITH THE DESIRES OF SAID OWNER.

IN WITNESS WHEREOF, SAID OWNER HAS CAUSED THESE PRESENTS TO BE SIGNED THIS

12 DAY OF February, A.D., 2002.  
*Billie L. Steavenson* For the *William A. Steavenson II Revocable Trust*  
 BILLIE L. STEAVENSON, FOR THE WILLIAM A. STEAVENSON II REVOCABLE TRUST  
*Billie L. Steavenson* a single person individually

WASHINGTON COUNTY SURVEYOR'S APPROVAL:  
 THIS ADMINISTRATIVE LOT LINE ADJUSTMENT WAS REVIEWED BY THE WASHINGTON COUNTY SURVEYOR'S OFFICE ON THIS 13 DAY OF February, A.D., 2002.  
*Richard L. Hansen*  
 RICHARD L. HANSEN, WASHINGTON COUNTY SURVEYOR

2002/11/21  
 STATE OF NEBRASKA COUNTY OF WASHINGTON  
 ENTERED IN NUMERICAL INDEX AND FILED FOR RECORD THIS 19th DAY OF February, A.D. 2002  
 AT 10:18 O'CLOCK A M AND RECORDED IN BOOK 358 AT PAGE 180-183  
 COUNTY CLERK *Charlotta K. Petersen*  
 DEPUTY *Karen Madson*

TREASURER'S CERTIFICATION:  
 THIS IS TO CERTIFY THAT I FIND NO REGULAR OR SPECIAL TAXES DUE OR DELINQUENT AGAINST THE PROPERTY DESCRIBED IN THE LEGAL DESCRIPTION ON THIS PLAT, AS SHOWN BY THE RECORDS OF THIS OFFICE ON THIS 14th DAY OF February, A.D., 2002.  
*Kay J. Ewing*  
 WASHINGTON COUNTY TREASURER

**SURVEYOR'S STATEMENT:**  
 I, GARY L. SIEDSCHLAG, HEREBY CERTIFY THAT THIS PLAT OF SURVEY WAS MADE BY ME OR UNDER MY SUPERVISION AND IS TRUE AND ACCURATE TO THE BEST OF MY KNOWLEDGE, AND THAT I AM A DULY REGISTERED LAND SURVEYOR UNDER THE LAWS OF THE STATE OF NEBRASKA.  
*Gary L. Siedschlag*  
 GARY L. SIEDSCHLAG, LS 517  
 FEBRUARY 11, 2002



Recorded \_\_\_\_\_  
 General \_\_\_\_\_  
 Numerical \_\_\_\_\_  
 Photostat \_\_\_\_\_  
 Proofer \_\_\_\_\_

ME	ARL
SHEET: ADMINISTRATIVE ADJUSTMENT SURVEY OF REVISED LOT 2 & REVISED LOT 3	PROJECT: ALL OF LOTS 2 AND 3, OF OAK POINT FARMS AS PLATTED IN SECTIONS 16 AND 17 TOWNSHIP 18 NORTH, RANGE 9 EAST OF THE SIXTH P.M., WASHINGTON COUNTY, NEBRASKA
PROJECT NO.: SU-532	
DRAWN BY: DJM	
DATE: 02/11/02	
FIELDBOOK: WASHINGTON CO. 3	
DWG FILE:	
SCALE: 1" = 200'	
REVISION DATE:	
SHEET 1 OF 1	