

BEFORE THE COUNTY JUDGE OF **LANCASTER** COUNTY, NEBRASKA

STATE OF NEBRASKA
DEPARTMENT OF ROADS,

Docket 91 Page 159

Condemner,

v.

RETURN OF APPRAISERS

LOIS PEGRAM, Owner; BILLY J. PEGRAM, also known as B. J. PEGRAM, husband of LOIS PEGRAM; ROBERT KNAPE and FLORENCE KNAPE, husband and wife, Holders of Interest; MERLE MOOK, Lienholder; THE EQUITABLE LIFE ASSURANCE SOCIETY OF THE UNITED STATES, Mortgagee;

Condemnees.

TO HONORABLE **RALPH SLOCUM**, COUNTY JUDGE, **LANCASTER** COUNTY, NEBR.

We, the undersigned appraisers, do hereby certify that under and by virtue of an "Appointment of Appraisers" duly served upon us by William C. Greiner and Delton C. Ziemann, Sheriff or Deputy Sheriff of Lancaster County, Nebraska, on the 29th and 30th day of August, 19 66, and after having taken and filed the "Oath of Appraisers" that we did carefully inspect and view the property described herein, sought to be appropriated by the State of Nebraska, Department of Roads, and also other property of the condemnees alleged damaged thereby and did hear all parties interested therein in reference to the amount of damages sustained while we were so inspecting and viewing the property herein described and thereafter did assess the damages that the condemnees have sustained or will sustain by such appropriation of the property herein described for State highway purposes and also damage to such other property of the condemnees as in our opinion was damaged by the appropriation of the property herein described:

RLW-648

C O N D E M N A T I O N

Land Owners: Lois Pegram and E. J. Pegram, wife and husband

Mortgagee: Equitable Life Assurance Society of the United States

Mechanics Lien: Merle Hook

Purchasers on Contract: Robert Knape and Florence Knape, husband and wife

Project: I-80-9 (9 $\frac{1}{2}$) AFE: R-172h Lancaster County, Nebraska

Permanent Easement to a tract of land for the Control of Outdoor Advertising as illustrated on the attached plat and being more particularly described as all that part of the North Half of the Northwest Quarter of Section 1, Township 10 North, Range 5 East of the 6th P.M., Lancaster County, Nebraska, lying within 660 feet of the Interstate Highway Right of Way Controlled Access Line as measured at right angles to the centerline of said Interstate Highway and being in accordance with the rules and regulations relating to the Control of Advertising in areas adjacent to the National System of Interstate and Defense Highways in Nebraska, which were adopted pursuant to Section 39-1320.03, R. S. Supp., 1961 and in accordance with Section 34-907, R. S. S. 1943; approved and filed on June 15, 1961.

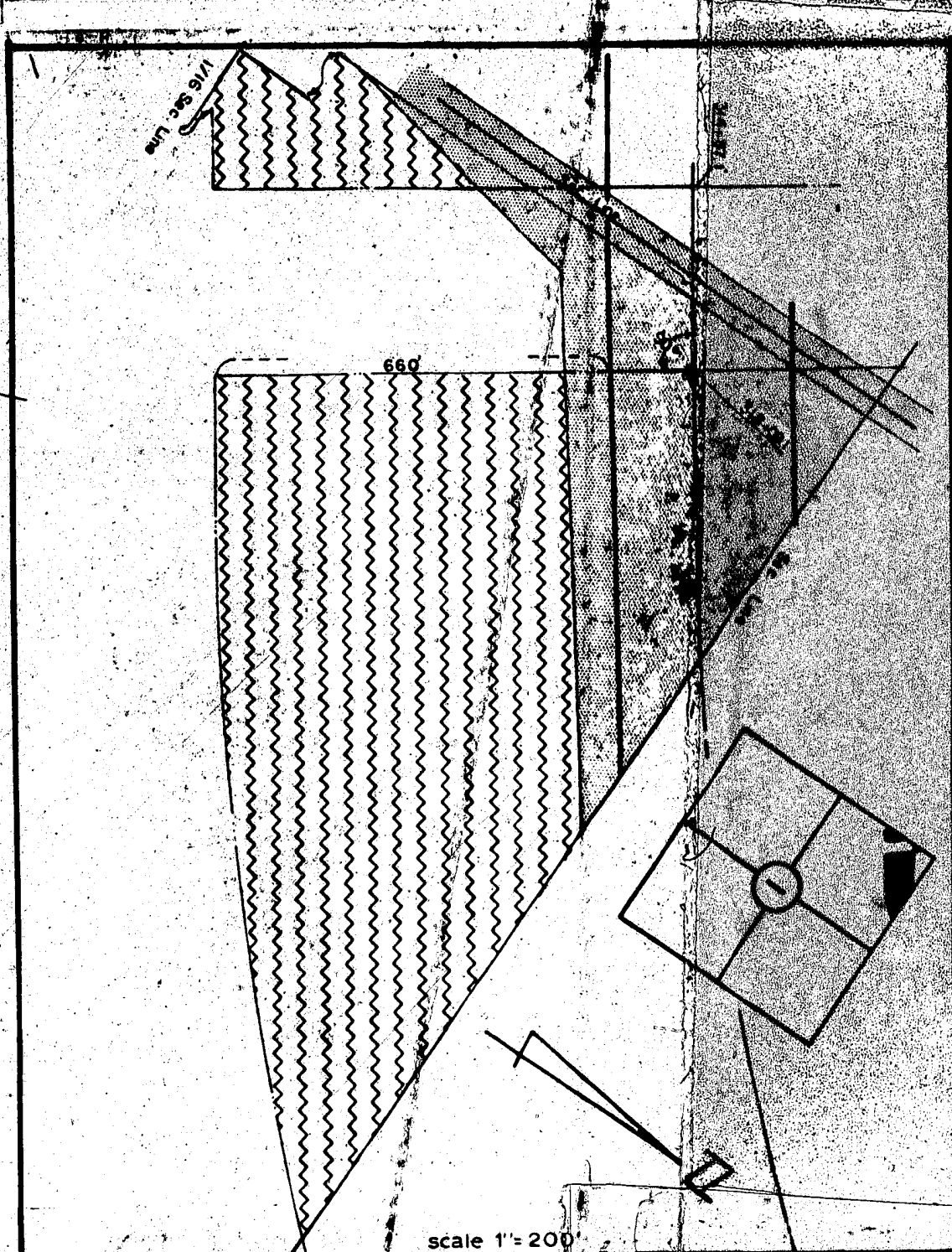

scale 1" = 200'

ADVERTISING CONTROL

to be acquired for Interstate Highway purposes
Project: I-80-9 (94) Lancaster County A.F.E. R-1726
Tract 46

Holder of Record: Lois Pegram

Location: Sec. 1 - T10N-R6E, N² NW



Old R.O.W.



Advertising Control Easement

Controlled Access Line

drawn G. J.R. 7/18/66
checked J.L.
written C.R.S. 7-66
checked M.R. 7-66

STATE OF NEBRASKA
DEPARTMENT OF ROADS

...do hereby find
...the damages that will be suffered by reason of the
...of title to the said property or any interest therein
...for State highway purposes by the State of Nebraska,
...Department of Roads in the amount of:

...: **Edna Fagan, Widow; Billy J. Fagan,
also known as B. J. Fagan, husband
of Edna Fagan; Robert Knapp and
Florence Knapp, husband and wife,
Successors of Interest; Merle Cook,
Trustee; The Equitable Life
Assurance Society of the United
States, Mortgagee;**

\$ 150.00

All of which is hereby respectfully submitted.

Dated this 12th day of September, A. D., 1966.

John P. Glynn
Appraiser

Jack B. Aids
Appraiser

Tommy E. Hicks
Appraiser

Subscribed and sworn to before me this 12th day of September,

A. D., 1966

(Notary)

Notary

Ralph W. Slocum
County Judge

IN THE COUNTY COURT OF LANCASTER COUNTY NEBRASKA

STATE OF NEBRASKA)
LANCASTER COUNTY)

ss.

CERTIFICATE

I, RALPH W. SLOCUM, Judge of the County Court of Lancaster County, do hereby certify that the foregoing is a full and correct copy of the original instrument duly filed and of record in this Court.

IN WITNESS WHEREOF, I have hereunto set my hand and the seal of the County Court of said County at Lincoln, Nebraska this 16 day of September, 1966

(SEAL)

Ralph W. Slocum
County Judge
By Don [Signature]
Clerk County Court

INDEXED 6-557
GENERAL *mer*
COMPARED
PAGED

LANCASTER COUNTY NEBRASKA
FILED IN NUMERICAL INDEX
FILED FOR RECORD IN
BOOK
1966 SEP 19 AM 6:00
J. L. Ferguson
REGISTER OF DEEDS

#925

✓