



# ADMINISTRATIVE LOT LINE ADJUSTMENT

I hereby certify that this plat, map, survey or report was made by me or under my direct supervision and that I am a duly Registered Land Surveyor under the laws of the State of Nebraska.

## LEGAL DESCRIPTION:

Lot 57 and the East 2.00 foot of Lot 56, all in MILLARD PARK SOUTH, a subdivision, as surveyed, platted and recorded in Sarpy County, Nebraska.

Lot 56, MILLARD PARK SOUTH, a subdivision, as surveyed, platted and recorded in Sarpy County, Nebraska, EXCEPT the East 2.00 foot thereof.

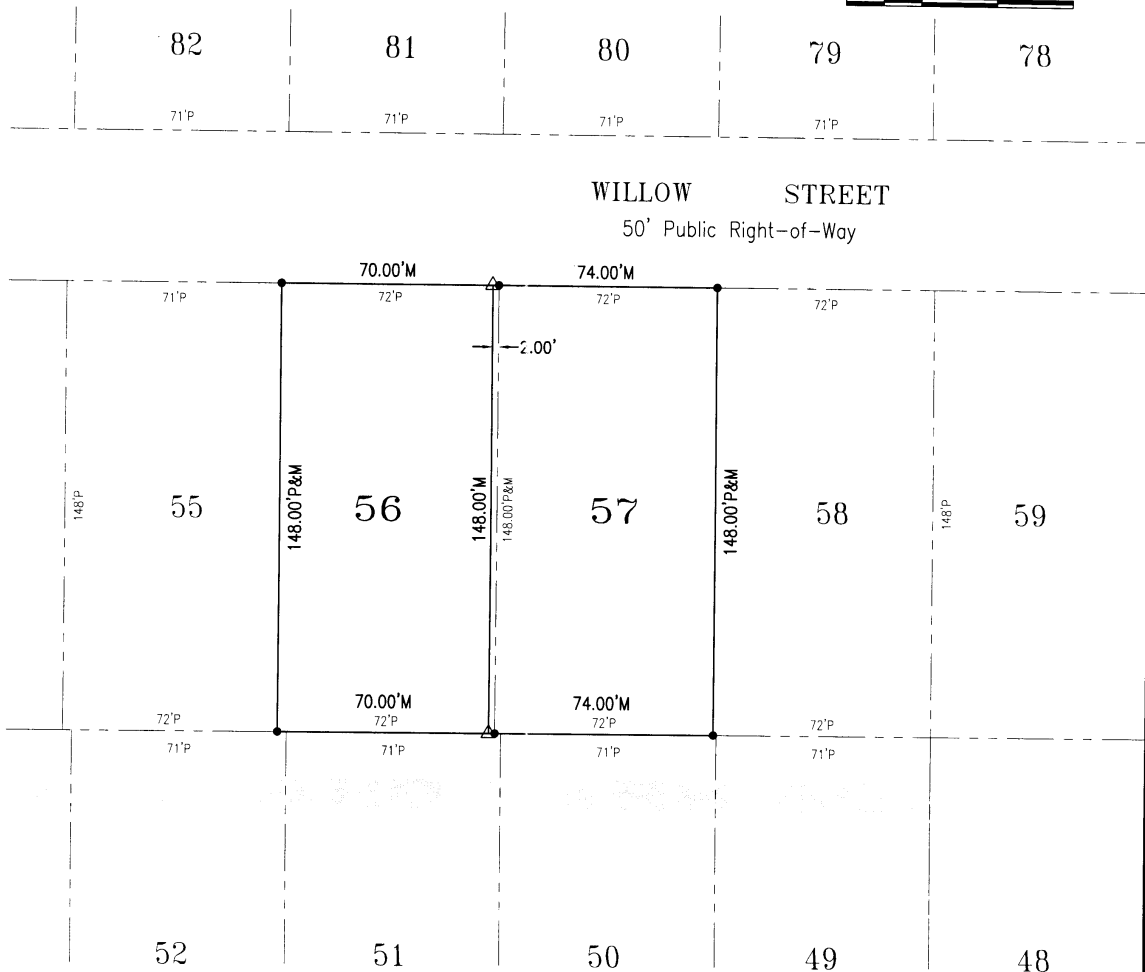
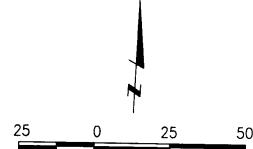

## LEGEND

- △ CORNERS SET (5/8" REBAR WITH 1 1/4" YELLOW PLASTIC CAP STAMPED LS 545)
- CORNERS FOUND (5/8" REBAR)
- M MEASURED DIMENSIONS
- P PLAT DIMENSIONS

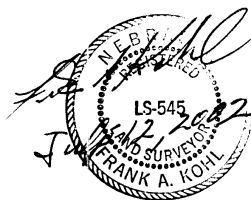

Book 98020 # 2 Page 10 Date July 11, 2002 Dwn.By JHVD Job Number M0211.34



**lamp, ryneason & associates, inc.**  
engineers surveyors planners

14710 west dodge road, suite 100  
omaha, nebraska 68154-2029

ph 402-496-2498  
fax 402-496-2730

2002-26550B

SARPY COUNTY, NEBRASKA  
ADMINISTRATIVE LOT LINE ADJUSTMENT

Legal Description:

Lot 57 and the East Two foot (2.00') of Lot 56, all in MILLARD PARK SOUTH, a subdivision, as surveyed, platted and recorded in Sarpy County, Nebraska.

Lot 56, MILLARD PARK SOUTH, a subdivision, as surveyed, platted and recorded in Sarpy County, Nebraska, EXCEPT the East Two foot (2.00') thereof.

SURVEYOR'S CERTIFICATE

I hereby certify that this plat, map, survey or report was prepared by me or under my direct supervision and that I am a duly Registered Land Surveyor under the laws of the State of Nebraska. I further certify that I have surveyed and placed or found permanent markers at all corners of all lots being platted.

  
Frank A. Kohl, LS 545

July 12, 2002  
Date

OWNER'S CERTIFICATION

KNOW ALL PERSONS BY THESE PRESENTS: That the undersigned are owner's of the property as described in the surveyor's certificate and embraced within this plat, and have caused said land to be subdivided into lots as shown on this plat.

Barr Homes, Inc. (OWNER)

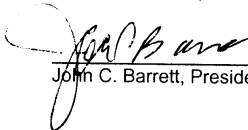
  
John C. Barrett, President

7-16-02  
Date

ACKNOWLEDGEMENT OF NOTARY

State of Nebraska)

)SS

County of Sarpy)

On this 16<sup>th</sup> day of July, 2002, before me, a notary public, duly qualified and commissioned in and for said county and state, personally appeared John C. Barrett, President of Barr Homes, Inc., who is personally known to me to be the identical person whose name is affixed to the foregoing instrument and he acknowledged the signing of the same to be his voluntary act and deed.

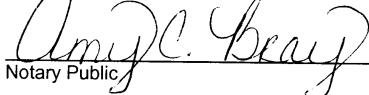
  
Notary Public

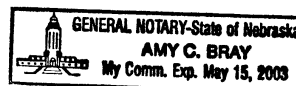

COUNTY TREASURER'S CERTIFICATION

This is to certify that I find no regular or special taxes due or delinquent against the property as described in the surveyor's certificate and as shown by the records of this office.

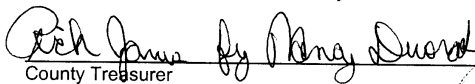
  
County Treasurer

7-16-02  
Date  
TAXES ASSESSED AND LEVIED FOR THE  
CURRENT YEAR ARE NEITHER DUE NOR  
PAID. TREASURER'S CERTIFICATION  
IS ONLY VALID UNTIL DECEMBER 30<sup>th</sup>  
OF THIS YEAR.

SARPY COUNTY SURVEYOR

I hereby reviewed the Administrative Lot Line Adjustment as attached hereto.

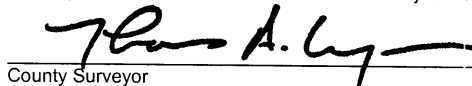
  
County Surveyor

July 16<sup>th</sup> 2002  
Date

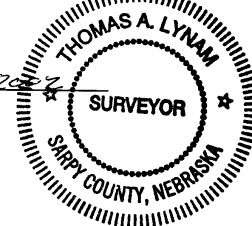

COUNTY BUILDING INSPECTOR

I hereby approve the Administrative Lot Line Adjustment as attached hereto.

  
County Building Inspector

7-15-02  
Date