

## GRANT OF EASEMENT

PERMANENT SEWER EASEMENT

This Indenture and Grant of Easement made the 22<sup>ND</sup> day of SEPTEMBER, 1980, between PAUL K. ABELL AND SYLVIA J. ABELL hereinafter referred to as "Grantors", in favor of Sanitary and Improvement District No. 229, Douglas County, Nebraska, hereinafter referred to as SID, and its successors and assigns, including but not in limitation of the City of Omaha Douglas County, Nebraska, a municipal corporation, hereinafter referred to as "City".

WITNESSETH:

THAT, said Grantor(s) in consideration of the sum of One Dollar (\$1.00), and other valuable consideration, to Grantor(s) in hand paid by said SID, the receipt whereof is hereby acknowledged, does or do hereby grant, sell, convey and confirm unto said SID and City and their assigns forever, the right to construct by jacking, maintain, repair and/or reconstruct a sanitary pipe for the passage of sewage, and other applicable equipment pertaining to said sewer, in, through, and under the parcel of land described as follows, to-wit:

The South Ten (10) feet of Lot Twelve (12), Block Four (4) of Maple Villiage, a subdivision surveyed, platted and recorded in Douglas County, Nebraska.

No buildings, improvements or structures, shall be placed, in, on, over or across said easements by undersigned, his or their successors and assigns without express approval of said SID and said City: provided, however, that a paved macadam, rocked, asphalt or other hard surfaced street or parking lot and trees, grass and shrubbery, may be installed within said easement by Grantor, his or their successors and assigns, and that in the event it becomes necessary to remove or replace said sewer line, the removal or repair of said street or parking lot shall be done at the expense of the SID and its successors and assigns and said premises shall be restored by SID and its successors and assigns to the condition thereof before said removal or repair.

Said SID shall cause any trench made on aforesaid realty to be properly refilled, and shall cause grass sod to be placed over said trench, and shall cause the premises to be left in a neat and orderly condition.

The easement is also for the benefit of any contractor, agent, employee and representative of the SID in any of said construction and work.

Said Grantor(s) for himself or themselves and his or their heirs, executors, and administrators does or do confirm with the said SID and their assigns, that he or they, the Grantor(s) is or are well seized in fee of the above described property and that he or they has or have the right to grant and convey this easement in the manner and form aforesaid, and that he or they will, and his or their heirs, executors and administrators, shall warrant and defend this easement to said SID and their assigns against the lawful claims and demands of all persons. This easement runs with the land.

IN WITNESS WHEREOF, said Grantor(s) have or have hereunto set his or their hands and seal(s) the day and year first above written.

Paul K. Abell  
Sylvia J. Abell

STATE OF NEBRASKA )  
                                  )ss  
COUNTY OF                 )

On the 22d day of SEPT, 1980, before me, a Notary Public in and for said County, personally came PAUL K. ABELL + SYLVIA J. ABELL who is (are) personally known to me to be the identical person(s) whose name(s) is (are) affixed to the foregoing instrument and acknowledge the instrument to be his, her, (their) voluntary act and deed for the purpose therein stated.

WITNESS my hand and Notarial Seal the date aforesaid.

Thomas J. Kiefer  
Notary Public

My Commission expires 6-9-83.

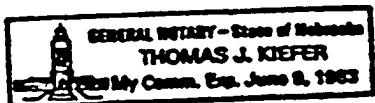

OR INSTRUMENT FILED

# EXHIBIT "A"

BOOK 639 PAGE 347

## SEWER AND DRAINAGE EASEMENT S. & I. D. No. SARPY COUNTY, NEBRASKA



Scale: 1" = 50'

STATE HWY. 680

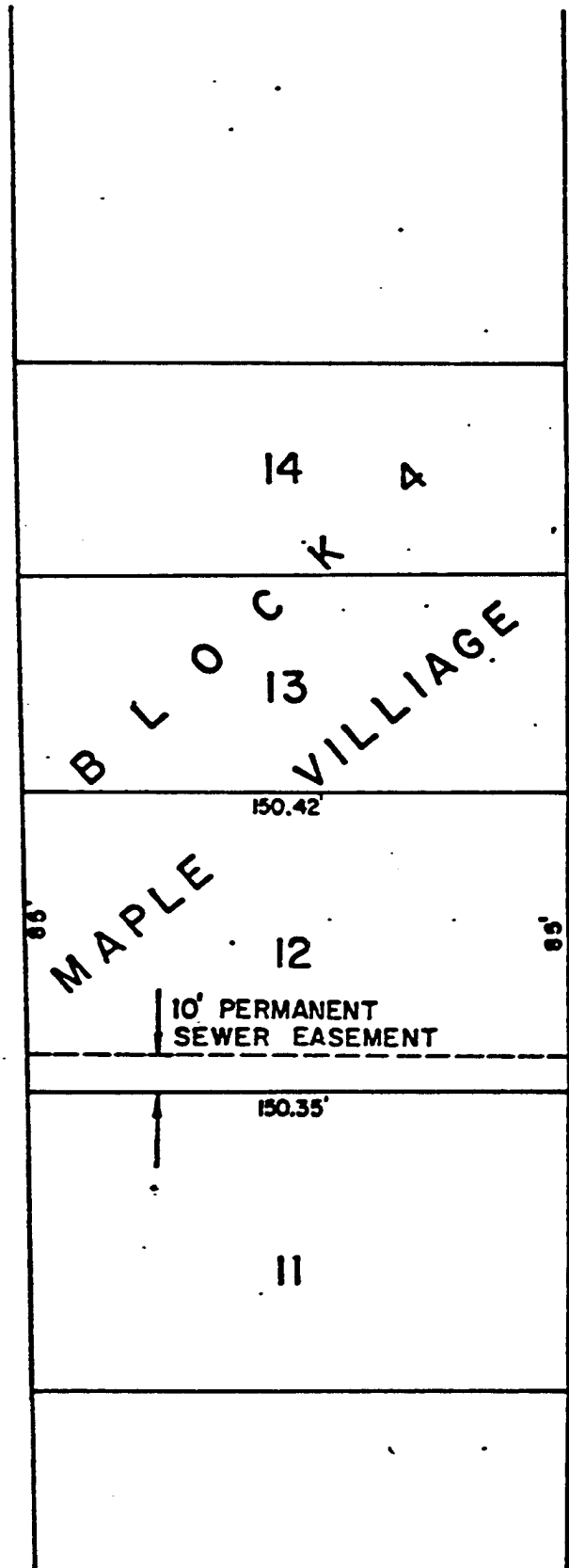

B L O C K  
V I L L I A G E

101st STREET

MANDERSON STREET

RECEIVED  
1980 SEP 22 PM 3:58  
C. HAROLD COSTER  
REGISTERED 28495  
SARPY COUNTY, NEBR.

Book 639  
Page 345  
of 345

Fee 9.22  
Index  
Copied  
69-28  
69