

6.00 Feb. 22, 1966

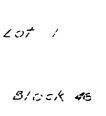

Note:  
Dimensions Shown On Curves Are Arc Dimensions

4/10.50

[illegible]

*James B. Warner*  
REGISTERED LAND SURVEYOR

*M. A. Pedersen*  
PEDERSEN CONSTRUCTION COMPANY  
MARTIN A. PEDERSEN - PRESIDENT  
*Thomas J. Pedersen, Secretary*

FIRST FEDERAL SAVINGS & LOAN  
ASSOCIATION OF LINCOLN  
N. P. Dodge  
R. P. Pharmacy  
N. P. DODGE COMPANY

WITNESS MY HAND AND OFFICIAL SEAL, IN OMAHA, NEBRASKA, THE DATE LAST AFORESAID.

MY COMMISSION EXPIRES ON January 21 1975

NOTARY PUBLIC James L. Hall

WITNESS MY HAND AND OFFICIAL SEAL, IN OMAHA, NEBRASKA, THE DATE LAST AFORESAID.

MY COMMISSION EXPIRES ON NOV 15 1960

NOTARY PUBLIC Wm. C. Fullerton

WITNESS MY HAND AND OFFICIAL SEAL, IN OMAHA, NEBRASKA, THE DATE LAST AFORESAID.

MY COMMISSION EXPIRES ON September 13 1977

NOTARY PUBLIC Phyllis S. Friebe

DEPUTY \_\_\_\_\_ DOUGLAS COUNTY TREASURER \_\_\_\_\_

APPROVAL OF CITY ENGINEER \_\_\_\_\_

THIS PLAT OF MAPLE VILLAGE REPLAT II WAS APPROVED BY THE CITY PLANNING BOARD OF THE CITY OF CHAMPAIGN, ILL. ON THIS 16 DAY OF JUNE, 1976

CHAIRMAN [Signature]

APPROVAL BY DOUGLAS COUNTY SURVEYOR  
THIS PLAT OF MAPLE VILLAGE REPLAT II WAS APPROVED AND ACCEPTED BY THE DOUGLAS COUNTY SURVEYOR ON THIS 15TH DAY OF

1916, 1916. DOUGLAS COUNTY SURVEYOR James J. Hendricks