

FINAL PLAT

# LAURITSEN SU

A SMALL TRACT SUBDIVISION OF TAX LOTS  
IN SECTION 5, TOWNSHIP 17 NORTH, RANGE 11  
THE 6<sup>th</sup> P.M., WASHINGTON COUNTY, NEBR.

LEGAL DESCRIPTION:

ALL OF TAX LOTS 84 AND 87 LYING IN SECTION 5, TOWNSHIP 17 NORTH, RANGE 11 EAST OF THE 6th P.M., WASHINGTON COUNTY, NEBRASKA, AND MORE PARTICULARLY DESCRIBED AS FOLLOWS: BEGINNING AT THE NORTHEAST CORNER OF TAX LOT 85 IN SAID SECTION 5, T 17 N, R 11 E, AS SAID TAX LOT WAS SURVEYED BY R.L. HANSEN, LS-382, AND DATED DECEMBER 12, 1990; THENCE N 56°46'24" E (ASSUMED BEARING) ALONG THE SOUTHERLY RIGHT-OF-WAY LINE OF FIRST STREET IN KENNARD, NEBRASKA, AS SAID STREET IS PLATTED AND RECORDED, A DISTANCE OF 290.25 FEET TO A POINT OF CURVATURE; THENCE ALONG A 17013.76 FOOT RADIUS CURVE TO THE LEFT AN ARC DISTANCE OF 443.51 FEET, SAID CURVE HAVING A CHORD BEARING OF N 56°35'45"E AND A CHORD DISTANCE OF 443.50 FEET, TO THE NORTHWEST CORNER OF TAX LOT 83 AS SAID TAX LOT WAS SURVEYED BY W.G. KIRK, LS-310, AND DATED OCTOBER 30, 1990; THENCE S 34°24'43" E ALONG THE WESTERLY LINE OF SAID TAX LOT 83 A DISTANCE OF 125.00 FEET TO A POINT ON THE NORTHERLY RIGHT-OF-WAY LINE OF THE CHICAGO & NORTHWESTERN RAILROAD; THENCE SOUTHWESTERLY ALONG SAID NORTHERLY RAILROAD R.O.W. LINE ALONG A 17138.76 FOOT RADIUS CURVE TO THE RIGHT, AN ARC DISTANCE OF 447.34 FEET TO THE POINT OF TANGENCY OF SAID CURVE, SAID CURVE HAVING A CHORD BEARING OF S 56°35'42" W AND A CHORD DISTANCE OF 447.32 FEET; THENCE CONTINUING ALONG SAID NORTHERLY RAILROAD R.O.W. LINE S 56°44'26" W A DISTANCE OF 289.76 FEET TO THE SOUTHEAST CORNER OF SAID TAX LOT 85; THENCE N 32°52'53" W ALONG THE EAST LINE OF SAID TAX LOT 85 A DISTANCE OF 125.16 FEET TO THE POINT OF BEGINNING; AND CONTAINING 2.11 ACRES, MORE OR LESS.

THIRD ST

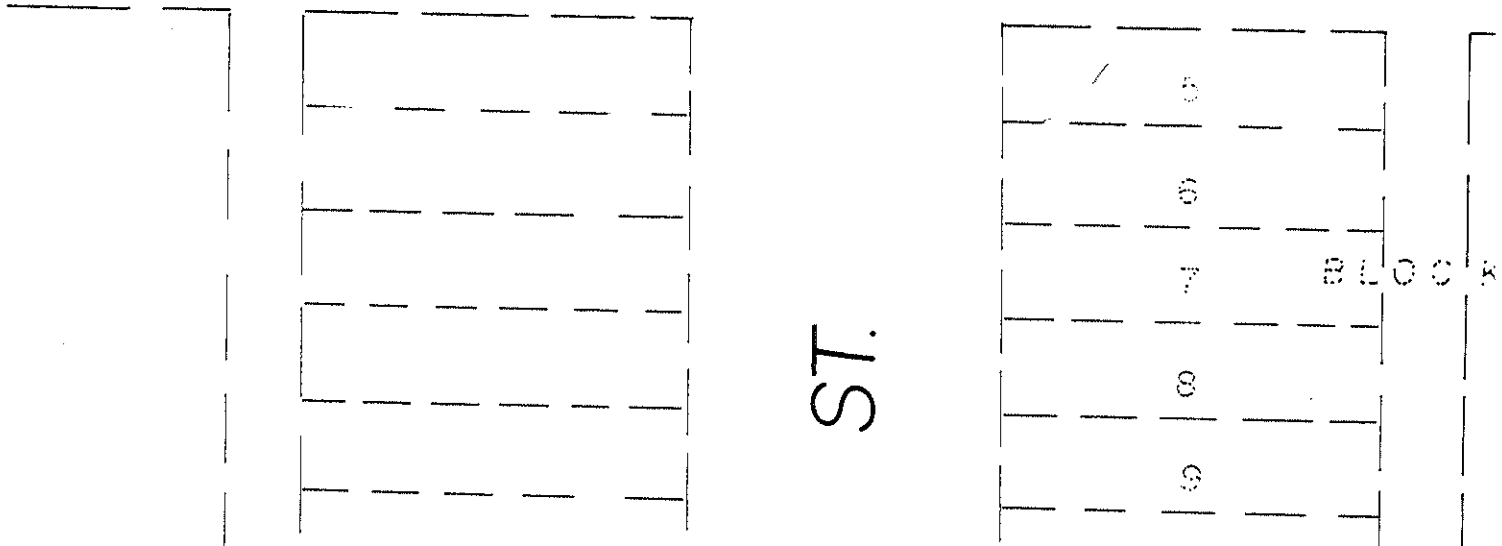

D E D I C A T I O N :

KNOW ALL MEN BY THESE PRESENTS THAT  
President of Lauritsen Grain and  
Corporation, and being the Owner  
shown and described hereon, has ca  
divided into lots numbered as show  
to be known as "Lauritsen Subdivi  
does hereby dedicate to the public  
road right-of-way as shown hereon;  
of land is made with free consent  
desire of the Owner.

IN WITNESS WHEREOF: said Owner ha  
be signed this 4<sup>th</sup> day of Me

OWNER: Lau

BY: Byron  
Byron

ACKNOWLEDGEMENT:

STATE OF NEBRASKA)  
WASHINGTON COUNTY) ss

On this 4<sup>th</sup> day of Me  
before me, a General Notary Public  
personally appeared Byron D. Lau  
Lauritsen Grain & Storage Inc., a  
who is known to me to be the iden  
the foregoing Dedication and who  
of the foregoing instrument to be

WITNESS my hand and official seal  
last aforesaid.

GENERAL

S U R V E Y O R ' S C E R T I F I C A T I O N :

I, the undersigned Registered Land Surveyor,  
hereby certify that I have accurately surveyed  
the plat of "Lauritsen Subdivision", as shown  
and described hereon, and have set or found  
iron pins on the corners of all lots in said  
subdivision. I further certify that I am a  
duly Registered Land Surveyor under the laws of  
the State of Nebraska.

My Commission Expires: \_\_\_\_\_

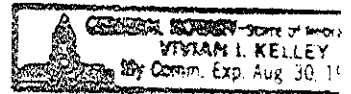

Richard L. Hansen

RICHARD L. HANSEN  
REGISTERED LAND SURVEYOR  
REGISTRATION NO. LS-382  
DATE: APRIL 13, 1992  
CLIENT: BYRON LAURITSEN

AUG 9 2

REVISED: July 22, 1992

Correction in line 11 of legal description only.  
SE Corner of T.L. 83 corrected to NW Corner.

