

COMPARED

18227

INST # _____
RECORDING FEE No Fee
AUDITOR FEE _____
RMA FF" _____ ECOM _____

FILED FOR RECORD
POTTAWATTAMIE CO. IA.

04 FEB 10 AM 10:00

JOHN SCIORTINO
RECORDER

Prepared by: Pottawattamie County, Planning and Development, 223 South 6th Street, Council Bluffs, Iowa 51501 (712) 328-5792
Return to: Pottawattamie County, Planning and Development, 223 South 6th Street, Council Bluffs, Iowa 51501 (712) 328-5792

**POTTAWATTAMIE COUNTY, IOWA
ORDINANCE NO. 2004-02**

AN ORDINANCE to amend the Official Zoning Map of Pottawattamie County, Iowa, by changing the district designation of approximately 63.26 acres from a Class A-2 (Exclusive Agricultural) District to a R-1 (Rural Residential) District.

BE IT ORDAINED BY THE BOARD OF SUPERVISORS OF POTTAWATTAMIE COUNTY, IOWA

SECTION 1 - AMENDMENTS: That the Official Zoning Map, as adopted by reference in Section 8.003.020 of the Pottawattamie County, Iowa, Zoning Ordinance, be and the same is hereby amended by changing the district designation from its present designation of a Class A-2 (Exclusive Agricultural) District to a R-1 (Rural Residential) District of certain real estate, as shown on the attached plat and which is legally described as follows:

S1/2 SW1/4, Section 6, Township 74N, Range 42W of the 5th P.M.

SECTION 2 - SEVERABILITY: That should any section or provision of this Ordinance be declared by a court of competent jurisdiction to be invalid, that decision shall not effect that validity of the Ordinance as a whole or any part thereof, other than the part so declared to be invalid.

SECTION 3 - REPEAL OF CONFLICTING ORDINANCES: That all ordinance or parts of ordinances in conflict with the provisions of this Ordinance are hereby repealed.

SECTION 4 - EFFECTIVE DATE: This Ordinance shall be in full force and effect after its passage, approval and publication as provided by law.

PASSED AND APPROVED January 26, 2004.

Delbert King, Chairman

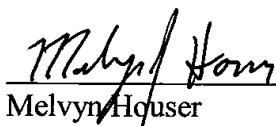
Melvyn Houser

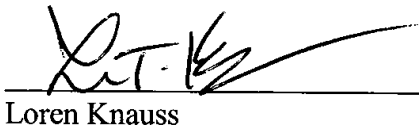
Loren Knauss

	ROLL CALL VOTE			
	AYE	NAY	ABSTAIN	ABSENT
Delbert King, Chairman	●	○	○	○
Melvyn Houser	●	○	○	○
Loren Knauss	●	○	○	○

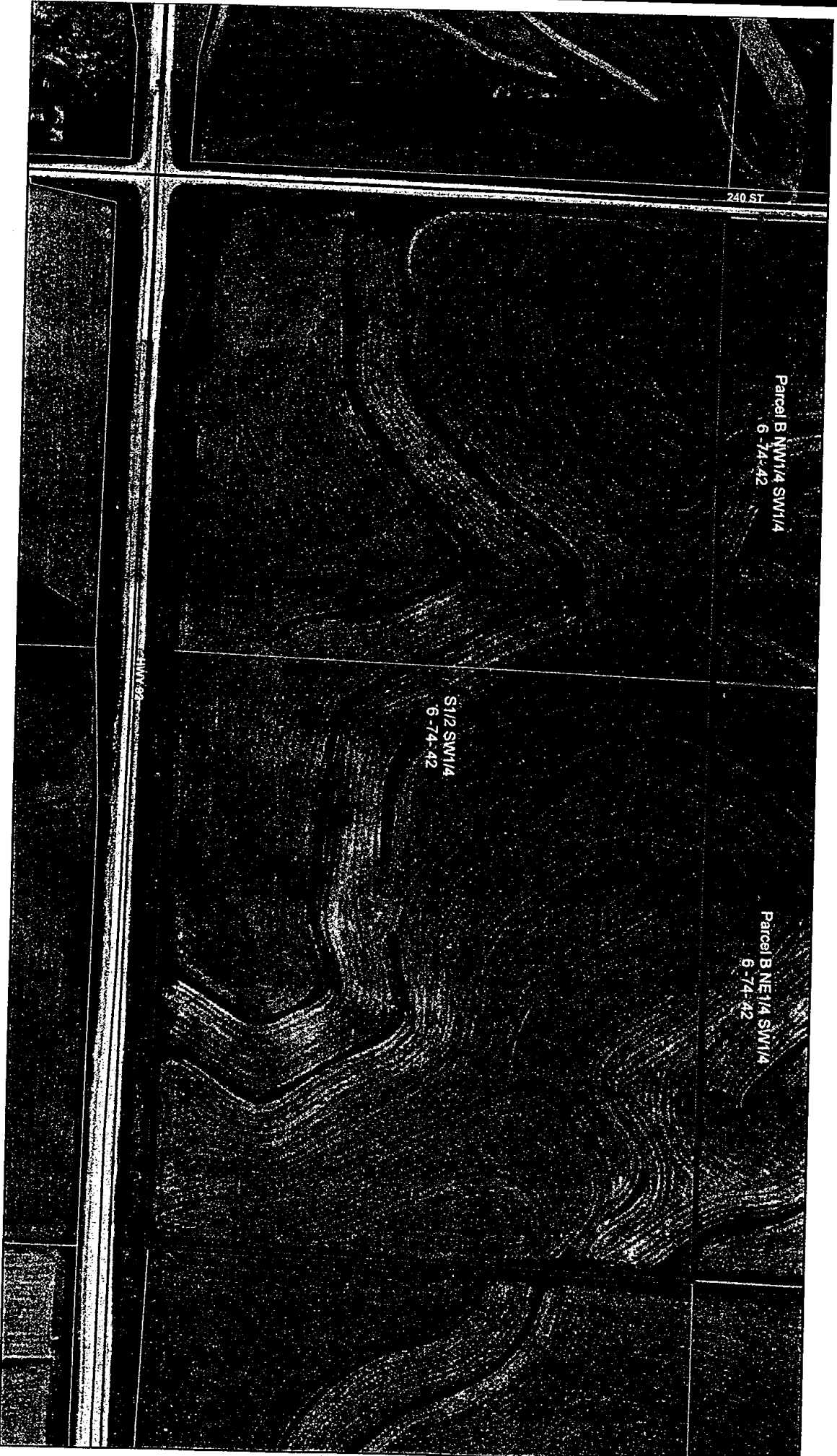

240 ST

Parcel B NW1/4 SW1/4
6-74-42

S1/2 SW1/4
6-74-42

Parcel B NE1/4 SW1/4
6-74-42

Zoning Map Amendment Map

Property Owner: Martha McKivern

Sally Sandblom

Hearthstone Estates, Inc.

6 Key Creek

Applicant:
Township:
Section/Sub:

A-2 to R-1

Zoning:

1-26-04

