

CAHN, METCALF & FARWELL'S

SUBDIVISION

Scale: 200 feet = one inch.

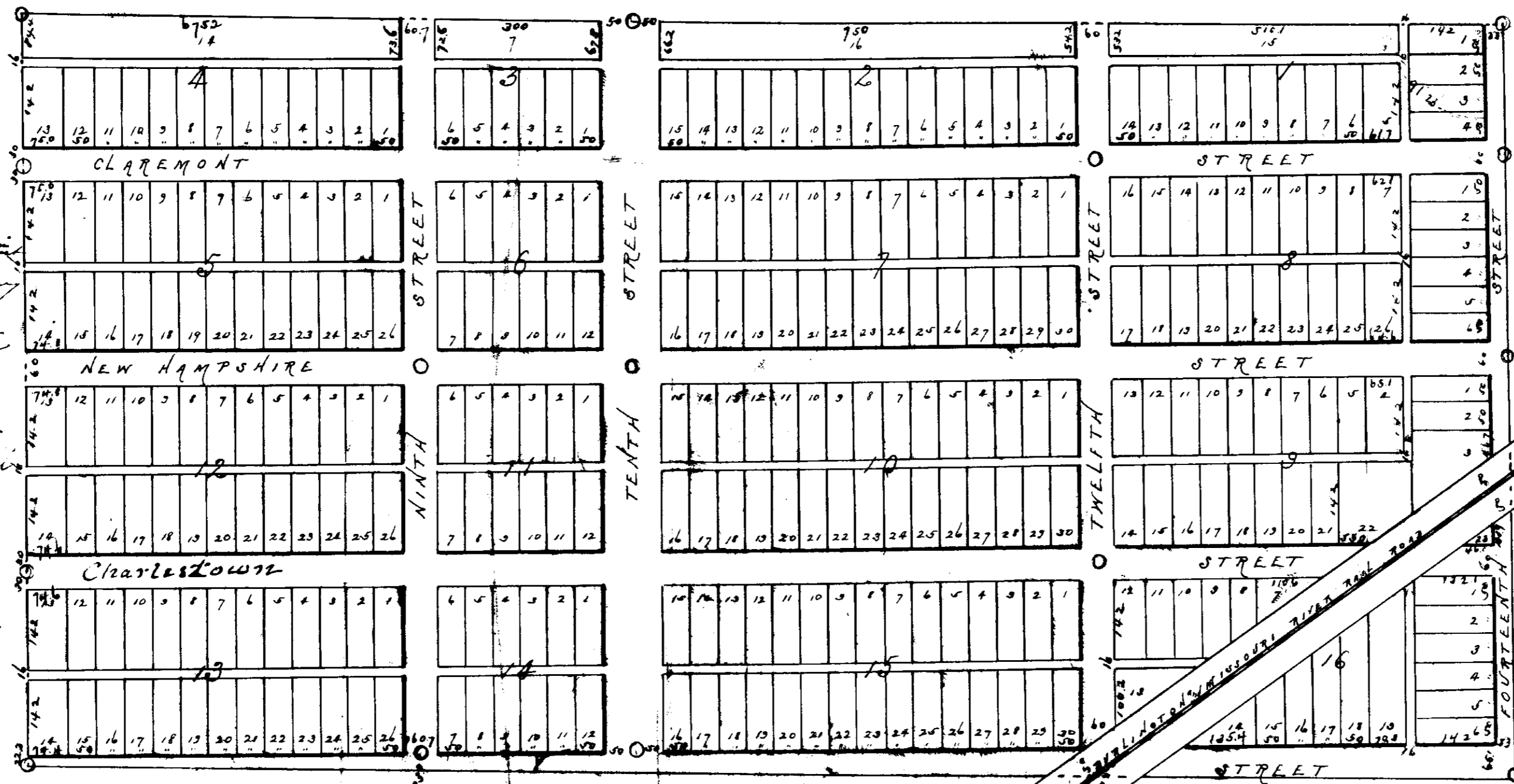
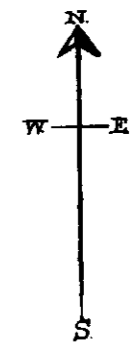

LEGEND:
 CAHN, METCALF & FARWELL'S
 SUBDIVISION comprises all of the North
 half of the NE 1/4 of Section 20, T. 10 N. R. 6 E. of
 the 6th P.M. Lancaster Co. Neb.
 Tenth Street is 100 feet wide being a contin-
 uation of Tenth Street in Lincoln.
 Ninth Street is 67 feet wide. The distance
 from center line of 9th Street to monu-
 ment in center of 9th St. in North Lin-
 coln being 4107 feet. CHARLESTOWN
 Claremont, New Hampshire, & 12th Streets
 are each 60 feet wide.
 11th Street has dimensions as marked on the
 plat the North line of 11th Street being 313
 feet North of monument at center of 11th St
 streets in North Lincoln.
 Fourteenth Street is 55 feet wide & is paral-
 lel to East line of 7th of the NE 1/4 of section
 20.
 All street lines are parallel to or at right
 angles with the center line of 11th Street
 in Lincoln, except 12th Street & the south
 line of 11th Street.
 All alleys are 16 feet wide.
 All lots are subject to 142 feet except
 fractional lots on the North West
 boundaries of this subdivision, lots
 adjoining the right of way of the B. & O.
 M. & N. R. R. Lots 19 & 20 in Block 1, lots 7 & 8
 in Block 8, lots 19 & 20 in Block 9, lot
 19 in Block 16 which have dimensions
 as indicated on the plat.
 Stones with drill hole are set at points
 marked thus O
 Oak stakes are set at all lot corners
 on the block lines except all lot cor-
 ners between the South West corner of lot
 4 in the South West corner of lot 1 in
 Block 2, the North West corner of lot
 16 in Block 2, all lot corners between
 the North West corner of lot 1 & the North
 West corner of lot 16 in Block 7, corners
 on the south end of lots 1 & 10 Block 6 &
 the South West corner of lot 11 Block 14
 Nov. 16, 1886.
 W. H. Patton Co. Surveyors
 By Anna Johnson Deputy

The foregoing subdivision of the
 North half of the North East quarter
 of Section 20 T. 10 N. R. 6 E. of the 6th P.M.
 Lancaster Co. Neb. as appears on this
 plat, is with the free consent and in
 accordance with the desire of the un-
 assigned owners and proprietors.
 Signed this 30th day of
 June 1886
 In presence of
 O. C. Bell
 Anna Metcalf
 Julia Metcalf
 Julia Metcalf
 Julia Metcalf
 Julia Metcalf

The State of Nebraska
 County of Lancaster }
 On this 30th
 day of November 1886 before
 me J. J. Greenwood
 a Notary Public duly commissioned
 and qualified for and residing in
 said county, personally came
 Julia Metcalf and Julia B
 Metcalf
 his wife
 to me known to be the identical per-
 sons who executed the foregoing plat
 and acknowledged the said instru-
 ment to be their voluntary act and
 deed.
 Witness my hand and Notarial Seal
 in said County and State, the day and
 year last above written.
 J. J. Greenwood
 Notary Public

The State of New Hampshire
 County of Sullivan }
 On this 30th
 day of November 1886
 before me J. J. Greenwood
 a Notary Public duly commissioned
 and qualified for and residing in
 said County, personally came
 W. L. Fuwelle and Murtia
 C. Fuwelle
 his wife
 to me known to be the identical per-
 sons who executed the foregoing plat
 and acknowledged the said instru-
 ment to be their voluntary act and
 deed.
 Witness my hand and Notarial Seal
 in said County and State, the day and
 year last above written.

State of Nebraska
 Lancaster County }
 On this
 day of January 1886
 before me O. C. Bell
 a Notary Public duly commissioned
 and qualified for and residing in said
 County, personally came Isaac Cahn
 and Thos. Metcalf & his wife
 to me known to be the ident-
 ical persons who executed the foregoing
 plat and acknowledged the said in-
 strument to be their voluntary act and
 deed.
 Witness my hand and Notarial Seal
 in said County and State, the day and
 year last above written.
 O. C. Bell
 Notary Public

