

144-79

KNOW ALL MEN BY THESE PRESENTS

THAT I or We, MACKEDON, LTD., a limited partnership organized under Nebraska law,

herein called the grantor whether one or more,

in consideration of One and No/100 Dollars (\$1.00)

received from grantee do hereby grant, bargain, sell, convey and confirm unto

CAMPBELL SOUP COMPANY, a corporation

herein called the grantee whether one or more, the following described real property in

Sarpy County, Nebraska

Those tracts of land in the Southeast Quarter (SE1/4) of Section Seventeen (17), Township Fourteen (14) North, Range Twelve (12) East of the 6th P.M., described on Exhibits A and C, and as shown on the attached plat as parcels A and C, all of which are attached hereto, and by this reference made a part hereof, subject, however, to all rights of way and easements now of record, and as existing on the premises.

To have and to hold the above described premises together with all tenements, hereditaments and appurtenances therein belonging unto the grantee and to grantee's heirs and assigns forever.

And the grantor does hereby covenant with the grantee and with grantee's heirs and assigns that grantor is lawfully seised of said premises; that they are free from encumbrance;

that grantor has good right and lawful authority to convey the same; and that grantor warrants and will defend the title to said premises against the lawful claims of all persons whomsoever.

Dated December 12, 1969

NEBRASKA DEEDS INDEX SEARCHED

DEC 31 1969

BY [Signature]

MACKEDON, LTD.

By: Keith Miller

Chester A. McCurdy

Its General Partners

STATE OF NEBRASKA County of DOUGLAS

Before me, a notary public qualified for said county, personally came

KEITH MILLER and CHESTER A. McCURDY, General Partners of Mackedon, Ltd., a limited partnership,

known to me to be the identical person or persons who signed the foregoing instrument and acknowledged the execution thereof to be his, her or their voluntary act and deed.

Witness my hand and notarial seal on December 12, 1969



[Signature] Notary Public My commission expires 12/31/70

STATE OF NEBRASKA

County of DOUGLAS

Entered on numerical index and filed for record in the Register of Deeds of said County the day of December 1969 at o'clock and minutes M.

and recorded in Book of said County at page

INDEXED IN BOOK 144 of Deeds page 77

By [Signature] Deputy

DEED 1 4 4

144-90

LEGAL DESCRIPTION
PARCEL "A"

For a tract of land in the SE 1/4 of Section 17, T14N, R12E, of the 6th P.M.,
Sarpy County, Nebraska, lying North of the C. B. & Q. R.R. R.O.W. described
as follows:

Beginning at the E 1/4 corner of said Section 17, thence S 00° 51' 20" E for
a distance of 394.94 feet to a point on the East line of said SE 1/4; thence
N 50° 41' 50" W for a distance of 344.74 feet to a point of curve; thence along
a curve to the left, an arc length of 251.33 feet to a point of tangency; thence
N 60° 22' 00" W for a distance of 151.07 feet to a point on the North line of
said SE 1/4; thence N 90° 00' 00" E along said North line of said SE 1/4 for
a distance of 631.60 feet to the point of beginning, containing 2.772 acres,
more or less.

The above description includes the easterly 33.00 feet of said tract presently
dedicated as R.O.W. for 108th Street.

*Kim
Rus*

EXHIBIT "A"

DEED 1 4 4

144-81

LEGAL DESCRIPTION
PARCEL "C"

For a tract of land in the SE 1/4 of Section 17, T14N, R12E of the 6th P.M.,
Sarpy County, Nebraska, lying North of the C.B. & Q. R.R. R.O.W. described
as follows:

Beginning at the center of Section 17, T14N, R12E, thence N90°-00'-00" E for
a distance of 177.58 feet to a point; thence S60°-22'-00" E for a distance of
300.01 feet to a point on the North R.O.W. line of the C. B. & Q. R.R.; thence
along the Northerly curved R.O.W. line of said C. B. & Q. R.R. on a curve to the
left, an arc length of 419.27 feet to a point of compound curvature; thence contin-
uing on a curve to the left, an arc length of 1601.63 feet to a point; thence
N00°-07'-15" W for a distance of 254.11 feet to the point of beginning, contain-
ing 3.409 acres, more or less.

RB

EXHIBIT "C"

DEED 1 4 4

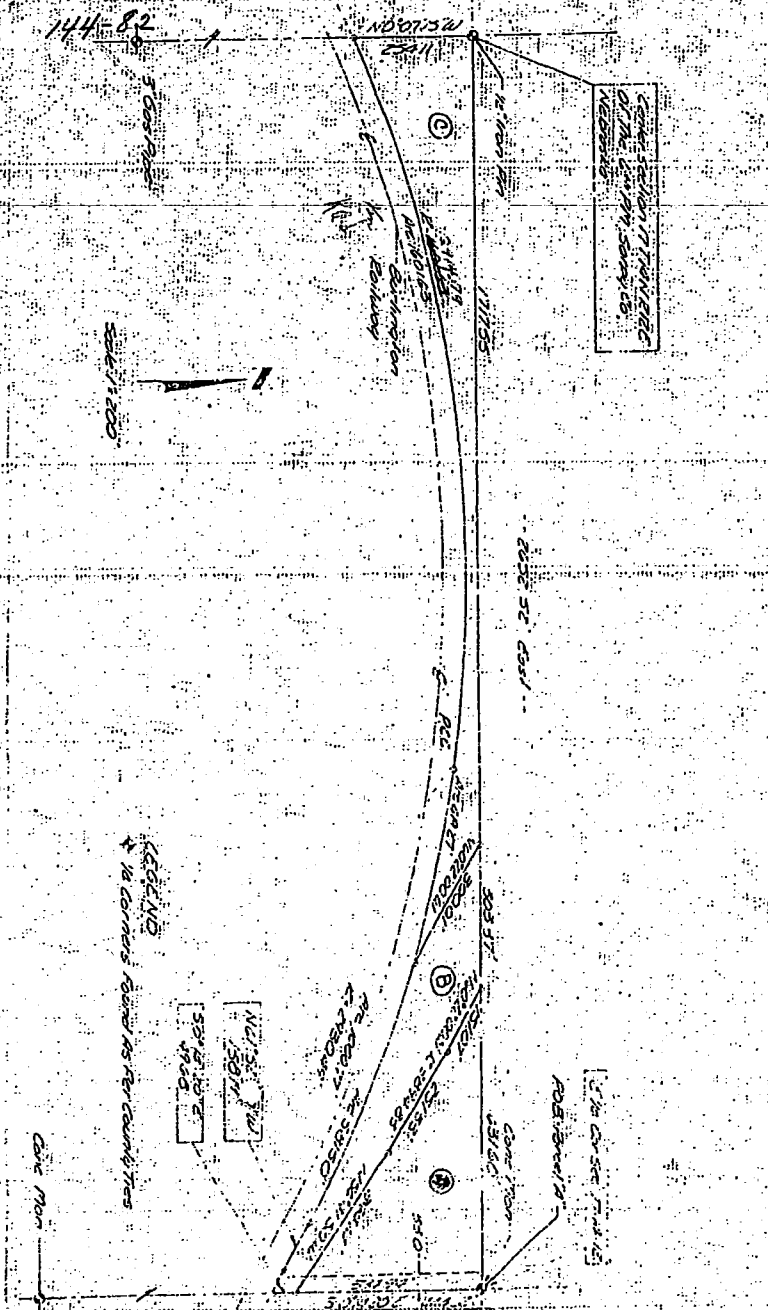

DEED 1 4 4