



BK 1431 PG 053-062

SHARD N. TAKECHI
REGISTER OF DEEDS
DODDAS COUNTY, NE

2002 MAR 26 AM 10:36

RECEIVED



MISC 2002 06805

THIS PAGE INCLUDED FOR INDEXING
PAGE DOWN FOR BALANCE OF INSTRUMENT

misc
10
59

✓

FEE 79.50 FB See back
 BKP _____ C/O _____ COMP 3/2
 DEL _____ SCAN CR FV _____

Temp. 12.4.01

RETURN: MARK Co.lds
22243 HOMESTEAD Rd
Elkhorn NE 68022
 1072

SEVENTH AMENDMENT TO PROTECTIVE COVENANTS

The undersigned, being owners of real estate located in The Farm, a subdivision in Douglas County, Nebraska, as surveyed, platted and recorded, and more particularly described on Exhibit "A" attached hereto and incorporated herein by reference, do hereby state, publish and declare that the real estate contained in platted areas of The Farm subdivision be owned, conveyed and used under and subject to the following change in covenant 8d. There is no change in any other covenants, conditions, restrictions and easements.

8d. Exterior Details. The roofs of residential dwellings and outbuildings shall have wood or 40 year Celotex Presidential Shake AR weathered wood fiberglass composition shingles. (If for any reason 40 year Celotex Presidential Shake AR weathered wood fiberglass composition shingles are not available, the Protective Covenants Compliance Committee shall select a suitable substitute 40 year composite shingle in weathered wood appearance and color.) Exposed portions of the foundation on the front, sides and rear of each dwelling and outbuilding are to be covered with either siding or clay-fired brick, or stucco painted to match the exterior siding color. All exposed portions of fireplace chimneys shall be faced with clay-fired brick or stone. Exterior colors used in new construction or in improvements such as periodic repainting shall be neutral or earth tones.

Dated this 21 day of October, 2001.

Stephen F. Kellanz David E. Miller
STEPHEN F. KELLANZ DAVID E. MILLER
Lot # 29 Lot # 51 Replat # 2

Thomas E. Harkey Mark W. Guilds
THOMAS E. HARKEY MARK W. GUILDS
Lot # 34 Lot # 55 REPLAT 2

Larry K. Miller Michael E. Washburn
LARRY K. MILLER MICHAEL E. WASHBURN
Lot # 23 Lot # 56 REPLAT 2

Stein Hordvik
STEIN-INGE HORDVIK
Lot # 13

Gregory Kneifel
GREGORY KNEIFL
Lot # 2 R 5

Joan C. Hackett
JOAN C. HACKETT
Lot # 35

Patti Boyle
PATTI A. BOYLE
Lot # 50 R 2

Joan C. Hackett
JOAN C. HACKETT
Lot # 36

Brian Engel
BRIAN K. ENGEL
Lot # 16

Theresa Manahan
THERESA M. MANAHAN
Lot # 19

Michael E. Meeks
MICHAEL E. MEEKS
Lot # 15

Robert Luellen
ROBERT LUELLEN
Lot # 79 48 R 2

Patricia L. Sheldon
PATRICIA L. SHELDON
Lot # 10

Thomas A. Shaver
THOMAS A. SHAVER
Lot # 49 R 2

William K. Lake
WILLIAM K. LAKE
Lot # 22

C. Craig Bennett
C. CRAIG BENNETT
Lot # 53 R 2

Beverly Timending
Lot # 48
BEVERLY TIMERDING

Thomas H. Rosenquist
THOMAS H. ROSENQUIST
Lot # 37

Beverly Timending
Lot # 5
BEVERLY TIMERDING

Mark T. Boschoet
MARK T. BOSCHOET
Lot # 5R6

John W. Utrie
JOHN W. UTRIE
Lot # 33

Brian Broderick
BRIAN BRODERICK
Lot # 1

Donald R. Kaiser
DONALD R. KAISER
Lot # 31

Marcia D. Heywood
MARCIA D. HEYWOOD
Lot # 54 R2

Margaret L. Bullock
MARGARET L. BULLOCK
Lot # 27

James M. McCoy
JAMES M. MCCOY
Lot # 47 R2

Carl A. Bartenhagen
CARL A. BARTENHAGEN
Lot # #24

Edward J. Weber
EDWARD J. WEBER
Lot # 57 R2

John G. Lynch
JOHN G. LYNCH
Lot # #9

Pat Dahm
NOT PART of COVENANTS
PATRICIA R. DAHMKE
Lot # 2

John C. Flor
JOHN C. FLOR
Lot # 43 R2

Karen L. Hodges
KAREN L. HODGES
Lot # #11

Bob Nebe
ROBERT A. NEBE
Lot # 45 R2

Larry G. Poindexter
LARRY G. POINDEXTER
Lot # 20

Bob Karasek
ROBERT L. KARASEK
Lot # 17

Pam Wood
PAMELA J. WOOD
Lot # 1R5

Robert P. Johnston
ROBERT P. JOHNSTON
Lot # 14

Don Peers
DONALD R PEERS
Lot # 18

Gary H. Perkins
GARY H. PERKINS
Lot # 44 R2

Michael A. Hedge
MICHAEL A. HEDGE
Lot # 30

Michael F. Benson
MICHAEL F. BENSON
Lot # 21

Leroy Roberts
LEROY ROBERTS
Lot # 2-R4

Albert J. Wees
ALBERT J. WEES
Lot # 46 R2

David L. Miller
DAVID L. MILLER
Lot # 51 Replat #2

Stan M. Bartz

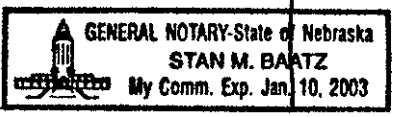

Lot # _____

Lot # _____

Lot # _____

Lot # _____

Lot # _____

Lot # _____

Lot # _____

STATE OF NEBRASKA)
) ss.
 COUNTY OF DOUGLAS)

On this 21st day of October, 2001, before me, the undersigned, a Notary Public, duly commissioned and qualified for and in said County, personally came the aforesigned individuals to me known to be the identical persons whose names are affixed to the foregoing Seventh Amendment to Protective Covenants and acknowledge the execution thereof to be their voluntary act and deed.

Stephen F. Pflanz	Thomas E. Harvey	Larry K. Miller	Mark W. Guilds
Michael C. Washburn	Stein-Inge Hordvik	Joan C. Hackett 35	Joan C. Hackett 36
Theresa M. Manahan	Robert Luellen	Thomas A. Shaver	C. Craig Piennentt
Thomas H. Rosenquist	Gregory Kneifl	Patti A. Boyle	Brian K. Engel
Michael E. Meeks	Patricia L. Sheldon	William K. Lake	

Witnessed my hand and notarial seal the day and year last above written.

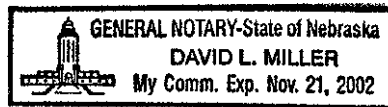

[Signature]
 Notary Public

On this 31st day of October, 2001, before me, the undersigned, a Notary Public, duly commissioned and qualified for and in said County, personally came the aforesigned individuals to me known to be the identical persons whose names are affixed to the foregoing Seventh Amendment to Protective Covenants and acknowledge the execution thereof to be their voluntary act and deed.

Beverly Timerding 4	Karen L. Hodges	John C. Flor	Michael A. Hedge
Beverly Timerding 5	Larry G Poindexter	Robert A. Nebe	Michael F. Benson
Mark T. Boschult	John W. Utrie	Robert L. Karasek	Leroy Roberts
Brian Broderick	Donald R. Kaiser	Pamela J. Wood	Alert J. Wees
Marcia Heywood	Margaret L. Bullock	Robert P. Johnston	
James M. McCoy	Carl A. Bartenhagen	Donald R. Peers	
Edward J. Weber	John G. Lynch	Gary A. Perkins	

Witnessed my hand and notarial seal the day and year last above written.

STATE of NEBRASKA)
) ss.
 County of Douglas)

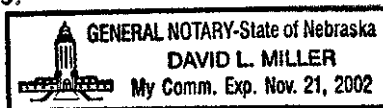

[Signature]
 Notary Public

EXHIBIT "A"

The Farm is a subdivision in Douglas County Nebraska covering real property as surveyed, platted and described in pertinent documents filed and recorded in the following books and pages at the Douglas County Office of the Register of Deeds:

<u>DOCUMENT</u>	<u>BOOK</u>	<u>PAGE</u>
The Farm	1573	720
The Farm Replat I	1774	7
The Farm Replat II	1776	285
The Farm Replat III	1813	528
The Farm Replat IV	1826	672
The Farm Replat V	1862	538
The Farm Replat VI	1839	696
The Farm Vacation	749	296

Seventh Amendment to Protective Covenants applies to the lots listed below:

<i>CC-11910</i>	The Farm:	1, 2 , 1 , 3 , 9, 10, 11, 12, 13, 14, 15, 16, 17, 18, 19, 20, 21, 22, 23, 24, 25, 26, 27, 28, 29, 30, 31, 32, 33, 34, 35, 36, 37
	The Farm Replat I	Outlet 1
<i>CC-11917</i>	The Farm Replat II	41, 42, 43, 44, 45, 46, 47, 48, 49, 50, 51 , 52 , 53, 54, 55, 56, 57
<i>CC-11918</i>	The Farm Replat III	1 , Outlet 1
<i>CC-11919</i>	The Farm Replat IV	1, 2
<i>CC-11916</i>	The Farm Replat V	1, 2
<i>CC-11913</i>	The Farm Replat VI	1, 2, 3, 4, 5
<i>CC-11921</i>	The Farm Replat 8 LTS	1, 2
<i>CC-11914</i>	The Farm Replat 7 LTS	1, 2 6

*Print names
 adjacent to story
 labels with #*

The Farm

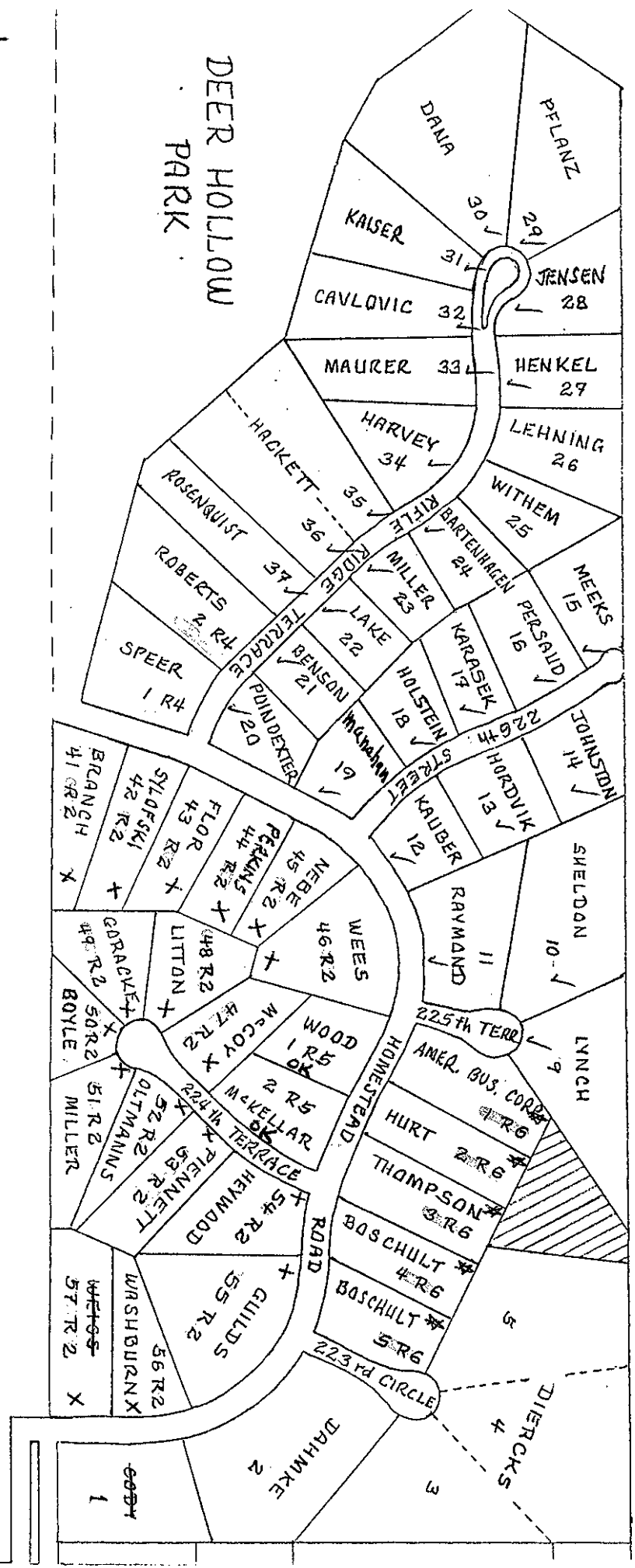

SID No. 277 Resident Homeowners

16-Jan-02

ACCT	LAST NAME	FIRST NAME	SPOUSE NAME	STREET ADDRESS	TELEPHONE	LOT NBRS
024	Barthenhagen	Carl A.	Evelyn D.	22746 Rifle Ridge Terrace	(402) 332-4150	24
021	Benson	Michael F.	Peggy	22716 Rifle Ridge Terrace	(402) 332-4706	21
012	Bolamperti	Matthew P.	Mary J.	3939 So. 226 Terrace	(402) 332-2616	12
605	Boschult	Mark T.	Gail	22306 Homestead Road	(402) 332-5685	05 Replat 6
250	Boyle	Ned F.	Patti A.	4041 So. 224 Terrace	(402) 332-4835	50 Replat 2
001	Broderick	Brian	Cheryl	22224 Homestead Road	(402) 332-0050	01, Outlot 1
252	Broekemeier	David A.	Robin	4025 So. 224 Terrace	(402) 332-5418	52 Replat 2
027	Bullock	John B.	Margaret L.	22816 Rifle Ridge Terrace	(402) 332-5385	27
032	Cavlovic	Francis J.	Linda K.	22821 Rifle Ridge Terrace	(402) 332-3564	32
002	Dahmke	Patricia L.		3926 So. 222 Street	(402) 332-3554	02, Replat 3
604	Denham	Tom C.	Janet R.	22318 Homestead Road	(402) 332-2620	04 Replat 6
016	Engel	Brian K.	Cynthia S.	3910 So. 226 Terrace	(402) 332-5019	16
243	Flor	John C.	Susan P.	22631 Homestead Road	(402) 332-3648	43 Replat 2
004	Gant	John	Beverly	3905 S. 223 Circle	(402) 916-9000	03, 04
255	Guilds	Mark W.	Maureen (Mo)	22243 Homestead Road	(402) 332-5650	55 Replat 2
035	Hackett	Charles D.	Joan C.	22735 Rifle Ridge Terrace	(402) 332-4460	35, 36
241	Haman	Vince	Sue	22649 Homestead Road	(402) 332-5105	41 Replat 2
034	Harvey	Thomas E.	Sallyann	22805 Rifle Ridge Terrace	(402) 332-3506	34
030	Hedger	Michael	Michelle	22833 Rifle Ridge Terrace	(402) 332-0111	30
601	Henkel	Larry R.	Loree J.	22428 Homestead Road	(402) 332-4430	01 Replat 6
254	Heywood	Michael D.	Marcia D.	22311 Homestead Road	(402) 332-3030	54 Replat 2
011	Hodges	Robert L.	Karen Lynn	3920 So. 225 Terrace	(402) 332-3065	11
013	Hordvik	Nancy L.	Stein-Inge	3925 So. 226 Terrace	(402) 332-5840	13
602	Hurt	Vern E.	Linda H.	22416 Homestead Road	(402) 332-4284	02 Replat 6
028	Jensen	William R.	Mary Ann	22822 Rifle Ridge Terrace	(402) 332-5516	28
603	Johnson	Ken L.	Ann V.	22404 Homestead Road	(402) 332-2908	03 Replat 6
014	Johnston	Robert P.	Patricia L.	3911 So. 226 Terrace	(402) 332-3414	14
031	Kaiser	Donald R.	LuAnn E.	22827 Rifle Ridge Terrace	(402) 332-3935	31
017	Karasek	Robert L.	Cynthia E.	3918 So. 226 Terrace	(402) 332-4665	17
502	Kneifi	Gregory	Julie	4008 So. 224 Terrace	(402) 332-5293	02 Replat 5
022	Lake	William K.	Kathryn H.	22726 Rifle Ridge Terrace	(402) 332-4916	22
248	Luellen	Rob	Marietta	4034 So. 224 Terrace	(402) 332-9985	48 Replat 2
009	Lynch	John G.	Winona (Nonie)	3905 So. 225 Terrace	(402) 332-4477	09
019	Manahan	Michael G.	Theresa M.	22612 Homestead Road	(402) 332-5713	19
247	McCoy	James M.	Kathleen R.	4022 So. 224 Terrace	(402) 332-4551	47 Replat 2
015	Meeks	Michael E.	Karen E.	3904 So. 226 Terrace	(402) 332-5696	15
251	Miller	David L.	Angie	4035 So. 224 Terrace	(402) 332-4416	51 Replat 2
023	Miller	Larry K.	Judith Ann	22736 Rifle Ridge Terrace	(402) 332-4782	23
245	Nebe	Robert A.	Judy	22607 Homestead Road	(402) 332-3250	45 Replat 2
018	Peers	Donald R.	Jeanne A.	3928 So. 226 Terrace	(402) 332-5433	18
244	Perkins	Gary A.	Carol J.	22621 Homestead Road	(402) 332-5870	44 Replat 2
029	Pflanz	Stephen F.	Anona M.	22828 Rifle Ridge Terrace	(402) 332-3524	29
253	Piennett	C. Craig	M. B.	4015 So. 224 Terrace	(402) 332-3160	53 Replat 2
020	Poindexter	Larry G.	Suzanne D.	22706 Rifle Ridge Terrace	(402) 332-3841	20
402	Roberts	Leroy	Patricia A.	22717 Rifle Ridge Terrace	(402) 332-5811	02 Replat 4
037	Rosenquist	Thomas H.	Dianne	22723 Rifle Ridge Terrace	(402) 332-4323	37
249	Shaver	Thomas A.	Vicky L.	4040 So. 224 Terrace	(402) 332-5986	49 Replat 2
010	Sheldon, Jr.	Laurence F.	Patricia L.	3910 So. 225 Terrace	(402) 332-4622	10
401	Speer	Bradley K.	Louise A.	22705 Rifle Ridge Terrace	(402) 332-4324	01 Replat 4
242	Sylofski	Edward J.	Gerrie	22707 Homestead Road	(402) 332-4513	42 Replat 2
033	Utrie	John W.	Linda A.	22815 Rifle Ridge Terrace	(402) 332-5734	33
256	Washburn	Michael C.	Lori	22233 Homestead Road	(402) 332-5778	56 Replat 2
257	Weber	Edward J.	Linda M.	22223 Homestead Road	(402) 332-3357	57 Replat 2
246	Wees	Albert J.	Sharon (Shari)	22515 Homestead Road	(402) 332-3131	46 Replat 2
501	Wood	Jack R.	Pamela J.	22419 Homestead Road	(402) 332-4338	01 Replat 5

Total: 55

SID No. 277 Non-Resident Owners

16-Jan-02

<i>ACCT</i>	<i>LAST NAME</i>	<i>FIRST NAME</i>	<i>SPOUSE NAME</i>	<i>STREET ADDRESS</i>	<i>TELEPHONE</i>	<i>LOT NBRS</i>
025	Dixon	William J.	Mary Jo	3905 S. 223 Circle Elkhorn 68022	(402) 332-4226	25
026	Green	Leslie L.	Jean C.	1221 Skyline Drive Elkhorn 68022	(402) 289-3592	26
005	Stratman	Steven	Rhonda	S. 223rd Circle Elkhorn 68022		05

Total: 3