



BK 1400 PG 583-587



MISC 2001 15389

RICHARD N. TAKECHI
REGISTER OF DEEDS
DOUGLAS COUNTY, NE

01 SEP 27 PM 12:20

RECEIVED

EASEMENT AND RIGHT-OF-WAY

(PERMANENT AND TEMPORARY)

Misc F
5 4300
30 BKP C/G COMP
DEL SCAN FV

THIS INDENTURE, made this 24th day of September, 2001, between CELEBRITY HOMES, INC., a Nebraska Corporation, ("Grantor"), and METROPOLITAN UTILITIES DISTRICT OF OMAHA, a Municipal Corporation, ("Grantee"),

WITNESS:

That Grantor, in consideration of the sum of Two Dollars (\$2.00) and other valuable consideration, receipt of which is hereby acknowledged, does hereby grant to Metropolitan Utilities District of Omaha, its successors and assigns, permanent and temporary easement and right-of-way rights to lay, maintain, operate, repair, relay and remove, at any time, pipelines for the transportation of water and all appurtenances thereto, together with the right of ingress and egress on, over, under and through lands described as follows:

PERMANENT EASEMENT TRACTS

The northerly five feet (5') of each of Lots 353 through 364, inclusive, and the northerly five feet (5') of the easterly 14.31 feet of Lot 352, all in Coyote Run, a subdivision, as surveyed, platted and recorded in Douglas County, Nebraska. Said tracts, which contain a total of 0.071 of a acre, more or less are show on Exhibit "A", Page 2, attached hereto and made a part hereof by this reference.

TEMPORARY EASEMENT TRACTS

Portions of Lots 329 through 364, inclusive, of Coyote Run, a subdivision, as surveyed, platted and recorded in Douglas County, Nebraska, said tracts being further described and shown on Exhibit "A", Pages 1, 2 and 3, attached hereto and made a part hereof by this reference.

TO HAVE AND TO HOLD this Easement and Right-of-Way to Grantee, Metropolitan Utilities District of Omaha, its successors and assigns.

1. The Grantor and its successors and assigns shall not at any time erect, construct or place on or below the surface of the permanent easement tracts any building or other structure, except paving or similar covering, and shall not permit

Please return to:
MUD
R OWENS
1723 HARVEY
OMAHA 68102

8808

Temporary Water Main Easements
WCP 9135, WCP 9136, & WCP 9183 - 42", 36", & 24" Water Main at 192nd & "Q" St.

Tracts of land in Coyote Run, a subdivision, as platted and recorded in Douglas County, Nebraska and being described as follows:

TEMPORARY EASEMENTS

The southerly fifteen feet (15') of the northerly twenty feet (20') of Lots 353, 354, 355, 356, 357, 358, 359, 360, 361, 362, 363, and 364.

(PAGE 2)

These tracts contain 0.208 of an acre, more or less, and is shown on the drawing attached hereto and made a part hereof by this reference.

The southerly fifteen feet (15') of the northerly twenty feet (20') of the easterly fourteen and thirty-one one-hundredths feet (14.31'), and the northerly ten feet (10') of the westerly thirty-five and seventy one-hundredths feet (35.70') of Lot 352.

(PAGE 2)

These tracts contain 0.013 of an acre, more or less, and is shown on the drawing attached hereto and made a part hereof by this reference.

The northerly ten feet (10') of Lots 349, 350, and 351; and the westerly ten feet (10') of Lot 349.

(PAGE 2)

These tracts contain 0.062 of an acre, more or less, and is shown on the drawing attached hereto and made a part hereof by this reference.

The westerly ten feet (10') of Lots 346, 347, and 348.

(PAGE 3)

These tracts contain 0.059 of an acre, more or less, and is shown on the drawing attached hereto and made a part hereof by this reference.

The westerly ten feet (10') of the northerly twenty-six and eighty-six one-hundredths feet (26.86') and the westerly twenty feet (20') of the southerly twenty-three and forty-one one-hundredths feet (23.41') of Lot 345.

(PAGE 3)

These tracts contain 0.017 of an acre, more or less, and is shown on the drawing attached hereto and made a part hereof by this reference.

The westerly twenty feet (20') of Lots 329, 330, 331, 332, 333, 334, 335, 336, 337, 338, 339, 340, 341, 342, 343, and 344.

(PAGE 3)

These tracts contain 0.380 of an acre, more or less, and is shown on the drawing attached hereto and made a part hereof by this reference.

METROPOLITAN

**UTILITIES
DISTRICT**
OMAHA, NEBRASKA

**EASEMENT
ACQUISITION**

FOR
**WCP 9135, WCP 9136,
& WCP 9183**

LAND OWNER

Celebrity Townhomes, LLC
P.O. Box 390485
Omaha, Nebraska 68139-0485

TOTAL ACRE _____
PERMANENT 0.071 ±

TOTAL ACRE _____
TEMPORARY 0.283 ±

LEGEND



PERMANENT EASEMENT



TEMPORARY EASEMENT

PAGE 1 OF 2

DRAWN BY _____ DAS
DATE _____ 5-25-2001
CHECKED BY _____
DATE _____
APPROVED BY _____
DATE _____
REVISED BY _____
DATE _____
REV. CHK'D. BY _____
DATE _____
REV. APPROV. BY _____
DATE _____

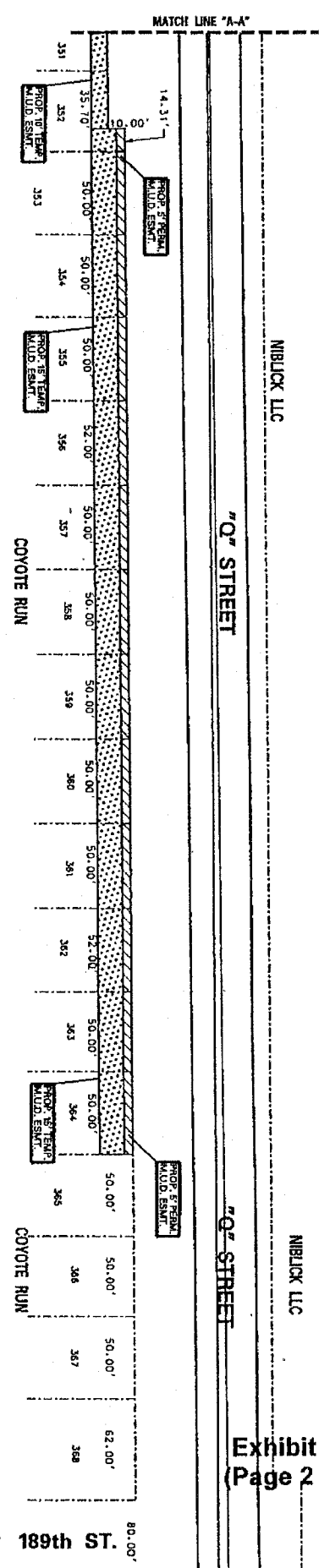
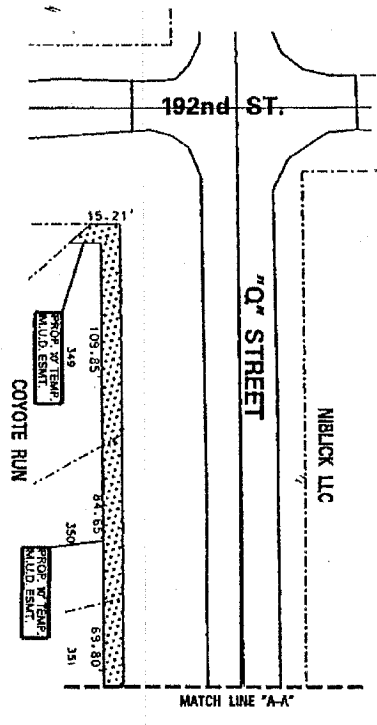

Exhibit "A"
(Page 2 of 3)



METROPOLITAN UTILITIES DISTRICT
OMAHA, NEBRASKA

EASEMENT ACQUISITION

FOR
**WCP 9135, WCP 9136,
 & WCP 9183**

LAND OWNER
 Celebrity Townhomes, LLC
 P.O. Box 390485
 Omaha, Nebraska 68139-0485

TOTAL ACRE 0.000 ±
PERMANENT _____
TOTAL ACRE 0.486 ±
TEMPORARY _____

LEGEND
 PERMANENT EASEMENT 
 TEMPORARY EASEMENT 

PAGE 2 **OF** 2

DRAWN BY DAS
DATE 5-25-2001
CHECKED BY _____
DATE _____
APPROVED BY _____
DATE _____
REUSED BY _____
DATE _____
REV. CHK'D. BY _____
DATE _____
REV. APPROV. BY _____
DATE _____

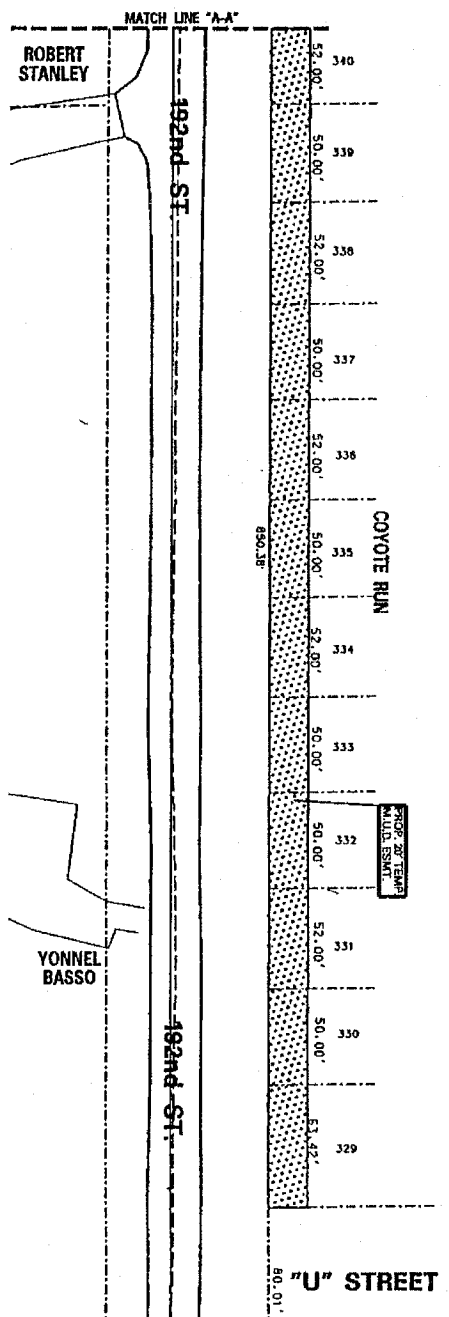
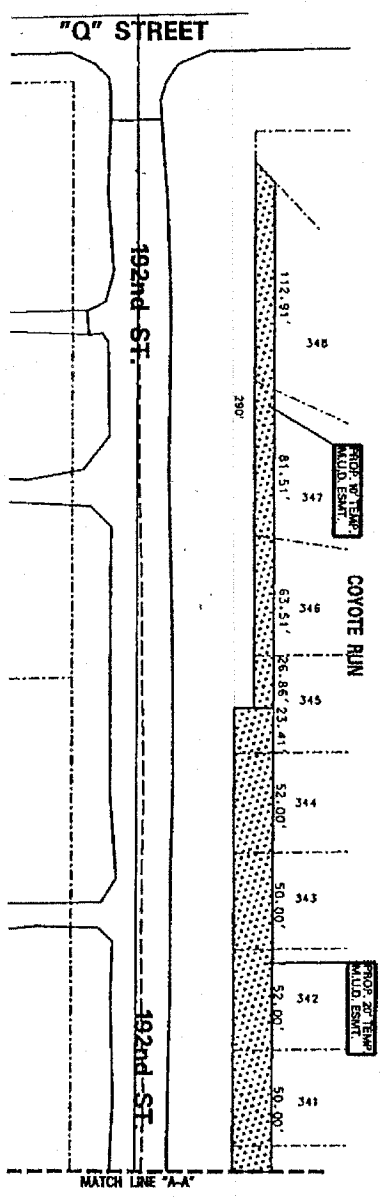

DAS

NO SCALE
 192nd & "Q" Streets

Exhibit "A"
(Page 3 of 3)