



BK 1383 PG 621-622



MISC 2001 07893

J. S.

RICHARD M. TAKECHI
REGISTER OF DEEDS
DOUGLAS COUNTY, NE.

2001 MAY 30 PM 1:54

RECEIVED

AFFIDAVIT OF CORRECTION

To correct the error in wording of the legal description of District Boundary of Douglas County S.I.D. No. 456 located in the NW 1/4 of Section 8, Township 14 North, Range 11 East of the 6th P.M., Douglas County, Nebraska.

The first line of the legal description to delete "and also together with the SW1/4 of Section 5; all located in".

AFFIDAVIT

Correction to District Boundary of Douglas County S.I.D. No. 456 located in the NW 1/4 of Section 8, Township 14 North, Range 11 East of the 6th P.M., Douglas County, Nebraska.

I, Robert Clark, do hereby submit the above affidavit of correction in order to correct the error in the text of the Legal Description of the District Boundary of Douglas County S.I.D. No. 456 located in Douglas County, Nebraska, as recorded in Miscellaneous Book No. 1351. Page Nos. 125 thru 128, of the Register of Deeds office, Douglas County, Nebraska.

I certify that I am the same (identical) person who prepared the District Boundary legal description of Douglas County S.I.D. No. 456 as dated, Revised 8-22-00.

Robert Clark

5-11-2001

Robert Clark, L.S. 419

Date

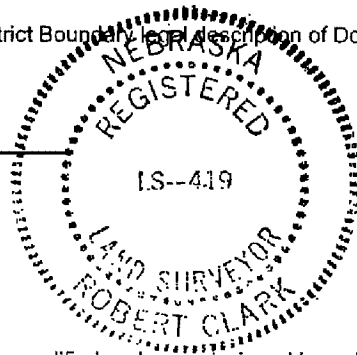

STATE OF NEBRASKA

COUNTY OF DOUGLAS

On the 11TH day of MAY, 2001, before me a Notary Public, qualified and commissioned in and for said County, personally appeared Robert Clark, who is personally known to me to be the same and identical person whose name is affixed to the above Affidavit, and he acknowledged the signing thereof to be his voluntary act and deed.

Witness my hand and official seal at Omaha, Nebraska, on the date last aforesaid.

Commission Expires:

4.30.03 *Homer R. Hunt*

NOTARY PUBLIC

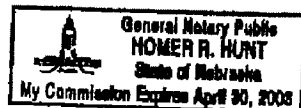

E & A Consulting Group, Inc.
12001 "Q" Street
Omaha, Nebraska 68137

MISC
2
1

#99027

FEE 1050 FB 0160000 ✓
BKP 8-14-11 C/O _____ COMP _____
DEL _____ SCAN OK FV _____

5-11-2001

63372



LEGAL DESCRIPTION
DISTRICT BOUNDARY
DOUGLAS COUNTY SID NO. 456

Part of the NW 1/4 Section 8; ~~and also together with the SW 1/4 of Section 5, all located in~~ Township 14 North, Range 11 East of the 6th P.M., Douglas County, Nebraska, more particularly described as follows:

Beginning at the Southeast corner of said NW 1/4 of Section 8, said point also being the Southwest corner of Lot 6, Rolling Meadows II, a subdivision located in the NE 1/4 of said Section 8; thence S87°17'30"W (assumed bearing) along the South line of said NW 1/4 of Section 8, a distance of 1312.15 feet to the Southwest corner of the SE 1/4 of said NW 1/4 of Section 8; thence N01°40'38"W along the West line of the East 1/2 of said NW 1/4 of Section 8, a distance of 1355.68 feet; thence S87°22'13"W, a distance of 1312.09 feet to a point on the West line of said Section 8; thence N01°40'33"W along said West line of Section 8, a distance of 1290.47 feet to the Northwest corner of said Section 8; thence N87°24'48"E along the North line of said Section 8, a distance of 2624.08 feet to the North 1/4 corner of said Section 8; thence S01°40'44"E along the East line of said NW 1/4 of Section 8, a distance of 33.00 feet to a point on the South right-of-way line of "Q" Street; thence S87°24'48"W along said South right-of-way line of "Q" Street, a distance of 189.09 feet to the Northwest corner of Mount Auburn Cemetery; thence S01°40'44"E along the West line of said Mount Auburn Cemetery, a distance of 447.46 feet to the Southwest corner of said Mount Auburn Cemetery; thence N87°24'48"E along the South line of said Mount Auburn Cemetery, a distance of 189.09 feet to a point on the West line of Lot 14, said Rolling Meadows II, said point also being on the East line of said NW 1/4 of Section 8; thence S01°40'44"E along the West line of said Rolling Meadows II, said line also being said East line of the NW 1/4 of Section 8, a distance of 2161.91 feet to the point of beginning.

Said tract of land contains an area of 5,076,078 square feet or 116.531 acres, more or less.

#99027 ^{sw}
8/1/00
Revised 8/22/00

E & A CONSULTING GROUP, INC.
12001 "Q" STREET
OMAHA, NE 68137