



Doc ID: 015572050003 Type: GEN
Recorded: 08/29/2004 at 01:01:38 PM
Fee Amt: \$17.00 Page 1 of 3
Polk County Iowa
TIMOTHY J. BRIEN RECORDER
File# 2005-00031032

BK **10753** PG **96-98**

RETURN TO:

PLEASE RETURN TO:

MIDAMERICAN ENERGY ATTN: RIGHT-OF-WAY SERVICES P.O. BOX 657 DES MOINES, IA 50303-0657

Prepared by: Anne M. King (515) 281-2202

**MIDAMERICAN ENERGY COMPANY
UNDERGROUND ELECTRIC LINE EASEMENT**

Folder No. 369-04
Work Req. No. DR1719981
Project No. 41125
Sub No. DR1719981

State of Iowa
County of Polk
Section 26
Township 79 North
Range 25 West of the 5th P.M.

KNOW ALL MEN BY THESE PRESENTS:

For and in consideration of the sum of One and no/100-----Dollar (\$1.00), and other valuable consideration, in hand paid by MIDAMERICAN ENERGY COMPANY, an Iowa Corporation, receipt of which is hereby acknowledged, the undersigned The Reserve, a nonprofit corporation Grantors), heirs and assigns, do hereby grant to MIDAMERICAN ENERGY COMPANY (Grantee), its successors or assigns, the right to lay, maintain, operate, repair, and remove underground conduit, wires, and other necessary equipment incident thereto (including associated riser, pole and other surface mounted equipment) through and across certain property described below, together with ingress and egress to and from the same, and all the rights and privileges incident and necessary to the enjoyment of this grant.

In consideration of such grant, MIDAMERICAN ENERGY COMPANY agrees that it will repair or pay for any damage which may be caused to real and personal property of the undersigned by the construction, maintenance, operation, or removal of said line, except such property placed subsequent to the granting of this easement that interferes with the operation and maintenance of the line and associated equipment.

Additionally, MIDAMERICAN ENERGY COMPANY shall have the right to remove from the strip of land specifically described below, any obstructions; including trees, plants, undergrowth, buildings, and structures that interfere with the proper operation and maintenance of said line and equipment.

Grantors agree that they will not construct or place any permanent buildings, structures, trees, plants, or other objects on the property described below.

EASEMENT DESCRIPTION:

An underground electric line easement 10 feet in width, situated in Lot 7, Colby Woods West Plat 7, an Official Plat, now included in and forming a part of the City of Urbandale, Polk County, Iowa; the centerline of said electric line easement being more particularly described as follows:

Commencing, as a point of reference, at the Northwest corner of said Lot 7; thence southerly along the west lot line a distance of 5 feet, more or less, to the Point of Beginning of the centerline of said easement strip of land; thence N90°00'00"E a distance of 247 feet, more or less; thence N54°00'20"E a distance of 146 feet, more or less; thence in a southeasterly direction a distance of 54 feet, more or less, to the Point of Terminus at a pad-mounted transformer, as generally depicted on Exhibit "A", attached hereto and made a part hereof.

UNDER.MRG

This easement shall be binding upon the heirs, successors, and assigns of both parties. Grantors shall have the right of full enjoyment and use of the above-described property except as such that will be inconsistent with this easement.

Dated this 14th day of September, 2004

By: Richard Walters
Richard Walters
Title: President

ACKNOWLEDGMENT

STATE OF Iowa)
COUNTY OF Dale) ss

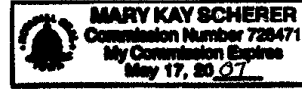

On this 14th day of September, 2004, before me, a Notary Public in and for said State, personally appeared Richard Walters, to me personally known, who being by me duly sworn, did say that he is the President of The Reserve, a nonprofit corporation; that said instrument was signed on behalf of said nonprofit corporation by authority of its board of directors, and the said President acknowledged the execution of said instrument to be the voluntary act and deed of said nonprofit corporation, by it, and by him, voluntarily executed.

Mary Kay Scherer
Notary Public in and for said State

UNDER.MRG

EXHIBIT "A"

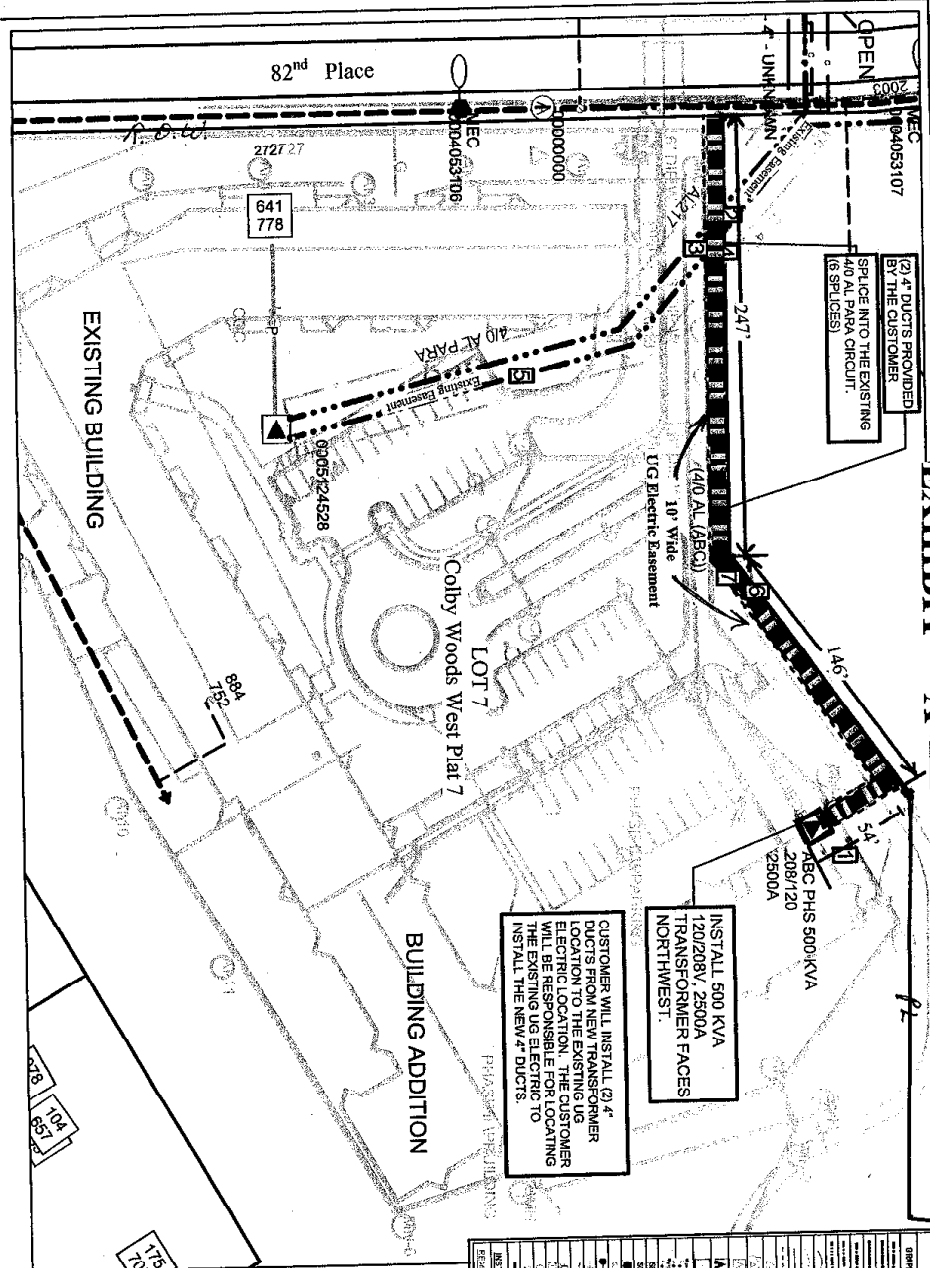

NOTE
SOURCE 0645 AT URBANDALE AVE
AND NW 68TH STREET.

SYMBOL	DESCRIPTION	REMARKS
○	EXISTING OVERHEAD TRANSFORMER	
□	EXISTING UNDERGROUND TRANSFORMER	
—	EXISTING UNDERGROUND 11KV CABLE	
—	EXISTING UNDERGROUND 4KV CABLE	
—	EXISTING UNDERGROUND 2KV CABLE	
—	EXISTING UNDERGROUND 1KV CABLE	
—	EXISTING UNDERGROUND 480V CABLE	
—	EXISTING UNDERGROUND 240V CABLE	
—	EXISTING OVERHEAD 11KV LINE	
—	EXISTING OVERHEAD 4KV LINE	
—	EXISTING OVERHEAD 2KV LINE	
—	EXISTING OVERHEAD 1KV LINE	
—	EXISTING OVERHEAD 480V LINE	
—	EXISTING OVERHEAD 240V LINE	
—	EXISTING UNDERGROUND 11KV TRENCH	
—	EXISTING UNDERGROUND 4KV TRENCH	
—	EXISTING UNDERGROUND 2KV TRENCH	
—	EXISTING UNDERGROUND 1KV TRENCH	
—	EXISTING UNDERGROUND 480V TRENCH	
—	EXISTING UNDERGROUND 240V TRENCH	
—	EXISTING UNDERGROUND 11KV CONDUIT	
—	EXISTING UNDERGROUND 4KV CONDUIT	
—	EXISTING UNDERGROUND 2KV CONDUIT	
—	EXISTING UNDERGROUND 1KV CONDUIT	
—	EXISTING UNDERGROUND 480V CONDUIT	
—	EXISTING UNDERGROUND 240V CONDUIT	
—	EXISTING UNDERGROUND 11KV DUCT	
—	EXISTING UNDERGROUND 4KV DUCT	
—	EXISTING UNDERGROUND 2KV DUCT	
—	EXISTING UNDERGROUND 1KV DUCT	
—	EXISTING UNDERGROUND 480V DUCT	
—	EXISTING UNDERGROUND 240V DUCT	
—	EXISTING UNDERGROUND 11KV TRUNK	
—	EXISTING UNDERGROUND 4KV TRUNK	
—	EXISTING UNDERGROUND 2KV TRUNK	
—	EXISTING UNDERGROUND 1KV TRUNK	
—	EXISTING UNDERGROUND 480V TRUNK	
—	EXISTING UNDERGROUND 240V TRUNK	
—	EXISTING UNDERGROUND 11KV MANHOLE	
—	EXISTING UNDERGROUND 4KV MANHOLE	
—	EXISTING UNDERGROUND 2KV MANHOLE	
—	EXISTING UNDERGROUND 1KV MANHOLE	
—	EXISTING UNDERGROUND 480V MANHOLE	
—	EXISTING UNDERGROUND 240V MANHOLE	
—	EXISTING UNDERGROUND 11KV JUNCTION	
—	EXISTING UNDERGROUND 4KV JUNCTION	
—	EXISTING UNDERGROUND 2KV JUNCTION	
—	EXISTING UNDERGROUND 1KV JUNCTION	
—	EXISTING UNDERGROUND 480V JUNCTION	
—	EXISTING UNDERGROUND 240V JUNCTION	
—	EXISTING UNDERGROUND 11KV CROSSING	
—	EXISTING UNDERGROUND 4KV CROSSING	
—	EXISTING UNDERGROUND 2KV CROSSING	
—	EXISTING UNDERGROUND 1KV CROSSING	
—	EXISTING UNDERGROUND 480V CROSSING	
—	EXISTING UNDERGROUND 240V CROSSING	
—	EXISTING UNDERGROUND 11KV TIE	
—	EXISTING UNDERGROUND 4KV TIE	
—	EXISTING UNDERGROUND 2KV TIE	
—	EXISTING UNDERGROUND 1KV TIE	
—	EXISTING UNDERGROUND 480V TIE	
—	EXISTING UNDERGROUND 240V TIE	
—	EXISTING UNDERGROUND 11KV BRANCH	
—	EXISTING UNDERGROUND 4KV BRANCH	
—	EXISTING UNDERGROUND 2KV BRANCH	
—	EXISTING UNDERGROUND 1KV BRANCH	
—	EXISTING UNDERGROUND 480V BRANCH	
—	EXISTING UNDERGROUND 240V BRANCH	
—	EXISTING UNDERGROUND 11KV FEEDER	
—	EXISTING UNDERGROUND 4KV FEEDER	
—	EXISTING UNDERGROUND 2KV FEEDER	
—	EXISTING UNDERGROUND 1KV FEEDER	
—	EXISTING UNDERGROUND 480V FEEDER	
—	EXISTING UNDERGROUND 240V FEEDER	
—	EXISTING UNDERGROUND 11KV SERVICE	
—	EXISTING UNDERGROUND 4KV SERVICE	
—	EXISTING UNDERGROUND 2KV SERVICE	
—	EXISTING UNDERGROUND 1KV SERVICE	
—	EXISTING UNDERGROUND 480V SERVICE	
—	EXISTING UNDERGROUND 240V SERVICE	
—	EXISTING UNDERGROUND 11KV MISC	
—	EXISTING UNDERGROUND 4KV MISC	
—	EXISTING UNDERGROUND 2KV MISC	
—	EXISTING UNDERGROUND 1KV MISC	
—	EXISTING UNDERGROUND 480V MISC	
—	EXISTING UNDERGROUND 240V MISC	

SYMBOL	DESCRIPTION	REMARKS
○	EXISTING OVERHEAD TRANSFORMER	
□	EXISTING UNDERGROUND TRANSFORMER	
—	EXISTING UNDERGROUND 11KV CABLE	
—	EXISTING UNDERGROUND 4KV CABLE	
—	EXISTING UNDERGROUND 2KV CABLE	
—	EXISTING UNDERGROUND 1KV CABLE	
—	EXISTING UNDERGROUND 480V CABLE	
—	EXISTING UNDERGROUND 240V CABLE	
—	EXISTING OVERHEAD 11KV LINE	
—	EXISTING OVERHEAD 4KV LINE	
—	EXISTING OVERHEAD 2KV LINE	
—	EXISTING OVERHEAD 1KV LINE	
—	EXISTING OVERHEAD 480V LINE	
—	EXISTING OVERHEAD 240V LINE	
—	EXISTING UNDERGROUND 11KV TRENCH	
—	EXISTING UNDERGROUND 4KV TRENCH	
—	EXISTING UNDERGROUND 2KV TRENCH	
—	EXISTING UNDERGROUND 1KV TRENCH	
—	EXISTING UNDERGROUND 480V TRENCH	
—	EXISTING UNDERGROUND 240V TRENCH	
—	EXISTING UNDERGROUND 11KV CONDUIT	
—	EXISTING UNDERGROUND 4KV CONDUIT	
—	EXISTING UNDERGROUND 2KV CONDUIT	
—	EXISTING UNDERGROUND 1KV CONDUIT	
—	EXISTING UNDERGROUND 480V CONDUIT	
—	EXISTING UNDERGROUND 240V CONDUIT	
—	EXISTING UNDERGROUND 11KV DUCT	
—	EXISTING UNDERGROUND 4KV DUCT	
—	EXISTING UNDERGROUND 2KV DUCT	
—	EXISTING UNDERGROUND 1KV DUCT	
—	EXISTING UNDERGROUND 480V DUCT	
—	EXISTING UNDERGROUND 240V DUCT	
—	EXISTING UNDERGROUND 11KV TRUNK	
—	EXISTING UNDERGROUND 4KV TRUNK	
—	EXISTING UNDERGROUND 2KV TRUNK	
—	EXISTING UNDERGROUND 1KV TRUNK	
—	EXISTING UNDERGROUND 480V TRUNK	
—	EXISTING UNDERGROUND 240V TRUNK	
—	EXISTING UNDERGROUND 11KV MANHOLE	
—	EXISTING UNDERGROUND 4KV MANHOLE	
—	EXISTING UNDERGROUND 2KV MANHOLE	
—	EXISTING UNDERGROUND 1KV MANHOLE	
—	EXISTING UNDERGROUND 480V MANHOLE	
—	EXISTING UNDERGROUND 240V MANHOLE	
—	EXISTING UNDERGROUND 11KV JUNCTION	
—	EXISTING UNDERGROUND 4KV JUNCTION	
—	EXISTING UNDERGROUND 2KV JUNCTION	
—	EXISTING UNDERGROUND 1KV JUNCTION	
—	EXISTING UNDERGROUND 480V JUNCTION	
—	EXISTING UNDERGROUND 240V JUNCTION	
—	EXISTING UNDERGROUND 11KV CROSSING	
—	EXISTING UNDERGROUND 4KV CROSSING	
—	EXISTING UNDERGROUND 2KV CROSSING	
—	EXISTING UNDERGROUND 1KV CROSSING	
—	EXISTING UNDERGROUND 480V CROSSING	
—	EXISTING UNDERGROUND 240V CROSSING	
—	EXISTING UNDERGROUND 11KV TIE	
—	EXISTING UNDERGROUND 4KV TIE	
—	EXISTING UNDERGROUND 2KV TIE	
—	EXISTING UNDERGROUND 1KV TIE	
—	EXISTING UNDERGROUND 480V TIE	
—	EXISTING UNDERGROUND 240V TIE	
—	EXISTING UNDERGROUND 11KV BRANCH	
—	EXISTING UNDERGROUND 4KV BRANCH	
—	EXISTING UNDERGROUND 2KV BRANCH	
—	EXISTING UNDERGROUND 1KV BRANCH	
—	EXISTING UNDERGROUND 480V BRANCH	
—	EXISTING UNDERGROUND 240V BRANCH	
—	EXISTING UNDERGROUND 11KV FEEDER	
—	EXISTING UNDERGROUND 4KV FEEDER	
—	EXISTING UNDERGROUND 2KV FEEDER	
—	EXISTING UNDERGROUND 1KV FEEDER	
—	EXISTING UNDERGROUND 480V FEEDER	
—	EXISTING UNDERGROUND 240V FEEDER	
—	EXISTING UNDERGROUND 11KV SERVICE	
—	EXISTING UNDERGROUND 4KV SERVICE	
—	EXISTING UNDERGROUND 2KV SERVICE	
—	EXISTING UNDERGROUND 1KV SERVICE	
—	EXISTING UNDERGROUND 480V SERVICE	
—	EXISTING UNDERGROUND 240V SERVICE	
—	EXISTING UNDERGROUND 11KV MISC	
—	EXISTING UNDERGROUND 4KV MISC	
—	EXISTING UNDERGROUND 2KV MISC	
—	EXISTING UNDERGROUND 1KV MISC	
—	EXISTING UNDERGROUND 480V MISC	
—	EXISTING UNDERGROUND 240V MISC	

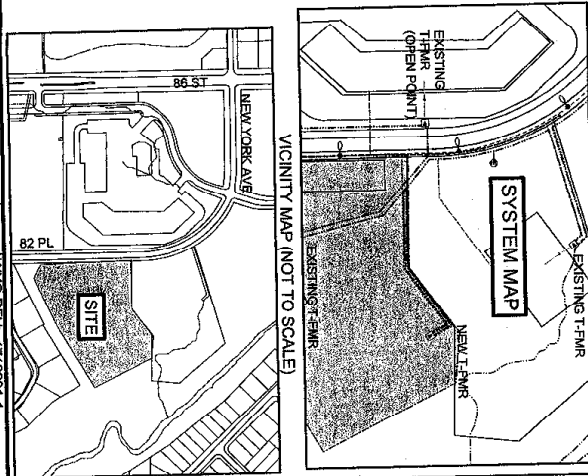

Middlesex
City: URBANDALE
Cust: THE RESERVE ON WALNUT CREEK PHASE II
Addr: 2729 82ND PLACE
City: URBANDALE
Job Desc: INSTALL 500KVA (120/208V) 1-FMR. FULL IN 40 AL PARA THRU CURB. INSTALLEDUCT. SPLICE INTO EXISTING 40 AL PARA CIRCUIT.

SECTION: 26, 779U, R23W
S. 1/4, 61st, 157980, 2500S
Date: 7/20/04
Scale: 1" = 60'
VMS-REV: 1719981-1



Doc ID: 015572050003 Type: GEN
Recorded: 08/29/2004 at 01:01:38 PM
Fee Amt: \$17.00 Page 1 of 3
Polk County Iowa
TIMOTHY J. BRIEN RECORDER
File# 2005-00031032

BK 10753 PG 96-98

RETURN TO:

PLEASE RETURN TO:

MIDAMERICAN ENERGY ATTN: RIGHT-OF-WAY SERVICES P.O. BOX 657 DES MOINES, IA 50303-0657

Prepared by: Anne M. King (515) 281-2202

**MIDAMERICAN ENERGY COMPANY
UNDERGROUND ELECTRIC LINE EASEMENT**

Folder No. 369-04
Work Req. No. DR1719981
Project No. 41125
Sub No. DR1719981

State of Iowa
County of Polk
Section 26
Township 79 North
Range 25 West of the 5th P.M.

KNOW ALL MEN BY THESE PRESENTS:

For and in consideration of the sum of One and no/100-----Dollar (\$1.00), and other valuable consideration, in hand paid by MIDAMERICAN ENERGY COMPANY, an Iowa Corporation, receipt of which is hereby acknowledged, the undersigned The Reserve, a nonprofit corporation Grantors), heirs and assigns, do hereby grant to MIDAMERICAN ENERGY COMPANY (Grantee), its successors or assigns, the right to lay, maintain, operate, repair, and remove underground conduit, wires, and other necessary equipment incident thereto (including associated riser, pole and other surface mounted equipment) through and across certain property described below, together with ingress and egress to and from the same, and all the rights and privileges incident and necessary to the enjoyment of this grant.

In consideration of such grant, MIDAMERICAN ENERGY COMPANY agrees that it will repair or pay for any damage which may be caused to real and personal property of the undersigned by the construction, maintenance, operation, or removal of said line, except such property placed subsequent to the granting of this easement that interferes with the operation and maintenance of the line and associated equipment.

Additionally, MIDAMERICAN ENERGY COMPANY shall have the right to remove from the strip of land specifically described below, any obstructions; including trees, plants, undergrowth, buildings, and structures that interfere with the proper operation and maintenance of said line and equipment.

Grantors agree that they will not construct or place any permanent buildings, structures, trees, plants, or other objects on the property described below.

EASEMENT DESCRIPTION:

An underground electric line easement 10 feet in width, situated in Lot 7, Colby Woods West Plat 7, an Official Plat, now included in and forming a part of the City of Urbandale, Polk County, Iowa; the centerline of said electric line easement being more particularly described as follows:

Commencing, as a point of reference, at the Northwest corner of said Lot 7; thence southerly along the west lot line a distance of 5 feet, more or less, to the Point of Beginning of the centerline of said easement strip of land; thence N90°00'00"E a distance of 247 feet, more or less; thence N54°00'20"E a distance of 146 feet, more or less; thence in a southeasterly direction a distance of 54 feet, more or less, to the Point of Terminus at a pad-mounted transformer, as generally depicted on Exhibit "A", attached hereto and made a part hereof.

UNDER.MRG

This easement shall be binding upon the heirs, successors, and assigns of both parties. Grantors shall have the right of full enjoyment and use of the above-described property except as such that will be inconsistent with this easement.

Dated this 14th day of September, 2004

By: Richard Walters
Richard Walters
Title: President

ACKNOWLEDGMENT

STATE OF Iowa)
COUNTY OF Dalk) ss

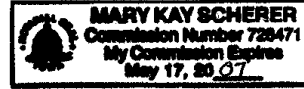

On this 14th day of September, 2004, before me, a Notary Public in and for said State, personally appeared Richard Walters, to me personally known, who being by me duly sworn, did say that he is the President of The Reserve, a nonprofit corporation; that said instrument was signed on behalf of said nonprofit corporation by authority of its board of directors, and the said President acknowledged the execution of said instrument to be the voluntary act and deed of said nonprofit corporation, by it, and by him, voluntarily executed.

Mary Kay Scherer
Notary Public in and for said State

UNDER.MRG

