

HOUSING COMMUNITY & DEVELOPMENT DEPARTMENT
PERMITS & INSPECTIONS DIVISION

WORK SHEET

ADDRESS 1154-54 1/2 No 20 Str STRUCTURE Wd. Frm - Masonry
 TYPE Com. Bldg. last use as church SIZE 50x42x20
 BASEMENT _____ STORIES 1 + 2
 OCCUPANT Vacant
 CONDITION OF BUILDING: Fire + Vandal Damaged

LOCATION: SHOW LOCATION OF STRUCTURE ON THE PLATTED BLOCK AS MEASURED FROM CENTER LINES OF STREETS TO CENTER LINE OF STRUCTURE.

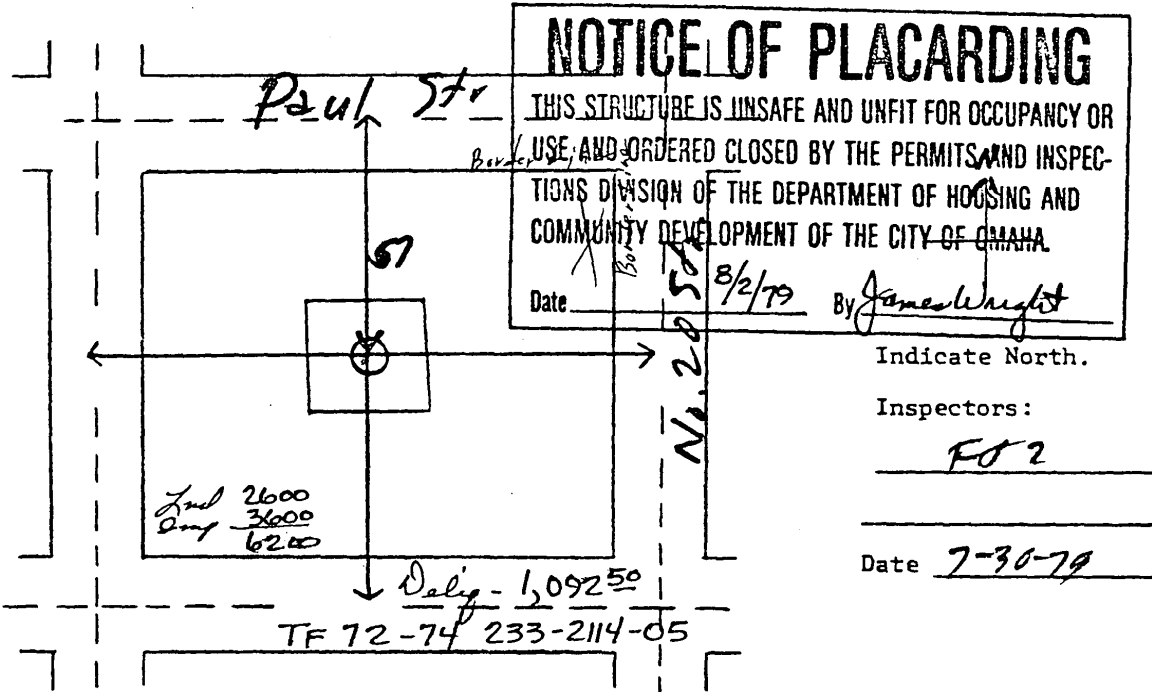

LEGAL DESCRIPTION N 48 FT L 6, BLK 7, HORBACHS 2ND ADD
EXTENSION EXTENDED

OWNER: ABRAHAM KIRSHENBA KIRSHENBAUM
ADDRESS: 1742 CRAWFORD RD., OMAHA, NEBR 68144

BPI-164 OS COPY: SHERIFF'S DELINQUENT TAX DEPT.
Deed 29/41
mortgage 29/327
N/S - no decree.

S. H. H. H.

RECEIVED
1979 AUG - 2 PM 3:30
C. HAROLD OSTLER
REGISTER OF DEEDS
DOUGLAS COUNTY, NEBR.

Doc: 618
Page: 352
of 2000

Fee [Signature]
Index [Signature]
Comped [Signature]

29-42
29