

REGISTRATION NUMBER
96-018153

96 SEP -5 PM 2:54

Lloyd J. Dowding

REGISTER OF DEEDS

96-18153

JD
Fee \$ 25.50
Chg MOA

THIS PAGE ADDED FOR RECORDING INFORMATION

LLOYD J. DOWDING
Sarpy County Register of Deeds

1210 Golden Gate Drive, Suite 1109 Papillion, Nebraska 68046-2895 Phone: (402) 593-2185 Fax: (402) 593-2338

96-18153A

IN THE COUNTY COURT OF SARPY COUNTY, NEBRASKA

COUNTY OF SARPY,
A Body Politic and Corporate,

Condemner,

vs.

ROLAND F. WAITE, A Single Person; and
DONALD E. KROEGER and BARBARA H.
KROEGER, Husband and Wife, Truators; and
FIRST NATIONAL BANK OF OMAHA, Trustee

Condemnees.

DOC. M4 PAGE 114

RETURN OF APPRAISERS

TO THE COUNTY JUDGE OF SARPY COUNTY, NEBRASKA.

We, the undersigned appraisers, do hereby certify that under and by virtue of an "Appointment of Appraisers" duty served upon us by _____ Sheriff or Deputy Sheriff of Sarpy County, Nebraska, on the ____ day of _____, 1996, and after having taken and filed the "Oath of Appraisers" that we did carefully inspect and view the property described herein, sought to be appropriated by the County of Sarpy, A Body Politic and Corporate, and also other property of the condemnees alleged damaged thereby and did hear all parties interest therein in reference to the amount of damages sustained while we were so inspecting and viewing the property herein described and thereafter did assess the damages that the condemnees have sustained or will sustain by such appropriation of the property herein described for County sewer purposes and also damage to such property of the condemnees as in our opinion, was damaged by the appropriation of the property as described in Exhibit A attached hereto.

96-1353B

Now, therefore, we as appraisers aforesaid, do hereby find and appraise the damages that will be suffer by reason of the appropriation of title to the said property or any interest therein described for County sewer purposes by the County of Sarpy. A

Body Politic and Corporate, in the amount of:

TOTAL AMOUNT AWARDED FOR ACQUISITION OF TRACT

\$ 11,500.00

Award to be distributed as follows:

To: Roland F. Waite, Owner,

\$ 11,500.00

All of which is hereby respectfully submitted.

Dated this 5th day of September, 1996.

[Handwritten signatures of appraisers]
Appraisers

Subscribed and sworn to before me this 5th day of Sept, 1996.

[Handwritten signature of County Judge]
County Judge
Case No. 114-114

STATE OF NEBRASKA)
COUNTY OF SARPY) SS

I, the Judge of the County Court in and for said county, do hereby certify that I have compared the foregoing copies (4) (pages) with the original thereof now remaining on file and of record in this Court, and that the same is a correct transcript therefrom, and of the whole of such original:

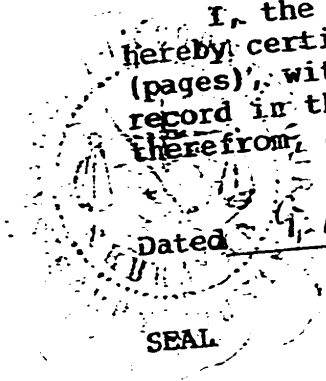

Dated 9-6-96

SEAL

[Handwritten signature of County Judge]
County Judge
[Handwritten signature of Clerk]
Clerk of County Court

Handwritten signature

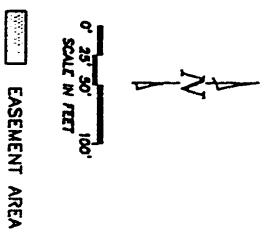
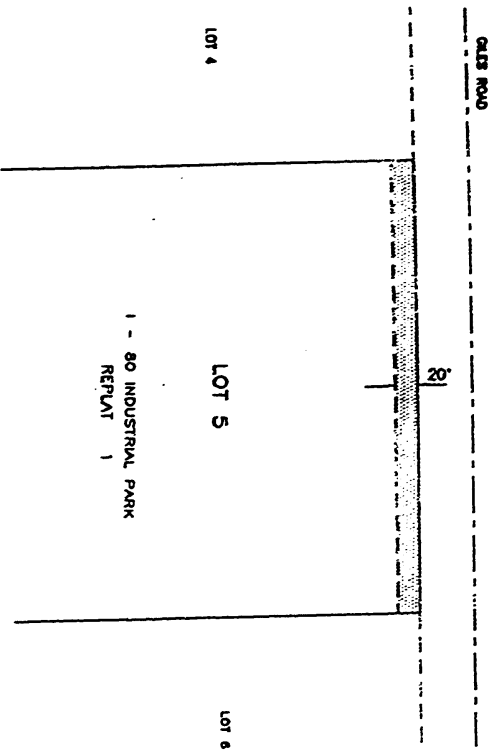

EASEMENT AREA

LEGAL DESCRIPTION

THE NORTH 20.00 FEET OF LOT 5, 1-80 INDUSTRIAL PARK REPLAT A SUBDIVISION AS SURVEYED, PLATTED AND RECORDED IN SARY COUNTY, NEBRASKA CONTAINING 0.18 ACRES MORE OR LESS.

PERMANENT EASEMENT

SARY COUNTY, NEBRASKA
SOUTH PAPILLION CREEK OUTFALL SEWER

TRACT NO. 9
ROLAND F. WAITE

EXHIBIT _____



2 THOLPSON, DRESSSEN & DONNER, INC.
Consulting Engineers & Land Surveyors
1838 OLD 24th ROAD
DULLES, NE 68154
(402) 330 - 8888

9-18-95
DRAWING NO. EASE11.DWG

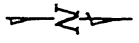
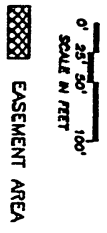
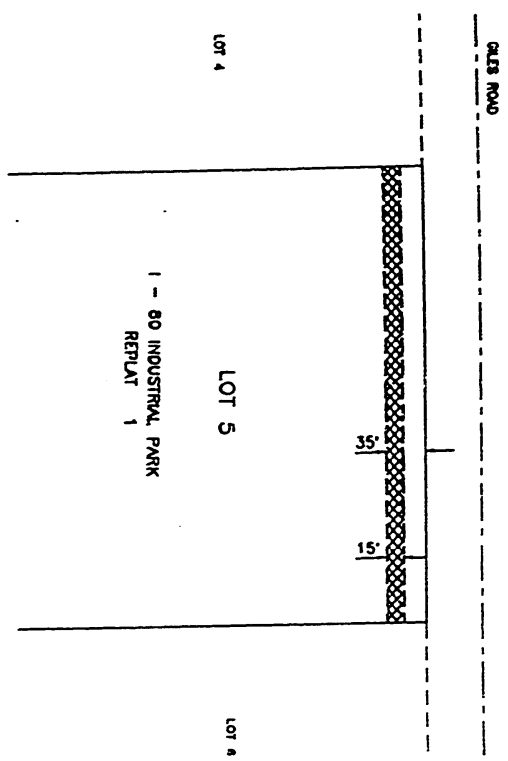

LEGAL DESCRIPTION

THE SOUTH 15.00 FEET OF THE NORTH 35.00 FEET OF LOT 5, 1-80 INDUSTRIAL PARK REPLAT 1, A SUBDIVISION AS SURVEYED, PLATTED AND RECORDED IN SAPPY COUNTY, NEBRASKA, 0.14 AC. MORE OR LESS

TEMPORARY EASEMENT

SAPPY COUNTY, NEBRASKA
SOUTH PAPILLION CREEK OUTFALL SEWER

TRACT NO. 9
ROLAND F. WAITE

EXHIBIT

TP 2 THOMPSON, DEBESSEN & DORNER, INC.
Consulting Engineers & Land Surveyors
10224 OLD MILL ROAD
OMAHA, NE 68114
(402) 330-0880

9-18-05
DRAWING NO. EAS111.CDWG