

Form 640004
10-78

COMPARED



IOWA DEPARTMENT OF TRANSPORTATION
HIGHWAY DIVISION
ENTRANCE PERMIT

(Application for Permit to Construct Entrance from Private Property
to Primary Road or Primary Road Extension)

STATE OF IOWA, Pottawattamie County
Filed for record the 29 day of August
1979 at 8 o'clock AM and recorded
in book 80 page 4413

By Wifra Larson
Recorder

2476

Permit Number 4-1030
County Pottawattamie
Project F-959 (So. Omaha Bridge Rd.)
Highway Number U.S. 275 (Iowa 92)

Applicant The Bluffs Corporation

(Owner or Owners of Record)

Address Box 7343 Omaha, Nebraska 68107 August 1, 1979
(Date)

A permit is hereby requested to construct a "C" entrance 24 feet in width, from right of way line to primary road traveled way, including necessary drainage structure thereunder at Station 254+00 North side.
(Type "A", "B", or "C")

PLAT OF ENTRANCE AS PROPOSED TO BE CONSTRUCTED IS ATTACHED
TO AND IS A PART OF THIS APPLICATION. (Form 534)

Proposed entrance is located on Primary Road No. 275, Sec. 12, T. 74N, R. 44W Pottawattamie
County, 0.25 Miles East from Jct. U.S. 275 & So. Expressway more specifically de-
(Direction) (Place, Town, or Object)

scribed as follows:

38 Ft East 1/4 1/4 Line Sec 12, Twp. 74N, Range 44W

Poster to pts WSE 1/4 12-74-44 per Paul

The applicant agrees that if granted a permit to construct the above described entrance, the following stipulations shall govern.

- Written approval of the Department shall be obtained before any change is made in the entrance or its location.
- That the entrance, including drainage structure, grading and surfacing, shall be constructed by the applicant at the applicant's expense, in accordance with the plat attached hereto, and in conformity with the standard specifications of the Highway Division, and shall thereafter be kept in repair and maintained by the applicant at his own expense. Nothing in this stipulation, however, shall preclude the Department from entering upon said entrance on highway right of way and performing necessary maintenance for the protection of the highway.
- That the construction of the entrance shall be completed by the 1st day of November, 1979.
(The permit is null and void if drive is not completed by the above date unless extension is granted in writing by the Department.)
- That the construction, future repair or maintenance of said entrance shall be carried on in such a way as not to interfere with, or interrupt traffic on said highway, and the applicant shall take all reasonable precautions to protect and safeguard the lives and property of any person or persons, and shall save the State and Department of Transportation harmless of any damage or losses that may be sustained by any person or persons, on account of such construction, repair, or maintenance operations.
- That no filling will be permitted in the right of way of primary road No. US 275 other than that necessary to construct the proposed entrance.
That the culvert pipe under the entrance shall be zinc coated corrugated metal or 1500D concrete pipe. It shall be 18 inches in diameter and 70 feet in length, as shown on attached sketch, and of quality complying with Sec. 4141 and Sec. 4145 of the Highway Division Standard and Specifications, Series of 1964, or subsequent revisions. The pipe shall be installed at the elevation specified by the engineer.
The finished surface elevation of the driveway over the pipe or place where the pipe would normally be shall be 15 inches lower than shoulder elevation at Station 254+00 to prevent water draining onto the pavement or travel way.
Side slope of the requested entrance shall be constructed with a minimum of 6:1 slope.
- That the applicant agrees to give the Highway Division forty-eight hours notice of his intention to start construction on the highway right of way. Said notice shall be in writing to the person whose name is shown on the reverse side.
- That all provisions herein relating to future repair or maintenance shall be binding on all successors or assigns of the applicant.
- Stipulations and requirements contained herein are not intended to waive greater requirement of local zoning ordinances.
- Applicant's attention is directed to the fact that private property may not be used so as to obstruct or encumber the public highway right of way, or interfere with the safety, comfort, and rights of public highway users.
- §319.14 Code of Iowa requires any work performed under this permit to be in conformity with the specifications of the D.O.T. If the applicant does not conform to these specifications the D.O.T. may make the necessary changes and charge the cost against the person responsible, including court action if necessary.

COMPARED

11. _____

Signed The Bluffs Corporation By Elmer W. Adams
(Applicant) OWNER OF RECORD (Type name below line) Elmer W. Adams
Title Owner Address Box 7343
Omaha, Nebraska 68107

ACKNOWLEDGEMENT

STATE OF ~~Iowa~~ Nebr
On this 8 day of August, A.D. 19 79, before me Anna Marie Osthoff
a Notary Public in and for said State of Iowa, personally appeared Elmer Adams and
to me known to be the person(s), named in and who execute the foregoing instrument, and acknowledged, that Elmer Adams
executed the same as voluntary act and deed.

Anna Marie Osthoff
Notary Public in and for said state ANNA MARIE OSTHOFF
My Comm. Exp. 2/5/81

Recommended for approval by Jan R. Whetstone
Resident Maintenance Engineer, on 8-10 19 79
Access hereby requested is approved and granted by the Department of Transportation, Highway Division
by A.E. Adams
Authorized Dist. Agent on 8-23 19 79

Recommended for approval for Council Bluffs, Iowa
City of town
on August 8th 19 79 by
Jan R. Whetstone
Authorized City Official
Zoning Officer

Notice of date construction is to start shall be sent by applicant to:
James R. Whetstone, Res. Maint. Engr.

Name P. O. Box #7 Address Council Bluffs, Iowa 51501 Telephone No. 366-0438

NOTATION OF RECORD

Filed for Record on the _____ day of _____, 19____, at _____ o'clock _____ M., and Recorded in
Book _____ of _____, on Page _____

Recorder _____
By Deputy _____

To be recorded by State for applications on Class I, II, and III highways. On Class IV highway, permits may be recorded by applicant if desired.



IOWA DEPARTMENT OF TRANSPORTATION
HIGHWAY DIVISION
ACCESS PLAT

No. E-1830
County Pottawattamie
Project No. F-959

SPECIAL PUBLIC ROAD CONNECTION
Access Rights Acquired
Attach To Form 538

Location Description: Primary Road No. US 275 Sec. 12 T. 74N R. 44W Pottawattamie
Being 0.25 Miles East From Jct. U.S. 275 & South Expressway, Council Bluffs, Iowa

Check PRIVATE PROPERTY ENTRANCE
Access Rights Not Acquired
Attach To Form 539

Specifically described as:

COMPARED

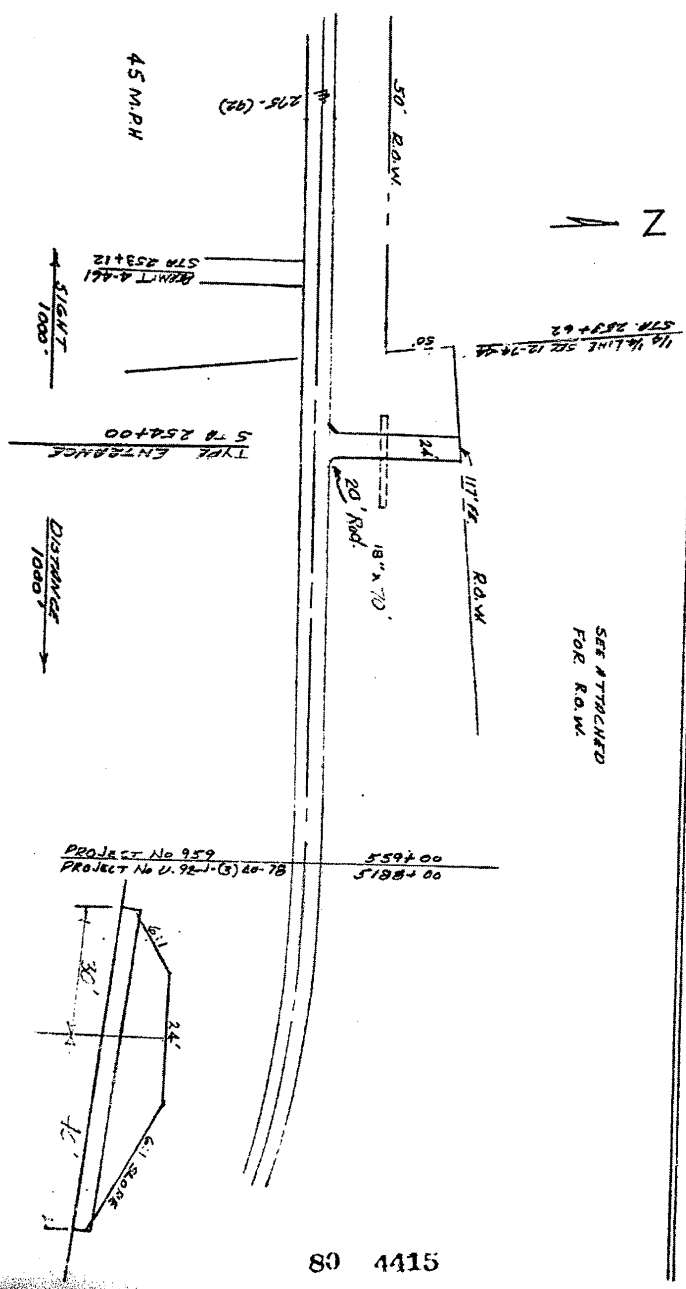

CERTIFICATION

I hereby certify that this sketch was prepared by me or under my direct personal supervision and that I am a duly registered professional engineer under the laws of the State of Iowa.

Date August 10, 1979 License No. 7091

(Signature) [Handwritten Signature]

APPLICANT The Bluffs Corporation
By: [Handwritten Signature]
Address Box 1343 Omaha, Nebraska 68107
DATE August 19 79