

2-1192
Fee \$20.00 (five dollars per parcel)-City
(one dollar per parcel)-County

NO. 1907

NE 1/4, SEC. 34 T. 10 N., R. 6 E.

APPLICATION FOR SUBDIVISION PERMIT

TO THE LINCOLN CITY-LANCASTER COUNTY PLANNING DEPARTMENT

The undersigned hereby applies for a permit to subdivide the following described parcel of land:

LEGAL DESCRIPTION OF PROPERTY LOT 145 IRREGULAR TRACTS IN THE NE 1/4
OF SECTION 34, T10N, R6E OF THE 6TH P.M.,

in Lancaster County, Nebraska

DESCRIPTION OF PARCELS CREATED:

DESCRIPTION KEY: Parcel numbers are not to be used for legal descriptions.

PARCEL 1 SEE ATTACHED EXHIBIT 'A'

PARCEL 2 SEE ATTACHED EXHIBIT 'A'

PARCEL 3 SEE ATTACHED EXHIBIT 'A'

PARCEL 4 SEE ATTACHED EXHIBIT 'A'

The approval of this subdivision is granted with the condition(s) of approval as specified on Exhibit "B" attached to and made a part of this subdivision approval.

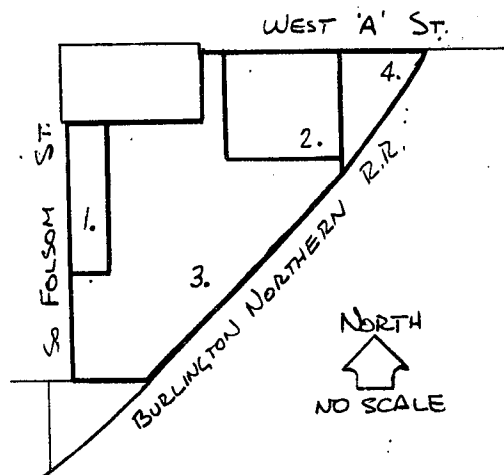

APPROVED THIS 10TH DAY OF AUG. 1978

1. CITY OF LINCOLN, AND ITS CITY COUNCIL
DE BROGDEN BY Rodger P. Harris
PLANNING DIRECTOR

—OR—

2. LANCASTER COUNTY, AND
ITS COUNTY BOARD

CHAIRMAN, COUNTY BOARD

COUNTY SURVEYOR

PLANNING DIRECTOR

I HEREBY CERTIFY THAT THE ABOVE
STATEMENTS ARE CORRECT

Karl L. Hampshire
OWNER
5801 "Q" Street

21192
EXHIBIT "A"

DESCRIPTION OF PARCELS CREATED

PARCEL 1

A portion of Lot 145 irregular tracts in the NE $\frac{1}{4}$ of Section 34, T10N, R6E, more particularly described as follows: Commencing at the NW corner of said NE $\frac{1}{4}$, such point being the intersection of centerlines of South Folsom Street and West "A" Street, thence south along centerline of South Folsom Street a distance of 951.85; thence east 50.0' to the point of beginning; thence north a distance of 618.85'; thence east a distance of 154.0'; thence south a distance of 620.58'; thence west a distance of 154.0' to the point of beginning.

PARCEL 2

A portion of Lot 145 of irregular tracts in the NE $\frac{1}{4}$ of Section 34, T10N, R6E, more particularly described as follows: Commencing at the NW corner of said NE $\frac{1}{4}$, such point being the intersection of centerlines of South Folsom Street and West "A" Street; thence east along the centerline of West "A" Street a distance of 672.48'; thence south a distance of 50.0' to the point of beginning. Thence south a distance of 400.0'; thence east a distance of 400.0'; thence north a distance of 400.0' to the south line of West "A" Street; thence west a distance of 400.0' to the point of beginning.

PARCEL 3

A portion of Lot 145 of irregular tracts in the NE $\frac{1}{4}$ of Section 34, T10N, R6E, more particularly described as follows: Commencing at the NW corner of said NE $\frac{1}{4}$, such point being the intersection of centerlines of South Folsom Street and West "A" Street, thence south along centerline of South Folsom Street a distance of 1322.54; thence east 50.0' to the point of beginning. Thence north a distance of 370.69'; thence east a distance of 154.0'; thence north 620.58'; thence east 379.27'; thence north 282.94' to the south line of West "A" Street; thence east a distance of 89.48'; thence south a distance of 400.0'; thence east a distance of 400.0'; thence south 21.33' to a point of intersection with the northwesterly line of the Burlington Northern Railroad right-of-way; thence 1117.71' southwesterly along the northwesterly line of the Burlington Northern Railroad right-of-way to a point of intersection with the north line of Lot 90 of irregular tracts in said northeast $\frac{1}{4}$; thence west a distance of 300.20' along the north line of Lot 90 I.T., to a point 50.0' east of the NW corner of said Lot 90 I.T. to the point of beginning.

PARCEL 4

A protion of Lot 145 of irregular tracts in the NE $\frac{1}{4}$ of Section 34, T10N, R6E, more particularly described as follows: Commencing at the NW corner of said NE $\frac{1}{4}$, such point being the intersection of centerlines of South Folsom Street and West "A" Street; thence east along the centerline of West "A" Street a distance of 1072.48'; thence south a distance of 421.33' to a point of intersection with the northwesterly line of the Burlington Northern Railroad right-of-way; thence 543.36' northwesterly along the northwesterly line of the Burlington Northern Railroad to a point 50.0' south of the centerline of West "A" Street, thence west a distance of 310.91' along the south line of West "A" Street to the point of beginning.

EXHIBIT "B"

In consideration of City of Lincoln, Nebraska, a municipal corporation, granting administrative subdivision approval as specified on the subdivision permit, it is agreed by and between subdivider and City as follows:

1. That direct vehicular access to West "A" Street and to South Folsom Street from Parcels 1, 2 and 4, as described on attached Exhibit "A", be forever relinquished to the City.
2. That a single direct vehicular access location to West "A" Street from Parcel 3, as described on attached Exhibit "A", and located inline with the centerline of SW 6th Street is permitted.
3. That a single direct vehicular access location to South Folsom Street from Parcel 3, as described on attached Exhibit "A", and located inline with the centerline of West Summer Circle.

The agreements contained herein shall run with the land described above and shall be binding and obligatory upon the heirs, successors and assigns of the subdivider to all or any part of the real estate as described above.

Dated this 9 day of August, 1978.

C & D, Inc.

By: Earl Lampshire President
Earl Lampshire

By: Dwight Nelson Vice-President
Dwight Nelson

VILLAGE MANOR CONSTRUCTION, INC.

By: Dan L. Cuda President
Dan L. Cuda

By: Richard A. Holtmeier Vice-President
Richard A. Holtmeier

LANCASTER COUNTY NBR.
Kenneth L. Ferguson
REGISTER OF DEEDS

1978 AUG 10 PM 3:54

ENTERED ON
NUMERICAL INDEX
FILED FOR RECORD AS:
INST. NO. 78-21192

INDEXED
MICRO-FILED
GENERAL

6-12-644
Mue

\$9.25