



THIS PAGE INCLUDED FOR  
INDEXING  
PAGE DOWN FOR BALANCE OF INSTRUMENT

HOUSING AND COMMUNITY DEVELOPMENT DEPARTMENT  
HOUSING DIVISION

BOOK **815** PAGE **23**

WORK SHEET

ADDRESS 2902 N 24 STRUCTURE 1 1/2 Plex  
 TYPE Brick Ord. SIZE 30' x 22' x 23'  
 BASEMENT no STORIES 3 story  
 OCCUPANT Partial  
 CONDITION OF BUILDING: Delapidated

LOCATION: SHOW LOCATION OF STRUCTURE ON THE PLATTED BLOCK AS MEASURED FROM CENTER LINES OF STREETS TO CENTER LINE OF STRUCTURE.

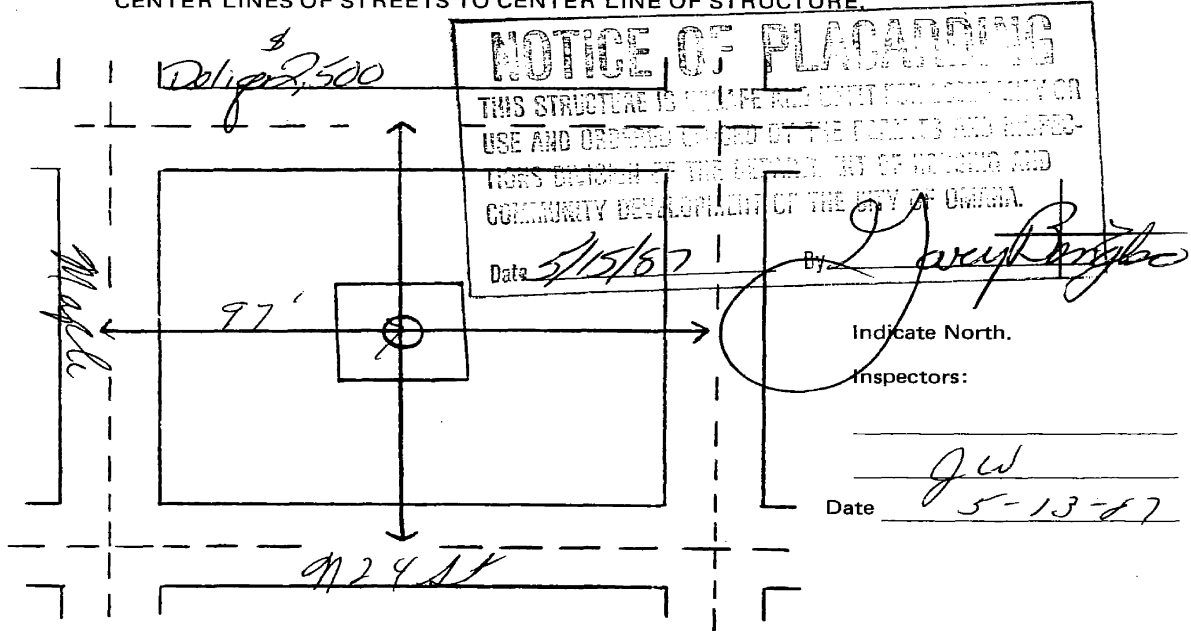

LEGAL DESCRIPTION East 80 Feet of Lot 1-283, B1K1,

Patrick-AS-add

OWNER: Nebraska & Rosam MORROW

ADDRESS: 212 Pinkney St Omaha Neb 68110

39A/223 39/238

39/191

BK 815 PG 23 N 39/223/18 DEL 11 MC OC  
 COMP 11/1 F/B 05-2372022

RECEIVED  
 1987 MAY 18 PM 12: 01  
 GEORGE J. BOUTER  
 REGISTERED CLERK  
 DOUGLAS COUNTY, NEBR.

8966 City