

HOLT COUNTY ASSESSOR

Parcel Number: 450020062
Computer ID: 0657-00-0-00000-000-0000
Deed Holder: SCHULTE, JONATHAN A & KATHRYN M
Property Address: 506 N HILL ST
 ATKINSON, 68713-0000 [MAP THIS ADDRESS](#)
Mailing Address: 506 N HILL ST
 PO BOX 847
 ATKINSON , NE 68713-0000 USA
Status: IMPROVED
Use: COMMERCIAL
Zoning: NONE
Location: URBAN
City Size: N/A
Lot Size: NONE
Map Area: 2003
Plat Map: 001-008-0059
Subdivision: 00000-NONE
Sec-Twp-Rng: 32-30-14W
Lot-Block: -
Assessor Location: ATKINSON
Legal Description: ATKINSON V; BITNEY'S ADD BLK 28 LOTS 1-2-3-7-8
 (NOT TO BE USED ON LEGAL DOCUMENTS)
Property Report: [PROPERTY REPORT \(PDF FILE\)](#)



1 / 8



Taxing Districts

District

- Ag Society
- Airport Authority
- Cities & Villages
- Community College
- County
- Educational Service Units
- Fire District
- Master
- Natural Resources District
- Reclamation
- School Bond
- School Bond 2

Description

- AG SOCIETY
- NONE
- ATKINSON VILLAGE
- NE COMM COLL
- COUNTY GENERAL
- ESU 8
- ATKINSON FIRE DIST
- 2-ATKINSON VIL 239-1-E
- UPPER ELKHORN NRD
- RECLAMATION
- WEST HOLT K-12 BOND
- NONE

School District
TIF-Excess
Township

WEST HOLT PUB SCH 239
NONE
ATKINSON TWP

Current Value Information

Land Value	Dwelling Value	Improvement Value	Total Value
\$10,200	\$0	\$389,401	\$399,601

Tax Information

Taxable Value	Exempt Value	Net Taxable Value	Levy	Gross Tax	Homestead Loss	Ag Land Tax Credit	Used Tax Credit	Net Tax
\$399,601	\$0	\$399,601	1.431119	\$5,718.80	\$0.00	\$0.00	\$345.66	\$5,373.14

NOTE: Tax amounts do not necessarily reflect official values and are subject to change based on exemption and levy rate changes.
Please click link below for accurate Tax Information
[Get Official Taxes](#)

Prior Year Value Information

Year	Land	Dwelling Value	Improvement Value	Total Value
2019	\$10,200	\$0	\$389,401	\$399,601
2018	\$10,200	\$0	\$389,401	\$399,601
▼ More Years...				

Land Information

Lot Type	Square Feet	Acres
Acres x Rate	44,431	1.020

Commercial Building Information

Occupancy	Year Built	Building Area
▼ Office - Medical / Dental	2013	3,570

Yard Extra Information

Description	Item Count	Year Built
▼ Garage	1	2014
▼ Paving - Concrete	1	2013
▼ Paving - Concrete	1	2014
▼ Paving - Concrete	1	2013
▼ Paving - Concrete	1	2013
▼ Paving - Concrete	1	2013

Sale Information

Sale Date	Amount	Non-Useable Transaction Code	Recording
▼ 12/11/2013	\$15,000	13 - Normal, Arms-Length Transaction	204 ~618
▼ 01/15/2012	\$10,000	13 - Normal, Arms-Length Transaction	203 ~558

Sketch

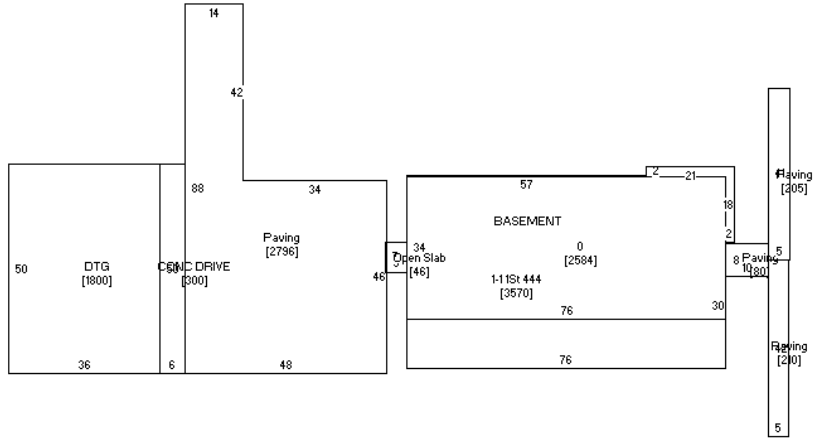

1 / 1

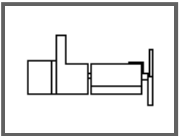

GIS Map Information

The image displays a web-based parcel map interface. The main area shows a grid of land parcels, each labeled with a unique parcel ID. The parcels are outlined in red. One parcel, 450020062, is highlighted with a thick red border. The parcels are arranged in a grid-like fashion, with some parcels having irregular shapes. The IDs visible are: 450020079, 450020082, 450020072, 450020081, 450020054, 450020053, 450020062, 450020055, 450020060, 450020056, 450020058, 450020061, and 450020061. In the top-left corner, there are navigation icons: a compass, a plus sign, and a minus sign. A scale bar in the bottom-left corner indicates 10 meters and 50 feet. On the right side, there is a sidebar menu with the following items: Views, Base Layer (with radio buttons for Google Hybrid, Google Satellite, Google Streets, Google Terrain, Imagery 2016, Imagery 2014, Imagery 2012, and Imagery Off), Overlays (with checkboxes for Parcels, Land Use, Soils, Water, and Railroad), Search, Legend, Help, Tools, and Ag Report. The 'Parcels' overlay is checked.

Tax Statement

Served by WEBSERVER-ONE

Holt County

0 Step 4 of 8

Perm ID 450020062	Name SCHULTE, JONATHAN A & KATHRYN M 506 N HILL ST PO BOX 847 ATKINSON NE 68713-0000	Legal ATKINSON V; BITNEY'S ADD BLK 28 LOTS 1-2-3-7-8 506 N HILL ST
-----------------------------	---	---

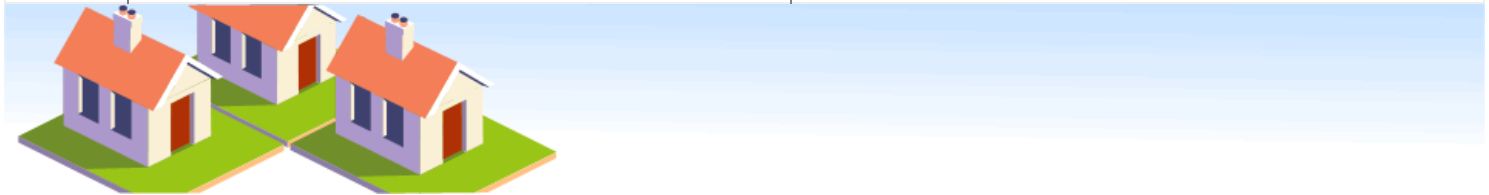

- [Levy Graph](#)
- [Value Graph](#)
- [Tax Graph](#)

Year	Statement	Value	Tax	Exemption	Net Tax	Balance Due
2018	011999	\$ 399,601	\$ 5,718.80	- \$ 345.66	\$ 5,373.14	\$ 5,373.14
2017	009586	\$ 383,780	\$ 5,341.18	- \$ 337.52	\$ 5,003.66	\$ 0.00
2016	011963	\$ 383,780	\$ 5,392.60	- \$ 343.76	\$ 5,048.84	\$ 0.00
2015	002142	\$ 383,780	\$ 5,664.20	- \$ 361.10	\$ 5,303.10	\$ 0.00
2014	009542	\$ 249,760	\$ 4,093.64	- \$ 178.68	\$ 3,914.96	\$ 0.00
2013	009489	\$ 7,125	\$ 122.44	- \$ 4.70	\$ 117.74	\$ 0.00
2012	070101	\$ 2,840	\$ 50.34	- \$ 2.04	\$ 48.30	\$ 0.00

The information provided in this site is the most recent and most accurate data available. All information contained herein is for informational purposes only. MIPS Inc does not warrant that such information is accurate and error free. This information is provided on an "as is" basis without warranties of any kind, either expressed or implied, including, but not limited to, the implied warranties of merchantability or fitness for a particular purpose. MIPS Inc shall not be liable for any direct, indirect, incidental, special or consequential damages arising out of the use of such information or the inability to use such information. MIPS also is not, nor shall be party to or subject to any warranty or any breach of any kind. The User acknowledges and agrees that the use of such information is at the sole risk of the User.

Copyright © 2004 Nebraska Association of County Officials. All rights reserved.