

26076

89-232

Introduce: 8-28-89

ORDINANCE NO. 15295

01 AN ORDINANCE creating Sidewalk Improvement District No. 85,
02 defining the limits thereof, providing for the construction, reconstruction,
03 replacement, or repair of public sidewalks therein, providing for the payment
04 of the cost thereof, designating the property to be benefited, providing for
05 the acquisition of easements and additional right-of-way, if necessary, and
06 repealing all ordinances or parts of ordinances in conflict herewith.

07 BE IT ORDAINED by the City Council of the City of Lincoln, Nebraska:

08 Section 1. That Sidewalk Improvement District No. 85, of the City of
09 Lincoln, Nebraska, be and the same is hereby created, that said Sidewalk
10 Improvement District shall include that area bounded on the north by Holdrege
11 Street; on the east by 70th Street; on the south by "A" Street; and on the
12 west by 48th Street; with construction, reconstruction, replacement or repair
13 of sidewalks as approved by the Director of Public Works for the following
14 described real estate benefited to-wit: All those properties legally described
15 in the attached "Exhibit A" which is hereby incorporated herein.

16 The cost of constructing, reconstructing, replacing or repairing the
17 sidewalks in said District, including the cost of grading the sidewalk space
18 and public street between the curb line and the property line and all
19 expenses incidental to all of this improvement shall be assessed against the
20 property benefited in said District in proportion to the benefits not
21 exceeding the cost thereof. In the event that easements or additional
22 right-of-way must be acquired for the completion of this district, such
23 property rights may be acquired by negotiation and purchase or by
24 condemnation, if necessary, as provided by law.

2

01 2. That all ordinances and parts of ordinances in conflict herewith be
02 and the same hereby are repealed.

03 3. This ordinance shall take effect and be in force from and after its
04 passage and publication according to law, but construction shall not be
05 commenced until ordered by resolution by the City Council.

Introduced by

Kenneth W. Haar

Approved as to Form:

Donna W. Poyer
City Attorney

AYES: Gutschell, Haar, Hempel,
Johanns, Seng, Wilson;
NAYS: None.
ABSENT: Minnick.

Approved as to Description:

Ruth Robinson
City Engineer

Staff Review Completed:

[Signature]
Administrative Assistant

Preliminary Cost Estimate:

KKH1077

APPROVED

SEP 19, 1989

Bill Harris
MAYOR

PASSEL

SEP 11 1989

CITY COUNCIL

3

C E R T I F I C A T E

I, Paul A. Malzer, City Clerk of the City of Lincoln, Nebraska, do certify that the above and foregoing is a true and correct copy of Ordinance No. 15295 - Creating Sidewalk Improvement District No. 85

as passed and approved by the City Council of the City of Lincoln, Nebraska, at its meeting held September 11, 1989 as the original appears of record in my office, and is now in my charge remaining as City Clerk aforesaid.

IN WITNESS WHEREOF, I have hereunto set my hand officially and affixed the seal of the City of Lincoln, Nebraska, this 13th day of September, 1989.

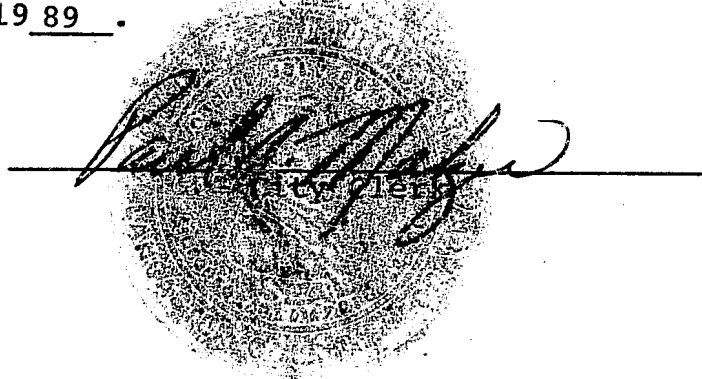

5

2

TAX # NAME AND ADDRESS
0600741 HARSCH, LEONARD H & MILDRED R
INSPTR 6747 STARR
DC LINCOLN, NE 68505

ENPL
LEGAL
ENDOWMENT PLACE BLOCK 6 LDT
1 TO 3

SECTION 1-3

SEQUENCE 1 LOCATION 06947 STARR ST

0600334 KOERNER, LEONARD J & CAROLE E
INSPTR 6900 STARR
DC LINCOLN, NE 68505

ENDOWMENT PLACE BLOCK 01
LOT 8

SECTION 1-3

SEQUENCE 2 LOCATION 06900 STARR ST

0600351 SURMAEZ, JAN & KATARZYNA
INSPTR 6920 STARR
DC LINCOLN, NEBR. 68505

ENDOWMENT PLACE BLK 1-LDT
10

SECTION 1-3

SEQUENCE 3 LOCATION 06920 STARR ST

0600385 SMITH, DON
INSPTR 6948 STARR
DC LINCOLN, NE 68505

ENDOWMENT PLACE BLOCK 01
LOT 13

SECTION 1-3

SEQUENCE 5 LOCATION 06948 STARR ST

0600395 ZIPP, HELEN M
INSPTR 1401 N 70
DC LINCOLN, NE 68505

ENDOWMENT PLACE BLOCK 01
LOT 14

SECTION 1-3

SEQUENCE 6 LOCATION 01401 ND 70 ST

0600296 SMITH, LEONARD L & DORIS D
INSPTR 1445 N 70
DC LINCOLN, NE 68505

ENDOWMENT PLACE BLOCK 01
LOT 1&2

SECTION 1-3

SEQUENCE 7 LOCATION 01445 ND 70 ST

6

6

3

TAX # NAME AND ADDRESS LEGAL
 0600407 BRANNEN, PAUL G. & SANDRA ENDOWMENT PLACE BLOCK 02
 INSPTR 670 BRUCE BRANSON LOT 1&2
 DC 6839 HOLDREGE STREET
 LINCOLN, NE 68505

SECTION 1-3

SEQUENCE 9 LOCATION 06839 HOLDREGE ST

0600415 CARTER, SHIRLEY A ENDOWMENT PLACE BLOCK 02
 INSPTR 4119 SHERIDAN BLVD LOT 3&4
 DC LINCOLN, NE 68506

SECTION 1-3

SEQUENCE 10 LOCATION 06827 HOLDREGE ST

0600474 SHUCK, WARREN F ENDOWMENT PLACE BLOCK 2 LOT
 INSPTR 6820 STARR 10
 DC LINCOLN, NEBR. 68505

SECTION 1-3

SEQUENCE 12 LOCATION 06820 STARR ST

0600733 YEGGY, JAMES F & RITA C ENDOWMENT PLACE BLOCK 5
 INSPTR 6842 DUDLEY ST LOTS 11 & 12
 DC LINCOLN, NE 68505

SECTION 1-3

SEQUENCE 13 LOCATION 06842 DUDLEY ST

0600717 SMITH, RONALD D & JACQUELYN EDNOWNMENT PLACE ALL L 9 &
 INSPTR 6820 DUDLEY E10' LOT
 DC LINCOLN, NE 68505 8 BLK 5

SECTION 1-3

SEQUENCE 15 LOCATION 06820 DUDLEY ST

0600709 MAPEL, DWAIN & DONNA ENDOWMENT PLACE LOT 7 & EX
 INSPTR 5501 SO 68 E10' LOT 8
 DC LINCOLN, NE 68516 BLK 5

SECTION 1-3

SEQUENCE 16 LOCATION 06802 DUDLEY ST

7

4

BETHANY

TAX # NAME AND ADDRESS
0469815 PRICE, JOE R & MARIAN L
INSPTR 6735 LEXINGTON CIR
DC LINCOLN, NE 68505

LEGAL
BETHANY BLOCK 70
THAT PT LYING EAST OF
COTNER BLVD OF
LOTS 1, 2, 3, 4, 5, & 6

SECTION 1-3

SEQUENCE 17 LOCATION 01340 NO COTNER BLV

0470244 BURKHART, JOSEPHINE A
INSPTR 1205 NO 66
DC LINCOLN, NE 68505

BETHANY HEIGHTS BLOCK 79 LOT
6

SECTION 1-3

SEQUENCE 18 LOCATION 01205 NO 66 ST

0470198 MILLER, DALTON C & ERMA V
INSPTR 1245 N 66
DC LINCOLN, NEBR. 68505

BETHANY HEIGHTS BLOCK 79 LOT
1

SECTION 1-3

SEQUENCE 19 LOCATION 01245 NO 66 ST

0470180 HALL, BOB
INSPTR 600 LAKEWOOD DR
DC LINCOLN, NE 68510

BETHANY S114.6' B 78 LYING
E & S OF
COTNER BLVD

NO
LOTS

SECTION 1-3

SEQUENCE 20 LOCATION 01200 NO COTNER BLV

0470287 GATES, EDNA
INSPTR 516 NO 66
DC LINCOLN, NE 68505

BETHANY HEIGHTS BLOCK 79
5100' LDT 7

SECTION 1-3

SEQUENCE 21 LOCATION 01202 NO 65 ST

1310547 CORNING, CHARLES E
INSPTR 6520 Y ST
DC LINCOLN, NE 68505

BETHANY HEIGHTS ADD BLOCK
94 LOT 1

SECTION 1-3

SEQUENCE 23 LOCATION 01037 NO 65 ST

6

8

TAX # NAME AND ADDRESS
0470929 FOTINDS, HARRIET L
INSPTR 1140 NO 45
DC LINCOLN, NE 68505

LEGAL
BETHANY 51/2 VAC ALLEY ADJ
AND E20' LOT 6 &
ALL LOT 7 BLK 09

SECTION 1-3

SEQUENCE 24 LOCATION 06444 Y ST

0549495 LINCOLN, CITY OF
INSPTR PARKS & RECREATION DEPT.
DC 2740 A STREET
LINCOLN, NE 68508

COTNER
COTNER ADD BLK 15 LOTS 10,
11&12 EXEMPT

SECTION 1-3

SEQUENCE 30 LOCATION BETHANY PARK 66TH & VINE
(N.W. CORNER)

0549452 LINCOLN, CITY OF
INSPTR PARKS & RECREATION DEPT.
DC 2740 A ST
LINCOLN, NE 68510

COTNER
COTNER ADD BLOCK 16

SECTION 1-3

SEQUENCE 31 LOCATION BETHANY PARK 66TH & VINE
STREETS

0549487 CITY OF LINCOLN
INSPTR PARKS & RECREATION DEPT.
DC 2740 A STREET
LINCOLN, NE 68508

page
COTNER ADD BLK 17 EXEMPT

SECTION 1-3

SEQUENCE 32 LOCATION BETHANY PARK 66TH & VINE
STREET

0469319 TEXACO REFINING & MARKETING
INSPTR PO BOX 1650
DC TULSA, OK 74102

BETHANY
BETHANY E10' VAC ALLEY ADJ
& ALL L 1 & 2
BLK 63

SECTION 1-3

SEQUENCE 33 LOCATION 01441 NO COTNER BLV
FC FOOD MART

0469823 HUNTER, LYLE E & PATRICIA A
INSPTR 1300 N COTNER
DC LINCOLN, NE 68505

BETHANY
BETHANY EX ST PT S & E OF
BLVD L 7 BLK 70

SECTION 1-3

SEQUENCE 34 LOCATION 01300 NO COTNER BLV

9

6

TAX # NAME AND ADDRESS
0469252 MASTERS, WILLIAM E & RITA E
INSPTR 6401 HOLDREGE ST
DC LINCOLN, NE 68505

BETHANY
No
LOTS

LEGAL
BETHANY HEIGHTS BLOCK 62 W50
OF NW QTR

X

SECTION 1-3

SEQUENCE 36 LOCATION 06401 HOLDREGE ST

0469254 SCHIDLER, ROBERT L & EULA M
INSPTR 4411 HOLDREGE
DC LINCOLN, NEBR 68505

No
LOTS

BETHANY HEIGHTS BLOCK 62 W50
OF E100 OF
NW QTR

X

SECTION 1-3

SEQUENCE 37 LOCATION 06411 HOLDREGE ST

0469211 SCHOLLE, STEVE A & LORNA J
INSPTR 1443 NO 65
DC LINCOLN, NE 68505

No
LOTS

BETHANY N50 FT NE 1/4 BLK
62
(AKA N1/3 NE1/4)

X

SECTION 1-3

SEQUENCE 39 LOCATION 01443 NO 65 ST

0469220 BOMBERGER, SHIRLEY E.
INSPTR 1435 NO 65TH
DC LINCOLN, NEBR. 68505

No
LOTS

BETHANY N 50' S100' NE 1/4
BLK 62

X

SECTION 1-3

SEQUENCE 40 LOCATION 01435 NO 65 ST

0469238 SPENCE, WARREN C & ELLEN G
INSPTR 1425 NO 65
DC LINCOLN, NE 68505

No
LOTS

BETHANY BLK 62 S50' NE1/4

X

SECTION 1-3

SEQUENCE 41 LOCATION 01425 NO 65 ST

0469297 HOFFMEYER, BONITA R
INSPTR 1409 NO 65
DC LINCOLN, NE 68505

No
LOTS

BETHANY HEIGHTS N1/2 OF
SE1/4 BLOCK 62

X

SECTION 1-3

SEQUENCE 42 LOCATION 01409 NO 65 ST

6

10

7

TAX # NAME AND ADDRESS
0469904 MICK, LAVERNE D & MARLENE W
INSPTR 6100 ADAMS ST
DC LINCOLN, NE 68507

BETHANY
No
LOTS

LEGAL
BETHANY S 1/2 N 2/3 SE 1/4
BLK 71

X

SECTION 1-3

SEQUENCE 44 LOCATION 01309 ND 65 ST

0469971 LANDIS, RONALD D & JACQUELINE
INSPTR 6340 DUDLEY ST
DC LINCOLN, NE 68505

No
LOTS

BETHANY E53' W103' S122' E
1/2 BLK 72

X

SECTION 1-3

SEQUENCE 47 LOCATION 06340 DUDLEY ST

0470015 RINNE, DIANA L
INSPTR 6310 DUDLEY
DC LINCOLN, NE 68505

No
LOTS

BETHANY EX W100' SW 1/4 BLK
72

X

SECTION 1-3

SEQUENCE 48 LOCATION 06310 DUDLEY ST

0469963 ALM, EMIL E & MARGARET E
INSPTR 6330 DUDLEY
DC LINCOLN, NE 68505

No
LOTS

BETHANY HEIGHTS BLOCK 72 W
50 DF S 122
OF E HALF

X

SECTION 1-3

SEQUENCE 49 LOCATION 06330 DUDLEY ST

0469955 HELGET, RODNEY M. & FAYE
INSPTR 1317 N 64
DC LINCOLN, NEBR. 68505

No
LOTS

BETHANY E1/2 EX N123'
& EX S122' BLK 72

X

SECTION 1-3

SEQUENCE 50 LOCATION 01317 ND 64 ST

0469939 SMITH, CLYDA E
INSPTR 6313 STARR
DC LINCOLN, NEBR. 68505

No
LOTS

BETHANY NW 1/4 EX S60' BLK
72

X

SECTION 1-3

SEQUENCE 52 LOCATION 06313 STARR ST

6

11

8

TAX # NAME AND ADDRESS
0469122 SCHWEITZER, DAVID M & DENISE J
INSFTR C/O PAT KAORN
DC 6343 HOLDREGE STREET
LINCOLN, NE 68505

BETHANY
LEGAL
BETHANY HEIGHTS BLOCK 61 N
1THD OF NE QTR
No Lots

SECTION 1-3

SEQUENCE 53 LOCATION 06343 HOLDREGE ST

0470058 YOUNG, ROGER L & SHIRLEY J
INSFTR 6301 DUDLEY
DC LINCOLN, NEBR. 68505

BETHANY N150' EX E240' BLK
77
No Lots

SECTION 1-3

SEQUENCE 55 LOCATION 06301 DUDLEY ST

0470158 B B T COMPANY
INSFTR 1217 N DUTNER
DC LINCOLN, NEBR. 68505

BETHANY EX ST N 1/3 SW 1/4
LYING N OF
DUTNER BLVD BLK 78
No Lots

SECTION 1-3

SEQUENCE 56 LOCATION 01217 NO DUTNER BLV

0470237 TYRRELLS FLOWERS
INSFTR 01133 N DUTNER BLVD
DC LINCOLN, NEBR. 68505

BETHANY THAY PT LOT 1 BLK
39 WEST OF DUTNER
BLVD & ALL LOTS 1 TO 7 BLK
90 & VAD
E-W ALLEY ADJ

SECTION 1-3

SEQUENCE 58 LOCATION 01133 NO DUTNER BLV

0470981 ELSON, LARRY R
INSFTR 06309 Y ST
DC LINCOLN, NE 68505

BETHANY HEIGHTS BLOCK 93
LOT 5

SECTION 1-3

SEQUENCE 61 LOCATION 06309 Y ST

0470953 BAUELER, JAMES L & SANDRA LEE
INSFTR 1040 NO 63
DC LINCOLN, NE 68505

BETHANY
LOT 6 BLK 93

SECTION 1-3

SEQUENCE 62 LOCATION 01040 NO 63 ST

6

12

9

TAX # NAME AND ADDRESS
0549151 KONECKY, DARRYL R.
INSPTR 6310 X ST
DC LINCOLN, NEBR. 68505

COTNER
LEGAL
COTNER ADDBLOCK 07 LOT 5
W30 LOT 6 E30

X

SECTION 1-3

SEQUENCE 64 LOCATION 06310 X ST

0601292 BROWNSON, MICHAEL L & EMMY
INSPTR 1140 NORTH 69
DC LINCOLN, NEBR. 68505

ENPL
ENDOWMENT PLACE BLOCK 12
LOT 7

X

SECTION 1-3

SEQUENCE 67 LOCATION 01140 NO 69 ST

0601284 FLECK, JEROME V & BARBARA L
INSPTR 6911 ORCHARD
DC LINCOLN, NE 68505

ENDOWMENT PLACE BLOCK 12
LOT 6

X

SECTION 1-3

SEQUENCE 68 LOCATION 06911 ORCHARD ST

0470554 BREED, MAX E & JANELLE D
INSPTR 6950 Y
DC LINCOLN, NE 68505

BETHANY
BETHANY HEIGHTS BLOCK 84
E3' LOT 6 & ALL LOT 7

X

SECTION 1-3

SEQUENCE 71 LOCATION 06950 Y ST

0470562 KELLER, DWAYNE E & MARION
INSPTR 6930 Y
DC LINCOLN, NEBR. 68505

BETHANY E17' L4 & W 39' L5
BLK 84

X

SECTION 1-3

SEQUENCE 73 LOCATION 06930 Y ST

0470538 COLLINS, ROY G & DELDRES N
INSPTR 6920 Y STREET
DC LINCOLN, NEBR. 68505

BETHANY HEIGHTS BLOCK 84
LOT 3 E 27
LOT 4 W 33

X

SECTION 1-3

SEQUENCE 74 LOCATION 06920 Y ST

6

13

10

TAX # NAME AND ADDRESS
0470520 HARTMAN, DWAIN E & EDITH V
INSPTR 6910 YN
DC LINCOLN, NE 68505

BETHANY

LEGAL
BETHANY HEIGHTS BLOCK 84
LOT 2 E 37
LOT 3 W 23

SECTION 1-3

SEQUENCE 75 LOCATION 06910 Y ST

0470511 THALKEN, GARY W & PATRICIA
INSPTR 1100 N 69
DC LINCOLN, NEBR. 68505

BETHANY HEIGHTS BLOCK 84
LOT 1 LOT 2 W 13

SECTION 1-3

SEQUENCE 76 LOCATION 01100 NO 69 ST

0601047 JANSSEN, GILBERT L & JUDY A
INSPTR 6821 DUDLEY
DC LINCOLN, NEBR. 68505

ENPL

ENDOWMENT PLACE BLOCK 9 LOT
4

SECTION 1-3

SEQUENCE 80 LOCATION 06821 DUDLEY ST

0601039 CHUDA, LARRY L & JUDITH M
INSPTR 1230 NO. 68TH ST.
DC LINCOLN, NEBR. 68505

ENDOWMENT PLACE 570' LOTS 5
& 6 BLK 8

SECTION 1-3

SEQUENCE 81 LOCATION 01230 NO 68 ST

0600989 SNELL, GLEN L & JOYCE D
INSPTR 1201 NO 70
DC LINCOLN, NEBR. 68505

ENDOWMENT PLACE BLOCK 7 LOT
14

SECTION 1-3

SEQUENCE 87 LOCATION 01201 NO 70 ST

0470635 DENNLER, RANDALL D & ANN B
INSPTR 6707 ORCHARD
DC LINCOLN, NE 68505

BETHANY

BETHANY HEIGHTS BLOCK 84
LOT 3

SECTION 1-3

SEQUENCE 91 LOCATION 06707 ORCHARD ST

14

11

TAX # NAME AND ADDRESS
0601152 ATWOOD, LARRY & BARBARA
INSPTR 6921 ORCHARD
DC LINCOLN, NE 68505

ENL¹³ LEGAL
ENDOWMENT PLACE BLOCK 09
LOT 6 7 8

SECTION 1-3

SEQUENCE 93 LOCATION 06728 ORCHARD ST

0601101 HILLER, GERALD C & MELODY A
INSPTR 6743 DUDLEY
DC LINCOLN, NE 68505

ENDOWMENT PLACE BLOCK 09
LOT 1

SECTION 1-3

SEQUENCE 94 LOCATION 06743 DUDLEY ST

0601128 RICKETS, HARVEY A
INSPTR 7001 AYLESWORTH
DC LINCOLN, NE 68505

ENDOWMENT PLACE BLOCK 09
LOT 3

SECTION 1-3

SEQUENCE 95 LOCATION 06727 DUDLEY ST

0470414 ALLEN, GEORGE H JR & SYBIL C
INSPTR 6444 LEIGHTON ST
DC LINCOLN, NE 68507

BETHANY
BETHANY HEIGHTS BLOCK 81 LOT
3 S HALF

SECTION 1-3

SEQUENCE 98 LOCATION 01236 ND 67 ST

0470376 HAHN, LUCILE M
INSPTR 1211 N 67
DC LINCOLN, NEBR. 68505

BETHANY HEIGHTS BLOCK 80
LOT 10 TO 12 N65

SECTION 1-3

SEQUENCE 102 LOCATION 01211 ND 67 ST

0470341 SHEAR, JOYCE
INSPTR 1218 ND 66
DC LINCOLN, NE 68505

BETHANY HEIGHTS BLOCK 80
LOT 7

SECTION 1-3

SEQUENCE 105 LOCATION 01218 ND 66 ST

6

15

BETHANY 12

TAX # NAME AND ADDRESS
0470333 BUCK, JAMES B & PATRICIA K
INSPTR 1224 NO 66TH ST
DC LINCOLN, NEBR. 68505

LEGAL
BETHANY HEIGHTS BLOCK 80
LOT 6 W1/2 VAC ALL

X

SECTION 1-3

SEQUENCE 106 LOCATION 01224 NO 66 ST

0470325 YATES, ELMER A & LUCILLE
INSPTR 1228-30 N 66
DC LINCOLN, NEBR. 68505

BETHANY HEIGHTS BLOCK 80
LOT 5

X

SECTION 1-3

SEQUENCE 107 LOCATION 01230 NO 66 ST

0470791 STOCKFIELD, AMELIA ET AL
INSPTR 1127 N 66
DC LINCOLN, NEBR. 68505

BETHANY HEIGHTS BLOCK 88 LOT
2 S HALF LOT 3

X

SECTION 1-3

SEQUENCE 109 LOCATION 01127 NO 66 ST

0470805 CORNING, CHARLES E & LOIS
INSPTR 1119 NO 66
DC LINCOLN, NEBR. 68505

BETHANY HEIGHTS BLOCK 88
LOT 4

X

SECTION 1-3

SEQUENCE 110 LOCATION 01119 NO 66 ST

0469777 HINKLEY, LLOYD D
INSPTR 5440 FAIRDALE RD
DC LINCOLN, NE 68510

BETHANY
W2' LOT 2 & LOTS 3 THRU 9 &
VAC N-S ALLEY BLK 69

X

SECTION 1-3

SEQUENCE 116 LOCATION 01300 NO 66 ST

0469769 HINKLEY, LLOYD D
INSPTR 5440 FAIRDALE RD
DC LINCOLN, NE 68510

BETHANY
EX W2FT L2 & ALL LOT 1 BLK
69

X

SECTION 1-3

SEQUENCE 117 LOCATION 06645 STARR ST

6

16

13

TAX # NAME AND ADDRESS
0469360 MAHONEY ENTERPRISES INC
INSPTR 7420 SOUTH #7
DC LINCOLN, NE 68506

LEGAL
BETHANY
LOTS 6 7 8 & 9 BLK 64

SECTION 1-3

SEQUENCE 119 LOCATION 01402 NO COTNER BLV

0469343 HUB HALL CO
INSPTR 111 PIAZZA TER
DC LINCOLN, NEBR. 68510

BETHANY HEIGHTS BLOCK 64 LOT 3

SECTION 1-3

SEQUENCE 120 LOCATION 06629 HOLDREGE ST

0600563 SAHS, ROB R. & LAURIE
INSPTR 6728 STARR
DC LINCOLN, NE 68505

ENPL
ENDOWMENT PLACE BLOCK 03
LOT 6

SECTION 1-3

SEQUENCE 127 LOCATION 06728 STARR ST

0469718 STOKI, STANLEY R & PATRICIA H
INSPTR 1340 NO 67
DC LINCOLN, NE 68505

BETHANY
BETHANY HEIGHTS BLOCK 68 LOT 3

SECTION 1-3

SEQUENCE 128 LOCATION 01340 NO 67 ST

0600644 WILLIAMS, LEONA
INSPTR 1321 NO 68
DC LINCOLN, NE 68505

ENPL
ENDOWMENT PLACE BLOCK 4 LOT 4 TRI ON REAR
LOTS 7 & 8 N 51 FT

SECTION 1-3

SEQUENCE 133 LOCATION 01321 NO 68 ST

0469700 WILSON, DON S.
INSPTR 6711 STARR
DC LINCOLN, NE 68505

BETHANY
BETHANY HEIGHTS BLOCK 68
LOT 2

SECTION 1-3

SEQUENCE 137 LOCATION 06711 STARR ST

6

17

14

TAX CODE	NAME & ADDRESS	LEGAL
0600792 INSPTR DC	HYLE, GAYLE E 4303 SOUTH LINCOLN, NE	ENDOWMENT PLACE BLOCK & LOT 9
SECTION 1-3	LOCATION 06910	DUDLEY ST
SEQUENCE 139		
0200814 INSPTR DC	PASKA, EMIL J JR. 6930 DUDLEY LINCOLN, NEBR	ENDOWMENT PLACE BLOCK & LOT 11
SECTION 1-3	LOCATION 06930	DUDLEY ST
SEQUENCE 141		
0200831 INSPTR DC	MOORE, BETTY A 950 FURNAS LINCOLN, NE	ENDOWMENT PLACE BLOCK & LOT 13
SECTION 1-3	LOCATION 06950	DUDLEY ST
SEQUENCE 142		
0600849 INSPTR DC	JEANETTE, DOUGLAS D & M SMOLIK 1301 NO 70 LINCOLN, NEBR.	ENDOWMENT PLACE BLOCK & LOT 14
SECTION 1-3	LOCATION 01301 NO 70	ST
SEQUENCE 143		
0549215 INSPTR DC	HELLENIC ORTHODOX CHURCH OF THE ANNUNCIATION 950 NO 63 LINCOLN, NE	COTNER BLOCK 1 COTNER ADD, W26.51' N70' L1 & 2 & S25' L2 & L3 & 4 & N1/2 L5 & N1/2 L12 & 13 - 16 INC. & ALL VA STREETS & ALLEY
SECTION 1-3	LOCATION 06301	X ST
SEQUENCE 144		
0549185 INSPTR DC	CITY OF LINCOLN MAINTENANCE DIVISION	COTNER LTS 7 TO 10 BLK 8 COTNER ADD
SECTION 1-3	LOCATION 00901 NO COTNER	BLV
SEQUENCE 146		

6

18

15

pt 11-7

TAX # 0549461
NAME AND ADDRESS
GASPAR, OTTO
% CHATEAU LAFLEUR
DC 1025 NO 63
LINCOLN, NE 68505

LEGAL
COTNER ADD B17 L4 TO 7 N OF
COTNER BLVD & S HALF
VAC ST ADJ ON NO

SECTION 1-3

SEQUENCE 147

LOCATION 815 NO COTNER

0943126 TROUBA, MARVIN & JEANETTE
INSPTR 1731 DONALD CIR
DC LINCOLN, NE 68505

SUAC
SUNNYSIDE ACRES FIRST ADD
BLOCK 1 LOT 1

SECTION 1-3

SEQUENCE 150

LOCATION 06111 HOLDREGE ST

0943193 MERTLIK, JAMES & SANDRA L
INSPTR 1340 NO 61 ST
DC LINCOLN, NE 68505

SUNNYSIDE ACRES FIRST ADD
BLOCK 1 LOT 8

SECTION 1-3

SEQUENCE 152

LOCATION 01340 NO 61 ST

0943045 HULS, CAROL A
INSPTR 5945 TANGEMAN TERRACE
DC LINCOLN, NE 68505

SUAC
SUNNYSIDE ACRES BLOCK 04
LOT 4

SECTION 1-3

SEQUENCE 154

LOCATION 05945 TANGEMAN TER

0943053 SMDLIK, MARTIN J & LYDIA ET AL
INSPTR 5914 FIELDCREST WAY
DC LINCOLN, NE 68512

SUNNYSIDE ACRES BLOCK 04
LOT 5

SECTION 1-3

SEQUENCE 155

LOCATION 05935 TANGEMAN TER

0943088 HARRIMAN, DAMON D & BARBRAELLA
INSPTR 5911 TANGEMAN TERRACE
DC LINCOLN, NE 68505

SUNNYSIDE ACRES BLOCK 04
LOT 8

SECTION 1-3

SEQUENCE 156

LOCATION 05911 TANGEMAN TER

6

19

16

TAX # NAME AND ADDRESS
0943096 STUECK, MICHAEL
INSPTR 5901 TANGEMAN TERRACE
DC LINCOLN, NEBR. 68505

30AC

LEGAL
SUNNYSIDE ACRES BLOCK 4 LOT
9 & E1/2 VAC NO 59TH ST ADJ

SECTION 1-3

SEQUENCE 157 LOCATION 5901 TANGEMAN TERRACE

0943118 WATERMEIER, MARK R & KAREN R
INSPTR 5900 NORFOLK DR
DC LINCOLN, NE 68505

SUNNYSIDE ACRES BLOCK 05
LOT 2

SECTION 1-3

SEQUENCE 158 LOCATION 05829 TANGEMAN TER

0943002 WITTMANN BROS LTD
INSPTR 1/2 TRUST DEPT UNION BANK
DC PO BOX 6155
LINCOLN, NE 68506

SUNNYSIDE ACRES BLOCK 03
LOT 8

SECTION 1-3

SEQUENCE 159 LOCATION 01401 NO 59 ST

0942995 SCHEFFERT, ALBERT M & BETTY J
INSPTR 1407 NO 59
DC LINCOLN, NE 68505

SUNNYSIDE ACRES BLOCK 03
LOT 7

SECTION 1-3

SEQUENCE 160 LOCATION 01407 NO 59 ST

0550884 DENSBERGER, JOY C & NANCY R
INSPTR 7311 WHITESTONE DR
DC LINCOLN, NE 68506

CO^{THE} COTNER HEIGHTS BLOCK 3 LOT 6

SECTION 1-3

SEQUENCE 161 LOCATION 05940 R ST

0550833 VOGLER, LORI L
INSPTR PO BOX 67012
DC LINCOLN, NE 68506

COTNER HEIGHTS BLOCK 3 LOT
1

SECTION 1-3

SEQUENCE 162 LOCATION 00440 NO COTNER BLV

6

20

17

TAX # NAME AND ADDRESS
0550868 DALEY, JAMES S & BONNIE
INSPTR 822 ELDON DR
DC LINCOLN, NEBR. 68510

^{COTHE} LEGAL
COTNER HEIGHTSBLOCK 3 LOT 4

SECTION 1-3

SEQUENCE 164. LOCATION 00410 NO COTNER BLV

0550876 DALEY, JAMES S & BONNIE COTNER HEIGHTSBLOCK 3 LOT 5
INSPTR 822 ELDON DR
DC LINCOLN, NEBR. 68510

SECTION 1-3

SEQUENCE 165 LOCATION 00400 NO COTNER BLV

0672408 TEMPLE, BENJAMIN F & JANICE K
INSPTR 601 N 67
DC LINCOLN, NE 68505

HERBRADL

HERBERT BROS PARK PLAZA
BLOCK 2 LOT 10

SECTION 1-3

SEQUENCE 166 LOCATION 00601 NO 67 ST

0672394 BRILL, DAVID L & LINDA A
INSPTR 600 N 67
DC LINCOLN, NEBR. 68505

HERBERT BROS PARK PLAZA
BLOCK 2 LOT 9

SECTION 1-3

SEQUENCE 167 LOCATION 00600 NO 67 ST

0672386 BRODD, RICHARD D & PEARL D
INSPTR 608 N 67
DC LINCOLN, NE 68505

HERBERT BROS PARK PLAZA
BLOCK 2 L 8

SECTION 1-3

SEQUENCE 168 LOCATION 00608 NO 67 ST

0672378 OMEARA, JOAN
INSPTR 616 NO 67
DC LINCOLN, NE 68505

HERBERT BROS PARK PLAZA
BLOCK 2 LOT 7

SECTION 1-3

SEQUENCE 169 LOCATION 00616 NO 67 ST

6

21

15

HERBRPAPL

TAX # NAME AND ADDRESS
0672351 HESSON KEVIN M &
INSPTR NALLEY, DIANE E
DC 630 NO 67 ST
LINCOLN, NE 68505

LEGAL
HERBERT BROS PARK PLAZA
BLOCK 2 LOT 5

X

SECTION 1-3

SEQUENCE 170 LOCATION 00630 NO 67 ST

0672343 HOVELING, NORMAN J & DORIS M
INSPTR 636 NO 67
DC LINCOLN, NEBR. 68505

HERBERT BROS PARK PLAZA
BLOCK 2 LOT 4

SECTION 1-3

SEQUENCE 171 LOCATION 00636 NO 67 ST

0672335 NEITZEL, FRANCIS E & ELIZABETH
INSPTR 640 NO 67
DC LINCOLN, NE 68505

HERBERT BROS PARK PLAZA
BLOCK 2 LOT 3

SECTION 1-3

SEQUENCE 172 LOCATION 00640 NO 67 ST

0672327 STEVENS, GLENN W JR & ELAINE L
INSPTR 648 NO 67
DC LINCOLN, NE 68505

HERBERT BROS PARK PLAZA
BLOCK 2 LOT 2

SECTION 1-3

SEQUENCE 173 LOCATION 00648 NO 67 ST

0672319 PETERSON, DOUGLAS D. & DONNA
INSPTR 6711 MARCIA LN
DC LINCOLN, NE 68505

HERBERT BROS PARK PLAZA
BLOCK 2 LOT 1

SECTION 1-3

SEQUENCE 174 LOCATION 06711 MARCIA LN

WIJUPAVI

1024285 UERLING, DONALD F. & LONA
INSPTR 626 NO 68
DC LINCOLN, NEBR. 68505

WITT & JUCKETTE PARK VIEW
BLOCK 1 LOT 10

SECTION 1-3

SEQUENCE 180 LOCATION 00626 NO 68 ST

6

22

19

TAX # NAME AND ADDRESS
1024277 MURTAUGH, MICHAEL P & SUSAN M
INSPTR 632 NO 68
DC LINCOLN, NE 68505

WITT & JUCKETTE PARK VIEW
LEGAL
BLOCK 1 LOT 9

SECTION 1-3

SEQUENCE 181 LOCATION 00632 NO 68 ST

1024289 MILLER, FLOYD H. & NONA G
INSPTR 638 N 68
DC LINCOLN, NEBR. 68505

WITT & JUCKETTE PARK VIEW
BLOCK 1 LOT 8

SECTION 1-3

SEQUENCE 182 LOCATION 00638 NO 68 ST

0672254 STERNS, DIANNE L
INSPTR 6401 CARLSBAD DR
DC LINCOLN, NE 68510

HERBERT BROS PARK PLAZA
BLOCK 1 LOT 9

SECTION 1-3

SEQUENCE 189 LOCATION 06610 MARCIA LN

0672491 BORGMANN, WM F JR & LEORA M
INSPTR 6631 MARCIA LANE
DC LINCOLN, NE 68505

HERBERT BROS PARK PLAZA
BLOCK 2 LOT 19

SECTION 1-3

SEQUENCE 190 LOCATION 06631 MARCIA LN

0672483 CRAMLET, LYLE D & SHERYL E
INSPTR 653 NO 67
DC LINCOLN, NEBR. 68505

HERBERT BROS PARK PLAZA
BLOCK 2 LOT 18

SECTION 1-3

SEQUENCE 191 LOCATION 00653 NO 67 ST

0672475 EDWARDS, RONALD L & GERALDINE
INSPTR 647 NO 67
DC LINCOLN, NE 68505

HERBERT BROS PARK PLAZA
BLOCK 2 LOT 17

SECTION 1-3

SEQUENCE 192 LOCATION 00647 NO 67 ST

6

23

20

HEISR PA PL
LEGAL

TAX # NAME AND ADDRESS
0672416 MOHLMAN, ROBERT N & DARLENE M
INSPTR 609 N 67
DC LINCOLN, NE 68505

HERBERT BROS PARK PLAZA
BLOCK 2 LOT 11

SECTION 1-3

SEQUENCE 195 LOCATION 00609 NO 67 ST

0672530 NITZ, ERNEST H & FLORA C
INSPTR 624 NO 66
DC LINCOLN, NEBR. 68505

HERBERT BROS PARK PLAZA
BLOCK 2 LOT 23

SECTION 1-3

SEQUENCE 196 LOCATION 00624 NO 66 ST

0672548 RODENBURG, STANLEY W & RUTH F
INSPTR 609 GLENHAVEN DR
DC LINCOLN, NE 68505

HERBERT BROS PARK PLAZA BLK
2 LT 24 ALL &
LT 25 NO 30

SECTION 1-3

SEQUENCE 197 LOCATION 00614 NO 66 ST

0724408 FLOWER VIEW ASSOCIATES
INSPTR 1/2 BLANTZ, IRWIN
DC 60 EAST 42 ST #2022
NEW YORK, NY 10165

IRREG TRACT LOT 260 SE
21-10-7

SECTION 1-3

SEQUENCE 199 LOCATION 500 N 66 ST CODOE

0569330 BELL, TIMOTHY K & TRACY D
INSPTR 6835 JOYCE AVE
DC LINCOLN, NE 68505

EA EASTBOROUGH ADD
LOT 17 BLK 05

SECTION 1-3

SEQUENCE 200 LOCATION 06835 JOYCE AVE

0569194 UMPHREYS, HOPE E & NANCY E
INSPTR 519 ELDORA
DC LINCOLN, NE 68505

EASTBOROUGH ADD BLOCK 05
LOT 3

SECTION 1-3

SEQUENCE 201 LOCATION 00519 ELDORA LN

6

24

21

TAX # NAME AND ADDRESS
 0569257 DRUDIK, LOUIS L & BERTRICE A
 INSPTR 412 EASTBOROUGH
 DC LINCOLN, NE 68505

EA LEGAL
 EASTBOROUGH ADD BLOCK 05
 LOT 9

SECTION 1-3

SEQUENCE 202 LOCATION 00412 EASTBOROUGH LN

0569267 BRETHOWER, WILMA R & HAROLD
 INSPTR 422 EASTBOROUGH
 DC LINCOLN, NEBR. 68505

EASTBOROUGH ADD BLOCK 05
 LOT 10

SECTION 1-3

SEQUENCE 203 LOCATION 00422 EASTBOROUGH LN

0569305 YOUNG, LARRY A & KIMBERLY
 INSPTR 316 EASTBOROUGH
 DC LINCOLN, NE 68505

EASTBOROUGH ADD BLOCK 05
 LOT 14

SECTION 1-3

SEQUENCE 205 LOCATION 00516 EASTBOROUGH LN

0569313 LEFHOLTZ, BILLIE K
 INSPTR 526 EASTBOROUGH LN
 DC LINCOLN, NE 68505

EASTBOROUGH ADD BLOCK 05
 LOT 15

SECTION 1-3

SEQUENCE 206 LOCATION 00526 EASTBOROUGH LN

0569321 LIEN, WM R & MARY A
 INSPTR 536 EASTBOROUGH
 DC LINCOLN, NEBR. 68505

EASTBOROUGH ADD BLOCK 05
 LOT 16

SECTION 1-3

SEQUENCE 207 LOCATION 00536 EASTBOROUGH LN

0569437 HALL, DONALD D & MARILYN A
 INSPTR 427 EASTBOROUGH
 DC LINCOLN, NE 68505

EASTBOROUGH ADD BLOCK 06
 LOT 10

SECTION 1-3

SEQUENCE 213 LOCATION 00427 EASTBOROUGH LN

6

28

22

TAX # NAME AND ADDRESS
0567453 FLEMING, MARY T
INSPTR 3435 NO 70TH
DC LINCOLN, NE 68507

EA LEGAL
EASTBOROUGH ADD BLOCK 06 X
LOT 12

SECTION 1-3

SEQUENCE 214 LOCATION 00415 EASTBOROUGH LN

0568776 JEFFREY COMPANY
INSPTR 3601 CALVERT
DC LINCOLN, NEBR. 68506

EASTBOROUGH ADD BLOCK 03 X
LOT 11

SECTION 1-3

SEQUENCE 215 LOCATION 00616 EASTBOROUGH LN

0569011 CHAILLIE, RICH
INSPTR 2 SHAWN PIESHKE
DC 626 EASTBOROUGH
LINCOLN, NE 68505

EASTBOROUGH ADD BLOCK 03 A
LOT 13

SECTION 1-3

SEQUENCE 217 LOCATION 00626 EASTBOROUGH LN

0569020 PEARLSTEIN, EDGAR A
INSPTR 632 EASTBOROUGH LN
DC LINCOLN, NEBR. 68505

EASTBOROUGH ADD BLOCK 03
LOT 14

SECTION 1-3

SEQUENCE 218 LOCATION 00632 EASTBOROUGH LN

0569038 LADA, ELDORA J
INSPTR 642 EASTBOROUGH
DC LINCOLN, NEBR. 68505

EASTBOROUGH ADD BLOCK 03 d
LOT 15

SECTION 1-3

SEQUENCE 219 LOCATION 00642 EASTBOROUGH LN

0568879 RAY, JOHN H & DENISE W
INSPTR 647 ELDORA LANE
DC LINCOLN, NE 68505

EASTBOROUGH ADD BLOCK 03 d
LOT 1

SECTION 1-3

SEQUENCE 220 LOCATION 00647 ELDORA LN

6

26

23

TAX # NAME AND ADDRESS
0568970 BARMORE, DAVID M & DEBRA L
INSPTR 6834 JOYCE
DC LINCOLN, NE 68505

LEGAL
EASTBOROUGH ADD BLOCK 03
LOT 9

SECTION 1-3

SEQUENCE 225 LOCATION 06834 JOYCE AVE

0568635 DEHLERKING, HAZEL & RICHARD
INSPTR ET AL 6838 MARCIA
DC LINCOLN, NE 68505

EASTBOROUGH ADD BLOCK 01
LOT 12

Block 1

SECTION 1-3

SEQUENCE 226 LOCATION 06838 MARCIA LN

0568619 SPATH, HARLAN & GAYLE
INSPTR 6800 MARCIA LN
DC LINCOLN, NE 68505

EASTBOROUGH ADD BLOCK 01
LOT 10

Block 1

SECTION 1-3

SEQUENCE 227 LOCATION 06800 MARCIA LN

0569071 IHFE, HARRY N & FERNE M
INSPTR 721 EASTBOROUGH
DC LINCOLN, NEBR. 68505

EASTBOROUGH ADD BLOCK 04
LOT 3

SECTION 1-3

SEQUENCE 228 LOCATION 00721 EASTBOROUGH LN

0569089 ANDERSON, BURTON N & RAMONA K
INSPTR 701 EASTBOROUGH
DC LINCOLN, NE 68505

EASTBOROUGH ADD BLOCK 04
LOT 4

SECTION 1-3

SEQUENCE 229 LOCATION 00701 EASTBOROUGH LN

0569097 ORE, ROBERT J & EDNA
INSPTR 647 EASTBOROUGH
DC LINCOLN, NEBR. 68505

EASTBOROUGH ADD BLDCK 04
LOT 5

SECTION 1-3

SEQUENCE 230 LOCATION 00647 EASTBOROUGH LN

6

27

24

TAX # NAME AND ADDRESS
0569160 DROZDA, MICHAEL L & PATRICIA
INSPTR 601 EASTBOROUGH
DC LINCOLN, NE 68505

6A LEGAL
EASTBOROUGH ADD BLOCK 04
LOT 12

SECTION 1-3

SEQUENCE 234 LOCATION 00601 EASTBOROUGH LN

0724467 VANICE, KAER P III
INSPTR 9802 CRAIG DR
DC OVERLAND PARK, KS 66212

IRREG TRACT
L 245 SE 21-10-7

SECTION 1-3

SEQUENCE 235 LOCATION 06800 J ST
GOODYEAR AUTO SERVICE CTR

0569241 WHITTEMORE, ROSELLA B &
INSPTR LETITIA
DC 7219 ORCHARD
LINCOLN, NE 68505

6A EASTBOROUGH ADD BLOCK 05
LOT 8

SECTION 1-3

SEQUENCE 238 LOCATION 00400 EASTBOROUGH LN

0568700 LODDELL, GWENDOLYN S
INSPTR 621 NO 70
DC LINCOLN, NE 68505

EASTBOROUGH ADD BLOCK 02
LOT 4

SECTION 1-3

SEQUENCE 240 LOCATION 00621 NO 70 ST

0568694 ANDERSEN, JACK L & DONNA J
INSPTR 8105 50 CHERRYWOOD DR
DC LINCOLN, NEBR. 68510

EASTBOROUGH ADD BLOCK 02
LOT 3

SECTION 1-3

SEQUENCE 241 LOCATION 00627 NO 70 ST

0568539 HALL, DONALD D. & MARILYN
INSPTR 725 NO 70 ST
DC LINCOLN, NEBR. 68505

EASTBOROUGH ADD BLOCK 01
LOT 2

Block 1

SECTION 1-3

SEQUENCE 243 LOCATION 00725 NO 70 ST

6

28

25

TAX # NAME AND ADDRESS
0568562 SCHEULER, MARJORIE J & STEVEN
INSPTR 309 ALEXANDER CT
DC LINCOLN, NE 68516

CA
LEGAL
EASTBOROUGH ADD BLOCK 01
LOT 5
Block 1

SECTION 1-3

SEQUENCE 244 LOCATION 06911 VINE ST

1024196 WALLA, ADOLPH R & LOUISE T
INSPTR 740 NO 68
DC LINCOLN, NE 68505

WITT & SUCKETTE PARK VIEW
BLOCK 1 LOT 1
Block 1

SECTION 1-3

SEQUENCE 245 LOCATION 00740 NO 68 ST

0672203 BOHAM, RONALD R
INSPTR 6631 VINE ST
DC LINCOLN, NE 68505

HERBERT BROS PARK PLAZA
BLOCK 1 LOT 4
Block 1

SECTION 1-3

SEQUENCE 247 LOCATION 06631 VINE ST

0672521 METCALF, GLEN & MARCELLA ET AL
INSPTR 632 NO 66 ST
DC LINCOLN, NEBR. 68505

HERBERT BROS PARK PLAZA
BLOCK 2 LOT 22

SECTION 1-3

SEQUENCE 251 LOCATION 00632 NO 68 ST

0631752 FIJAN, LODGE, FRITCH & SHAFER
INSPTR 630 NO COTNER
DC LINCOLN, NEBR. 68505

GATE
GATEWAY TERRACE
LOT 2 BLK 1
Block 1

SECTION 1-3

SEQUENCE 252 LOCATION 00630 NO COTNER BLV

0631761 ALLIED MUTUAL INS CO
INSPTR ATT: STAFF ACCOUNTING
DC 701 FIFTH AVE
DES MOINES, IA 50309

GATEWAY TERRACE PT LT 1 BLK
1 2.524 ACRES

SECTION 1-3

SEQUENCE 253 LOCATION 00700 NO COTNER BLV

GATE BLOCK

6

29

26

GATEWAY

TAX # 0631775
NAME AND ADDRESS GATEWAY EXECUTIVE CENTER
INSPTR PARTNERSHIP
DC 770 NO COTNER SUITE #403B
LINDOLN, NE 68505

LEGAL
GATEWAY TERRACE REPLAT
LOT 1

NO 510-6

SECTION 1-3

SEQUENCE 254

LOCATION 00770 NO COTNER BLV
FC

0724343 AMERITAS LIFE INSURANCE CO
INSPTR PO BOX 81889
DC LINCOLN, NE 68501

IRREG TRACTS LOT 261 SE
21-10-7

SECTION 1-3

SEQUENCE 257

LOCATION 633 NO 66

0724378 DUBOSE, J S
INSPTR PO BOX 2990
DC FORT WORTH, TX 76195

IRREG TR LT 131 SE 21-10-7

SECTION 1-3

SEQUENCE 258

LOCATION 601 NO 66

0724513 BANKERS LIFE INS CO OF NEBR.
INSPTR WJACOBS, VISCONSINI & JACOBS CO
DC 25425 CTR RIDGE RD ATTN: JAMES
SUDINE CLEVELAND, OH 44145

IRREG TRACT L 213 SE
21-10-7

SECTION 1-3

SEQUENCE 259

LOCATION 00505 NO 66 ST
GATEWAY NORTH (LAND ONL)

1379343 SEARS ROEBUCK CO
INSPTR DEPT. 970 PROPERTY TAX
DC SEARS TOWER BSC 41-35
CHICAGO, IL 60684

IRREG TRACT
LOT 233 SE EX 3.998 AC E FT
AND EX .69 AC & EX
.62 AC IN SW PART 21-10-7

SECTION 1-3

SEQUENCE 260

LOCATION 'Q' STREET WALK

1227721 LINCOLN Q COMPANY
INSPTR ONE WARD PARKWAY SUITE 236
DC KANSAS CITY, MO 64112

IRREG TRACT LOT 233 3.998
AC E FT SE EX 0.323 AC
IN SE PT 21-10-7

SECTION 1-3

SEQUENCE 261

LOCATION 06404 0 ST

6

30

27

TAX # NAME AND ADDRESS LEGAL
0724386 SEARS ROEBUCK & CO IRREG TR LT 132 SE 21-10-7
INSPTR DEPT. 970 PROPERTY TAX
DC SEARS TOWER BSC 41-35
CHICAGO, IL 60684

SECTION 1-3

SEQUENCE 262 LOCATION 66TH SOUTH OF CHI CHIS

0724394 SEARS ROEBUCK & CO IRREG TRACT LOT 201 SE
INSPTR DEPT. 970 PROPERTY TAX 21-10-7
DC SEARS TOWER BSC 41-35
CHICAGO, IL 60684

SECTION 1-3

SEQUENCE 263 LOCATION 06540 0 ST

0724551 DIVALL ROCKY RODD ASSOCIATES IRREG TRACTS
INSPTR IV LTD PARTNERSHIP LOT 197 SE EX E104' 21-10-7
DC 100 N HAMILTON SUITE 4000
MADISON, WI 53703

SECTION 1-3

SEQUENCE 264 LOCATION 06440 0 ST
ROCKY RODD'S

1399360 PIZZA HUT OF AMERICA INC .69 AC IN SW PART OF IRREG
INSPTR % PROPERTY MGMT DEPT TRACT
DC PO BOX 428 LOT 233 SE 21-10-7
WICHITA, KS 67201 (ALSO DESCRIBED AS:
COMMENCING FROM THE S1/4
CORN OF SAID

SECTION 1-3 LOCATION 6404 'D' STREET

1245727 BANKERS LIFE NEBR CO IRREGULAR TRACT LOT 257 SW
INSPTR % JACOBS, WISCONSIN & JACOBS & LOTS 214 & 232 SE 21-10-7
DC CD25425 CTR RIDGE RD ATTN: JAMES
GUDINE CLEVELAND, OH 44145

SECTION 1-3

SEQUENCE 266 LOCATION 06100 0 ST
"IOLL" DA# 1465087 (GATEWAY)

0724301 FIRST FEDERAL SAVINGS & IRREG TRACT
INSPTR LOAN ASSN LOT 164 SW EX S125' BY 7.2'
DC 135 NO COTNER 21-10-7
LINCOLN, NE 68505

SECTION 1-3

SEQUENCE 267 LOCATION 00135 NO COTNER BLV
FIRST FEDERAL

6

31.

25

TAX #	NAME AND ADDRESS	LEGAL
0724131	WHITEHEAD GIL DC	IRREG TR L110 SW 21-10-7
INSPTR	2537 RANDOLPH ST	
DC	LINCOLN, NE 68510	

SECTION 1-3

SEQUENCE	268	LOCATION	05740	D	ST
----------	-----	----------	-------	---	----

1459030	LA SOCIETE DES 40 HOMMES ET 3	IRREGULAR TRACTS LOTS 121, 140, 162 & 180 SW & 3125'
INSPTR	CHEVAUX LEGIONNAIRE CLUB	BY 7.2' OF LOT 164 SW EX
DC	5730 D ST	W151.18' OF LOTS 140 & 162
	LINCOLN, NE 68510	SW 21-10-7

SECTION 1-3

SEQUENCE	269	LOCATION	05730	D	ST
----------	-----	----------	-------	---	----

0724289	FIRST ASSEMBLY OF GOD CHURCH	IRREG TR L145 SW 21-10-7
INSPTR	340 NO 56	
DC	LINCOLN, NE 68504	

SECTION 1-3

SEQUENCE	272	LOCATION	00340 NO 56		ST
----------	-----	----------	-------------	--	----

0724151	KHWH INC	IRREG TRACT LOT 220 SW
INSPTR	301 NO COTNER	21-10-7
DC	LINCOLN, NE 68503	

SECTION 1-3

SEQUENCE	274	LOCATION	00301 NO COTNER		BLV
			FC TWIN DRAGON RESTAURANT		

0724173	KALLGS, D.W.	IRREG TRACT LOT 221 SW
INSPTR	6211 CORNELL RD	21-10-7
DC	LINCOLN, NE 68516	

SECTION 1-3

SEQUENCE	275	LOCATION	00311 NO COTNER		BLV
			321 NO COTNER BLVD		

0724319	WEIGEL, ROBERT A.	IRREG TR L166 SW 21-10-7
INSPTR	339 NO COTNER #3	
DC	LINCOLN, NE 68505	

SECTION 1-3

SEQUENCE	276	LOCATION	00333 NO COTNER		BLV
----------	-----	----------	-----------------	--	-----

6

32

29

TAX # NAME AND ADDRESS
0724220 NELSON, NORMAN P & DONNA C
INSPTR 2646 SD 46
DC LINCOLN, NE 68505

LEGAL
IRKES TRACT LOT 193 SW 21
10 7

SECTION 1-3

SEQUENCE 277 LOCATION 00401 NO 57 ST

0637474 SCHWINDT, JOHN H & ELAINE C
INSPTR 740 NO 56
DC LINCOLN, NE 68504

GR H²
GRACE HEIGHTS W14.44' LOT 3
& ALL LOT 4
NO BLOCK

SECTION 1-3

SEQUENCE 285 LOCATION 00740 NO 56 ST
56TH AND VINE

0638532 CHRASTIL, ROBERT & ELIZABETH J
INSPTR 701 NO 57
DC LINCOLN, NE 68505

GRACE HEIGHTS NW SW LT 8
No block

SECTION 1-3

SEQUENCE 289 LOCATION 00701 NO 57 ST

0487201 BRAKER, WILLIAM L & JANICE
INSPTR 511 NORTH 57
DC LINCOLN, NE 68505

BRANDT'S REPLAT 920' LOT 4
& 950' LOT 5

SECTION 1-3

SEQUENCE 292 LOCATION 00611 NO 57 ST

0487210 MILLER, EDWARD C. & CAROL
INSPTR 501 NO. 57TH ST.
DC LINCOLN, NEBR. 68505

BRANDT'S REPLAT, SD 10'
LOT 5 AND ALL
LOT 6

SECTION 1-3

SEQUENCE 293 LOCATION 00501 NO 57 ST

0940623 ZAGER, BARRY L & JUDITH A
INSPTR 5731 VINE
DC LINCOLN, NEBR. 68505

STRE
STEWARTS REPLAT LOT 1
NO BLOCK

SECTION 1-3

SEQUENCE 296 LOCATION 05731 VINE ST

6

33

33

TAX # NAME AND ADDRESS
0971854 FAZEL, IRA A JR & DARLENE M
INSPTR 5745 VINE
DC LINCOLN, NE 68503

ATL LEGAL
VINE TERRACE BLOCK 1 LOT 1
Block 1

SECTION 1-3

SEQUENCE 297 LOCATION 05745 VINE ST

0550902 MADHANI, HELEN A.
INSPTR 4840 ALLES CIR
DC LINCOLN, NE 68510

COTNER HEIGHTS FIRST BLOCK
1 LOT 3 N 70
LOT 2 N 70 OF E 44 & 78
HNDRS

SECTION 1-3

SEQUENCE 302 LOCATION 00525 ND 58 ST

0550480 HOUSING AUTHORITY OF LINCOLN
INSPTR 5700 R ST
DC LINCOLN, NE 68505

COTNER HEIGHTS BLOCK 2 LOT 11

SECTION 1-3

SEQUENCE 304 LOCATION 05901 BILLAN RD

0550663 SCHROEDER, THOMAS A & MARY K
INSPTR 5817 BILLAN RD
DC LINCOLN, NE 68505

COTNER HEIGHTS BLOCK 2 LOT 9

SECTION 1-3

SEQUENCE 305 LOCATION 05817 BILLAN RD

0550655 POLLARD, LAWRENCE W & EVELYN M
INSPTR 5825 BILLAN
DC LINCOLN, NEBR. 68505

COTNER HEIGHTS BLOCK 2 LOT 8

SECTION 1-3

SEQUENCE 306 LOCATION 05825 BILLAN RD

0550647 BIGHAM, MARK & SUSAN K
INSPTR 5833 BILLAN RD
DC LINCOLN, NEBR. 68505

COTNER HEIGHTS BLOCK 2 LOT 7

SECTION 1-3

SEQUENCE 307 LOCATION 05833 BILLAN RD

6

34

31

COTNER

TAX # NAME AND ADDRESS
0550639 UNVERFERTH, JAMES V & SANDRA J
INSPTR 5841 GILLAN RD
DC LINCOLN, NEBR. 68505

LEGAL
COTNER HEIGHTSBLOCK 2 LOT 6 ✓

SECTION 1-3

SEQUENCE 308 LOCATION 05841 GILLAN RD

0550621 ANDERSON, FLOYD L & CAROL
INSPTR 5901 GILLAN ROAD
DC LINCOLN, NEBR. 68505

COTNER HEIGHTSBLOCK 2 LOT 5 ✓

SECTION 1-3

SEQUENCE 309 LOCATION 05901 GILLAN RD

1369405 MILNE, CHRISTOPHER ROBIN &
INSPTR PATRICIA ANN
DC 5911 GILLAN RD
LINCOLN, NE 68505

COTNER HEIGHTS ADD BLOCK 2
LOTS 3 & 4 ✓

SECTION 1-3

SEQUENCE 310 LOCATION 05911 GILLAN RD

V L. & RUTH
RD
DR. 68505

COTNER HEIGHTSBLOCK 2 LOT 2 ✓

S
S

LOCATION 05931 GILLAN RD

0550582 SCHWINDT, ROBER P & CHARLOTTE
INSPTR 5941 GILLAN RD
DC LINCOLN, NE 68505

COTNER HEIGHTSBLOCK 2 LOT 1 ✓

SECTION 1-3

SEQUENCE 312 LOCATION 05941 GILLAN RD

1510520 MARA, THOMAS C JR & JARMILLA V
INSPTR 437 NO COTNER
DC LINCOLN, NE 68505

COTNER HEIGHTS BLOCK 2 ALL
LOT 23 & LOT 24 EX SE 10' ✓

SECTION 1-3

SEQUENCE 313 LOCATION 00437 NO COTNER BLV

6

38

32

TAX # NAME AND ADDRESS
0550809 FAYNE, LEONARD R & ELLA I
INSPTR 431 N COTNER
DC LINCOLN, NEBR. 68505

COTNER LEGAL
COTNER HEIGHTS BLOCK 2 LOT
22

SECTION 1-3

SEQUENCE 314 LOCATION 00433 NO COTNER BLV

0550787 LAWSON, JOHN S & MAY B COTNER HEIGHTS BLOCK 2 LOT
INSPTR 419 N COTNER 20
DC LINCOLN, NEBR. 68505

SECTION 1-3

SEQUENCE 315 LOCATION 00419 NO COTNER BLV

0550779 LOVELACE, EDWARD N & MILDRED M COTNER HEIGHTS BLOCK 2 LOT
INSPTR 413 NO COTNER 19
DC LINCOLN, NE 68505

SECTION 1-3

SEQUENCE 316 LOCATION 00413 NO COTNER BLV

0550761 JENSEN, MAX E & JANICE I COTNER HEIGHTS BLOCK 2 LOT
INSPTR 401 NO COTNER BLVD 18
DC LINCOLN, NE 68505

SECTION 1-3

SEQUENCE 317 LOCATION 00407 NO COTNER BLV

0550744 JENSEN, MAX E & JANICE I COTNER HEIGHTS 62 EX 14 60
INSPTR 401 NO COTNER FT IN 6RLY COR L
DC LINCOLN, NEBR. 68505 17

SECTION 1-3

SEQUENCE 318 LOCATION 00401 NO COTNER BLV

0550710 ROLAND, DANIEL A & LORETTA T COTNER HEIGHTS BLOCK 2 LOT
INSPTR 5810 R ST 14 E 30 & W40
DC LINCOLN, NE 68505 LOT 15

SECTION 1-3

SEQUENCE 319 LOCATION 05810 R ST

6

36

33

TAX # NAME AND ADDRESS
0550701 ROLAND, DANIEL A & LORETTA T
INSPTR 5810 R ST
DC LINCOLN, NE 68505

COTNER LEGAL
COTNER HEIGHTS B2 W30' L14'
& ALL 13

SECTION 1-3

SEQUENCE 320 LOCATION 624 NO 58

0992011 WINDELS, PAUL B & LUCILLE K
INSPTR 5601 EARL DR
DC LINCOLN, NE 68505

VITE.
VINE TERRACE BLOCK 3 LOT 1

SECTION 1-3

SEQUENCE 328 LOCATION 05801 EARL DR

0952044 KRNAK, JOSEPH & OLGA JANE
INSPTR 6015 VINE
DC LINCOLN, NE 68504

TAHE
TAYLOR HEIGHTS BLOCK 1 W45'
LOT 2 & E45' LOT 3 &
A TRI TRACT OF LOT 7 (BEING
46.25' ON N & 11.5' ON E
& 45' ON S)
Block 1

SECTION 1-3

SEQUENCE 336 LOCATION 06015 VINE ST

0952028 EGG, PAUL F & NANCY E
INSPTR 6031 VINE ST.
DC LINCOLN, NEBR. 68505

Block 1
TAYLOR HEIGHTS BLK TR N PT
L7 ADJ 1029' ON
N37.7 ON E 100 ON S 11.6 ON
W: & E 100 L2 B1

SECTION 1-3

SEQUENCE 337 LOCATION 06031 VINE ST

0952079 BOARD OF EDUCATIONAL LANDS AND
INSPTR FUNDS OF THE STATE OF
DC NEBRASKA 555 NO COTNER BLVD
LINCOLN, NE 68505

TAYLOR HEIGHTS BLOCK 2 LOT
17 & 18

SECTION 1-3

SEQUENCE 340 LOCATION 00555 NO COTNER BLV

0550531 TAYLOR, RICHARD E & ELEANOR B
INSPTR 5420 FAIRDALE RD
DC LINCOLN, NE 68510

COTNER
COTNER HEIGHTS BLOCK 1 LOT
10
Block 1

SECTION 1-3

SEQUENCE 341 LOCATION 05800 BILLAN RD

6

37

39

TAX # NAME AND ADDRESS
0471615 THOMAS, AURELIA J
INSPTR 912 N 68
DC LINCOLN, NEBR. 68505

LEGAL
BETHANY PARK ADDBLOCK 2 LOT ✓
9

SECTION 1-3

SEQUENCE 349 LOCATION 00912 NO 68 ST

0471655 HUBBELL, ROBERT L & MARJORIE
INSPTR 6820 BETHANY PK DR
DC LINCOLN, NE 68505

BETHANY PARK ADDBLOCK 2 LOT ✓
13

SECTION 1-3

SEQUENCE 353 LOCATION 06820 BETHANY PARK DR

0471682 THAU, BENJAMIN H & SHIRLEY J
INSPTR 6846 BETHANY PARK DR
DC LINCOLN, NE 68505

BETHANY PARK ADD L 16 EX ✓
STRIP ON S16' ON
FRONT 88' ON REAR & 5 FT
16' ON REAR & 42.2
FRT L 17 BLK 2

SECTION 1-3

SEQUENCE 355 LOCATION 06846 BETHANY PARK DR

0471518 SHUBERT, C LOYD & GRACE M
INSPTR 6920 W ST
DC LINCOLN, NE 68505

BETHANY PARK ADD BLOCK 1 ✓
LOT 8

Case 1

SECTION 1-3

SEQUENCE 363 LOCATION 06920 W ST

0472506 ROELLE, WAYNE S & VERLA J
INSPTR 6831 BETHANY PARK DRIVE
DC LINCOLN, NEBR. 68505

BETHANY PARK ADDBLOCK 7 LOT ✓
7

SECTION 1-3

SEQUENCE 364 LOCATION 06831 BETHANY PARK DR

0472549 CARLSON, RALPH M & EVELYN
INSPTR 6924 LYNN
DC LINCOLN, NEBR. 68505

BETHANY PARK ADDBLOCK 7 LOT ✓
11

SECTION 1-3

SEQUENCE 367 LOCATION 06924 LYNN ST

4

38

35

TAX # NAME AND ADDRESS
0472239 ZALCIDEK, JOSEPH J & MARY ANN
INSPTR 6917 LYNN
DC LINCOLN, NE 68505

85 PA LEGAL
BETHANY PARK ADDBLOCK 6 LOT
8 ✓

SECTION 1-3

SEQUENCE 378 LOCATION 06917 LYNN ST

0472433 WIRKA, KARL D & SUZANNE
INSPTR 6954 VINE
DC LINCOLN, NEBR. 68505

BETHANY PARK ADDBLOCK 6 LOT
28 ✓

SECTION 1-3

SEQUENCE 385 LOCATION 06956 VINE ST

0472409 MINER, JOHN E & DIANA K
INSPTR 6944 VINE
DC LINCOLN, NE 68507

BETHANY PARK ADDBLOCK 6 LOT
25 ✓

SECTION 1-3

SEQUENCE 388 LOCATION 06944 VINE ST

0472387 HELLER, BARBARA DECKER
INSPTR 6930 VINE STREET
DC LINCOLN, NEBR. 68505

BETHANY PARK ADDBLOCK 6 LOT
23 ✓

SECTION 1-3

SEQUENCE 390 LOCATION 06930 VINE ST

0472379 STEPHENSON, WILLIAM D &
INSPTR PATRICIA A
DC 6920 VINE
LINCOLN, NEBR. 68505

BETHANY PARK ADDBLOCK 6 LOT
22 ✓

SECTION 1-3

SEQUENCE 391 LOCATION 06920 VINE ST

0472361 PRICE, L C & ESTHER M
INSPTR % SWOLENSKY, JOSEPH &
DC KATHLEEN (CONTRACT) 6908
VINE ST LINCOLN, NE 68505

BETHANY PARK ADD BLOCK 6
LOT 21 ✓

SECTION 1-3

SEQUENCE 392 LOCATION 06908 VINE ST

6

39

36

TAX # NAME AND ADDRESS
0472344 HINES, CHARLES E & CARLA B
INSPTR % HAUMONT, DAVID &
DC LYNNE-CONTR7501 OLD POST RD #8
LINCOLN, NE 68506

LEGAL
BETHANY PARK ADDBLOCK 6 LOT ✓
17

SECTION 1-3

SEQUENCE 393 LOCATION 06840 VINE ST

0472328 FREDERICK, MICHAEL C
INSPTR 6820 VINE ST
DC LINCOLN, NE 68505

BETHANY PARK ADD BLOCK 6 ✓
LOT 17

SECTION 1-3

SEQUENCE 395 LOCATION 06820 VINE ST

0472310 WILSON, NAOMI J
INSPTR 6810 VINE
DC LINCOLN, NEBR. 68505

BETHANY PARK ADDBLOCK 6 LOT ✓
16

SECTION 1-3

SEQUENCE 396 LOCATION 06810 VINE ST

0472301 KRÖEGER, JERRY A & SIMPSON, EJ
INSPTR 3800 SD 84 ST
DC ROUTE 9
LINCOLN, NE 68506

BETHANY PARK ADD BLOCK 6 ✓
LOT 15

SECTION 1-3

SEQUENCE 397 LOCATION 00800 NO 68 ST

0472298 HAVIG, DOUGLAS E
INSPTR 836 N 68
DC LINCOLN, NEBR. 68505

BETHANY PARK ADDBLOCK 6 LOT ✓
14

SECTION 1-3

SEQUENCE 398 LOCATION 00836 NO 68 ST

0472280 MCDOWELL, CONNIE M. & JACKIE
INSPTR 6809 BETHANY PARK DR
DC LINCOLN, NEBR. 68505

BETHANY PARK ADDBLOCK 6 LOT ✓
13

SECTION 1-3

SEQUENCE 399 LOCATION 06809 BETHANY PARK DR

6

37

40

TAX # NAME AND ADDRESS
0472271 SCHRÖEDER, WALTER
INSPTR 6815 BETHANY PK DR
DC LINCOLN, NE 68505

LEGAL
BETHANY PARK ADDBLOCK 6 LOT
12
BEPA

SECTION 1-3

SEQUENCE 400 LOCATION 06815 BETHANY PARK DR

0472026 LASSLEY, MERLE G & DELORES
INSPTR 7025 CAROL CIR
DC LINCOLN, NE 68505

BETHANY PARK ADDBLOCK 5 LOT ✓
3

SECTION 1-3

SEQUENCE 403 LOCATION 06715 BETHANY PARK DR

0472018 SCHNEIDER, JACK D & CAROL
INSPTR 6721 BETHANY PARK DR.
DC LINCOLN, NEBR. 68505

BETHANY PARK ADDBLOCK 5 LOT ✓
2

SECTION 1-3

SEQUENCE 404 LOCATION 06721 BETHANY PARK DR

0472000 KARDELL, PAUL D & MADONNA G
INSPTR 1330 TWIN RIDGE RD
DC LINCOLN, NE 68510

BETHANY PARK ADDBLOCK 5 LOT ✓
1

SECTION 1-3

SEQUENCE 405 LOCATION 00845 NO 68 ST

0472077 CAREY, A LESLIE & HILDA
INSPTR 830 NO 66TH ST
DC LINCOLN, NEBR. 68505

BETHANY PARK ADDBLOCK 5 LOT ✓
8

SECTION 1-3

SEQUENCE 410 LOCATION 00830 NO 66 ST

0472069 LANDER, TERRENCE N & PAMELA J
INSPTR 6615 BETHANY PARK DR
DC LINCOLN, NE 68505

BETHANY PARK ADDBLOCK 5 LOT ✓
7

SECTION 1-3

SEQUENCE 411 LOCATION 06615 BETHANY PARK DR

7

41

35

TAX # NAME AND ADDRESS
0471925 STEELE, JANE D
INSPTR 900 ND 66
DC LINCOLN, NEBR. 68505

BEPA
LEGAL

BETHANY PARK ADD EX N10 LOT
10 BLK 4

SECTION 1-3

SEQUENCE 413 LOCATION 00900 ND 66 ST

0471917 WILLHITE, SAMUEL D & BONNIE L
INSPTR 910 N 66
DC LINCOLN, NE 68505

BETHANY PARK ADD BLK 4 N
10' LOT 10 &
11 ALL LOT 9 & EX E 28.7' N
10' LOT 11

SECTION 1-3

SEQUENCE 414 LOCATION 00910 ND 66 ST

0471909 KRAMER, ROY H & NELLIE V
INSPTR 922 N 66
DC LINCOLN, NE 68505

BETHANY PARK ADDBLOCK 4 LOT
7 S HALF LOT 8

SECTION 1-3

SEQUENCE 415 LOCATION 00922 ND 66 ST

0471941 BENEJAM, GARY A & JEAN
INSPTR 901 N 67TH
DC LINCOLN, NEBR. 68505

BETHANY PARK BLOCK 4 LOT 12
EX W2FT

SECTION 1-3

SEQUENCE 420 LOCATION 00901 ND 67 ST

0471704 KRATOCHVIL, BERNADETTE &
INSPTR WITZEL, JOSEPHINE
DC BOX 147
DWIGHT, NE 68635

BETHANY PARK ADDBLOCK 3 LOT
2

SECTION 1-3

SEQUENCE 422 LOCATION 06721 X ST

0471259 WALLEN, WALTER R & IMOGENE
INSPTR 6927 Y
DC LINCOLN, NE 68505

BETHANY HEIGHTSBLOCK 99 LOT
4 BETHANY

SECTION 1-3

SEQUENCE 427 LOCATION 06927 Y ST

6

42

29

TAX # NAME AND ADDRESS
0471232 TODD, WM H & ROSEMARY R
INSPTR RT. 1 BOX 79
DC UNION, NE 68455

LEGAL
BETHANY HEIGHTS BLOCK 99 LOT 1 ✓
2 BETHANY

SECTION 1-3

SEQUENCE 428 LOCATION 06945 Y ST

0471224 NEARY, MICHAELA A
INSPTR 6955 Y
DC LINCOLN, NE 68505

BETHANY HEIGHTS BLOCK 99 LOT 1 ✓

SECTION 1-3

SEQUENCE 429 LOCATION 06955 Y ST

0548804 SCHROEDER, HARVEY W & ELEANOR
INSPTR 1001 NO 70
DC LINCOLN, NE 68505

COTNER ADD BLOCK 1 LOT 1 LT ✓
2 E 15
COTNER
Block 1

SECTION 1-3

SEQUENCE 430 LOCATION 01001 NO 70 ST

0548812 TERKILDSSEN, ARTHUR C & HELEN L
INSPTR 6936 X
DC LINCOLN, NE 68505

COTNER ADD BLOCK 1 LOT 2 W ✓
30 LT 3 E 30
Block 1

SECTION 1-3

SEQUENCE 431 LOCATION 06936 X ST

0548821 BROWN, CLAUD H & MAXINE I
INSPTR 6926 X
DC LINCOLN, NE 68505

COTNER ADD BLOCK 1 LOT 3 W ✓
15 LOT 4
Block 1

SECTION 1-3

SEQUENCE 432 LOCATION 06926 X ST

0548839 ANTHES, EUGENE L & MARY F
INSPTR 6922 X ST
DC LINCOLN, NEBR. 68505

COTNER ADD BLOCK 1 LOT 5 ✓
Block 1

SECTION 1-3

SEQUENCE 433 LOCATION 06922 X ST

6

43

41

TAX # NAME AND ADDRESS
0548863 GRAY, ELIZADETH A
INSPTR 1000 ND 69
DC LINCOLN, NE 68505

LEGAL
COTNER ADDBLOCK 01 LOT 8
COTNER
Block 1

SECTION 1-3

SEQUENCE 434 LOCATION 01000 ND 69 ST

0548871 CLINEFELTER, KEVIN H & NELLA B
INSPTR 1001 ND 69
DC LINCOLN, NE 68505

COTNER ADD BLOCK 2 LOT 1
LOT 2 E 25'

SECTION 1-3

SEQUENCE 435 LOCATION 06842 X ST

0549029 KAUL, DEWEY J & LUCILLE M
INSPTR 1000 N 66
DC LINCOLN, NEBR. 68505

COTNER ADDBLOCK 04 LOT 5 & 6
6 5 HALF

SECTION 1-3

SEQUENCE 446 LOCATION 01000 ND 66 ST

0470643 JOHNSON, RICHARD L JR & SHERRI
INSPTR 6708 Y ST
DC LINCOLN, NE 68505

BETHANY HEIGHTS BLOCK 86
LOT 4 & W1/2 LOT 5
BETHANY

SECTION 1-3

SEQUENCE 449 LOCATION 06708 Y ST

0470651 OTTO, LUCILE J.
INSPTR 6728 Y
DC LINCOLN, NEBR. 68505

BETHANY HEIGHTS BLOCK 86 LOT
5 E HALF LOT 6

SECTION 1-3

SEQUENCE 450 LOCATION 06728 Y ST

0645991 HENNINGS, LARRY D & JEAN C
INSPTR KARAVAS, ADAM B & ALEXANDRA
DC 7300 SOUTH WEDGEWOOD DR.
LINCOLN, NEBR. 68510

HANSON PLAZA BLOCK 1 LOT 9
HAPL
Block 1

SECTION 1-3

SEQUENCE 451 LOCATION 01320 ND 54 ST

6

44

41

TAX # NAME AND ADDRESS
0645940 BALDWIN, RANDY B & JOANNE
INSPTR 1430 ND 54
DC LINCOLN, NE 68504

LEGAL
HANSON PLAZA BLOCK 1 LOT 4 ✓
HAPL
Block 1

SECTION 1-3

SEQUENCE 453 LOCATION 01430 ND 54 ST

0645915 WITTMANN, HERBERT J &
INSPTR THERESA F
DC 3501 VAN DORN
LINCOLN, NE 68506

HANSON PLAZA BLOCK 1 LOT 1 ✓
Block 1

SECTION 1-3

SEQUENCE 455 LOCATION 05431 HOLDREGE ST

0646385 SMOLIK, MARTIN J & LYDIA
INSPTR 1231 ND 54TH
DC LINCOLN, NEBR. 68504

HANSON PLAZA BLOCK 2 LOT 20 ✓

SECTION 1-3

SEQUENCE 459 LOCATION 01231 ND 54 ST

0646359 WITTMANN BROS LTD
INSPTR % TRUST DEPT UNION BANK
DC PO BOX 6255
LINCOLN, NE 68506

HANSON PLAZA BLOCK 2 LOT 18 ✓

SECTION 1-3

SEQUENCE 460 LOCATION 01211 ND 54 ST

0646351 CROWDER, KENNETH D &
INSPTR JACQUELINE R
DC 5330 ORCHARD
LINCOLN, NE 68504

HANSON PLAZA BLOCK 2 LOT 17 ✓

SECTION 1-3

SEQUENCE 461 LOCATION 05330 ORCHARD ST

0646334 KILLHAM, RHONDA K.
INSPTR 1210 ND 53 ST
DC LINCOLN, NEBR. 68506

HANSON PLAZA BLOCK 2 LOT 15 ✓

SECTION 1-3

SEQUENCE 462 LOCATION 01210 ND 53 ST

6

45

42

TAX # NAME AND ADDRESS
0646300 FIELDS, JODIE L, JACKIE L &
INSPTR NANCY L
DC 1240 NO 53
LINCOLN, NE 68504

LEGAL
HANSON PLAZA BLOCK 2 LOT 12
HAPL

SECTION 1-3

SEQUENCE 465 LOCATION 01240 NO 53 ST

0646253 HENNINGS, LARRY D & JEAN &
INSPTR KARAVAS, ADAM S & ALEXANDRA
DC 7300 SO WEDGEWOOD DR
LINCOLN, NE 68510

HANSON PLAZA BLOCK 2 LOT 7

SECTION 1-3

SEQUENCE 467 LOCATION 01400 NO 53 ST

0646312 LIND, ROBERT W
INSPTR 1027 S 37TH
DC LINCOLN, NEBR. 68510

HANSON PLAZA FIRST ADD LOT

5

HAPL1

NEBRASKA

SECTION 1-3

SEQUENCE 469 LOCATION 01241 NO 56 ST

0646491 MCLAUGHLIN, SHEILA M
INSPTR 1301 NO 56
DC LINCOLN, NE 68505

HANSON PLAZA FIRST ADD LOT
3

No Brak

SECTION 1-3

SEQUENCE 470 LOCATION 01301 NO 56 ST

0646482 TREFFER, RANDALL R & ANN M
INSPTR 1311 NO 56
DC LINCOLN, NE 68504

HANSON PLAZA FIRST ADD LOT
2

No

SECTION 1-3

SEQUENCE 471 LOCATION 01311 NO 56 ST

0646474 DETWEILER, RONALD E & JOYCE E
INSPTR 1211 MEADOW DALE DR
DC LINCOLN, NE 68505

HANSON PLAZA FIRST ADD LOT
1 & W30' VAC 56TH ST ADJ

No

SECTION 1-3

SEQUENCE 472 LOCATION 01321 NO 56 ST

6

46

83

TAX # NAME AND ADDRESS
0646164 PETERSON, ALLAN C & JUSTINE
INSPTR 1401 NO 55
DC LINCOLN, NEBR. 68504

LEGAL
HANSON PLAZA BLOCK 1 LOT 26 ✓
HAPL
Block 1

SECTION 1-3

SEQUENCE 474 LOCATION 01401 NO 55 ST

0646105 OMOLIK, MARTIN J & LYDIA
INSPTR 1231 NORTH 55
DC LINCOLN, NEBR. 68504

HANSON PLAZA BLOCK 1 LOT 20 ✓
Block 1

SECTION 1-3

SEQUENCE 479 LOCATION 01231 NO 55 ST

0646083 MEYER, ROLAND L (1/2 INT) &
INSPTR OLSON, THOMAS O & SYLVIA
DC (1/2) PO BOX 30538
LINCOLN, NE 68503

HANSON PLAZA BLOCK 1 LOT 18 ✓
Block 1

SECTION 1-3

SEQUENCE 480 LOCATION 01211 NO 55 ST

0646008 WITTMANN BROS LTD
INSPTR % UNION BANK TRUST DEPT
DC PO BOX 6155
LINCOLN, NE 68506

HANSON PLAZA BLOCK 1 LOT 10 ✓
Block 1

SECTION 1-3

SEQUENCE 484 LOCATION 01310 NO 54 ST

0680761 BALDWIN, RANDY B & JOANNE
INSPTR 1133 NORTH 55 ST
DC LINCOLN NEBR 68504

HILLS ADD BLOCK 1 LOT 2 ✓
HIAD
Block 1

SECTION 1-3

SEQUENCE 486 LOCATION 01133 NO 55 ST

0680796 DOUGHERTY, DONALD & CLAUDIA
INSPTR 1109 NO 55 ST
DC LINCOLN, NEBR 68504

HILLS ADD BLOCK 1 LOT 5 ✓
Block 1

SECTION 1-3

SEQUENCE 487 LOCATION 01109 NO 55 ST

6

47

44

TAX # NAME AND ADDRESS
0680826 WATHEN, EDWARD H & PAULETTE J
INSPTR 1108 NO 55
DC LINCOLN, NE 68504

LEGAL
HILLS ADD BLOCK 1 LOT 8
HIAD
Block 1

SECTION 1-3

SEQUENCE 488 LOCATION 01108 NO 55 ST

0680849 GARTZKE, RAINER L & BARBARA A
INSPTR 1140 NO 55 ST
DC LINCOLN, NEBR 68504

HILLS ADD BLOCK 1 LOT 12
Block 1

SECTION 1-3

SEQUENCE 489 LOCATION 01140 NO 55 ST

0680893 WATSON, CLASSTOL E & ANN E
INSPTR 5511 ORCHARD
DC LINCOLN, NE 68504

HILLS ADD BLOCK 1 LOT 15
Block 1

SECTION 1-3

SEQUENCE 491 LOCATION 05511 ORCHARD ST

0681181 SHEPARD, RAYMOND W & ERMA A
INSPTR 1031 NO 56
DC LINCOLN, NE 68504

HILLS ADD BLOCK 2 LOT 14

SECTION 1-3

SEQUENCE 473 LOCATION 01031 NO 56 ST

0681172 MACDOWELL, LLOYD J & ELEANOR K
INSPTR 1021 NO 56
DC LINCOLN, NE 68504

HILLS ADD BLOCK 2 LOT 13

SECTION 1-3

SEQUENCE 494 LOCATION 01021 NO 56 ST

0681164 WELCH, PATRICIA J
INSPTR 1011 NO 56
DC LINCOLN, NE 68504

HILLS ADD BLOCK 2 LOT 12

SECTION 1-3

SEQUENCE 495 LOCATION 01011 NO 56 ST

6

#9

76

TAX # NAME AND ADDRESS LEGAL
0691041 OSTEN, LELAND H. & ELVA HILLS ADD BLOCK 1 LOT 32 ✓
INSPTR 3930 LASALLE
DC LINCOLN, NEBR. 68516
HIAD
Block 1

SECTION 1-3

SEQUENCE 510 LOCATION 05340 X ST

0800686 TATE-LEE, EDWARD & BETTY NARRS SUB LOT 15 ✓
INSPTR 1000 N 53
DC LINCOLN, NE 68504 No Block

SECTION 1-3

SEQUENCE 511 LOCATION 01000 ND 53 ST

0800741 DUNN, FAY J & CHARLOTTE M NARRS SUB LOT 22 ✓
INSPTR 1101 ND 53
DC LINCOLN, NEBR. 68504 NARRS

SECTION 1-3

SEQUENCE 512 LOCATION 01101 ND 53 ST

0800759 KEHN, HOWARD E & MARJORIE NARRS SUB LOT 23 ✓
INSPTR SIMONSON, LARRY &
DC MARLENE-CONT 1111 ND 53
LINCOLN, NE 68504 NO

SECTION 1-3

SEQUENCE 513 LOCATION 01111 ND 53 ST

0802174 TATE, MARILYN & JAMES NEWMANS SUB BLK 5 LT 10 ✓
INSPTR 5411 ORCHARD
DC LINCOLN, NEBR. 68504 E 60' OF
W 95' OF N 120'
NEWMAN.

SECTION 1-3

SEQUENCE 519 LOCATION 05411 ORCHARD ST

0846031 CIEMINSKI, CLIFFORD J & SANDRA PATRICIAN HEIGHTS BLOCK 3 ✓
INSPTR 5400 VINE
DC LINCOLN, NE 68504 LOT 20 EX W5
PAHE

SECTION 1-3

SEQUENCE 521 LOCATION 05400 VINE ST

6

50

47

TAX #	NAME AND ADDRESS	LEGAL
0846023	ASHLEY, JAMES E & LESLIE J	PATRICIAN HEIGHTS BLK3 ALL ✓
INSPTR	5330 VINE	LT19 & LT20 W5
DC	LINCOLN, NEBR. 68504	PAHE

SECTION 1-3

SEQUENCE	522	LOCATION	05330	VINE	ST
----------	-----	----------	-------	------	----

0846015	BENDER, TERRENCE & KATHLEEN	PATRICIAN HEIGHTS BLOCK 3 ✓
INSPTR	5320 VINE	LOT 18
DC	LINCOLN, NEBR. 68504	

SECTION 1-3

SEQUENCE	523	LOCATION	05320	VINE	ST
----------	-----	----------	-------	------	----

0846007	TIETJEN, REINHARD F	PATRICIAN HEIGHTS BLOCK 3 ✓
INSPTR	% DONALD TIETJEN	LOT 17
DC	D BOX 484	
	LOUISVILLE, NE 68037	

SECTION 1-3

SEQUENCE	524	LOCATION	05310	VINE	ST
----------	-----	----------	-------	------	----

0845981	FRUSIA, ELMER L & FLORENCE M	PATRICIAN HEIGHTS BLOCK 3 ✓
INSPTR	5240 VINE	LOT 15
DC	LINCOLN, NE 68504	

SECTION 1-3

SEQUENCE	525	LOCATION	05240	VINE	ST
----------	-----	----------	-------	------	----

0845965	AYERS, JOHN H & JEANNE	PATRICIAN HEIGHTS BLOCK 3 ✓
INSPTR	810 MAHONEY DR	LOT 13
DC	LINCOLN, NE 68504	

SECTION 1-3

SEQUENCE	526	LOCATION	00810	MAHONEY	DR
----------	-----	----------	-------	---------	----

0845957	BREHM, SHARON R	PATRICIAN HEIGHTS BLOCK 3 ✓
INSPTR	PO BOX 31717	LOT 12
DC	AURORA, CO 80041	

SECTION 1-3

SEQUENCE	527	LOCATION	00824	MAHONEY	DR
----------	-----	----------	-------	---------	----

6

SK

48

TAX # NAME AND ADDRESS
0681156 KUHNIS, WALDEAN W & DOROTHY L
INSPTR 5540 X
DC LINCOLN, NE 68504

LEGAL
HILLS ADD BLOCK 2 LOT 11 ✓
HIAD

SECTION 1-3

SEQUENCE 529 LOCATION 05540 X ST

0681067 WOOD, BILL A & DORIS E
INSPTR 5511 HILLSDALE DR.
DC LINCOLN, NEBR 68504

HILLS ADD BLOCK 2 LOT 2 ✓

SECTION 1-3

SEQUENCE 533 LOCATION 05511 HILLS DALE DR

0516287 ARNOLD, SHERYL A
INSPTR C/O AL MOORE & E. ASPGREEN
DC 5211 ORCHARD STREET
LINCOLN, NE 68504

CAPITOL HEIGHTS SUB 15 16 & ✓
17 T F BARNES
SUB LOT 11

CAHE
NO Block

SECTION 1-3

SEQUENCE 539 LOCATION 05211 ORCHARD ST

0800791 STORKAN, EDWARD R & GLADY'S D
INSPTR 5241 ORCHARD
DC LINCOLN, NEBR. 68504

NARRS SUB LOT 28 & 29 ✓

NARRS

NO Block

SECTION 1-3

SEQUENCE 541 LOCATION 05241 ORCHARD ST

0516546 HENDRIX, JACK LEE & EMMA LOU
INSPTR 1045 NO 51
DC LINCOLN, NE 68504

CAPITOL HEIGHTS SUB 15 16 & ✓
17 T F BARNES SUB:
LOT 40 & S1/2 VAC Y ST ADJ
TO THE W145' OF LT 40

CAHE
NO Block

SECTION 1-3

SEQUENCE 542 LOCATION 01045 NO 51 ST

0516503 MAKOVICKA, FLORIAN & PATRICIA
INSPTR 1114 NO 52 STREET
DC LINCOLN, NE. 68504

CAPITOL HEIGHTS SUB 15 16 & ✓
17 T F BARNES
SUB LOT 36

NO Block

SECTION 1-3

SEQUENCE 545 LOCATION 01104 NO 52 ST

6

52

49

TAX #	NAME AND ADDRESS	LEGAL
0516449 INSPTR DC	MARKVIKA, FLORIAN & PATRICIA 1114 NO 52 STREET LINCOLN, NE. 68504	CAPITOL HEIGHTS SUB 15 16 & 17 T F BARNES SUB LOT 29 CAHE No Block
SECTION 1-3		
SEQUENCE 546	LOCATION 01114 NO 52	ST
0516686 INSPTR DC	DIPALD, ROBERT M & DONNA M 1015 NO 52 LINCOLN, NE 68504	CAPITOL HEIGHTS ADD TO UNIVERSITY PLACE LOT 54 No
SECTION 1-3		
SEQUENCE 549	LOCATION 01015 NO 52	ST
0516732 INSPTR DC	SPENCER, LEONA F 1009 NO 52ND ST LINCOLN, NEBR. 68504	CAPITOL HEIGHTS SUB 15 16 & 17 T F BARNES SUB LOT 59 EX 84.65' No
SECTION 1-3		
SEQUENCE 550	LOCATION 01009 NO 52	ST
0516767 INSPTR DC	WOODSHANK, ERWIN J JR & SONJA 1003 NO 52ND LINCOLN, NE 68504	CAPITOL HEIGHTS SUB 15 16 & 17 T F BARNES SUB: 84.65' L 59 & ALL LOT 62 No
SECTION 1-3		
SEQUENCE 551	LOCATION 01003 NO 52	ST
0846244 INSPTR DC	AMEN, JERRY E & BONNIE R 5435 WILSHIRE BLVD LINCOLN, NEBR. 68504	PATRICIAN HEIGHTS FIRST ADD BLOCK 2 N84' PAGE 1
SECTION 1-3		
SEQUENCE 552	LOCATION 05435 WILSHIRE	BLV
0845621 INSPTR DC	HASSENPLUG, WALTER E & MARLENE 5409 WILSHIRE BLVD LINCOLN, NE 68504	PATRICIAN HEIGHTS BLOCK 2 LOT 1
SECTION 1-3		
SEQUENCE 553	LOCATION 05409 WILSHIRE	BLV

6

53

50

TAX # NAME AND ADDRESS
0845637 FRIEDS, ALBERT B & KATHERINE
INSPTR 5401 WILSHIRE
DC LINCOLN, NE 68504

LEGAL
PATRICIAN HEIGHTS BLOCK 2
LOT 2 E 55
PAHE

SECTION 1-3

SEQUENCE 554 LOCATION 05401 WILSHIRE BLV

0845647 HOLLE, HERBERT G & DOROTHY A
INSPTR 5331 WILSHIRE BLVD
DC LINCOLN, NE 68504

PATRICIAN HEIGHTS BLK 2 LTS
3 E51' & W1' LT
2

SECTION 1-3

SEQUENCE 555 LOCATION 05331 WILSHIRE BLV

0845655 BENSON, HUBERT V & THELMA E
INSPTR 5321 WILSHIRE BLVD
DC LINCOLN, NE 68504

PATRICIAN HEIGHTS BLK 2 LT
4 E45' LT 3 W5'

SECTION 1-3

SEQUENCE 556 LOCATION 05321 WILSHIRE BLV

0845663 NOSKY, GREGORY A & CHERYL E
INSPTR 5311 WILSHIRE BLVD
DC LINCOLN, NE 68504

PATRICIAN HEIGHTS BLK 2 LT
5 E39' LT 4 W11'

SECTION 1-3

SEQUENCE 557 LOCATION 05311 WILSHIRE BLV

0845671 ROLLF, JACK E & BETTY I
INSPTR 5301 WILSHIRE BLVD
DC LINCOLN, NEBR. 68504

PATRICIAN HEIGHTS BLK 2 LT
6 E46' LT 5 W17'

SECTION 1-3

SEQUENCE 558 LOCATION 05301 WILSHIRE BLV

0845680 SCHELLPEPER, WM L & BETTY L
INSPTR 5239 WILSHIRE BLVD
DC LINCOLN, NE 68504

PATRICIAN HEIGHTS BLK 2 LT
7 EX W3' & LT 6
W 10'

SECTION 1-3

SEQUENCE 559 LOCATION 05239 WILSHIRE BLV

6

54

51

TAX #	NAME AND ADDRESS	LEGAL
0845698 INSPTR DC	BECHTOLT, WILBUR M & SCHMIDT, DELORES A 5229 WILSHIRE BLVD LINCOLN, NE 68504	PATRICIAN HEIGHTS BLOCK 2 ✓ LOT 8 & W3' LOT 7
SECTION 1-3		
SEQUENCE 560	LOCATION 05229 WILSHIRE	BLV
0845701 INSPTR DC	CRAIG, RAYMOND M & THELMA M 5215 WILSHIRE BLVD LINCOLN, NE 68504	PATRICIAN HEIGHTS BLOCK 2 ✓ LOT 9
SECTION 1-3		
SEQUENCE 561	LOCATION 05215 WILSHIRE	BLV
0845949 INSPTR DC	MICHAUD, PAUL M & MYRA J 3201 HEUMANN DR LINCOLN, NE 68504	PATRICIAN HEIGHTS BLOCK 3 ✓ LOT 11
SECTION 1-3		
SEQUENCE 562	LOCATION 05201 HEUMANN	DR
0845922 INSPTR DC	AKINS, JAMES D 5239 HEUMANN DR LINCOLN, NEBR. 68504	PATRICIAN HEIGHTS BLOCK 3 ✓ LOT 9
SECTION 1-3		
SEQUENCE 564	LOCATION 05239 HEUMANN	DR
0845914 INSPTR DC	SCHREURS, HARLAN E & MARY A 5301 HEUMANN DR LINCOLN, NEBR. 68504	PATRICIAN HEIGHTS BLOCK 3 ✓ LOT 8
SECTION 1-3		
SEQUENCE 565	LOCATION 05301 HEUMANN	DR
0845906 INSPTR DC	HENDRICKSON, HENRY G & JOSEPHINE K 5311 HEUMANN DR LINCOLN, NE 68504	PATRICIAN HEIGHTS BLOCK 3 ✓ LOT 7 W 52
SECTION 1-3		
SEQUENCE 566	LOCATION 05311 HEUMANN	DR

6

55

52

TAX #	NAME AND ADDRESS	LEGAL
0845892	COPAS, ORVAL, VERA, & KATHLEEN	PATRICIAN HEIGHTS BLK 3 LT 4
INSPTR	5321 HEUMANN DR	5 W3' ALL LT 6 &
DC	LINCOLN, NE 68504	E4' LT 7

SECTION 1-3

PAHE

SEQUENCE	567	LOCATION	05321	HEUMANN	DR
----------	-----	----------	-------	---------	----

0845884	CURTIN, FRANCIS P & JOYCE D	PATRICIAN HEIGHTS BLOCK 3
INSPTR	5331 HEUMANN DRIVE	LOT 5 E 53
DC	LINCOLN, NEBR. 68504	

SECTION 1-3

SEQUENCE	568	LOCATION	05331	HEUMANN	DR
----------	-----	----------	-------	---------	----

0845876	LESSOR, MARK A & SUE L	PATRICIAN HEIGHTS BLOCK 3
INSPTR	5411 HEUMANN DR	LOT 4
DC	LINCOLN, NE 68504	

SECTION 1-3

SEQUENCE	569	LOCATION	05411	HEUMANN	DR
----------	-----	----------	-------	---------	----

0845868	SCHL, DAVID S & JOYCE M	PATRICIAN HEIGHTS BLOCK 3
INSPTR	5421 HEUMANN DR	LOT 3
DC	LINCOLN, NE 68504	

SECTION 1-3

SEQUENCE	570	LOCATION	05421	HEUMANN	DR
----------	-----	----------	-------	---------	----

0845850	CLARK, OTIS L & HEDWIG	PATRICIAN HEIGHTS BLOCK 3
INSPTR	825 NO 55	LOT 2
DC	LINCOLN, NEBR. 68504	

SECTION 1-3

SEQUENCE	571	LOCATION	00825 NO 55		ST
----------	-----	----------	-------------	--	----

0862061	BRADLEY, DALE D & SUSAN R	PALMER & BROOKS PLEASANT
INSPTR	6121 NW 8	VIEW ADD TO UNIVERSITY
DC	LINCOLN, NE 68521	PLACE BLOCK 1 LOT 18

SECTION 1-3

SEQUENCE	573	LOCATION	05066	STARR	ST
----------	-----	----------	-------	-------	----

PABR PLVI
Block 1

6

56

53

TAX #	NAME AND ADDRESS	LEGAL
0861952 INSPTR DC	SAVARS, PAUL K. 5017 HOLDREGE LINCOLN, NE 68507	PALMER & BROOKS PLEASANT ✓ VIEW ADD TO UNIVERSITY PLACE BLOCK 1 LOT 7 EX ST PA BR PLVI Block 1
SECTION 1-3		
SEQUENCE 574	LOCATION 05017 HOLDREGE	ST
0861979 INSPTR DC	DICKINSON, JACK L & VIRGINIA R % KELLEY, DONALD W & BESS-CONT 1601 SKYLINE DR LINCOLN, NE 68506	PALMER & BROOKS PLEASANT ✓ VIEW ADD TO UNIVERSITY PLACE BLOCK 1 LOT 9 EX 370.1 SQ FT IN N & W FOR ST Block 1
SECTION 1-3		
SEQUENCE 575	LOCATION 05001 HOLDREGE	ST
1245648 INSPTR DC	L S H III 4230 SO 33 SUITE 204 LINCOLN, NE 68506	EAST CAMPUS SQUARE--AMENDED ✓ FINAL PLAT BLOCK 2 LOT 1 N150' EACASQAMPL
SECTION 1-3		
SEQUENCE 577	LOCATION 01448 NO 48	ST
1245664 INSPTR DC	1400 NORTH 49TH STREET PARTNERSHIP MCGILL, STEVEN SO 96 OMAHA, NE 68114	EAST CAMPUS SQUARE--AMENDED ✓ FINAL PLAT BLOCK 2 LOT 1 EX N150'
SECTION 1-3		
SEQUENCE 578	LOCATION 01400 NO 48 FC	ST
1227461 INSPTR DC	KEN'S LIQUOR, INC 1350 NO 48 LINCOLN, NE 68504	EAST CAMPUS SQUARE--AMENDED ✓ FINAL PLAT BLOCK 3 LOT 1 EX S140'
SECTION 1-3		
SEQUENCE 579	LOCATION 01350 NO 48 FC	ST
0574937 INSPTR DC	GUTSCHENRIETTER, MICHAEL & SANDRA 6500 MONTICELLO LINCOLN, NE 68510	EAST LAWN ADD TO UNIVERSITY ✓ PLACE LOTS 17 & 18 EALARDUNPL NO BDC
SECTION 1-3		
SEQUENCE 580	LOCATION 08105 HOLDREGE	ST

6

57

57

TAX # NAME AND ADDRESS
0574945 SHANE, DANIEL L
INSPTR 5102 STARR ST
DC LINCOLN, NE 68505

LEGAL
EAST LAWN ADD TO UNIVERSITY
PLACE LOTS 19 & 20
EALWADUNPL

SECTION 1-3

NO STARR

SEQUENCE 581

LOCATION 05102 STARR ST

0574988 HOBSTETLER, KARL D &
INSPTR SAWICKI, MARY A
DC 5134 STARR ST
LINCOLN, NE 68504

EAST LAWN ADD TO UNIVERSITY
PLACE LOTS 27 & 28

SECTION 1-3

SEQUENCE 582

LOCATION 05134 STARR ST

0685053 KIENE, MAXINE M & MERVIN
INSPTR 803 EL AVADO
DC LINCOLN, NEBR. 68504

HOLHE

HOLLYWOOD HEIGHTS BLOCK 2
854' & TRI ADD ON
N BEING 2.5' ON W & 49' ON
S LOT 7

SECTION 1-3

SEQUENCE 584

LOCATION 00803 EL AVADO AVE

0687961 HOLM, MAXINE
INSPTR 816 EL AVADO
DC LINCOLN, NEBR. 68504

HOLLYWOOD HEIGHTS BLOCK 1
LOT 7
Block 1

SECTION 1-3

SEQUENCE 585

LOCATION 00816 EL AVADO AVE

0687977 VANACKEREN, DALE J
INSPTR 800 EL AVADO
DC LINCOLN, NE 68504

HOLLYWOOD HEIGHTS BLOCK 1
LOT 8
Block 1

SECTION 1-3

SEQUENCE 586

LOCATION 00800 EL AVADO AVE

0846163 PETRI, ROLAND T & VERNETTA E
INSPTR 811 MAHONEY DR
DC LINCOLN, NE 68504

PAHE

PATRICIAN HEIGHTS BLK 4 LT
9 N64&1TNTH FT
OF E 32&3 TNTH FT & LT 10 N
64&1 TNTH FT

SECTION 1-3

SEQUENCE 587

LOCATION 00811 MAHONEY DR

58

55

TAX # NAME AND ADDRESS
0846147 NAVLICEK, GORDON L
INSPTR 1301 SW 8
DC LINCOLN, NE 68522

LEGAL
PATRICIAN HEIGHTS BLOCK 4 ✓
LOT 8
PAHE

SECTION 1-3

SEQUENCE 588 LOCATION 00819 MAHONEY DR

0846139 PARKER, WM JR & JAYLA M
INSPTR 825 MAHONY
DC LINCOLN, NE 68504

PATRICIAN HEIGHTS BLOCK 4 ✓
LOT 7

SECTION 1-3

SEQUENCE 589 LOCATION 00825 MAHONEY DR

0846121 ZIER, WILLIAM J & VALLENJOY
INSPTR 635 MAHONEY DR
DC LINCOLN, NEBR. 68504

PATRICIAN HEIGHTS BLOCK 4 ✓
LOT 6

SECTION 1-3

SEQUENCE 590 LOCATION 00835 MAHONEY DR

0846091 MILLER, RUSTY A & CONNIE K
INSPTR 721 MAHONEY DR
DC LINCOLN, NE 68504

PATRICIAN HEIGHTS BLOCK 4 ✓
LOT 3

SECTION 1-3

SEQUENCE 591 LOCATION 00921 MAHONEY DR

0846082 WELLS, STEVEN L & SANDRA S
INSPTR 731 MAHONEY DR.
DC LINCOLN, NEBR 68504

PATRICIAN HEIGHTS BLOCK 4 ✓
LOT 2

SECTION 1-3

SEQUENCE 592 LOCATION 00931 MAHONEY DR

0845752 DESCH, DONALD RAY & MILDRED J
INSPTR 5240 HEUMANN
DC LINCOLN, NEBR. 68504

PATRICIAN HEIGHTS BLK 2 ALL ✓
LT 14 & LT 15
W7'

SECTION 1-3

SEQUENCE 593 LOCATION 05240 HEUMANN DR

6

59

56

TAX # 0845779
NAME AND ADDRESS KUSHULINSKI, TOM & KATERINA
INSPTR 5310 HEUMANN DR
DC LINCOLN, NEBR. 68504

LEGAL
PATRICIAN HEIGHTS BLK 2 LT ✓
16 E42' & LT 17
W 10 1/2 FT

SECTION 1-3

PAHE

SEQUENCE 595

LOCATION 05310 HEUMANN DR

0845795 CRAREN, EDWARD J & SHIRLEY A
INSPTR 5330 HEUMANN DR.
DC LINCOLN, NEBR 68504

PATRICIAN HEIGHTS BLK 2 LT ✓
16 E42' LT 19
W 14'

SECTION 1-3

SEQUENCE 596

LOCATION 05330 HEUMANN DR

0845817 GAYS, WM C & CYNTHIA L
INSPTR 5420 HEUMANN DR
DC LINCOLN, NEBR. 68504

PATRICIAN HEIGHTS BLK 2 LT ✓
20 E48' & LT 21
W2' EX 19 & W.2 LT 22

SECTION 1-3

SEQUENCE 597

LOCATION 05420 HEUMANN DR

0845837 DUNNAY, DANNY D & MARGARET A
INSPTR 5440 HEUMANN DR
DC LINCOLN, NE 68504

PATRICIAN HEIGHTS BLK 2 EX ✓
W2' & EX N 2'
LT 22

SECTION 1-3

SEQUENCE 598

LOCATION 05430 HEUMANN DR

0845825 CRANDALL, JOHN H & DONNA L
INSPTR 911 N 13
DC LINCOLN, NEBR. 68504

PATRICIAN HEIGHTS BLK 2 EX ✓
N4' & S61 EX
W2' L21 & N2 EX W2 LT 22

SECTION 1-3

SEQUENCE 599

LOCATION 00911 ND 55 ST

0862231 BRINKMAN, LEO
INSPTR 1320 ND 51 ST
DC LINCOLN, NE 68504

PABRPLVI

FALMER & BROOKS PLEASANT
VIEW ADD TO UNIVERSITY
PLACE BLOCK 3 LOTS 1
THRU 5

SECTION 1-3

SEQUENCE 605

LOCATION 05049 DUDLEY ST

7

60

57

TAX #	NAME AND ADDRESS	LEGAL
0862266	WYLIE, ELIZABETH CLARA	PALMER & BROOKS PLEASANT ✓
INSPTR	5011 DUDLEY	VIEW ADD TO UNIVERSITY
DC	LINCOLN, NEBR. 68504	PLACE BLOCK 3 LOTS 8 & 9

SECTION 1-3 PABRPLVI

SEQUENCE	606	LOCATION	05011	DUDLEY	ST
----------	-----	----------	-------	--------	----

0862070	PICKERILL, MARILYNN J	PALMER & BROOKS PLEASANT ✓
INSPTR	5067 STARR	VIEW ADD TO UNIVERSITY
DC	LINCOLN, NEBR. 68504	PLACE BLOCK 2 LOT 1

SECTION 1-3

SEQUENCE	607	LOCATION	05067	STARR	ST
----------	-----	----------	-------	-------	----

0862088	RETZLAFF, WALTER H & GUSSIE B	PALMER & BROOKS PLEASANT ✓
INSPTR	5059 STARR	VIEW ADD TO UNIVERSITY
DC	LINCOLN, NE 68504	PLACE BLOCK 2 LOT 2

SECTION 1-3

SEQUENCE	608	LOCATION	05059	STARR	ST
----------	-----	----------	-------	-------	----

0862100	DRESSELHAUS, HAROLD E & CHRISTINE	PALMER & BROOKS PLEASANT ✓
INSPTR	5043 STARR	VIEW ADD TO UNIVERSITY
DC	LINCOLN, NE 68504	PLACE BLOCK 2 LOT 4

SECTION 1-3

SEQUENCE	609	LOCATION	05043	STARR	ST
----------	-----	----------	-------	-------	----

0862126	SEIDEL, PATRICK E & RUTH ELLEN	PALMER & BROOKS PLEASANT ✓
INSPTR	5027 STARR ST	VIEW ADD TO UNIVERSITY
DC	LINCOLN, NE 68504	PLACE BLOCK 2 LOT 6

SECTION 1-3

SEQUENCE	611	LOCATION	05027	STARR	ST
----------	-----	----------	-------	-------	----

0862134	FESLER, HARLEY L. & ELVA	PALMER & BROOKS PLEASANT ✓
INSPTR	5019 STARR	VIEW ADD TO UNIVERSITY
DC	LINCOLN, NEBR. 68504	PLACE BLOCK 2 LOT 7

SECTION 1-3

SEQUENCE	612	LOCATION	05019	STARR	ST
----------	-----	----------	-------	-------	----

60

61

55

TAX # NAME AND ADDRESS
0862142 HANSEN, WILLIAM & LINNIE L.
INSPTR 5011 STARR
DC LINCOLN, NE 68504

LEGAL
PALMER & BROOKS PLEASANT
VIEW ADD TO UNIVERSITY
PLACE BLOCK 2 LOT 8

PABRPLVI

SECTION 1-3

SEQUENCE 613 LOCATION 05011 STARR ST

0862169 POWELL, ROY FRANCIS &
INSPTR CINDY LYNN STUEFER
DC 5006 DUDLEY
LINCOLN, NE 68504

PALMER & BROOKS PLEASANT
VIEW ADD TO UNIVERSITY
PLACE BLOCK 2 LOTS 10
& 11

SECTION 1-3

SEQUENCE 615 LOCATION 05006 DUDLEY ST

0862177 HANNA, LESLIE D & DOUGLAS D
INSPTR 5018 DUDLEY
DC LINCOLN, NE 68504

PALMER & BROOKS PLEASANT
VIEW ADD TO UNIVERSITY
PLACE BLOCK 2 LOT 12

SECTION 1-3

SEQUENCE 616 LOCATION 05018 DUDLEY ST

0608215 DRAVER, LAWRENCE D & MARGARET
INSPTR 231 SANTA MONICA
DC LINCOLN, NEBR. 68504

HOLHE

HOLLYWOOD HEIGHTS BLOCK 3
LOT 7

SECTION 1-3

SEQUENCE 618 LOCATION 00831 SANTA MONICA AVE

0688151 BOWERS, DONALD L. & HELEN M
INSPTR 937 SANTA MONICA
DC LINCOLN, NE 68504

HOLLYWOOD HEIGHTS BLOCK 3
LOT 1

SECTION 1-3

SEQUENCE 621 LOCATION 00937 SANTA MONICA AVE

0688070 OWEN, CHARLES & SHIRLEY
INSPTR 800 SANTA MONICA
DC LINCOLN, NEBR. 68504

HOLLYWOOD HEIGHTS BLOCK 2
LOT 9

SECTION 1-3

SEQUENCE 622 LOCATION 00800 SANTA MONICA AVE

62

59

TAX # NAME AND ADDRESS
0688134 RINKEVICH, THOMAS E & VIRGINIA
INSPTR 926 SANTA MONICA
DC LINCOLN, NEBR. 68504

HOLHE

LEGAL
HOLLYWOOD HEIGHTS BLOCK 2
LOT 15

SECTION 1-3

SEQUENCE 627 LOCATION 00926 SANTA MONICA AVE

0687737 FOREMAN, DONALD F & AMELIA H
INSPTR 935 EL AVADO
DC LINCOLN, NE 68504

HOLLYWOOD HEIGHTS BLOCK 2
LOT 1

SECTION 1-3

SEQUENCE 628 LOCATION 00935 EL AVADO AVE

0687901 LINCOLN GOSPEL CHAPEL
INSPTR 936 EL AVADO AVE
DC LINCOLN, NE 68504

HOLLYWOOD HEIGHTS LOT 1 B1
EXEMPT
Block 1

SECTION 1-3

SEQUENCE 629 LOCATION 00936 EL AVADO AVE

0646074 MCCLURE, MARY LOU
INSPTR 1/2 BALL REAL ESTATE CO
DC 4444 D
LINCOLN, NE 68510

PAH2

PATRICIAN HEIGHTS BLOCK 4
LOT 1

SECTION 1-3

SEQUENCE 630 LOCATION 05141 WILSHIRE BLV

0688011 RIPA, LUMIR E & LOUISE A
INSPTR 901 EL AVADO
DC LINCOLN, NEBR. 68504

HOLLYWOOD HEIGHTS BLOCK 2
LOT 4

SECTION 1-3

SEQUENCE 631 LOCATION 00901 EL AVADO AVE

0687936 JAROS, JAMES J. & MARY
INSPTR 900 EL AVADO
DC LINCOLN, NEBR. 68504

HOLLYWOOD HEIGHTS BLOCK 1
LOT 4
Block 1

SECTION 1-3

SEQUENCE 632 LOCATION 00900 EL AVADO AVE

6

63

62

TAX # NAME AND ADDRESS
0687944 CARCHICK, STANLEY & THEODORA C
INSPTR 623 EL AVADO
DC LINCOLN, NE 68504

LEGAL
HOLHE HOLLYHIDE HEIGHTS BLOCK 1
LOT 5
Block 1

SECTION 1-3

SEQUENCE 633 LOCATION 00826 EL AVADO AVE

0647110 ADAMS, MICHAEL E. & BETTY
INSPTR 621 NO. 56TH ST.
DC LINCOLN, NEBR. 68504

HAWO HAPPY HOLLOW ADD BLK 1 LT 7 &
89' & ALL LT 8
Block 1

SECTION 1-3

SEQUENCE 635 LOCATION 00621 NO 56 ST

0647120 ANDERSON, AVERY D & CHRISTINE
INSPTR 411 NO 56
DC LINCOLN, NE 68504

HAPPY HOLLOW ADD BLOCK 1
LOT 9
Block 1

SECTION 1-3

SEQUENCE 636 LOCATION 00611 NO 56 ST

0647136 JENSEN, RALPH C & ELEANOR M
INSPTR 5540 T
DC LINCOLN, NE 68504

HAPPY HOLLOW ADD BLOCK 1
LOT 10
Block 1

SECTION 1-3

SEQUENCE 637 LOCATION 08540 T ST

0647152 MORROW, RAYMOND E & BETTY J
INSPTR 600 NO 55TH
DC LINCOLN, NEBR. 68504

HAPPY HOLLOW ADD BLOCK 1
LOT 12
Block 1

SECTION 1-3

SEQUENCE 638 LOCATION 00600 NO 55 ST

0647209 JOHNSON, DALE E & RUBY V
INSPTR 720 NO 55
DC LINCOLN, NEBR. 68504

HAPPY HOLLOW ADD BLK 1 LT
17 N 17&1 TENTH &
LT 18 94&9 TENTHS FT

SECTION 1-3

SEQUENCE 639 LOCATION 00720 NO 55 ST

Block 1

6

64

61

TAX # NAME AND ADDRESS
0647578 NILDON, VINCE J & DEBRA R
INSPTR 720 NO 54
DC LINCOLN, NE 68504

HAHO

LEGAL
HAPPY HOLLOW ADD BLOCK 2 ✓
LOT 36

SECTION 1-3

SEQUENCE 641 LOCATION 00720 NO 54 ST

0647543 JONES, WM S JR & CAROLYN A
INSPTR 640 NO 54
DC LINCOLN, NE 68504

HAPPY HOLLOW ADD BLOCK 2 ✓
LOT 33

SECTION 1-3

SEQUENCE 643 LOCATION 00640 NO 54 ST

0647535 THOMPSON, JANET K
INSPTR 630 NO 54
DC LINCOLN, NE 68504

HAPPY HOLLOW ADD BLOCK 2 ✓
LOT 32

SECTION 1-3

SEQUENCE 644 LOCATION 00630 NO 54 ST

0647471 BAATZ, FRANCINE S & MONTE A
INSPTR 520 NO 54
DC LINCOLN, NE 68504

HAPPY HOLLOW ADD BLOCK 2 ✓
LOT 26

SECTION 1-3

SEQUENCE 650 LOCATION 00520 NO 54 ST

0647454 JOHNSON, RANDALL L & DIXIE L
INSPTR 5410 S ST
DC LINCOLN, NE 68504

HAPPY HOLLOW ADD BLOCK 2 ✓
LOT 24

SECTION 1-3

SEQUENCE 652 LOCATION 05410 S ST

0647381 WHITE, RALPH R
INSPTR 7150 SO ELDORA DR
DC LINCOLN, NE 68505

HAPPY HOLLOW ADD
BLK 2 LOT 17

SECTION 1-3

SEQUENCE 657 LOCATION 00521 NO 56 ST

16

65

62

TAX # NAME AND ADDRESS
0647373 MAHONEY, PATRICIA D
INSPTR 5545 T ST
DC LINCOLN, NE 68504

HAWO

LEGAL
HAPPY HOLLOW ADD BLOCK 2
LOT 16

SECTION 1-3

SEQUENCE 658 LOCATION 05545 T ST

0647331 GROW, DON A & RAMONA R
INSPTR 5509 T ST
DC LINCOLN, NE 68504

HAPPY HOLLOW ADD BLOCK 2
LOT 12

SECTION 1-3

SEQUENCE 659 LOCATION 05509 T ST

0647314 ZEPLIN, JAMES T & JEAN A
INSPTR 601 ND 55
DC LINCOLN, NE 68504

HAPPY HOLLOW ADD BLOCK 2
LOT 10 & VACATED 10'
WALKWAY ADJACENT TO
THE SOUTH

SECTION 1-3

SEQUENCE 660 LOCATION 00601 ND 55 ST

0647306 WEST, BURT E & WILLA M
INSPTR 611 ND 55
DC LINCOLN, NEBR. 68504

HAPPY HOLLOW ADD BLK 2 LT 8
50 7' & ALL LT9

SECTION 1-3

SEQUENCE 661 LOCATION 00611 ND 55 ST

0647269 EBELER, ERNEST F & MABEL M
INSPTR ELNWOOD, NE 68349
DC

HAPPY HOLLOW ADD BLK 2 LT 4
S 39' &
LT 5 N 24 FT

SECTION 1-3

SEQUENCE 662 LOCATION 00715 ND 55 ST

0647250 ANDERSON, ROBERT L. & LINDA M
INSPTR 725 ND 55
DC LINCOLN, NE 68504

HAPPY HOLLOW ADD BLK 2 LT 3
S 47 FT &
LT 4 N 16'

SECTION 1-3

SEQUENCE 663 LOCATION 00725 ND 55 ST

6

66

63

TAX # NAME AND ADDRESS
0647241 FETRI, EDDAR & BEVERLY
INSPTR 735 NO 55
DC LINCOLN, NE 68504

HAHO

LEGAL
HAPPY HOLLOW ADD BLK 2 ALL ✓
LT2 & LT3 NBFT

SECTION 1-3

SEQUENCE 664 LOCATION 00735 NO 55 ST

0647233 SEARLES, JACK E
INSPTR 5433 VINE
DC LINCOLN, NE 68504

HAPPY HOLLOW ADD BLOCK 2 ✓
LBT 1

SECTION 1-3

SEQUENCE 665 LOCATION 05435 VINE ST

0647225 BOUSSELOT, JACK J & PATRICIA A
INSPTR 5501 VINE
DC LINCOLN, NE 68504

HAPPY HOLLOW ADD BLOCK 1 ✓
LDT 20

SECTION 1-3

SEQUENCE 666 LOCATION 05501 VINE ST

0647098 LYBARDER, WALTER R
INSPTR 2821 NO 6 RR 15
DC LINCOLN, NE 68521

HAPPY HOLLOW ADD BLK 1 LT 5 ✓
S 29' &
LT 6 N 36'

SECTION 1-3

SEQUENCE 669 LOCATION 00641 NO 56 ST

0516210 SCHAPPAUGH, STEVEN D
INSPTR 5105 ORCHARD
DC LINCOLN, NE 68504

CAHE

CAPITOL HEIGHTS SUB 15 16 & ✓
17 T F BARNES
SUB LOT 4
No Block

SECTION 1-3

SEQUENCE 670 LOCATION 05105 ORCHARD ST

0516244 WORSTER, GARY T
INSPTR 5131 ORCHARD
DC LINCOLN, NEBR. 68504

CAPITOL HEIGHTS SUB 15 16 & ✓
17 T F BARNES
SUB LOT 7
No Block

SECTION 1-3

SEQUENCE 673 LOCATION 05131 ORCHARD ST

0

67

64

TAX # NAME AND ADDRESS
0516261 BOWLAND, HOWARD E & KAREN L
INSPTR 5143 ORCHARD
DC LINCOLN, NE 68505

CAHE

LEGAL
CAPITOL HEIGHTS SUB 15 16 &
17 T F BARNES
SUB LOT 9 ✓

SECTION 1-3

NO BLOCK

SEQUENCE 675

LOCATION 05143 ORCHARD ST

0516473 GREENE, DALE W & LEAH
INSPTR 1101 NO 51
DC LINCOLN, NE 68504

NO BLOCK

CAPITOL HEIGHTS SUB 15 16 &
17 T F BARNES SUB:
LOTS 32 & 33 & N1/2 VAC Y
ST ADJ TO THE W145' OF LT
33 ✓

SECTION 1-3

SEQUENCE 677

LOCATION 01101 NO 51 ST

0516635 BASKINS, ROBERT L.
INSPTR 1019 NO. 51ST
DC LINCOLN, NEBR. 68504

" "

CAPITOL HEIGHTS SUB 15 16 &
17 T F BARNES
SUB LOT 49 ✓

SECTION 1-3

SEQUENCE 678

LOCATION 01019 NO 51 ST

0547237 FRANKS, KENNETH L & ROSEMARY
INSPTR 5615 L
DC LINCOLN, NE 68510

CONES

CONES SUB PT LTS 9 & 10
BARNES SUB SE1/4
NE1/4 20-10-7:W9' LOT 3 &
E42' LOT 4 BLOCK 3 ✓

SECTION 1-3

SEQUENCE 684

LOCATION 04640 ORCHARD ST

0942961 MILLER, LARRY (1/2 INT) &
INSPTR RYAN, ROBERT L (1/2 INT)
DC 1425 NO 59
LINCOLN, NE 68504

SUAC

SUNNYSIDE ACRES BLOCK 03
LOT 4 ✓

SECTION 1-3

SEQUENCE 687

LOCATION 01425 NO 59 ST

0942944 MUNDT, DENNIS D & MARLENE J
INSPTR 6425 LEXINGTON
DC LINCOLN, NE 68505

SUNNYSIDE ACRES BLOCK 3 LOT
2 ✓

SECTION 1-3

SEQUENCE 688

LOCATION 05825 HOLDREGE ST

68

3

TAX #	NAME AND ADDRESS	LEGAL
0942791	SNYDER, MICHAEL & CHRISTINA	SUNNYSIDE ACRES BLOCK 02
INSPTR	1440 NO 59 ST	LOT 4
DC	LINCOLN, NEBR. 68505	

SUAC

SECTION 1-3

SEQUENCE	689	LOCATION	01440 NO 59	ST
----------	-----	----------	-------------	----

0942804	PETERS, ARNOLD JR & JO ELLEN	SUNNYSIDE ACRES BLOCK 02
INSPTR	411 LAKEWOOD DR	LOT 5
DC	LINCOLN, NE 68510	

SECTION 1-3

SEQUENCE	690	LOCATION	01430 NO 59	ST
----------	-----	----------	-------------	----

0942847	SAHUELSON, CHARLES L & KATHRYN	SUNNYSIDE ACRES BLOCK 02
INSPTR	3264 SD 17	LOT 9
DC	LINCOLN, NE 68502	

SECTION 1-3

SEQUENCE	692	LOCATION	01408 NO 59	ST
----------	-----	----------	-------------	----

0942855	KARAVAS, ADAM S & ALEXANDRA	SUNNYSIDE ACRES BLOCK 02
INSPTR	HENNINGS, LARRY D & JEAN	LOT 10
DC	230 LAKEWOOD	
	LINCOLN, NE 68510	

SECTION 1-3

SEQUENCE	693	LOCATION	01400 NO 59	ST
----------	-----	----------	-------------	----

0942863	OCCONOR, STEVEN K & ROBIN L	SUNNYSIDE ACRES BLOCK 02
INSPTR	5910 TANGEMAN TERRACE	LOT 11
DC	LINCOLN, NE 68505	

SECTION 1-3

SEQUENCE	694	LOCATION	05910 TANGEMAN	TER
----------	-----	----------	----------------	-----

0942871	PARROTT, MICHAEL D. & JOANN L.	SUNNYSIDE ACRES BLOCK 02
INSPTR	5920 TANGEMAN TERRACE	LOT 12
DC	LINCOLN, NEBR. 68505	

SECTION 1-3

SEQUENCE	695	LOCATION	05920 TANGEMAN	TER
----------	-----	----------	----------------	-----

6

691

66

TAX # NAME AND ADDRESS
0942928 JACKSON, JAMES D
INSPTR 425 SO 26
DC LINCOLN, NE 68510

SUAC

LEGAL
SUNNYSIDE ACRES BLOCK 02
LOT 17

SECTION 1-3

SEQUENCE 696 LOCATION 01431 NO 60 ST

0942766 BENES, GREGORY V SUNNYSIDE ACRES BLOCK 2 LOT
INSPTR 7041 GARLAND 1
DC LINCOLN, NE 68505

SECTION 1-3

SEQUENCE 697 LOCATION 05935 HOLDREGE ST

0942758 KLEIS, BEATRICE M SUNNYSIDE ACRES BLOCK 01
INSPTR 6520 SUMNER LOT 6
DC LINCOLN, NEBR. 68506

SECTION 1-3

SEQUENCE 699 LOCATION 01400 NO 60 ST

0943339 MCWEN, HOMER H & DOROTHY M SUNNYSIDE ACRES FIRST ADD
INSPTR 1401 NO 61ST STREET BLOCK 2 LOT 7
DC LINCOLN, NEBR. 68505

SUAC1

SECTION 1-3

SEQUENCE 700 LOCATION 01401 NO 61 ST

0834386 SMITH, DONALD D & DORIS ORCUTT ACRES BLOCK 1 LOT 10
INSPTR 348 ORCUTT AVE EAST
DC LINCOLN, NEBR. 68504

ORAC

B/KI

SECTION 1-3

SEQUENCE 703 LOCATION 00348 E ORCUTT AVE

0834394 MAUEL, GRACE A ORCUTT ACRES BLOCK 1 LOT 11
INSPTR 340 ORCUTT AVENUE E
DC LINCOLN, NEBR. 68504

SECTION 1-3

SEQUENCE 704 LOCATION 00340 E ORCUTT AVE

6

70

5.2

TAX # NAME AND ADDRESS LEGAL
0834416 PENKAVA, EALEN D & CHRISTINE K ORAC DRCUTT ACRES BLOCK 1 LOT 13
INSPTR 324 DRCUTT AVE EAST
DC LINCOLN, NE 68504

SECTION 1-3

SEQUENCE 705 LOCATION 00324 E DRCUTT AVE

0834424 DIETZ, JOHN JR & BETTY A DRCUTT ACRES BLOCK 1 LOT 14
INSPTR 310 DRCUTT AVE EAST
DC LINCOLN, NEBR. 68504

SECTION 1-3

SEQUENCE 706 LOCATION 00310 E DRCUTT AVE

0834491 DLTMAN, MARVIN A & MARYANN DRCUTT ACRES BLOCK 1 LOT 21
INSPTR 5401 DRCUTT AVE SOUTH
DC LINCOLN, NEBR. 68504

SECTION 1-3

SEQUENCE 710 LOCATION 05401 SO DRCUTT AVE

0834505 ILG, CLIFFORD T & LEATA H DRCUTT ACRES BLOCK 1 LOT 22
INSPTR 301 DRCUTT AVE WEST
DC LINCOLN, NE 68504

SECTION 1-3

SEQUENCE 711 LOCATION 00301 W DRCUTT AVE

0834513 JOHNSON, EARL L & SHERAL I DRCUTT ACRES BLOCK 1 LOT 23
INSPTR 309 DRCUTT AVE WEST
DC LINCOLN, NEBR. 68504

SECTION 1-3

SEQUENCE 712 LOCATION 00309 W DRCUTT AVE

0834521 RICHARDS, LAWRENCE L & HELENE DRCUTT ACRES BLOCK 1 LOT 24
INSPTR 317 DRCUTT AVE WEST
DC LINCOLN, NE 68504

SECTION 1-3

SEQUENCE 713 LOCATION 00317 W DRCUTT AVE

6

71

65

TAX # NAME AND ADDRESS
0834530 YUHL, JOSEPHINE E
INSPTR 325 ORCUTT AVE WEST
DC LINCOLN, NEBR. 68504

ORAC

LEGAL
ORCUTT ACRES BLOCK 1 LOT 25

SECTION 1-3

SEQUENCE 714 LOCATION 00325 W ORCUTT AVE

0834548 HAWK, CAROL I
INSPTR 333 ORCUTT AVE WEST
DC LINCOLN, NEBR. 68504

ORCUTT ACRES BLOCK 1 LOT 26

SECTION 1-3

SEQUENCE 715 LOCATION 00333 W ORCUTT AVE

0834572 SCHWARTZKOPF, EDWARD & DOROTHY
INSPTR 3901 SD 27TH UNIT 23
DC LINCOLN, NE 68502

ORCUTT ACRES BLOCK 1 LOT 29

SECTION 1-3

SEQUENCE 717 LOCATION 00357 W ORCUTT AVE

0844594 THORN, LARRY E & BETTY J
INSPTR 5621 WILSHIRE BLVD
DC LINCOLN, NE 68505

PAYAVE

PARK VALLEY HEIGHTS BLOCK 4
LOT 2

SECTION 1-3

SEQUENCE 720 LOCATION 05621 WILSHIRE BLV

0844675 GOODWIN, VERNON W JR & DARLENE
INSPTR 840 ND 56
DC LINCOLN, NE 68504

PAYAVE

PARK VALLEY HEIGHTS BLK 4
LT 14 N 1' & LT
15 S 50'

SECTION 1-3

SEQUENCE 724 LOCATION 00840 ND 56 ST

0793183 FIRST NATIONAL BANK & TRUST CO
INSPTR % LADMAN, TERRY L
DC P.O. BOX 81008
LINCOLN, NE 68501

MILL

J S MILLERS SUB 20 10 7
S128.59' N328.59'
E298.57' LOT 32

SECTION 1-3

SEQUENCE 727 LOCATION 00201 ND 56 ST

6

72

67

TAX # NAME AND ADDRESS
0834319 EICHER, D D & LUETTA M
INSPTR 1301 SO 58
DC LINCOLN, NE 68506

ORAC

LEGAL
ORCUTT ACRES BLOCK 1 LOT 3

SECTION 1-3

SEQUENCE 730 LOCATION 00325 ND 56 ST

0834327 JACKSON, KEITH J.
INSPTR 333 ND 56
DC LINCOLN, NEBR. 68504

ORCUTT ACRES BLOCK 1 LOT 4

SECTION 1-3

SEQUENCE 731 LOCATION 00333 ND 56 ST

0834335 MCGINN, CONSTANCE M
INSPTR 341 ND 56
DC LINCOLN, NE 68504

ORCUTT ACRES BLOCK 1 LOT 5

SECTION 1-3

SEQUENCE 732 LOCATION 00341 ND 56 ST

0834343 CAMPBELL, RANDY E
INSPTR 347 ND 56
DC LINCOLN, NE 68504

ORCUTT ACRES BLOCK 1 LOT 6

SECTION 1-3

SEQUENCE 733 LOCATION 00347 ND 56 ST

0834351 MARVEL, ROBERT JESS &
INSPTR BRENDA LYNN
DC 353 ND 56
LINCOLN, NE 68504

ORCUTT ACRES BLOCK 1 LOT 7

SECTION 1-3

SEQUENCE 734 LOCATION 00353 ND 56 ST

0834360 ROESLER, LAWRENCE E. & FRANCES
INSPTR 5540 M ST
DC LINCOLN, NE 68510

ORCUTT ACRES BLOCK 1 LOT 8

SECTION 1-3

SEQUENCE 735 LOCATION 05511 R ST

6

73

TAX CODE	NAME & ADDRESS	LEGAL
0724075 INSPTR DC	KIMCO ADDITION INC 3910 SOUTH ST LINCOLN, NE	IRREGULAR TRACT 1 235 HW 21-10-7
SECTION 1-3		
SEQUENCE 737		LOCATION 05601 HOLDREDGE ST FC
0724107 INSPTR DC	MISSOURI PACIFIC RAILROAD	IRREGULAR TRACTS RAILROAD ROW ACROSS SE 1/4 21-10-7
SECTION 1-3		
SEQUENCE 740		LOCATION E. OF 56TH STREET
0844209 INSPTR DC	BUTT, KENNETH A & NEDLA R 5600 WILSHIRE BLVD LINCOLN, NEBR.	<i>PAYAHE</i> PARK VALLEY HEIGHTS BLOCK 1 LOT 14
SECTION 1-3		
SEQUENCE 741		<i>Block 1</i> LOCATION 05600 WILSHIRE BLV
0844161 INSPTR DC	SHEPPERSON, MEREL C & LOLA M 5640 WILSHIRE BLVD LINCOLN, NE	PARK VALLEY HEIGHTS BLOCK 1 LOT 10
SECTION 1-3		
SEQUENCE 743		LOCATION 05640 WILSHIRE BLV
0844060 INSPTR DC	BUTTON, LAVERNE H & CATHERINE 5830 WILSHIRE BLVD LINCOLN, NE	PARK VALLEY HEIGHTS BLOCK 1 LOT 1 LOT 2 E. HLF
SECTION 1-3		
SEQUENCE 747		LOCATION 05830 WILSHIRE BLV
0743798 INSPTR DC	EDWARDS, RUTH E 900 NO 59 LINCOLN, NE	<i>KRUEGER</i> KRUEGER ADD BLOCK 1 LOT 7
SECTION 1-3		
SEQUENCE 748		<i>Block 1</i> LOCATION 00900 NO 59 ST

6

7.4

71

TAX #	NAME AND ADDRESS	LEGAL
0743763	KRUEGER, OTTO H & LILLIE M 830 NO 59 DC LINCOLN, NE 68505	KRUEGER ADD BLOCK 1 LOT 4 KRUEGER
SECTION 1-3		
SEQUENCE 749	LOCATION 00830 NO 59	ST
0743739	FELLERS, ARTHUR R & WILMA P 5700 VINE DC LINCOLN, NE 68505	KRUEGER ADD BLOCK 1 LOT 1
SECTION 1-3		
SEQUENCE 750	LOCATION 05900 VINE	ST
0844284	SAALFELD, MELVIN W & SHARON A 5840 VINE DC LINCOLN, NE 68505	PARK VALLEY HEIGHTS BLOCK 2 LOT 9 SD 70 PAVAHE
SECTION 1-3		
SEQUENCE 754	LOCATION 05840 VINE	ST
0844275	SPAHN, LEONARD J & THERESSA 811 NO 59 DC LINCOLN, NE 68505	PARK VALLEY HEIGHTS BLK 2 ALL LT 8 & N5' LT 9
SECTION 1-3		
SEQUENCE 755	LOCATION 00811 NO 59	ST
0844250	NIEBUHR, GERHARD & GISELA 825 N 59 DC LINCOLN, NEBR. 68505	PARK VALLEY HEIGHTS BLOCK 2 LOT 5 S 46 FT LOT 6 N 55 FT
SECTION 1-3		
SEQUENCE 756	LOCATION 00825 NO 59	ST
0844233	TRAUDT, HELEN R 901 N 59 DC LINCOLN, NE 68505	PARK VALLEY HEIGHTS BLOCK 2 LOT 3 & N10' LOT 4
SECTION 1-3		
SEQUENCE 757	LOCATION 00901 NO 59	ST

6

75

72

TAX #	NAME AND ADDRESS	LEGAL
0844225	ERWAY, VIOLET C	PARK VALLEY HEIGHTS BLOCK 2
INSPTR	911 N 59	LOT 2
DC	LINCOLN, NE 68505	

PAVAHE

SECTION 1-3

SEQUENCE	738	LOCATION 00911 NO 59	ST
----------	-----	----------------------	----

0844217	STROUGH, CYNTHIA J	PARK VALLEY HEIGHTS BLOCK 2
INSPTR	5835 WILSHIRE	LOT 1
DC	LINCOLN, NE 68505	

SECTION 1-3

SEQUENCE	739	LOCATION 05535	WILSHIRE	BLV
----------	-----	----------------	----------	-----

0844373	WORM, ARTHUR J & FRANCES G	PARK VALLEY HEIGHTS BLOCK 2
INSPTR	5801 WILSHIRE BLVD	LOT 18
DC	LINCOLN, NE 68505	

SECTION 1-3

SEQUENCE	760	LOCATION 05601	WILSHIRE	BLV
----------	-----	----------------	----------	-----

0844365	WISMER, E GLEN	PARK VALLEY HEIGHTS BLOCK 2
INSPTR	% CRUSE, MICHAEL & SUSAN-CONT	LOT 17
DC	5527 LAKESHORE DR RT.4	
	MANHATTAN, KS 66502	

SECTION 1-3

SEQUENCE	761	LOCATION 00910 NO 58	ST
----------	-----	----------------------	----

0844560	FITZWATER, PAUL H & VELMA B	PARK VALLEY HEIGHTS BLOCK 3
INSPTR	740 NO 57	LOT 17
DC	LINCOLN, NE 68505	

SECTION 1-3

SEQUENCE	769	LOCATION 00940 NO 57	ST
----------	-----	----------------------	----

0688452	REITH, MERLIN L	HOLLYWOOD HEIGHTS BLOCK 4
INSPTR	2772 SO 39	LOT 11
DC	LINCOLN, NE 68506	

HOLHE

SECTION 1-3

SEQUENCE	771	LOCATION 00800	HOLLYWOOD	AVE
----------	-----	----------------	-----------	-----

6

76

73

TAX # 0688371
NAME AND ADDRESS
INSPTR 917 LA BREA
DC LINCOLN, NE 68504

LEGAL
HOLHE HOLLYWOOD HEIGHTS BLOCK 4
LOT 3

SECTION 1-3

SEQUENCE 778 LOCATION 00917 LA BREA AVE

0688347 THEISEN, STEVEN A & SALLY M
INSPTR 936 LABREA
DC LINCOLN, NE 68504

HOLLYWOOD HEIGHTS BLOCK 3
LOT 20

SECTION 1-3

SEQUENCE 752 LOCATION 00936 LA BREA AVE

0845531 WIENEKE, JANICE A
INSPTR 5310 WILSHIRE BLVD.
DC LINCOLN, NE 68504

PAHE PATRICIAN HEIGHTS BLOCK 1
LOT 5

SECTION 1-3

SEQUENCE 790 LOCATION 05310 WILSHIRE BLV

0845540 HOLLATZ, DANIEL H.
INSPTR 8100 WOODBERRY DR
DC LINCOLN, NE 68523

PATRICIAN HEIGHTS BLOCK 1
LOT 6

SECTION 1-3

SEQUENCE 791 LOCATION 05308 WILSHIRE BLV

0845574 BRIDGER, DAVID E
INSPTR 5226 WILSHIRE BLVD
DC LINCOLN, NE 68504

PATRICIAN HEIGHTS BLK 1 W2'
LOT 8 & ALL LOT 9 & E2' LOT
10

SECTION 1-3

SEQUENCE 792 LOCATION 05226 WILSHIRE BLV

0845582 PARKE, EUGENE H & PAULINE P
INSPTR 5210 WILSHIRE BLVD
DC LINCOLN, NE 68504

PATRICIAN HEIGHTS BLOCK 1
LOT 10 W 53

SECTION 1-3

SEQUENCE 793 LOCATION 05210 WILSHIRE BLV

6

77

74

TAX # NAME AND ADDRESS
0845391 FOUGHT, ROBERT A & ELIZABETH A
INSPTR 5200 WILSHIRE BLVD
DC LINCOLN, NE 68504

PANE

LEGAL
PATRICIAN HEIGHTS BLOCK 3
LOT 11

SECTION 1-3

SEQUENCE 794 LOCATION 00200 WILSHIRE BLV

0688843 CURNING, FRANK M & LINDA C
INSPTR 4920 WILSHIRE BLVD
DC LINCOLN, NE 68504

HOLHE

HOLLYWOOD HEIGHTS BLOCK 6
LOT 16

SECTION 1-3

SEQUENCE 798 LOCATION 04920 WILSHIRE BLV

0688860 WITTMAN BROTHERS LTD
INSPTR Z TRUST DEPT UNION BANK
DC PO BOX 6155
LINCOLN, NE 68506

HOLLYWOOD HEIGHTS BLOCK 6
LOT 20 &
E 56' LOT 21 BLK 6

SECTION 1-3

SEQUENCE 800 LOCATION 04830 WILSHIRE BLV

0688878 WITTMAN BROTHERS, LTD.
INSPTR UNION BANK & TRUST - TRUST
DC DEP. O. BOX 6155
LINCOLN, NE 68506

HOLLYWOOD HEIGHTS LOT 21 EX
E 56' BLK 6

SECTION 1-3

SEQUENCE 801 LOCATION 00930 NO 48 ST
WENDY'S

0456845 MINLINER CORPORATION
INSPTR 2555 NO 48 ST
DC LINCOLN, NE 68506

BANE

BARNES ADD TO NEWMAN
N151.3' S426.3' E84' W150'
LOT B

SECTION 1-3

SEQUENCE 803 LOCATION 00840 NO 48 ST

NO BLOCK

0456829 ZAGER, BARRY L & JUDITH A
INSPTR 810 NO 48
DC LINCOLN, NE 68504

BARNES ADD TO NEWMAN EX RD
N65FT S175FT W150FT E OF E
LINE OF 48TH ST
LOT B

SECTION 1-3

SEQUENCE 804 LOCATION 00810 NO 48 ST

NO BLOCK

6

78

75

TAX #	NAME AND ADDRESS	LEGAL
0456608 INSPTR DC	GUNCLING, THOMAS W & CONNIE J 2251 PLEASANT HILL RD LINCOLN, NE 68502	BARNES ADD TO NEWMAN BLOCK 1 550' N108.4' E124.8' LOT 1
SECTION 1-3		Block 1
SEQUENCE 808	LOCATION 00961 ND 56	ST
0456616 INSPTR DC	LORENZEN, RICHARD H & JEANNE M 951 ND 56TH LINCOLN, NEBR. 68504	BARNES ADD TO NEWMAN BLOCK 1 LOT 1 S 39 OF E 124 & 8 TENTS LOT 2 N 11 OF E 124 & 8 TENTS
SECTION 1-3		
SEQUENCE 809	LOCATION 00951 ND 56	ST
0456632 INSPTR DC	WEIDEMAN, NORMAN A & SHARON J 941 N 56 LINCOLN, NE 68504	BARNES ADD TO NEWMAN BLOCK 1 LOT 2 S 63 OF N 74 OF E 124 & 8 TENTS
SECTION 1-3		
SEQUENCE 810	LOCATION 00941 ND 56	ST
0456705 INSPTR DC	HANHART, BERNADETTE M 6231 FLEETWOOD DR LINCOLN, NE 68516	BARNES ADD TO NEWMAN BLOCK 1 S19' E124' LOT 2 & N31' E124.8' LOT 3
SECTION 1-3		
SEQUENCE 811	LOCATION 00921 ND 56	ST
0456713 INSPTR DC	GAYED, RISK R & BOBBIE JEAN 525 ND 48 LINCOLN, NE 68504	BARNES ADD TO NEWMAN BLOCK 1 S2' OF E1/2 LOT 3 & N48' E1/2 LOT 4
SECTION 1-3		
SEQUENCE 813	LOCATION 00831 ND 56	ST
0456781 INSPTR DC	CHURCH OF CHRIST OF LINCOLN 5640 VINE LINCOLN, NEBR. 68505	BARNES ADD TO NEWMAN BLOCK 01 LOT 5 E 1/2
SECTION 1-3		
SEQUENCE 814	LOCATION 05520 VINE	ST

6

80

77

TAX #	NAME AND ADDRESS	PAGE	LEGAL
0846210 INSPTR DC	BROCK, JAMES W & BARBARA L STURGEON, GEO W & JOANNE L 5430 WILSHIRE LINCOLN, NE 68504	PAHE1	PATRICIAN HEIGHTS FIRST ADD BLOCK 1 LOT 4
SECTION 1-3			
SEQUENCE	822	LOCATION	05430 WILSHIRE DR
0846220 INSPTR DC	SELLERS, ALLEN L & ELIZABETH 5420 WILSHIRE LINCOLN, NE 68504		PATRICIAN HEIGHTS FIRST ADD BLOCK 1 LOT 5
SECTION 1-3			
SEQUENCE	823	LOCATION	05420 WILSHIRE BLV
0845493 INSPTR DC	ZUHLKE, JERILYN L 5410 WILSHIRE BLVD LINCOLN, NE 68504	PAHE	PATRICIAN HEIGHTS BLOCK 1 LOT 1
SECTION 1-3			
SEQUENCE	824	LOCATION	05410 WILSHIRE BLV
0845507 INSPTR DC	MCMANON, DARRELL F & MARILYN L 5400 WILSHIRE BLVD. LINCOLN, NE 68504		PATRICIAN HEIGHTS BLOCK 1 LOT 2
SECTION 1-3			
SEQUENCE	825	LOCATION	05400 WILSHIRE BLV
0646229 INSPTR DC	STEPHENSON, CLIFFORD & FLORENCE 3935 SUMNER LINCOLN, NE 68504	HAPL	HANSON PLAZA BLOCK 2 LOT 4
SECTION 1-3			
SEQUENCE	826	LOCATION	01430 NO 53 ST
0646211 INSPTR DC	BEECHAM, JOHN B. & LAURA L. 5311 HOLDREGE LINCOLN, NEBR. 68504		HANSON PLAZA BLOCK 2 LOT 3
SECTION 1-3			
SEQUENCE	827	LOCATION	05311 HOLDREGE ST

6

81

78

TAX # NAME AND ADDRESS
1024510 FLEMING, MICHAEL S
INSPTR 5245 HOLDREGE
DC LINCOLN, NEBR. 68504

WITJURE

LEGAL
WITT & JUCKETTES REPLAT LOT
1

SECTION 1-3

SEQUENCE 828 LOCATION 05245 HOLDREGE ST

1024544 HORAK, JOSEPH JR & JANET L
INSPTR 132 NW HIGGS DR
DC PORT CHARLOTTE, FL 33752

WITT & JUCKETTES REPLAT LOT
4

SECTION 1-3

SEQUENCE 830 LOCATION 01401 NO 53 ST

1024552 HELDET, NORMAN L
INSPTR 1351 NO 53
DC LINCOLN, NE 68504

WITT & JUCKETTES REPLAT LOT
5

SECTION 1-3

SEQUENCE 831 LOCATION 01341 NO 53 ST

1024587 GREEN, ANNIS G & ALMA L
INSPTR 1311 N 53
DC LINCOLN, NEBR. 68504

WITJURE

WITT & JUCKETTES REPLAT LOT
8

SECTION 1-3

SEQUENCE 832 LOCATION 01311 NO 53 ST

1024595 KELLEY, DONALD W & BESS J
INSPTR 1301 NO 53
DC LINCOLN, NEBR. 68504

WITT & JUCKETTES REPLAT LOT
9

SECTION 1-3

SEQUENCE 833 LOCATION 01301 NO 53 ST

1024609 SCHWARTING, LYLE G & NORMA
INSPTR 1231 NO. 53RD ST.
DC LINCOLN, NEBR. 68504

WITT & JUCKETTES REPLAT LOT
10

SECTION 1-3

SEQUENCE 834 LOCATION 01231 NO 53 ST

6

82

79

TAX #	NAME AND ADDRESS	LEGAL
1024617	KELLEY, DONALD W & BESS J	WITT & JUCKETTES REPLAT LOT
INSPTR	5942 MADISON	11
DC	LINCOLN, NE 68507	

WITJURE

No Book

SECTION 1-3

SEQUENCE	835	LOCATION	01221 NO 53	ST
----------	-----	----------	-------------	----

1024633	SELL, JULIE & WIEDEMAN, MARK	WITT & JUCKETTES REPLAT LOT
INSPTR	1201 NO 53	13
DC	LINCOLN, NE 68504	

SECTION 1-3

SEQUENCE	836	LOCATION	01201 NO 53	ST
----------	-----	----------	-------------	----

1024641	BAIBLER, DENNIS D	WITT & JUCKETTES REPLAT LOT
INSPTR	2721 NO 74	14
DC	LINCOLN, NE 68507	

SECTION 1-3

SEQUENCE	837	LOCATION	01200 NO 52	ST
----------	-----	----------	-------------	----

0575140	CHURCH OF GOD IN THE STATE OF	EALRADUNPL
INSPTR	NEBR.	EAST LAWN ADD TO UNIVERSITY
DC	1305 NO. 52ND ST.	PLACE LOTS 65 THRU 72
	LINCOLN, NEBR. 68504	

No Book

SECTION 1-3

SEQUENCE	838	LOCATION	01302 NO 52	ST
----------	-----	----------	-------------	----

0575101	WILTSE, DOUG & JEAN	EAST LAWN ADD TO UNIVERSITY
INSPTR	5103 STARR	PLACE LOTS 51 & 52
DC	LINCOLN, NE 68504	

SECTION 1-3

SEQUENCE	843	LOCATION	05103 STARR	ST
----------	-----	----------	-------------	----

0793132	I I INC, A CORP	MILL
INSPTR	6515 RAILROAD ST	J G MILLERS SUB 20 10 7 6
DC	RAYTOWN, MD 64133	301 & 5 INTS
		EX 65' S200' EX STR LOT 31
		& S 301 & 5
		TNTS' W298.35' LOT 32

SECTION 1-3

SEQUENCE	844	LOCATION	05300 0	ST
----------	-----	----------	---------	----

No Book

6

83

80

No Block

BURLEIGH

TAX # NAME AND ADDRESS
 0505081 ALESIO, ANTHONY
 INSPTR XTONY&LUIGI'S LIMIT
 DC PARTNERSHIPATTN:JOE BUDA-2224
 HANOVER CT LINCOLN, NE 68512
 SECTION 1-3

LEGAL
 BURLEIGH SUB L30 J B
 MILLERS SUB S1/2
 20-10-7:EX S178' L A & EX
 S1117' L B & C
 S150' EX S35' E66' L H &
 S150' E 36' LOT B

SEQUENCE 846

LOCATION 05140 D ST
 TONY & LUIGIS REST.

0793108 J & A REAL ESTATE, INC
 INSPTR PO BOX 30537
 DC 5020 D
 LINCOLN, NE 68503
 SECTION 1-3

MILL

J B MILLERS SUB 20-10-7 W
 143' E310' S166'
 EX S6' L29 ✓

SEQUENCE 847

LOCATION 04900 D ST

No Block

0793078 SUP, GALE & DERNICE
 INSPTR 2464 WOODCREST
 DC LINCOLN, NE 68502
 SECTION 1-3

MILL

J B MILLERS SUB 20 10 7
 N150' S300' E150'
 W210' DR W210' S1/2 LOT 29
 EX S150' & EX
 W60'

SEQUENCE 849

LOCATION 00140 ND 48 ST
 FC

No Block

0792837 ARENA SKATE WORLD INC.
 INSPTR 1530 SD 70 #202
 DC LINCOLN, NE 68506
 SECTION 1-3

J B MILLERS SUB (S1/2
 20-10-7) LOT 20 S179.3'
 W1/2 EX RD ✓

SEQUENCE 851

LOCATION 00300 ND 48 ST

0792799 ARMSTRONG, JEAN & PAUL V
 INSPTR 366 N 48
 DC LINCOLN, NE 68504
 SECTION 1-3

J B MILLERS SUB (S1/2
 20-10-7) LOT 20 N125' OF
 W HALF EX RD ✓

SEQUENCE 852

LOCATION 00366 ND 48 ST

0792811 ROMERO, RON D & DOROTHY T
 INSPTR 5917 WOODSTOCK
 DC LINCOLN, NE 68512
 SECTION 1-3

J B MILLERS SUB (S1/2
 20-10-7) S 125' N 250'
 W 1/2 EX RD & N 15' S 100'
 N 350'
 W 1/2 LOT 20 ✓

SEQUENCE 853

LOCATION 00360 ND 48 ST

✓

84

81

TAX # NAME AND ADDRESS
0792527 U-HAUL OF NEBRASKA
INSPTR 2721 NO CENTRAL AVE
DC SUITE 700
PHOENIX, AZ 85004

MILL LEGAL

J G MILLERS SUB (S1/2
20-10-7) N200' EX W60' & EX
N17' & EX W226' S183'
N200' LOT 4

SECTION 1-3

NO BLOCK

SEQUENCE 856

LOCATION VACANT LOT, E OF 740 N. 48TH

0792471 DUBINSKY, SARGE S & GAYLE P
INSPTR ET AL
DC 6420 ROGERS CIR
LINCOLN, NE 68506

MILL

J G MILLERS SUB S1/2
20-10-7: LOT 3

SECTION 1-3

NO BLOCK

SEQUENCE 857

LOCATION 05001 VINE ST

1537975 HANCOCK, ROBERT I & ANN
INSPTR 10730 PACIFIC STREET
DC SUITE 214
OMAHA, NE 68114

J G MILLERS SUB S1/2
20-10-7: S1/2 LOT
15 EX E30' & EX S7' & EX
W60'

SECTION 1-3

SEQUENCE 859

LOCATION 5300 "R" STREET

0834629 PARO, KENNETH L & LOIS M
INSPTR 324 ORCUTT AVE WEST
DC LINCOLN, NEBR. 68504

ORAC

ORCUTT ACRES BLOCK 2 LOT 5

SECTION 1-3

SEQUENCE 861

LOCATION 00324 W ORCUTT AVE

0634637 LINEBERRY, ABRAHAM L & SANDRA
INSPTR 316 ORCUTT AVE WEST
DC LINCOLN, NE 68504

ORCUTT ACRES BLOCK 2 LOT 6

SECTION 1-3

SEQUENCE 862

LOCATION 00316 W ORCUTT AVE

0834653 PORTSCHE, ROBERT J SR & VICKI
INSPTR 5500 ORCUTT AVE SO
DC LINCOLN, NE 68504

ORCUTT ACRES BLOCK 2 LOT 8

SECTION 1-3

SEQUENCE 864

LOCATION 05500 SO ORCUTT AVE

6

85

82

TAX # NAME AND ADDRESS
0834661 DORF, MARVIN L.
INSPTR 301 ORCUTT AVE EAST
DC LINCOLN, NEBR. 68504

LEGAL
ORAC ORCUTT ACRES BLOCK 2 LOT 9

SECTION 1-3

SEQUENCE 865 LOCATION 00301 E ORCUTT AVE

0834670 HENDRICKS, STEVEN D & DEBRA J ORCUTT ACRES BLOCK 2 LOT 10
INSPTR 317 ORCUTT AVE E
DC LINCOLN, NE 68504

SECTION 1-3

SEQUENCE 866 LOCATION 00317 E ORCUTT AVE

0834700 MILES, FREDERICK V JR & SANDRA LYNN ORCUTT ACRES BLOCK 2 LOT 13
INSPTR 341 ORCUTT AVE EAST
DC LINCOLN, NE 68504

SECTION 1-3

SEQUENCE 867 LOCATION 00341 E ORCUTT AVE

0834581 ROCKENBACH, ANNA ORCUTT ACRES BLOCK 2 LOT 1
INSPTR 5431 R ST
DC LINCOLN, NEBR. 68504

SECTION 1-3

SEQUENCE 869 LOCATION 05431 R ST

0647772 HOFFMAN, RONALD A & LUCILLE HAPPY HOLLOW 1ST ADD LOT 18
INSPTR 401 NO 56TH EX N57' E120'
DC LINCOLN, NEBR. 68504

HAHD1

NO BLOCK

SECTION 1-3

SEQUENCE 875 LOCATION 00401 NO 56 ST

0647608 RUSSELL, MAURICE L & LORETTA M HAPPY HOLLOW FIRST LOT 1
INSPTR 5545 S
DC LINCOLN, NE 68504

SECTION 1-3

SEQUENCE 878 LOCATION 05545 S ST

6

86

83

TAX # NAME AND ADDRESS
0647691 RUSER, KEVIN & KATHLEEN J
INSPTR 5401 S ST
DC LINCOLN, NE 68504

HAPHOL

LEGAL
HAPPY HOLLOW FIRST LT 9 W
IFT & ALL LT 10

SECTION 1-3

No Block

SEQUENCE 886 LOCATION 05401 S ST

0549240 SHIELDS, GARLAND L
INSPTR BOX 72
DC MILTONA, MN 56354

COTNER

COTNER ADD BLOCK 09 LOT 2
S5, & LT 3

SECTION 1-3

SEQUENCE 887 LOCATION 00935 NO 65 ST

0646504 BALDWIN, RANDY G & JOANNE
INSPTR 1133 NO 55
DC LINCOLN, NE 68504

HAPL1

HANSON PLAZA FIRST ADD LOT
4

No Block

SECTION 1-3

SEQUENCE 889 LOCATION 01251 NO 56 ST

0646318 WALDRON, CHARLES L & MARILYN A
INSPTR 1230 NO 53
DC LINCOLN, NE 68504

HAPL

HANSON PLAZA BLOCK 2 LOT 13

SECTION 1-3

SEQUENCE 898 LOCATION 01230 NO 53 ST

0646024 KLEIS, ROBERT W
INSPTR 6520 SUMNER
DC LINCOLN, NE 68506

HANSON PLAZA BLOCK 1 LOT 12

SECTION 1-3

SEQUENCE 899 LOCATION 01240 NO 54 ST

0846066 TURNWALL, ERNEST J & BEVERLY K
INSPTR 5436 VINE
DC LINCOLN, NE 68504

PAHE

PATRICIAN HEIGHTS BLOCK 3
LOT 23

SECTION 1-3

SEQUENCE 900 LOCATION 05436 VINE ST

6

87

84

TAX #	NAME AND ADDRESS	LEGAL
1024412	PULAC, JOSEPH F & ROSE B	WITT & JUCKETTE PARK VIEW
INSPTR	625 NO 68	BLOCK 3 LOT 5
DC	LINCOLN, NE 68505	

WISUPAVE

✓

SECTION 1-3

SEQUENCE	901	LOCATION	00625 NO 68	ST
----------	-----	----------	-------------	----

1024323	SPOMER, JOHN E & MAXINE E	WITT & JUCKETTE PARK VIEW
INSPTR	6800 JOYCE	BLOCK 1 LOT 14
DC	LINCOLN, NE 68505	

✓

SECTION 1-3

SEQUENCE	902	LOCATION	06800 JOYCE	AVE
----------	-----	----------	-------------	-----

0845736	WURDEMAN, LOWELL E & GERALDINE	PAHE
INSPTR	5200 HEUMANN DR.	PATRICIAN HEIGHTS BLOCK 2
DC	LINCOLN, NEBR. 68504	LOT 12

✓

SECTION 1-3

SEQUENCE	910	LOCATION	05200 HEUMANN	DR
----------	-----	----------	---------------	----

0845744	ABRAHAMS, HARRY & RUTH M	PATRICIAN HEIGHTS BLOCK 2
INSPTR	% LINCOLN LIFE & CASUALTY CO	LOT 13
DC	PO BOX 81209	
	LINCOLN, NE 68501	

✓

SECTION 1-3

SEQUENCE	911	LOCATION	05230 HEUMANN	DR
----------	-----	----------	---------------	----

1652855	FRANKS, KENNETH L & ROSEMARY	CONES
INSPTR	4820 ORCHARD	CONES SUB OF BARNES SUB NE
DC	LINCOLN, NE 68504	20-10-7 PART OF LOTS 9 &
		10: BLOCK 3 LOTS 6, 7,
		8 & 9

✓

SECTION 1-3

SEQUENCE	914	LOCATION	04820 ORCHARD	ST
----------	-----	----------	---------------	----

0942936	MUNDT, DENNIS D. & MARLENE	SUAC
INSPTR	6425 LEXINGTON	SUNNYSIDE ACRES BLOCK 03
DC	LINCOLN, NE 68505	LOT 1

✓

SECTION 1-3

SEQUENCE	915	LOCATION	05835 HOLDREGE	ST
----------	-----	----------	----------------	----

6

88

85

TAX # 1648301
NAME AND ADDRESS HEMMER, WILLIAM H & ESTHER L
INSPTR 5840 WILSHIRE BLVD
DC LINCOLN, NE 68505

PAVAHE

LEGAL
PARK VALLEY HEIGHTS BLOCK 1
OUTLOT A AND IRREGULAR
TRACT LOT 204 NW & A
TRACT IN NW CORNER OF LOT
239 NW 21-10-7 (TRACT
OF LOT 239 NW DESCRIBED IN
LOCATION 05840 WILSHIRE BLV

No
Bik

SECTION 1-3
SEQUENCE 916

1024528 KNAPE, BEVERLY J
INSPTR C/O RUSS FUHRING
DC 2300 SO 75 ST
LINCOLN, NEBR. 68505

WIJURE

WITT & JUCKETTES REPLAT LOT
2

NO BLOCK

SECTION 1-3
SEQUENCE 918

LOCATION 01421 NO 53 ST

0773141 BANKERS LIFE INS CO OF NEBR
INSPTR X I I INC
DC 6515 RAILROAD ST
RAYTOWN, MO 64133

MILL

J G MILLERS SUB 20-10-7 LOT
31 N327.8
W273.8' W 1/2 EX STR

NO BLOCK

SECTION 1-3
SEQUENCE 919

LOCATION 05300 D ST

0469327 FIRST FEDERAL LINCOLN SAVINGS
INSPTR PO BOX 83009
DC LINCOLN, NE 68501

BETHANNY

BETHANY HEIGHTS BLOCK 63
LOTS 3 THRU 7 &
ALL VAC ALLEY ADJ EX E10'
ADJ TO LOTS 1 & 2

SECTION 1-3
SEQUENCE 924

LOCATION 01409 NO 66 ST
FC PICADILLY SQUARE

1399351 SPL COMPANY
INSPTR % MICHAEL BO CONRAD
DC 314 N. WINNEBAGO DR
LAKE WINNEBAGO, MO 64034

.62 ACRES IN SW CORNER OF
IRREG TRACT
LOT 233 SE 21-10-7
(ALSO DESCRIBED AS:
COMMENCING FROM THE S1/4
CORN OF SAID

SECTION 1-3
SEQUENCE 925

LOCATION 06404 D ST

0516368 RASMUSSEN, MARTHA L.
INSPTR 1140 NO 52
DC LINCOLN, NE 68504

CAHE

CAPITOL HEIGHTS SUB 15 16 &
17 T F BARNES
SUB LOT 20

SECTION 1-3
SEQUENCE 926

LOCATION 01140 NO 52 ST

7

89

86

TAX #	NAME AND ADDRESS	LEGAL
0862240	GREENING, DENNIS D ER & JEANNE	PALMER & BRUCKS PLEASANT
INSPTR	5019 DUDLEY	VIEW ADD TO UNIVERSITY
DC	LINCOLN, NE 68504	PLACE BLOCK 3 LOT 7

PABRPLVI

SECTION 1-3

SEQUENCE	932	LOCATION	05019	DUDLEY	ST
----------	-----	----------	-------	--------	----

0647594	FRY, SHARON ALBURY	HAPPY HOLLOW ADD BLOCK 2
INSPTR	5401 VINE	LOT 3B
DC	LINCOLN, NEBR. 68504	

WAHO

SECTION 1-3

SEQUENCE	933	LOCATION	05401	VINE	ST
----------	-----	----------	-------	------	----

0455822	HOLD INC	BLOCK 1 LOT 1 E125' & W30'
INSPTR	2930 NORTH 33	VAD 56TH ST
OF	LINCOLN, NE 68504	

SECTION 1-3

SEQUENCE	936	LOCATION	5600	HOLDREGE
----------	-----	----------	------	----------

0771368	DILLON REAL ESTATE CO INC	LOMA LINDA LOT 102 W125' &
INSPTR	% SAVAGE, SAVAGE & BROWN	525' W125' L101
OF	P.O. BOX 22945	
	OKLAHOMA CITY, OK 73123	

LOLI

NO BLOCK

SECTION 1-3

SEQUENCE	937	LOCATION	5600	HOLDREGE
----------	-----	----------	------	----------

0646393	KLIMENT, EUGENE J & GWENDOLYN	HANSON PLAZA BLK 2 LOT 21
INSPTR	1612 DAVID DR	
OF	LINCOLN, NE 68504	

HAPL

SECTION 1-3

SEQUENCE	938	LOCATION	1241	ND 54 ST
----------	-----	----------	------	----------

1645123	FIRST LINCOLN FEDERAL CREDIT UNION	COTNER HEIGHTS 1ST ADD
INSPTR	P.O. BOX 5872	BLOCK 3 S 60' LOTS 1 S60' E
OF	LINCOLN, NE 68505	12.08' LOT 3 AND IRREGULAR
		TRACTS LOT 2

COTHE1

Block 1

SECTION 1-3

SEQUENCE		LOCATION	5730	'R' STREET
----------	--	----------	------	------------

6

90

89

TAX # NAME AND ADDRESS
 0600628 KAUFMAN, MARK P
 INSPTR 6720 DUDLEY
 DC LINCOLN, NEBR. 68505

ENPL

LEGAL
 ENDORSEMENT PLACE BLOCK 04
 LOT 5
 BETHANY HEIGHTS BLK 08 LOT
 6 (0469742)

SECTION 1-3

SEQUENCE 131

LOCATION 06720

DUDLEY

BT

2

91

C 58

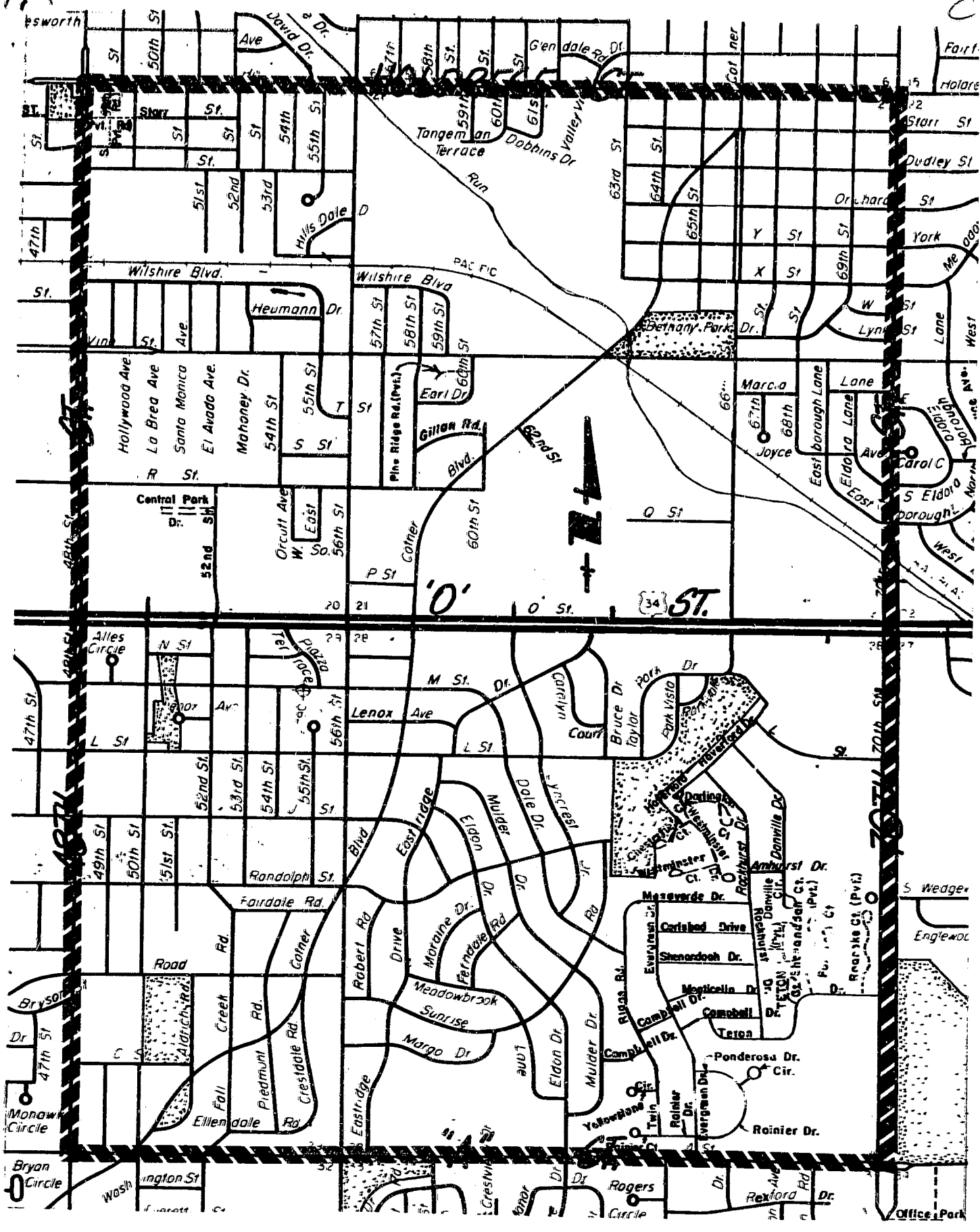

SIDEWALK DISTRICT NO. 85

- BLOCK
- CASE
- CHECKED
- ENTERED
- FILED

BARBARA COUNTY, NEBR
Dan Jato
 REGISTER OF DEEDS

#693⁵⁰

90 AUG 23 PH 4: 18

ENTERED ON
 NUMERICAL INDEX
 FILED FOR RECORD AS

INST. NO. 90- 26076

Dan Jato
 CITY CLERK
 HOLD