

STATE OF NEBRASKA)
COUNTY OF DOUGLAS) SS

On this ___ day of ___, 19___, before me a Notary Public,
in and for said County, personally came the aboved named:

who is (are) personally known to me to be the identical person(s) whose name(s)
is (are) affixed to the above instrument and acknowledged the instrument to be
his, her (their) voluntary act and deed for the purpose therein stated.

WITNESS my hand and Notarial Seal the date aforesaid.

Notary Public

My Commission expires _____

STATE OF NEBRASKA)
COUNTY OF DOUGLAS) SS

On this 27th day of April, 1977, before me, the
undersigned, a Notary Public in and for said County, personally came

THOMAS R. SHULER President of PROM TOWN HOUSE MOTOR INN, INC.
a Nebraska Corporation,

and ___, Secretary of said Corporation, to me
personally known to be the President and Secretary respectively of said Corporation
and the identical persons whose names are affixed to the foregoing instrument, and
acknowledged the execution thereof to be their respective voluntary act and deed as
such officers and the voluntary act and deed of said Corporation, and the Corporate
Seal of said Corporation to be thereto affixed by its authority.

WITNESS my hand and Notarial Seal at Omaha in said County the day and year
last above written.

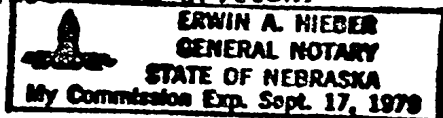

[Signature]
Notary Public

My Commission expires September 17th 1978

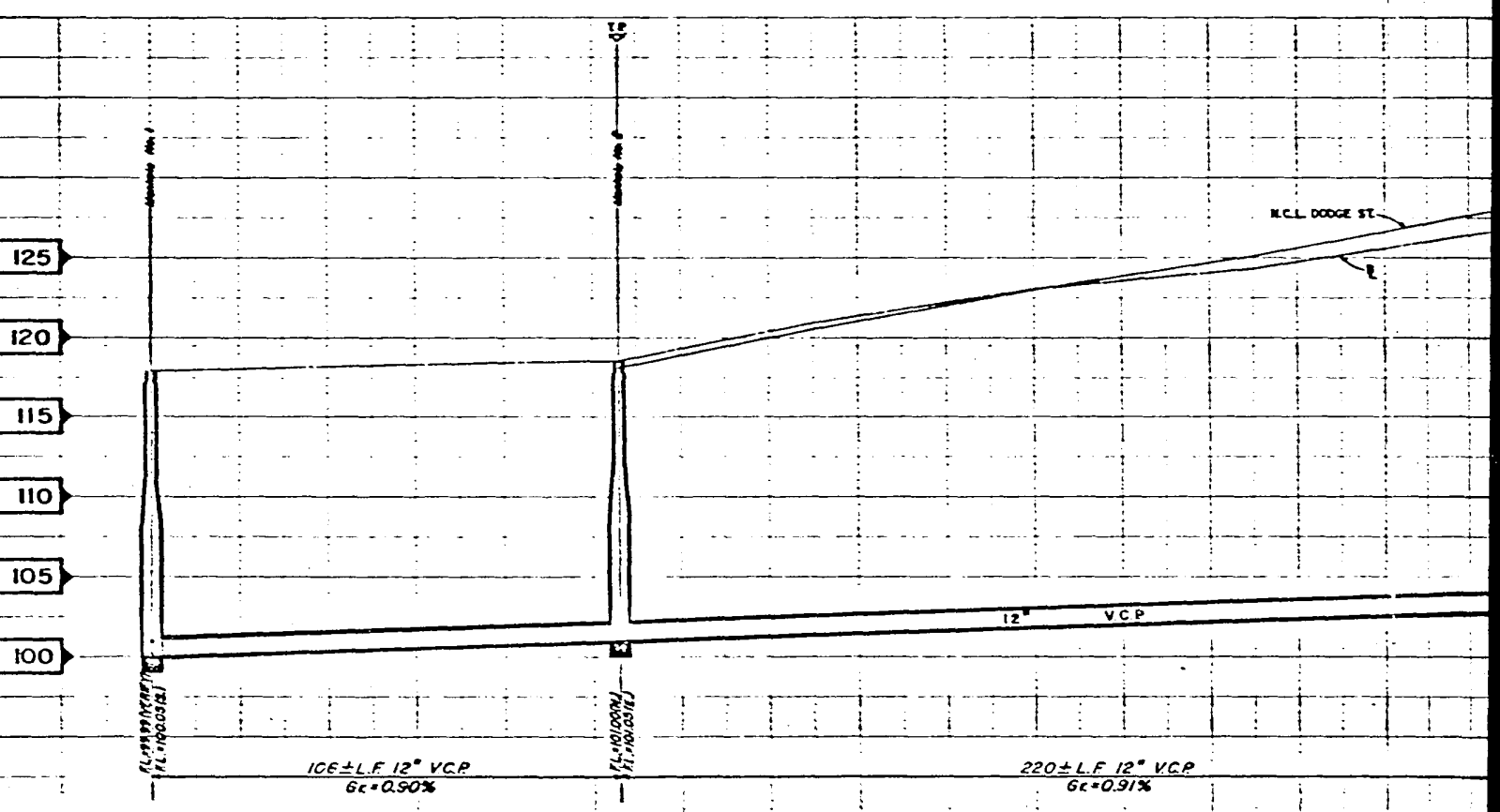
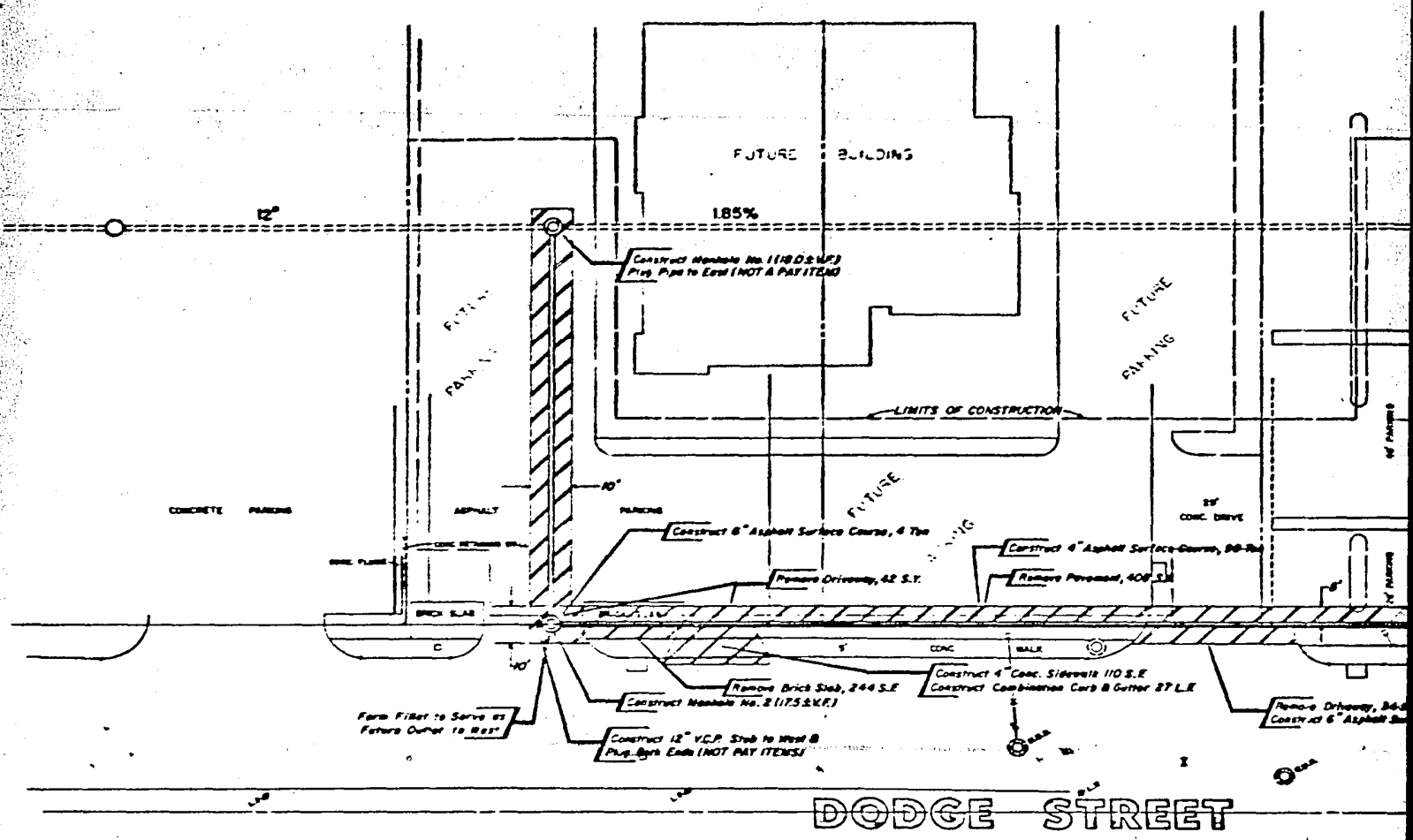

BENCH MARK SEE FOR 3 CONC. MARKS SEE FOR FANNS FOR BEARING 2.25 ELEVATION

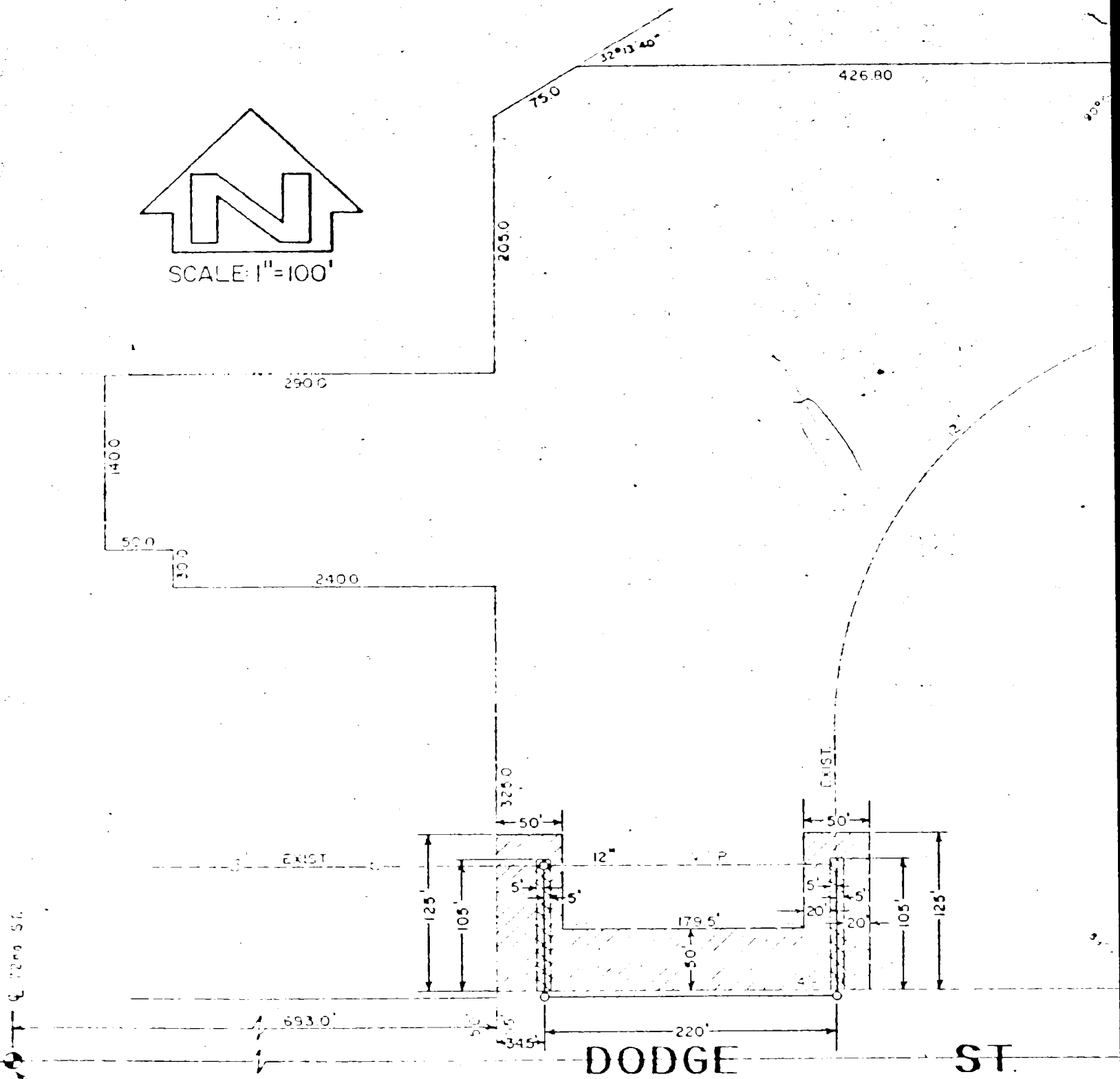
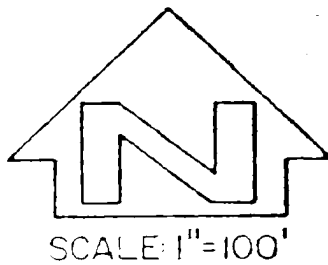

SW Cor. of NW 1/4,
NW 1/4 Sec. 24-15-12

EXHIBIT 'A'

PERMANENT EASEMENT(S)

Two rectangular parcels of land, 5 foot by 105 foot. Both parcels located in that part of the Northwest Quarter (¼) of the Northwest Quarter (¼) of Section 24, Township 15 North, Range 12 East of the 6th P.M. in Douglas County, Nebraska, being more particularly described as follows: Parcel I. Beginning at a point (said point being the point of beginning and located on the North property line of Dodge Street, 722.50 feet East of and 55 feet North of the Southwest corner of the Northwest Quarter (¼) of the Northwest Quarter (¼) of Section 24, Township 15 North, Range 12 East, thence North along a line parallel to the West line of 69th Street for a distance of 105 feet (said 69th Street being shown on the survey plat of Rugbrough Engineering Company, dated June 22, 1952, as a 60 foot Street) thence East along a line parallel to the North property line of Dodge Street for a distance of 10 feet; thence South along a line parallel to the West property line of 69th Street for a distance of 105 feet, thence West along the North property line of Dodge Street for a distance of 10 feet to the point of beginning.

Parcel II. A 5 foot by 105 foot permanent easement located in that part of the Northwest Quarter (¼) of the Northwest Quarter (¼) of Section 24, Township 15 North, Range 12 East of the 6th P.M. in Douglas County, Nebraska, and being more particularly described as follows: Beginning at a point (said point being the point of beginning) and located on the North property line of Dodge Street 942.50 feet East of and 55 feet North of the Southwest corner of the Northwest Quarter (¼) of the Northwest Quarter (¼) of Section 24, Township 15 North, Range 12 East, thence North along a line parallel to the West line of 69th Street for a distance of 105 feet (said 69th Street being shown on the survey plat of Rugbrough Engineering Company, dated June 22, 1952, as a 60 foot Street) thence East along a line parallel to the North property line of Dodge Street for a distance of 10 feet; thence South along a line parallel to the West property line of 69th Street for a distance of 105 feet; thence West along the North property line of Dodge Street for a distance of 10 feet to the point of beginning.

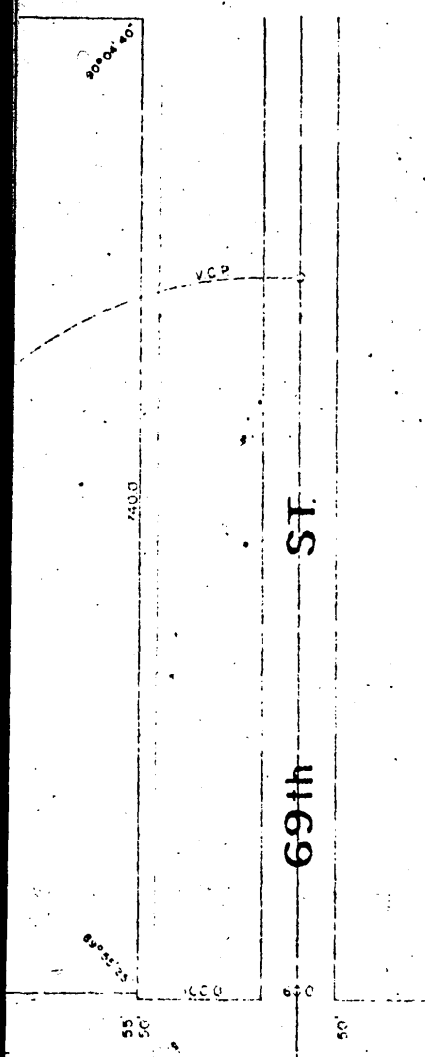

OWNER(S) <u>MR Thomas Shuler Pres</u>	TOTAL LAND AREA _____ SF.
ADDRESS <u>Peam Motor Hotel Inc</u>	LAND ACQUISITION _____ SF.
<u>701 MAIN Street</u>	PERMANENT EASEMENT <u>2,100</u> SF.
<u>KANSAS CITY MISSOURI</u>	TEMPORARY EASEMENT <u>19,325</u> SF.
<u>64105</u>	

PROJECT NO. R.N. 405B TRACT NO. 1 DATE 4/1/77

CITY OF OMAHA
PUBLIC WORKS DEPARTMENT

DRAWN BY _____ CHECKED BY _____ R.O.W. AGENT _____

RECEIVED
APR 27 PM 1:01
REGISTRAR OF DEEDS
DOUGLAS COUNTY, NEBR.
G. MAI & SUTLER

Book 579
Page 702
of 700

Fee 18.25
Index _____
Contact _____
24-5-2
1510

M. G. S.