

2-320
 2-2137
 #553

CRESCENT GLEN

LANCASTER COUNTY NEB.
 A SUBDIVISION OF THE N.W. QUARTER OF
 THE S.E. QUARTER SECTION 7, T. 10. R. 7 E. 6 P.M.

September 13th 1909
 A
J. E. Buford
 Surveyor of District

The foregoing Subdivision of the North West Quarter of South East Quarter of Section 7 Township 10 Range 7 East Entitled Crescent Glen and bounded as follows Commencing at a stake at the South West corner of said tract running North 79 Rods 10 1/2 feet to a stone, thence East 80 Rods to a stake thence South 79 Rods 18 1/2 feet to a stake thence West 80 Rods to the place of beginning as the same appears on the annexed Plat is with the free consent and in accordance with the desire of the undersigned owners and proprietors Signed this 13th day of September 1909 in the presence of

L. C. Humphrey
Witness

The State of Nebraska - S.S.
 Lancaster County

On this 13th Day of September 1909 before me the undersigned, before me the undersigned a Notary Public duly Commissioned and qualified for and residing in said County personally came A. H. Humphrey and Inez A. Humphrey his wife, to me known to be the identical persons who executed the foregoing instrument and they each of them acknowledge the same to be their voluntary act and deed.

Witness my hand and Notarial Seal this day and year last above written
L. C. Humphrey
 Notary Public

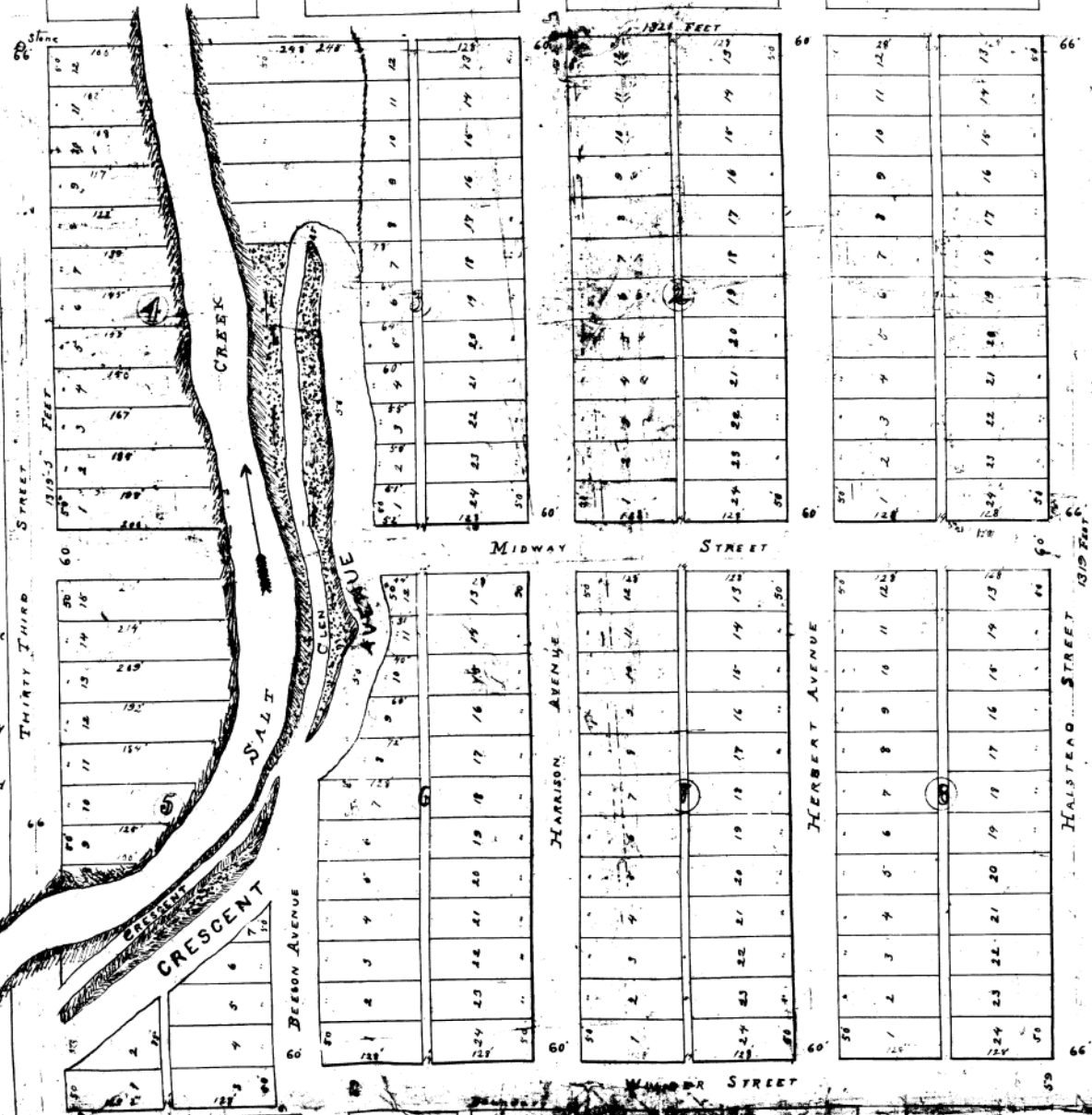

Legend

CRESCENT GLEN comprises the following tract, commencing at the South West corner of the North West Quarter of the South East Quarter of Section 7 Township 10 Range 7 East P.M. Lancaster County Nebraska running thence North 79 Rods 10 1/2 feet, thence East 80 Rods, thence South 80 Rods, thence West 80 Rods to the beginning. Containing 35 1/2 acres of land. The dimensions of all lots are indicated in feet by Red figures on the Plat. Pine Slakes are set in at the corners of streets and at corners of lots on slake.

I hereby certify that I have accurately surveyed and staked off CRESCENT GLEN as shown on the annexed Plat
C. J. Buford
 C.E.S. Surveyor

