



Parcel Information	
Parcel ID	760014728
Links	Photo #1 Sketch #1
Map Number	3689-00-0-10100-244-0001
Cadastral #	004-027-0001
Current Owner	LARIOS, GIOVANNY & MAYRA G
Mailing Address	145 BOSWELL AVENUE CRETE, NE 68333-
Situs Address	145 BOSWELL AVENUE
Tax District	5
Tax ID	004-027-0001
School District	CRETE 2
Neighborhood	1500
Property Class	Single Family
Lot Width x Depth	88 x 122
Legal Description	CRETE CITY LOTS 1-2 BLK. 244

Assessed Values				
Year	Total	Land	Improvements	Outbuildings
2018	\$167,420	\$20,080	\$147,340	\$0

2018 Tax Information	
Taxes	\$3,525.58
Tax Levy	2.192326

2018 Tax Levy	
Description	Rate
AGRICULTURE SOC.	0.010994
CRETE 2	1.053421
CRETE 2 BOND (2013)	0.196197
CRETE CITY	0.491534
CT HOUSE BOND (2015)	0.010555
ED SERV. UNIT #6	0.015669
HISTORICAL SOC.	0.001029
JAIL BOND	0.017892
LOWER B BLUE NRD	0.024231
SALINE COUNTY	0.280104
SE COMM COLLEGE	0.090700

5 Year Sales History				
Date	Book/Page	# Parcels	Grantor	Price
2014/12/01	408-269/270	1	O'BRIEN/MARY R	\$135,000.00



Property Classification			
Status:	Improved	Location:	Urban
Property Class:	Single Family	City Size:	5,001-12,000
Zoning:	Single Family	Lot Size:	10,000-20,000 sq. ft.

Land Information				
Lot Width	Lot Depth	Value Method	# of Units	Lot Value
88	122	Sq ft.	10736	20080

Historical Valuation Information							
Year	Billed Owner	Land	Impr	Outbldg	Total	Taxable	Taxes
2018	LARIOS/GIOVANNY & MAYRA G	\$20,080	\$147,340	\$0	\$167,420	\$167,420	\$3,525.58
2017	LARIOS/GIOVANNY & MAYRA G	\$20,080	\$140,325	\$0	\$160,405	\$160,405	\$3,365.76
2016	LARIOS/GIOVANNY & MAYRA G	\$20,080	\$133,645	\$0	\$153,725	\$153,725	\$3,265.84
2015	LARIOS/GIOVANNY & MAYRA G	\$20,080	\$133,645	\$0	\$153,725	\$153,725	\$3,311.50
2014	O'BRIEN/MARY R	\$20,080	\$133,645	\$0	\$153,725	\$153,725	\$3,417.74

Residential Datasheet			
Type	Single-Family	Heat Type	100 % WARM & COOLED AIR &
Quality / Condition	35 Average+ / 30 Average	Foundation	Concrete Block/8
Arch. Type		Slab Area	0 sq. ft
Year Built	1961	Crawl Area	0 sq. ft
Actual Age	58	Basement Area	1092sq. ft.
Ext. Wall 1	100 % SIDING	Min Finish	
Ext. Wall 2		Rec Finish	
Base Area	1,092 sq. ft	Part Finish	563 sq. ft
Total Area	2,184 sq. ft	Bedrooms	4
Style 1	100% Two-Story	Bathrooms	4
Style 2		Garage Type	ATTACHED
Roof Type	COMP SHINGLES	Garage Area	528 sq. ft

Miscellaneous Improvements		
Improvement	Year	Units
PATIO		60
OPEN PATIO W/STEPS		40
ROOFED PATIO W/STEP		36
WALK-OUT BASEMENT		1
SINGLE 2/S FIRE~PL		1
UNDRGRND LAWN~SPRKLR		6442
CONCRETE DRIVE		780

Photo/Sketch

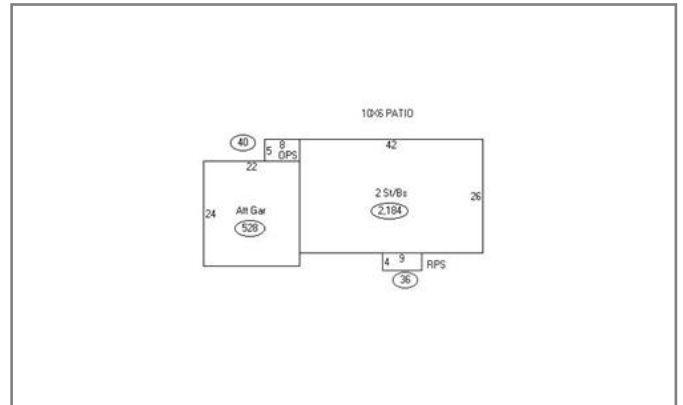

Tax Statement

Served by **WEBSERVER-TWO**

Saline County

0 **Step 4 of 8**

Perm ID 760014728	Name LARIOS/GIOVANNY & MAYRA G 145 BOSWELL AVENUE CRETE, NE 68333-	Legal CRETE CITY LOTS 1-2 BLK. 244 145 \ BOSWELL AVENUE
-----------------------------	--	--

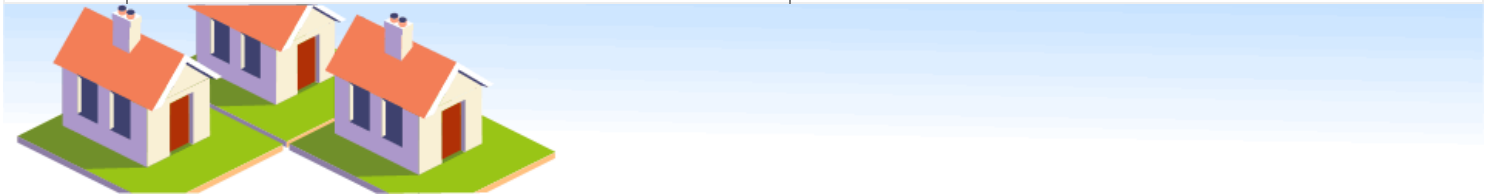

[Levy Graph](#)
[Value Graph](#)
[Tax Graph](#)

Year	Statement	Value	Tax	Exemption	Net Tax	Balance Due
2018	004752	\$ 167,420	\$ 3,670.40	- \$ 144.82	\$ 3,525.58	\$ 3,525.58
2017	004730	\$ 160,405	\$ 3,506.84	- \$ 141.08	\$ 3,365.76	\$ 0.00
2016	004695	\$ 153,725	\$ 3,403.54	- \$ 137.70	\$ 3,265.84	\$ 0.00
2015	004686	\$ 153,725	\$ 3,456.14	- \$ 144.64	\$ 3,311.50	\$ 0.00
2014	005785	\$ 153,725	\$ 3,527.72	- \$ 109.98	\$ 3,417.74	\$ 0.00
2013	005767	\$ 153,725	\$ 3,706.10	- \$ 101.42	\$ 3,604.68	\$ 0.00
2012	005767	\$ 153,895	\$ 3,438.88	- \$ 110.04	\$ 3,328.84	\$ 0.00
2011	005792	\$ 153,895	\$ 3,490.24	- \$ 115.90	\$ 3,374.34	\$ 0.00
2010	005817	\$ 153,895	\$ 3,375.44	- \$ 121.44	\$ 3,254.00	\$ 0.00
2009	005832	\$ 153,895	\$ 3,389.34	- \$ 126.54	\$ 3,262.80	\$ 0.00
2008	005836	\$ 158,035	\$ 3,421.16	- \$ 136.12	\$ 3,285.04	\$ 0.00
2007	005825	\$ 158,035	\$ 3,421.56	- \$ 131.52	\$ 3,290.04	\$ 0.00
2006	005767	\$ 137,600	\$ 2,978.30	\$ 0.00	\$ 2,978.30	\$ 0.00
2005	005687	\$ 130,670	\$ 2,792.34	\$ 0.00	\$ 2,792.34	\$ 0.00
2004	003167	\$ 130,670	\$ 2,788.16	\$ 0.00	\$ 2,788.16	\$ 0.00
2003	001410	\$ 125,170	\$ 2,656.88	\$ 0.00	\$ 2,656.88	\$ 0.00
2002	001204	\$ 110,870	\$ 2,323.80	\$ 0.00	\$ 2,323.80	\$ 0.00
2001	005560	\$ 104,790	\$ 2,235.50	\$ 0.00	\$ 2,235.50	\$ 0.00
2000	005565	\$ 104,790	\$ 2,279.64	- \$ 32.00	\$ 2,247.64	\$ 0.00
1999	005605	\$ 104,790	\$ 2,194.94	\$ 0.00	\$ 2,194.94	\$ 0.00
1998	004030	\$ 104,790	\$ 2,183.08	\$ 0.00	\$ 2,183.08	\$ 0.00
1997	003271	\$ 98,274	\$ 2,376.54	\$ 0.00	\$ 2,376.54	\$ 0.00
1996	008331	\$ 98,274	\$ 2,521.82	\$ 0.00	\$ 2,521.82	\$ 0.00

The information provided in this site is the most recent and most accurate data available. All information contained herein is for informational purposes only. MIPS Inc does not warrant that such information is accurate and error free. This information is provided on an "as is" basis without warranties of any kind, either expressed or implied, including, but not limited to, the implied warranties of merchantability or fitness for a particular purpose. MIPS Inc shall not be liable for any direct, indirect, incidental, special or consequential damages arising out of the use of such information or the inability to use such information. MIPS also is not, nor shall be party to or subject to any warranty or any breach of any kind. The User acknowledges and agrees that the use of such information is at the sole risk of the User.

Copyright © 2004 Nebraska Association of County Officials. All rights reserved.