



Parcel Information	
Parcel ID:	000596200
Map Number	
State Geo Code	3669-00-0-60005-000-5962
Cadastral #	1-59
Images	Photo #1 Photo #2 Photo #3 Photo #4 Photo #5 Photo #6 Photo #7 Sketch #1
Current Owner:	POLACEK, MARVIN E & DEBRA M 402 WALNUT STREET FRIEND, NE 68359
Situs Address:	307 E NORTH
Tax District:	45
School District:	HARVARD 11, 18-0011
Account Type:	Residential
Legal Description:	LOTS 1-2-3, O.T. HARVARD CITY 3 LOTS
Lot Width:	N/A
Lot Depth:	N/A
Lot Size:	N/A

Assessed Values				
Year	Total	Land	Outbuilding	Dwelling
2018	\$134,130	\$3,325	\$2,415	\$128,390
2017	\$134,130	\$3,325	\$2,415	\$128,390

Yearly Tax Information		
Year	Amount	Levy
2018	\$3,396.68	2.618874
2017		2.470932

2018 Tax Levy	
Description	Rate
HARVARD 11	1.02137900
ESU 9 CLAY	0.01500000
COUNTY LEVY	0.23048800
CENTRAL TECH	0.09595600
UPPER BIG BLUE NRD	0.02455300
HARVARD CITY	1.21676100
HARVARD TWP	0.00625700
AG SOCIETY	0.00848000

Agricultural Land Information				
Soil Symbol	Landuse	LVG	Unit Value	Acres
RESD	RESD	RESD	\$0.00	0.000
Total:				0

5 Year Sales History
No previous sales information is available (for the past 5 years).

Property Classification			
Status:	Improved	Location:	Urban
Property Class:	Residential	City Size:	800-2,500
Zoning:	Single Family	Lot Size:	10,000-20,000 sq. ft.

Residential Datasheet			
Zoning:	Single Family	Style:	100% One Story
Year Built:	1980	Bathrooms:	3.00
Exterior:	100% Frame, Siding, Vinyl	Heating/Cooling:	100% Warmed & Cooled Air
Bedrooms:	3	Min Finish:	0 sq. ft
Plumbing Fixtures:	12	Part Finish:	935 sq. ft
Basement Size:	1,416 sq. ft	Garage 1:	Attached Garage (SF)
Building Size:	2,124 sq. ft	Garage 1 Size:	864 sq. ft
Quality:	Fair		

Dwelling Data		
Description	Units	Value
Drive	920	\$1,830
Wood Deck - Wood Rail	165	\$2,700
Wood Deck, Wd Rail, Roof & Ceiling	20	\$1,035
Raised Slab Porch	96	\$1,030
Raised Slab Porch	240	\$2,135
Ceramic Tile	213	\$2,030
Carpet and Pad	1,614	\$3,325
Vinyl Composition Tile	297	\$565

Outbuilding Data			
Description	Units	Year Built	Cost
Tool Shed	192		\$1,780
Approach to # 1	36		\$105
Kennel Run	176		\$530

Photo/Sketch

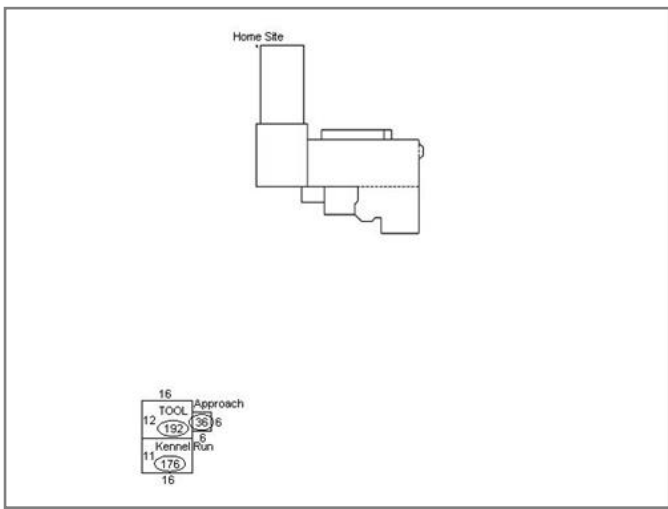
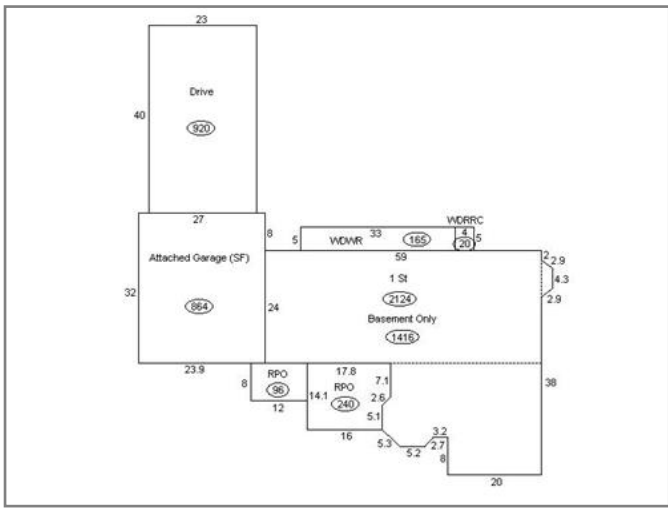

Tax Statement

Served by **WEBSERVER-TWO**

Clay County



Perm ID 000596200	Name POLACEK, MARVIN E & DEBRA M PO BOX 487 HARVARD, NE 68944	Legal LOTS 1-2-3, O.T. HARVARD CITY 3 LOTS 307 E NORTH HARVARD
-----------------------------	---	---

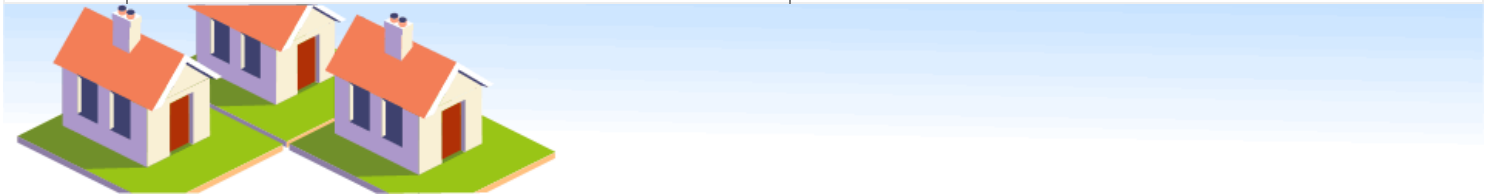

[Levy Graph](#)
[Value Graph](#)
[Tax Graph](#)

Year	Statement	Value	Tax	Exemption	Net Tax	Balance Due
2018	002039	\$ 134,130	\$ 3,512.70	- \$ 116.02	\$ 3,396.68	\$ 3,396.68
2017	002041	\$ 134,130	\$ 3,314.26	- \$ 117.98	\$ 3,196.28	\$ 0.00
2016	002038	\$ 134,130	\$ 3,226.18	- \$ 120.14	\$ 3,106.04	\$ 0.00
2015	002048	\$ 134,130	\$ 3,121.08	- \$ 126.20	\$ 2,994.88	\$ 0.00
2014	002060	\$ 134,130	\$ 3,074.14	- \$ 95.96	\$ 2,978.18	\$ 0.00
2013	002086	\$ 104,275	\$ 2,625.20	- \$ 68.80	\$ 2,556.40	\$ 0.00
2012	002123	\$ 104,275	\$ 2,706.40	- \$ 74.56	\$ 2,631.84	\$ 0.00
2011	002155	\$ 104,275	\$ 2,681.24	- \$ 78.54	\$ 2,602.70	\$ 0.00
2010	005886	\$ 104,275	\$ 2,535.84	- \$ 82.28	\$ 2,453.56	\$ 0.00
2009	005886	\$ 104,275	\$ 2,615.84	- \$ 85.74	\$ 2,530.10	\$ 0.00
2008	005990	\$ 104,265	\$ 2,644.58	- \$ 89.80	\$ 2,554.78	\$ 0.00
2007	005667	\$ 88,720	\$ 2,278.68	- \$ 73.84	\$ 2,204.84	\$ 0.00
2006	002160	\$ 88,720	\$ 2,194.22	\$ 0.00	\$ 2,194.22	\$ 0.00
2005	002171	\$ 88,720	\$ 2,261.56	\$ 0.00	\$ 2,261.56	\$ 0.00
2004	002172	\$ 88,720	\$ 2,322.34	\$ 0.00	\$ 2,322.34	\$ 0.00
2003	002189	\$ 77,230	\$ 2,130.70	\$ 0.00	\$ 2,130.70	\$ 0.00
2002	002193	\$ 77,230	\$ 2,016.86	\$ 0.00	\$ 2,016.86	\$ 0.00
2001	002201	\$ 77,230	\$ 2,014.78	\$ 0.00	\$ 2,014.78	\$ 0.00
2000	002207	\$ 77,230	\$ 2,039.41	- \$ 23.59	\$ 2,015.82	\$ 0.00
1999	002204	\$ 56,295	\$ 1,442.22	\$ 0.00	\$ 1,442.22	\$ 0.00
1998	001703	\$ 52,100	\$ 1,400.20	\$ 0.00	\$ 1,400.20	\$ 0.00
1997	002184	\$ 52,100	\$ 1,544.04	\$ 0.00	\$ 1,544.04	\$ 0.00
1996	001694	\$ 52,100	\$ 1,667.74	\$ 0.00	\$ 1,667.74	\$ 0.00
1995	005962	\$ 47,680	\$ 1,526.00	\$ 0.00	\$ 1,526.00	\$ 0.00

The information provided in this site is the most recent and most accurate data available. All information contained herein is for informational purposes only. MIPS Inc does not warrant that such information is accurate and error free. This information is provided on an "as is" basis without warranties of any kind, either expressed or implied, including, but not limited to, the implied warranties of merchantability or fitness for a particular purpose. MIPS Inc shall not be liable for any direct, indirect, incidental, special or consequential damages arising out of the use of such information or the inability to use such information. MIPS also is not, nor shall be party to or subject to any warranty or any breach of any kind. The User acknowledges and agrees that the use of such information is at the sole risk of the User.

Copyright © 2004 Nebraska Association of County Officials. All rights reserved.



Parcel Information	
Parcel ID:	000596300
Map Number	
State Geo Code	3669-00-0-60005-000-5963
Cadastral #	1-59
Images	
Current Owner:	POLACEK, MARVIN E & DEBRA M 402 WALNUT STREET FRIEND, NE 68359
Situs Address:	505 HARLAN
Tax District:	45
School District:	HARVARD 11, 18-0011
Account Type:	Residential
Legal Description:	LOT 4 O.T. HARVARD CITY 1 LOT -
Lot Width:	N/A
Lot Depth:	N/A
Lot Size:	N/A

Assessed Values				
Year	Total	Land	Outbuilding	Dwelling
2018	\$1,540	\$1,540	\$0	\$0
2017	\$1,540	\$1,540	\$0	\$0

Yearly Tax Information		
Year	Amount	Levy
2018	\$39.00	2.618874
2017		2.470932

2018 Tax Levy	
Description	Rate
HARVARD 11	1.02137900
ESU 9 CLAY	0.01500000
COUNTY LEVY	0.23048800
CENTRAL TECH	0.09595600
UPPER BIG BLUE NRD	0.02455300
HARVARD CITY	1.21676100
HARVARD TWP	0.00625700
AG SOCIETY	0.00848000

Agricultural Land Information				
Soil Symbol	Landuse	LVG	Unit Value	Acres
RESD	RESD	RESD	\$0.00	0.000
Total:				0

5 Year Sales History



No previous sales information is available (for the past 5 years).

Property Classification			
Status:	Unimproved	Location:	Urban
Property Class:	Residential	City Size:	800-2,500
Zoning:	Single Family	Lot Size:	<10,000 sq. ft.

Tax Statement

Served by **WEBSERVER-TWO**

Clay County

0 **Step 4 of 8**

Perm ID 000596300	Name POLACEK, MARVIN E & DEBRA M PO BOX 487 HARVARD, NE 68944-0487	Legal LOT 4 O.T. HARVARD CITY 1 LOT - 505 HARLAN
-----------------------------	--	---



- [Levy Graph](#)
- [Value Graph](#)
- [Tax Graph](#)

Year	Statement	Value	Tax	Exemption	Net Tax	Balance Due
2018	002040	\$ 1,540	\$ 40.34	- \$ 1.34	\$ 39.00	\$ 39.00
2017	002042	\$ 1,540	\$ 38.06	- \$ 1.36	\$ 36.70	\$ 0.00
2016	002039	\$ 1,540	\$ 37.04	- \$ 1.38	\$ 35.66	\$ 0.00
2015	002049	\$ 1,540	\$ 35.84	- \$ 1.46	\$ 34.38	\$ 0.00
2014	002061	\$ 1,540	\$ 35.30	- \$ 1.10	\$ 34.20	\$ 0.00
2013	002087	\$ 1,540	\$ 38.78	- \$ 1.02	\$ 37.76	\$ 0.00
2012	002124	\$ 1,540	\$ 39.98	- \$ 1.10	\$ 38.88	\$ 0.00
2011	002156	\$ 1,540	\$ 39.60	- \$ 1.16	\$ 38.44	\$ 0.00
2010	005887	\$ 1,540	\$ 37.46	- \$ 1.22	\$ 36.24	\$ 0.00
2009	005887	\$ 1,540	\$ 38.64	- \$ 1.28	\$ 37.36	\$ 0.00
2008	005991	\$ 1,550	\$ 39.32	- \$ 1.34	\$ 37.98	\$ 0.00
2007	005668	\$ 1,550	\$ 39.82	- \$ 1.30	\$ 38.52	\$ 0.00
2006	002161	\$ 1,550	\$ 38.34	\$ 0.00	\$ 38.34	\$ 0.00
2005	002172	\$ 1,550	\$ 39.52	\$ 0.00	\$ 39.52	\$ 0.00
2004	002173	\$ 1,550	\$ 40.58	\$ 0.00	\$ 40.58	\$ 0.00
2003	002190	\$ 1,595	\$ 44.00	\$ 0.00	\$ 44.00	\$ 0.00
2002	002194	\$ 1,595	\$ 41.66	\$ 0.00	\$ 41.66	\$ 0.00
2001	002202	\$ 1,595	\$ 41.62	\$ 0.00	\$ 41.62	\$ 0.00
2000	002208	\$ 1,595	\$ 42.13	- \$ 0.49	\$ 41.64	\$ 0.00
1999	002205	\$ 1,595	\$ 40.86	\$ 0.00	\$ 40.86	\$ 0.00
1998	001704	\$ 6,115	\$ 164.34	\$ 0.00	\$ 164.34	\$ 0.00
1997	001707	\$ 6,115	\$ 181.22	\$ 0.00	\$ 181.22	\$ 0.00
1996	001695	\$ 6,115	\$ 195.74	\$ 0.00	\$ 195.74	\$ 0.00
1995	005963	\$ 5,690	\$ 182.11	\$ 0.00	\$ 182.11	\$ 0.00

The information provided in this site is the most recent and most accurate data available. All information contained herein is for informational purposes only. MIPS Inc does not warrant that such information is accurate and error free. This information is provided on an "as is" basis without warranties of any kind, either expressed or implied, including, but not limited to, the implied warranties of merchantability or fitness for a particular purpose. MIPS Inc shall not be liable for any direct, indirect, incidental, special or consequential damages arising out of the use of such information or the inability to use such information. MIPS also is not, nor shall be party to or subject to any warranty or any breach of any kind. The User acknowledges and agrees that the use of such information is at the sole risk of the User.

Copyright © 2004 Nebraska Association of County Officials. All rights reserved.