

Thomas Dahl et al)
)
To)
)
The State of Nebraska)
Department of Roads)
)
Filed February 25, 1964 3:52 P.M.)
)
George H. King, County Clerk) Fee:\$5.50

BEFORE THE COUNTY JUDGE OF SEWARD COUNTY, NEBRASKA

THE STATE OF NEBRASKA)
DEPARTMENT OF ROADS)

Docket 5

Page 37

Condemner

#7182

vs.

RETURN OF APPRAISERS

NORMAN J. EGGERLING and RUTH MARIE
EGGERLING, husband and wife, Joint
Tenants;

IRENE WAHLGEMUTH, Owner; LeROY WAHLGEMUTH,
husband of IRENE WAHLGEMUTH;

FILED
FEB 18, 1964
P. H. Wiegardt
County Judge

MINNIE-LOHMEIER;-a-widow;-EARL-LOHMEIER;
JOHN-LOHMEIER;-LAWRENCE-LOHMENER;-LAURA--
HARRIS;-Heirs-of-the-Estate-of-Angust-H:-
Lohmeier;-EARL-LOHMEIER;-Administrator---
of-the-Estate-of-Angust-H:-Lohmeier;--
ADELINE-LOHMEIER;-wife-of-EARL-LOHMEIER;-
LEONE-LOHMEIER;-wife-of-JOHN-LOHMEIER;--
ANN-LOHMEIER;-wife-of-LAWRENCE-LOHMEIER;--
JOHN-HARRIS-husband-of-LAURA-HARRIS;---

WILLIAM F. BRANDHORST, a widower, Holder
of Life Estate; DON B. BRANDHORST,
DOROTHY M. BRANDHORST BREDOW, W. E.
BRANDHORST, first and real name unknown,
and BERT L. BRANDHORST, Remaindermen;
LILLIAN BRANDHORST, wife of DON B. BRAND-
HORST; RUDOLPH BREDOW, husband of DOROTHY
M. BRANDHORST BREDOW; NEVA BRANDHORST,
wife of W. E. BRANDHORST; AGNES BRAND-
HORST, wife of BERT L. BRANDHORST;

Condemnees

TO HONORABLE P. H. WIEGARDT, COUNTY JUDGE, SEWARD COUNTY, NEBR.

We, the undersigned appraisers, do hereby certify that under and by virtue of an "Appointment of Appraisers" duly served upon us by Marvin C. Pollock, Sheriff ~~xxxDeputy Sheriff~~ of Seward County, Nebraska, on the 24 day of January, 1964, and after having taken and filed the "Oath of Appraisers" that we did carefully inspect and view the property described herein, sought to be appropriated by the State of Nebraska, Department of Roads, and also other property of the condemnees alleged damaged thereby and did hear all parties interested therein in reference to the amount of damages sustained while we were so inspecting and viewing the property herein described and thereafter did assess the damages that the condemnees have sustained or will sustain by such appropriation of the property herein described for State highway purposes and also damage to such other property of the condemnees as in our opinion was damaged by the appropriation of the property herein described:

C O N D E M N A T I O N

Land Owners: Norman J. Eggerling and Ruth Marie Eggerling, husband and wife, Joint Tenants

Project: I-80-8 (13)

AFE: R-171b

Seward County, Nebraska

Permanent easement to a tract of land for the control of outdoor advertising as illustrated on the attached plat and being more partiucularly described as all that part of the Northwest Quarter of Section 20, Township 10 North, Range 4 East of the 6th P.M., Seward County, Nebraska, lying within 660 feet of the Interstate Highway Right of Way Controlled Access line as measured at right angles to the centerline of said Interstate Highway, and being in accordance with the provisions of Section 84-907, R.R.S. 1943; approved and filed on June 15, 1961.

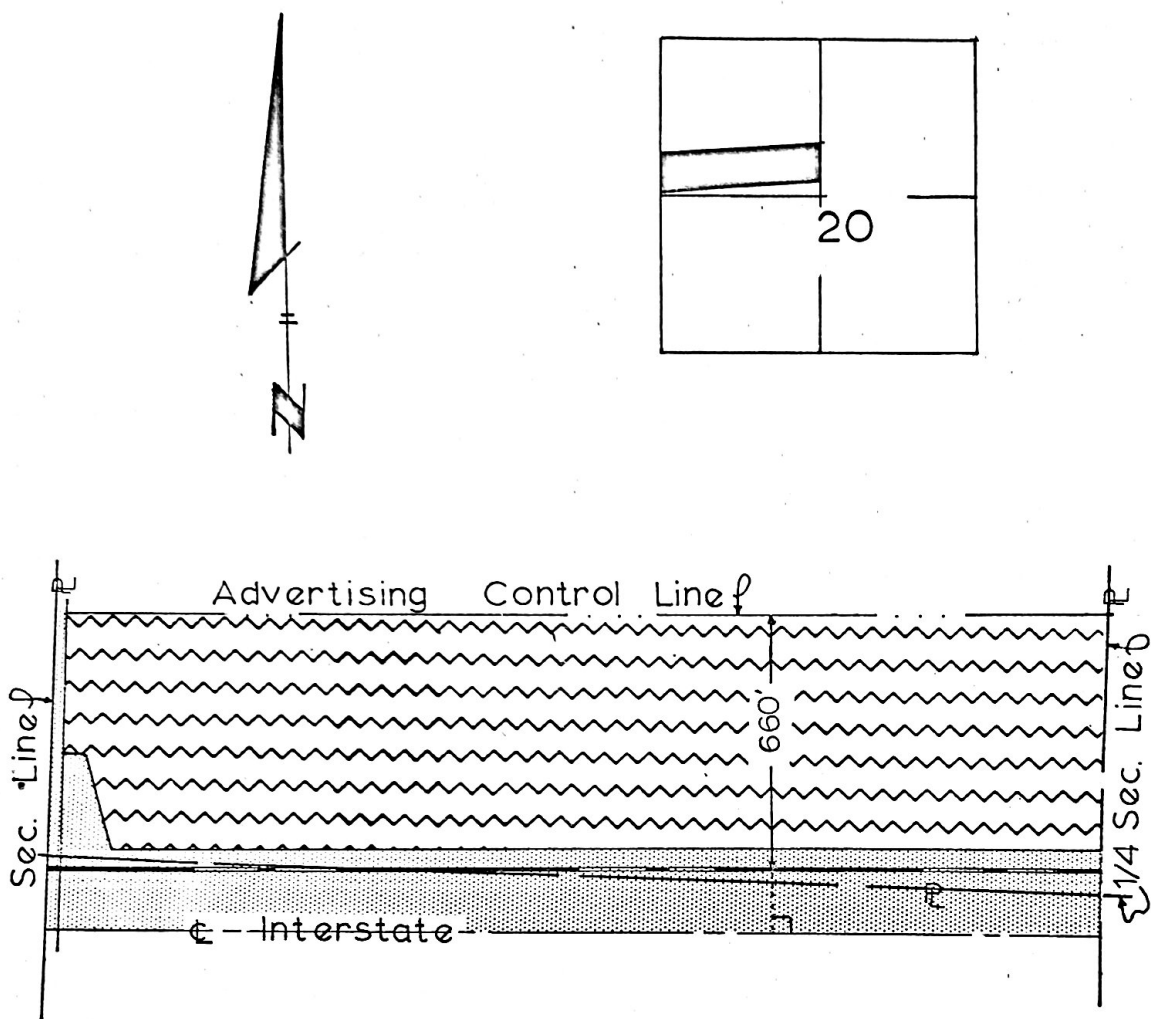

Scale: 1" = 400'

ADVERTISING EASEMENT

to be acquired for Interstate Highway purposes
Project: I-80-8 (13) Seward County AFER-171 b

Tract: 46

Holder of Record: Norman J. & Ruth Marie Eggerling

Location: NW⁴ Sec. 20 - T10N - R4E

drawn: O&B.
checked: A&F.
written: C&S.
checked: W&R.

| | | |
|-------------------|--|----------------------|
| Total ROW = | | Channel Ease. = |
| Old ROW = | | Advertising Easement |
| New ROW = | | |
| Controlled Access | | |

STATE OF NEBRASKA

DEPARTMENT OF ROADS

CONDEMNATION

Land Owners: Irene Wahlgemuth and LeRoy Wahlgemuth, wife and husband

Project: I-80-8 (13)

AFE: R-171b

Seward County, Nebraska

Permanent easement to a tract of land for the control of outdoor advertising as illustrated on the attached plat and being more particularly described as all that part of the Southeast Quarter of Section 19, Township 10 North, Range 4 East of the 6th P.M., Seward County, Nebraska, lying within 660 feet of the Interstate Highway Right of Way Controlled Access line as measured at right angles to the centerline of said Interstate Highway and being in accordance with the provisions of Section 84-907, R.R.S. 1943; approved and filed on June 15, 1961.

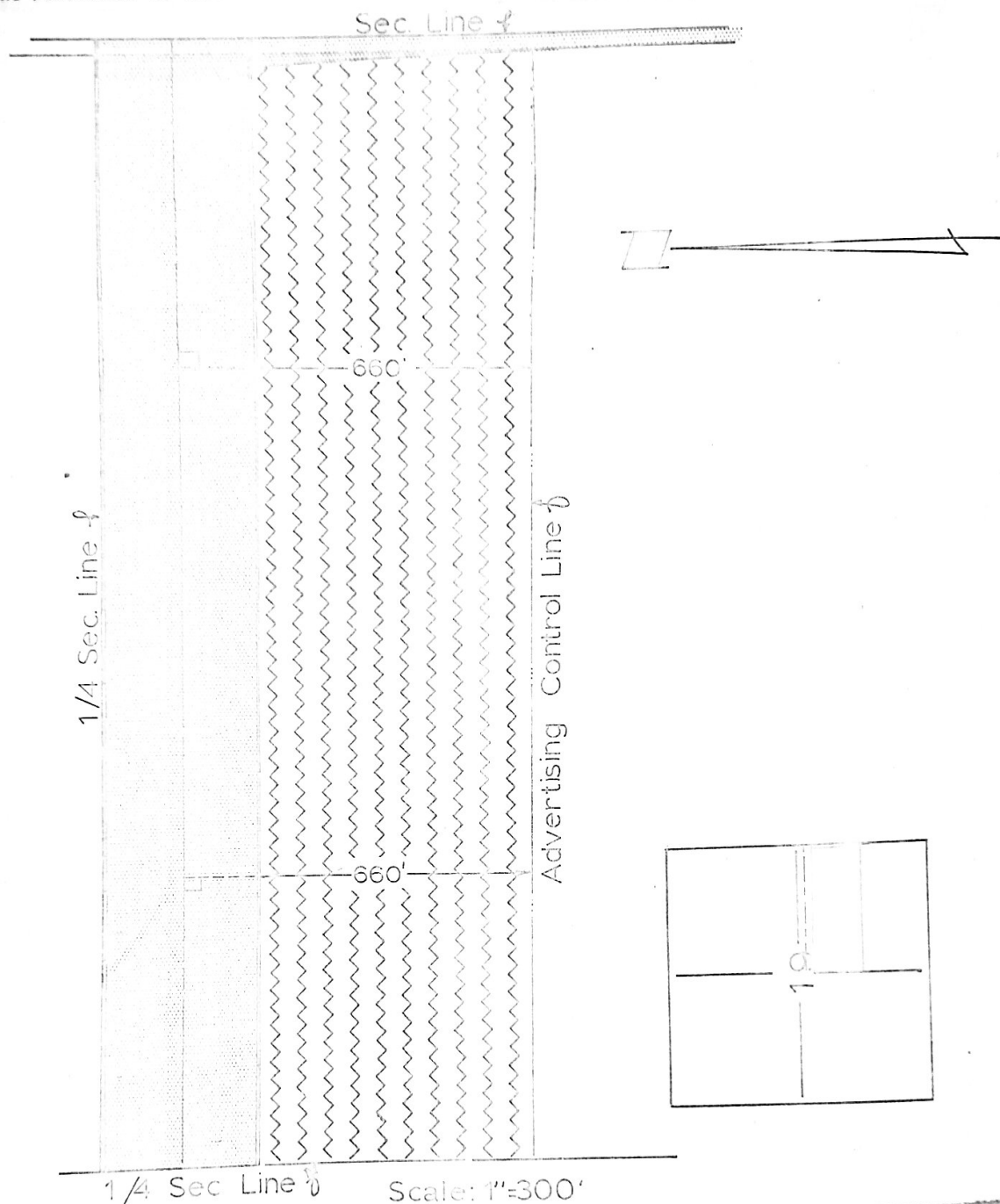

Advertising Control
to be acquired for Interstate Highway purposes
Project: I-80-8(13) Seward County AFE: R-171b
Tract: 48
Holder of Record: Irene Wahlgemuth
Location: SE⁴ Sec. 19-T10N-R4E

drawn: C.P.B.
checked: A.L.F.
written: C.E.S.
checked: W.D.E.

Total ROW =
Old ROW =
New ROW =
Controlled Access

Channel Easement =
Advertising Easement

STATE OF NEBRASKA

DEPARTMENT OF ROADS

C O N D E M N A T I O N

Land Owners: William F. Brandhorst, a widower, Life Estate; Don B. Brandhorst, Dorothy M. Brandhorst Bredow, W. E. Brandhorst, and Bert L. Brandhorst, Remaindermen; Lillian Brandhorst, wife of Don B. Brandhorst; Rudolph Bredow, husband of Dorothy M. Brandhorst Bredow; Neva Brandhorst, wife of W. E. Brandhorst; and Agnes Brandhorst, wife of Bert L. Brandhorst.

Project: 1-80-8 (13)

AFE: R-171b

Seward County, Nebraska

Permanent easement to a tract of land for the control of outdoor advertising as illustrated on the attached plat and being more particularly described as all that part of the Northwest Quarter of Section 24, Township 10 North, Range 3 East of the 6th P.M., Seward County, Nebraska, lying within 660 feet of the Interstate Highway Right of Way Controlled Access line as measured at right angles to the centerline of said Interstate Highway, and being in accordance with the provisions of Section 84-907, R.R.S. 1943; approved and filed on June 15, 1961.

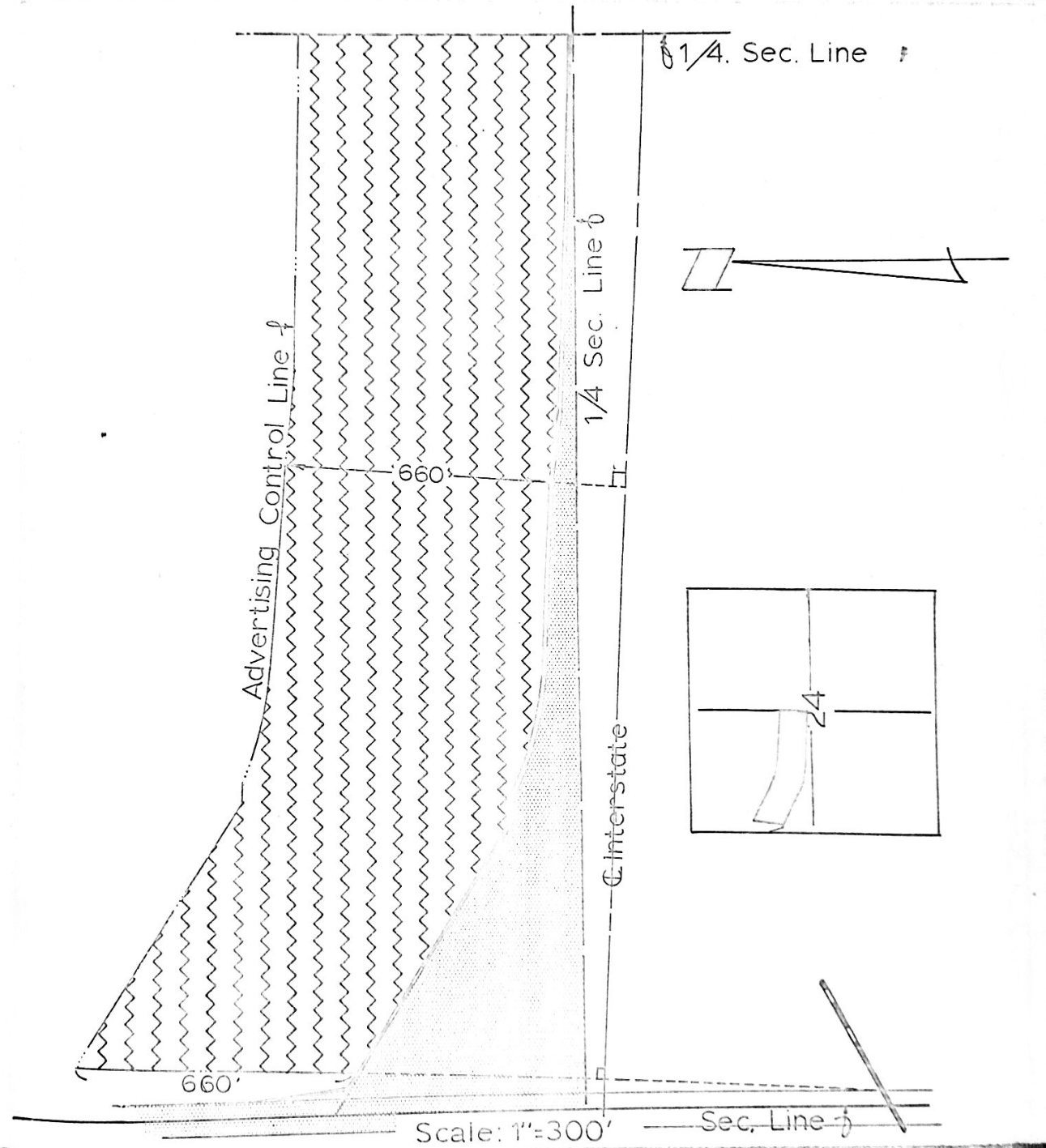

Advertising Control
to be acquired for Interstate Highway purposes
Project: 1-80-8(13) Seward County AFER-171b
Tract: 56
Holder of Record: William F Brandhorst
Location: NW⁴ Sec 24-T10N-R3E

drawn: CPB
checked: ALA
written: CES
checked: W.D.E.

Total ROW =
Old ROW =
New ROW =
Controlled Access
Channel Ease.=
Advertising Easement

STATE OF NEBRASKA

DEPARTMENT OF ROADS

Now, therefore, we, as appraisers aforesaid, do hereby find and appraise the damages that will be suffered by reason of the appropriation of title to the said property or any interest therein described for State highway purposes by the State of Nebraska, Department of Roads in the amount of:

- To: Norman J. Eggerling and Ruth Marie Eggerling, husband and wife,
Joint Tenants

\$ 25.00
- To: Irene Wahlgemuth, Owner; LeRoy Wahlgemuth, husband of Irene
Wahlgemuth

\$ 25.00
- To: ~~Minnie-bohmeier; a widow; Earl-bohmeier; John-bohmeier; Lawrence--
bohmeier; Laura-Harris; Heirs-of-the-Estate-of-August-H--bohmeier;
Earl-bohmeier; Administrator-of-the-Estate-of-August-H--bohmeier;
Adeline-bohmeier; wife-of-Earl-bohmeier; Beone-bohmeier; wife-of--
John-bohmeier; Ann-bohmeier; wife-of-Lawrence-bohmeier; John-Harris,
husband-of-Laura-Harris~~

\$ -----

To: William F. Brandhorst, a widower, Holder of Life Estate; Don B.
Brandhorst, Dorothy M. Brandhorst Bredow, W. E. Brandhorst, first
and real name unknown, and Bert L. Brandhorst, Remainermen;
Lillian Brandhorst, wife of Don B. Brandhorst; Rudolph Bredow,
husband of Dorothy M. Brandhorst Bredow; Neva Brandhorst, wife
of W. E. Brandhorst; Agnes Brandhorst, wife of Bert L. Brand-
horst

\$ 25.00
- All of which is hereby respectfully submitted.
Dated this 18th day of February, A. D., 1964.
- Thomas Dahl
G. E. Nicolaus
Homer Eberspacher
Appraisers
- Subscribed and sworn to before me this 18 day of Febr., A. D., 1964.
(SEAL)
- P. H. Wiegardt
County Judge
- STATE OF NEBRASKA)
) ss.
SEWARD COUNTY)
- I, P. H. Wiegardt, County Judge in and for Seward County, State of Nebraska, do hereby certify that the foregoing is a true and correct copy of the original instrument duly filed and recorded in this Court.
- Witness my hand and official seal at Seward, Nebraska, this 18 day of February, 1964
- P. H. Wiegardt
County Judge
- :Seal of County Court :
:Seward County :
:Nebraska :
- By Donna Bean
Clerk of County - Court