



Parcel Information	
<b>Parcel ID</b>	010635030
<b>Links</b>	<a href="#">Photo #1</a> <a href="#">Photo #2</a> <a href="#">Photo #3</a> <a href="#">Photo #4</a> <a href="#">Photo #5</a> <a href="#">Photo #6</a> <a href="#">Sketch #1</a>
<b>Map Number</b>	4163-00-0-10102-000-0000
<b>Cadastral #</b>	001-111-001
<b>Current Owner</b>	RGH PROPERTIES LLC
<b>Mailing Address</b>	4115 N 6TH ST BEATRICE NE 68310-
<b>Situs Address</b>	04115 N 6TH
<b>Tax District</b>	157
<b>School District</b>	SCH 15 BEATRICE
<b>Neighborhood</b>	1000
<b>Property Class</b>	Commercial
<b>Lot Width x Depth</b>	300 x 580
<b>Legal Description</b>	LOT 1 BURNHAM ADD

Assessed Values				
Year	Total	Land	Improvements	Outbuildings
2018	\$2,028,800	\$365,400	\$1,663,400	\$0

2018 Tax Information	
<b>Taxes</b>	\$40,183.34
<b>Tax Levy</b>	2.067146

2018 Tax Levy	
Description	Rate
AGRICULTURE	0.004171
AIRPORT GENERAL	0.033529
BEATRICE CITY	0.399171
BIG BLUE NRD	0.024231
COUNTY GENERAL	0.419871
ESU #5	0.015000
HISTORICAL	0.000958
SCC GENERAL	0.090700
SCH 15 BEATRICE	1.079515

5 Year Sales History				
Date	Book/Page	# Parcels	Grantor	Price
2017/05/01	2017-1295	2	BEATRICE FORD LINCOLN~MERCURY INC	\$4,500,000.00

Property Classification			
<b>Status:</b>	Improved	<b>Location:</b>	Urban
<b>Property Class:</b>	Commercial	<b>City Size:</b>	12,001-100,000
<b>Zoning:</b>	COMMERCIAL	<b>Lot Size:</b>	2.00-4.99 ac.



Historical Valuation Information							
Year	Billed Owner	Land	Impr	Outbldg	Total	Taxable	Taxes
2018	RGH PROPERTIES LLC	\$365,400	\$1,663,400	\$0	\$2,028,800	\$2,028,800	\$40,183.34
2017	RGH PROPERTIES LLC	\$365,400	\$1,663,400	\$0	\$2,028,800	\$2,028,800	\$37,518.76
2016	BEATRICE FORD LINCOLN MERCURY INC	\$365,400	\$1,663,400	\$0	\$2,028,800	\$2,028,800	\$37,003.64
2015	BEATRICE FORD LINCOLN MERCURY, INC	\$365,400	\$1,247,110	\$0	\$1,612,510	\$1,612,510	\$30,391.74
2014	BEATRICE FORD LINCOLN MERCURY, INC	\$365,400	\$608,780	\$0	\$974,180	\$974,180	\$18,971.06
2013	BEATRICE FORD LINCOLN MERCURY, INC	\$365,400	\$608,780	\$0	\$974,180	\$974,180	\$19,252.38

Commercial Building Datasheet										
Bldg.	Sec.	Code	Description	Year	Cls.	Qual.	Area	Perm.	Stor.	Hght.
1	1	303	AUTOMOTIVE SHOWROOM	1994	S	200	3936	260	1	16
1	5	406	WAREHOUSE, STORAGE	2015	D	200	88	38	1	7
1	2	455	AUTO DEALERSHIP,~COMPLET	1994	S	200	10906	380	1	16
1	3	528	SERVICE REPAIR~GARAGE	2014	S	200	6952		1	15
1	4	528	SERVICE REPAIR~GARAGE	2014	C	200	3540		1	18

Refinements		
Description	Year	Units
CONCRETE PAVING		56450
CANOPY		4926
LIGHTING PARKING LOT		9
PAVING, CONCRETE	2014	27603

Photo/Sketch

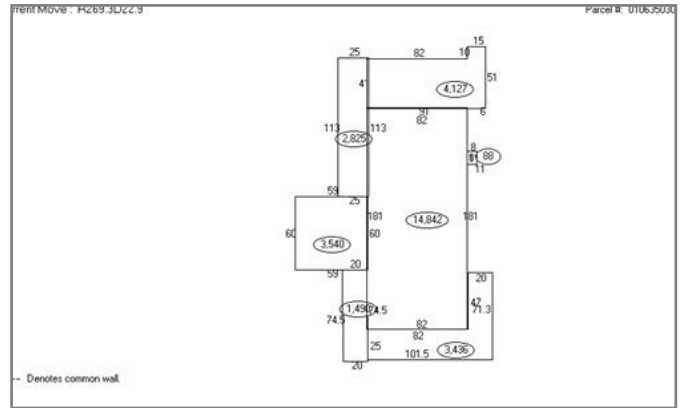

**Tax Statement**

Served by **WEBSERVER-ONE**

**Gage County**

**0** **Step 4 of 8**

<b>Perm ID</b> 010635030	<b>Name</b> RGH PROPERTIES LLC 4115 N 6TH ST BEATRICE NE 68310-	<b>Legal</b> LOT 1 BURNHAM ADD 04115 \N 6TH
-----------------------------	--	---



[Levy Graph](#)
[Value Graph](#)
[Tax Graph](#)

Year	Statement	Value	Tax	Exemption	Net Tax	Balance Due
2018	<a href="#">011318</a>	\$ 2,028,800	\$ 41,938.26	- \$ 1,754.92	\$ 40,183.34	\$ 40,183.34
2017	<a href="#">011295</a>	\$ 2,028,800	\$ 39,303.08	- \$ 1,784.32	\$ 37,518.76	\$ 0.00
2016	<a href="#">011267</a>	\$ 2,028,800	\$ 38,820.84	- \$ 1,817.20	\$ 37,003.64	\$ 0.00
2015	<a href="#">011241</a>	\$ 1,612,510	\$ 31,908.96	- \$ 1,517.22	\$ 30,391.74	\$ 0.00
2014	<a href="#">011233</a>	\$ 974,180	\$ 19,667.98	- \$ 696.92	\$ 18,971.06	\$ 0.00
2013	<a href="#">011191</a>	\$ 974,180	\$ 19,895.04	- \$ 642.66	\$ 19,252.38	\$ 0.00
2012	<a href="#">011198</a>	\$ 974,180	\$ 20,188.06	- \$ 696.54	\$ 19,491.52	\$ 0.00
2011	<a href="#">002017</a>	\$ 974,180	\$ 20,181.36	- \$ 733.66	\$ 19,447.70	\$ 0.00
2010	<a href="#">011171</a>	\$ 974,180	\$ 20,158.44	- \$ 768.72	\$ 19,389.72	\$ 0.00
2009	<a href="#">011150</a>	\$ 1,020,000	\$ 20,895.54	- \$ 838.64	\$ 20,056.90	\$ 0.00
2008	<a href="#">000910</a>	\$ 1,020,000	\$ 20,902.80	- \$ 878.52	\$ 20,024.28	\$ 0.00
2007	<a href="#">011117</a>	\$ 1,020,000	\$ 21,046.60	- \$ 848.84	\$ 20,197.76	\$ 0.00
2006	<a href="#">011021</a>	\$ 1,020,000	\$ 19,947.70	\$ 0.00	\$ 19,947.70	\$ 0.00
2005	<a href="#">010026</a>	\$ 1,020,000	\$ 20,336.92	\$ 0.00	\$ 20,336.92	\$ 0.00
2004	<a href="#">010912</a>	\$ 1,020,000	\$ 20,412.48	\$ 0.00	\$ 20,412.48	\$ 0.00
2003	<a href="#">010340</a>	\$ 521,785	\$ 10,509.02	\$ 0.00	\$ 10,509.02	\$ 0.00
2002	<a href="#">010856</a>	\$ 453,725	\$ 9,067.28	\$ 0.00	\$ 9,067.28	\$ 0.00
1998	<a href="#">011374</a>	\$ 421,000	\$ 8,912.12	\$ 0.00	\$ 8,912.12	\$ 0.00

The information provided in this site is the most recent and most accurate data available. All information contained herein is for informational purposes only. MIPS Inc does not warrant that such information is accurate and error free. This information is provided on an "as is" basis without warranties of any kind, either expressed or implied, including, but not limited to, the implied warranties of merchantability or fitness for a particular purpose. MIPS Inc shall not be liable for any direct, indirect, incidental, special or consequential damages arising out of the use of such information or the inability to use such information. MIPS also is not, nor shall be party to or subject to any warranty or any breach of any kind. The User acknowledges and agrees that the use of such information is at the sole risk of the User.

Copyright © 2004 Nebraska Association of County Officials. All rights reserved.



Parcel Information	
<b>Parcel ID</b>	013661501
<b>Links</b>	
<b>Map Number</b>	4163-00-0-10547-000-0000
<b>Cadastral #</b>	001-113-004
<b>Current Owner</b>	RGH PROPERTIES LLC
<b>Mailing Address</b>	4115 N 6TH ST BEATRICE NE 68310-
<b>Situs Address</b>	
<b>Tax District</b>	157
<b>School District</b>	SCH 15 BEATRICE
<b>Neighborhood</b>	1000
<b>Property Class</b>	Commercial
<b>Lot Width x Depth</b>	0 x 0
<b>Legal Description</b>	W 425.9' OF N 300' OF LOT 1 NORTH COMMERCE ADDITION

Assessed Values				
Year	Total	Land	Improvements	Outbuildings
2018	\$3,535	\$3,535	\$0	\$0

2018 Tax Information	
<b>Taxes</b>	\$70.02
<b>Tax Levy</b>	2.067146

2018 Tax Levy	
Description	Rate
AGRICULTURE	0.004171
AIRPORT GENERAL	0.033529
BEATRICE CITY	0.399171
BIG BLUE NRD	0.024231
COUNTY GENERAL	0.419871
ESU #5	0.015000
HISTORICAL	0.000958
SCC GENERAL	0.090700
SCH 15 BEATRICE	1.079515

5 Year Sales History				
Date	Book/Page	# Parcels	Grantor	Price
2017/05/01	2017-1295	-	BEATRICE FORD LINCOLN~MERCURY INC	\$4,500,000.00

Property Classification			
<b>Status:</b>	Unimproved	<b>Location:</b>	Urban
<b>Property Class:</b>	Commercial	<b>City Size:</b>	12,001-100,000
<b>Zoning:</b>	COMMERCIAL	<b>Lot Size:</b>	2.00-4.99 ac.



Land Information				
Lot Width	Lot Depth	Value Method	# of Units	Lot Value
0	0	Acre(s)	4.87	0

Historical Valuation Information							
Year	Billed Owner	Land	Impr	Outbldg	Total	Taxable	Taxes
2018	RGH PROPERTIES LLC	\$3,535	\$0	\$0	\$3,535	\$3,535	\$70.02
2017	RGH PROPERTIES LLC	\$3,535	\$0	\$0	\$3,535	\$3,535	\$65.38
2016	BEATRICE FORD LINCOLN MERCURY INC	\$3,535	\$0	\$0	\$3,535	\$3,535	\$64.48
2015	BEATRICE FORD LINCOLN MERCURY, INC	\$3,535	\$0	\$0	\$3,535	\$3,535	\$66.64
2014	BEATRICE FORD LINCOLN MERCURY, INC	\$3,535	\$0	\$0	\$3,535	\$3,535	\$68.84
2013	BEATRICE FORD LINCOLN MERCURY, INC	\$3,535	\$0	\$0	\$3,535	\$3,535	\$69.86

**Tax Statement**

Served by **WEBSERVER-ONE**

**Gage County**

**0** **Step 4 of 8**

<b>Perm ID</b> 013661501	<b>Name</b> RGH PROPERTIES LLC 4115 N 6TH ST BEATRICE NE 68310-	<b>Legal</b> W 425.9' OF N 300' OF LOT 1 NORTH COMMERCE ADDITION
-----------------------------	--	---

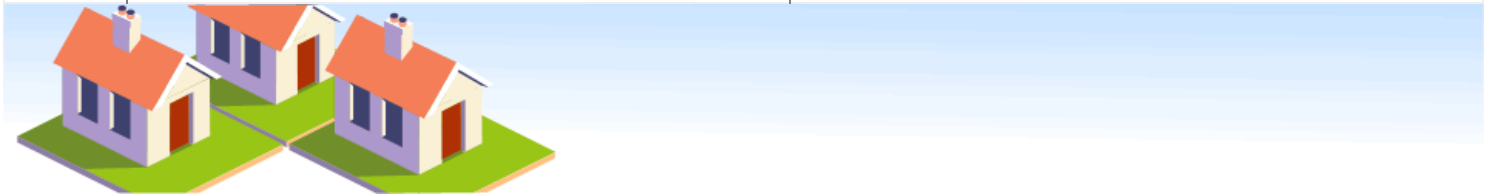

[Levy Graph](#)
[Value Graph](#)
[Tax Graph](#)

Year	Statement	Value	Tax	Exemption	Net Tax	Balance Due
2018	<a href="#">014539</a>	\$ 3,535	\$ 73.08	- \$ 3.06	\$ 70.02	\$ 70.02
2017	<a href="#">014515</a>	\$ 3,535	\$ 68.48	- \$ 3.10	\$ 65.38	\$ 0.00
2016	<a href="#">014472</a>	\$ 3,535	\$ 67.64	- \$ 3.16	\$ 64.48	\$ 0.00
2015	<a href="#">014458</a>	\$ 3,535	\$ 69.96	- \$ 3.32	\$ 66.64	\$ 0.00
2014	<a href="#">014454</a>	\$ 3,535	\$ 71.36	- \$ 2.52	\$ 68.84	\$ 0.00
2013	<a href="#">014402</a>	\$ 3,535	\$ 72.20	- \$ 2.34	\$ 69.86	\$ 0.00
2012	<a href="#">014390</a>	\$ 3,535	\$ 73.26	- \$ 2.52	\$ 70.74	\$ 0.00
2011	<a href="#">002018</a>	\$ 3,535	\$ 73.24	- \$ 2.66	\$ 70.58	\$ 0.00
2010	<a href="#">014364</a>	\$ 3,535	\$ 73.14	- \$ 2.78	\$ 70.36	\$ 0.00
2009	<a href="#">014337</a>	\$ 3,535	\$ 72.42	- \$ 2.90	\$ 69.52	\$ 0.00
2008	<a href="#">000911</a>	\$ 3,535	\$ 72.44	- \$ 3.04	\$ 69.40	\$ 0.00
2007	<a href="#">014281</a>	\$ 3,535	\$ 72.94	- \$ 2.94	\$ 70.00	\$ 0.00
2006	<a href="#">014173</a>	\$ 3,535	\$ 69.14	\$ 0.00	\$ 69.14	\$ 0.00
2005	<a href="#">010027</a>	\$ 3,535	\$ 70.48	\$ 0.00	\$ 70.48	\$ 0.00
2004	<a href="#">014031</a>	\$ 3,535	\$ 70.74	\$ 0.00	\$ 70.74	\$ 0.00
2003	<a href="#">010341</a>	\$ 3,535	\$ 71.20	\$ 0.00	\$ 71.20	\$ 0.00
2002	<a href="#">013918</a>	\$ 3,075	\$ 61.46	\$ 0.00	\$ 61.46	\$ 0.00
2001	<a href="#">014922</a>	\$ 2,930	\$ 57.78	\$ 0.00	\$ 57.78	\$ 0.00
2000	<a href="#">014855</a>	\$ 2,930	\$ 61.17	- \$ 0.89	\$ 60.28	\$ 0.00
1999	<a href="#">014684</a>	\$ 2,930	\$ 60.94	\$ 0.00	\$ 60.94	\$ 0.00
1998	<a href="#">014570</a>	\$ 2,930	\$ 62.02	\$ 0.00	\$ 62.02	\$ 0.00
1997	<a href="#">014511</a>	\$ 2,930	\$ 66.10	\$ 0.00	\$ 66.10	\$ 0.00
1996	<a href="#">014447</a>	\$ 1,640	\$ 40.88	\$ 0.00	\$ 40.88	\$ 0.00
1995	<a href="#">014350</a>	\$ 1,640	\$ 42.04	\$ 0.00	\$ 42.04	\$ 0.00

The information provided in this site is the most recent and most accurate data available. All information contained herein is for informational purposes only. MIPS Inc does not warrant that such information is accurate and error free. This information is provided on an "as is" basis without warranties of any kind, either expressed or implied, including, but not limited to, the implied warranties of merchantability or fitness for a particular purpose. MIPS Inc shall not be liable for any direct, indirect, incidental, special or consequential damages arising out of the use of such information or the inability to use such information. MIPS also is not, nor shall be party to or subject to any warranty or any breach of any kind. The User acknowledges and agrees that the use of such information is at the sole risk of the User.

Copyright © 2004 Nebraska Association of County Officials. All rights reserved.