



MISC 2014040884



JUN 03 2014 10:07 P 8

misc 84
FEE 52.00 FB 07-0563-odd
BKP C/O COMP
DEL SCAN FV

Received - DIANE L. BATTIATO
Register of Deeds, Douglas County, NE
6/3/2014 10:07:23.91
2014040884

THE CAPITOL DISTRICT REPLAT 1

LOTS 1 AND 2, THE CAPITOL DISTRICT REPLAT 1, BEING AN ADMINISTRATIVE REPLATTING OF LOTS 3 AND 4, THE CAPITOL DISTRICT, A SUBDIVISION, AS SURVEYED, PLATTED AND RECORDED IN DOUGLAS COUNTY, NEBRASKA.

LOCATED IN:
NE 1/4 NE 1/4 SEC. 22-15-13

drawn by	EAM
designed by	
reviewed by	TLW

filename	10011R101-FINAL.dwg
revisions	

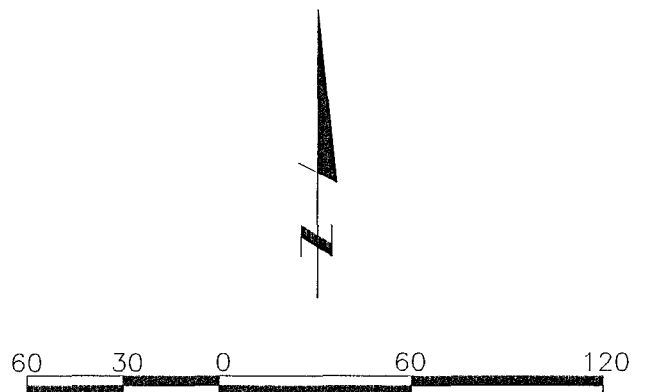

- LEGEND**
- BOUNDARY LINE
 - - - LOT LINE
 - - - EASEMENT LINE
 - ▨ STREET VACATION
 - ▤ EASEMENT TO BE RELEASED
 - ▥ MUD EASEMENT TO BE RELEASED

LAND SURVEYOR'S CERTIFICATE
I HEREBY CERTIFY THAT I have made a boundary survey of the subdivision herein and that permanent monuments have been placed at all corners, angle points and ends of curves on the boundary on the plat and that permanent monuments will be placed at all corners, angle points and ends of curves on all lots within the subdivision to be known as Lots 1 and 2, THE CAPITOL DISTRICT REPLAT 1 being an administrative replatting of Lots 3 and 4, THE CAPITOL DISTRICT, a subdivision, as surveyed, platted and recorded in Douglas County, Nebraska.

Contains 121,130 square feet or 2.781 acres.
Todd L. Whitfield, L.S. 561
Date 5-30-2014

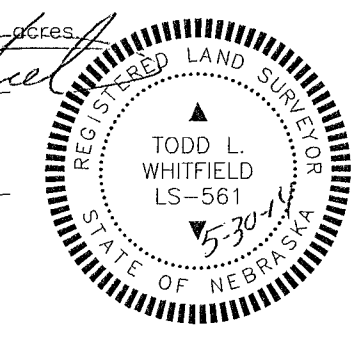

- NOTES**
- ALL DISTANCES ARE SHOWN IN DECIMAL FEET.
 - ALL ANGLES ARE 90° UNLESS OTHERWISE NOTED.

OWNER'S CERTIFICATION
KNOW ALL PERSONS BY THESE PRESENTS: That the undersigned are OWNERS of the property as described in the surveyor's certificate and embraced within this plat, and have caused said land to be subdivided into lots as shown on this plat.

CITY OF OMAHA, a Municipal Corporation, OWNER
Jean Stothert
Mayor, City of Omaha
Attest: [Signature]
City Clerk

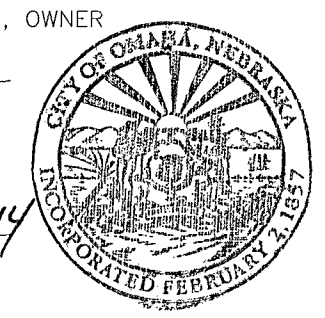

ACKNOWLEDGEMENT OF NOTARY

State of Nebraska)
)SS
County of Douglas)
The foregoing instrument was acknowledged before me this
2nd day of June, 2014
by Jean Stothert, Mayor of the City of Omaha
Jenna L. Garcia
Signature of Notary Public

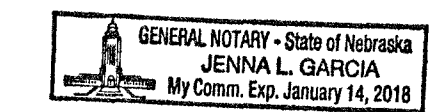

COUNTY TREASURER'S CERTIFICATE

THIS IS TO CERTIFY THAT I FIND NO REGULAR NOR SPECIAL TAXES DUE OR DELINQUENT AGAINST THE PROPERTY DESCRIBED IN THE LAND SURVEYOR'S CERTIFICATE AND EMBRACED IN THIS PLAT, AS SHOWN BY THE RECORDS OF THIS OFFICE, THIS
3 DAY OF June, 2014.
Susan Berscheid
DOUGLAS COUNTY TREASURER

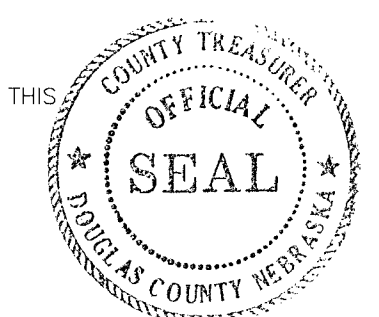

PLANNING DIRECTOR'S APPROVAL

APPROVED AS A SUBDIVISION OF LOTS 1 AND 2, THE CAPITOL DISTRICT REPLAT 1 OF NOT MORE THAN TWO (2) LOTS, PARCELS OR TRACTS WITH PLAT REQUIREMENTS WAIVED PER SECTION 7.08, HOME RULE CHARTER OF THE CITY OF OMAHA 1956. THIS SUBDIVISION APPROVAL IS VOID UNLESS THIS PLAT IS FILED AND RECORDED WITH THE COUNTY REGISTER OF DEEDS WITHIN THIRTY (30) DAYS OF THIS DATE.
James R. Thel
PLANNING DIRECTOR
DATE 6/2/14

DOUGLAS COUNTY ENGINEER REVIEW

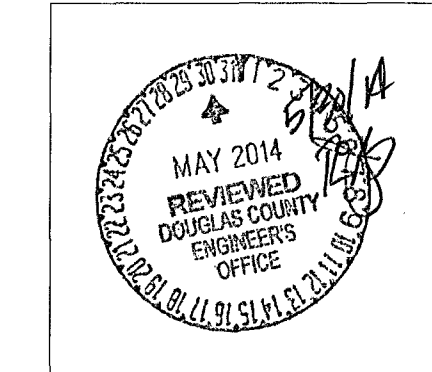

14710 West Dodge Road, Suite 100 402.496.2498 | P
Omaha, Nebraska 68154-2027 402.496.2730 | F
www.LRA-inc.com

LAMP RYNEARSON & ASSOCIATES

ADMINISTRATIVE
SUBDIVISION

job number-tasks
0110011.01-003
book page
date
5-30-14
sheet
1 of 1

