

3

1.30 1.40

BEFORE THE COUNTY JUDGE OF DOUGLAS COUNTY, NEBRASKA

BOOK 395 PAGE 311

THE STATE OF NEBRASKA  
DEPARTMENT OF ROADS

Condemner

vs.

~~ANDREW C. NELSON, Owner; OLIVA  
VESTER NELSON, wife of ANDREW  
C. NELSON;~~

BEVERLY SELDIN, Owner; MILLARD  
SELDIN, husband of BEVERLY SELDIN;

IRENE J. PINKALL, ELLENE M.  
GOLLEHON, NORMA I. GANS, a single  
woman, Tenants in Common; ARTHUR  
PINKALL, husband of IRENE J.  
PINKALL; EUGENE M. GOLLEHON,  
husband of ELLENE M. GOLLEHON;

GROVER E. NELSON, Owner; MARY  
D. NELSON, wife of GROVER E.  
NELSON;

Condemnees

RETURN OF APPRAISERS

C 2 - 206

TO HONORABLE ROBERT R. TROYER, COUNTY JUDGE OF DOUGLAS COUNTY, NEBR.

We, the undersigned appraisers, do hereby certify that under and by virtue of an "Appointment of Appraisers" duly served upon us by PATRICK CORRIGAN, Sheriff ~~or Deputy Sheriff~~ of Douglas County, Nebraska, on the 14<sup>th</sup> day of JANUARY, 1962, and after having taken and filed the "Oath of Appraisers" that we did carefully inspect and view the property described herein, sought to be appropriated by the State of Nebraska, Department of Roads, and also other property of the condemnees alleged damaged thereby and did hear all parties interested therein in reference to the amount of damages sustained while we were so inspecting and viewing the property herein described and thereafter did assess the damages that the condemnees have sustained or will sustain by such appropriation of the property herein described for State highway purposes and also damage to such other property of the condemnees as in our opinion was damaged by the appropriation of the property herein described:

C O N D E M N A T I O N

Land Owners: Beverly Seldin and Millard Seldin, wife and husband.

Project: I-80-9 (94) AFE: R-172b Douglas County, Nebraska

Permanent easement to a tract of land for the control of outdoor advertising as illustrated on the attached plat and being more particularly described as all that part of the West Half of the Southwest Quarter of Section 5, Township 14 North, Range 12 East of the 6th P.M., Douglas County, Nebraska, lying within 660 feet of the Interstate Highway Right of Way Controlled Access line as measured at right angles to the centerline of said Interstate Highway, and being in accordance with the provisions of Section 84-907, R.R.S. 1943; approved and filed on June 15, 1961.

1" St. e

N

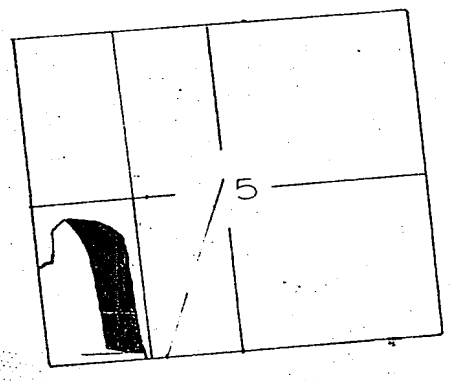

Advertising Control Lines

6 6

90°

10" St

16 L

1" = 200'

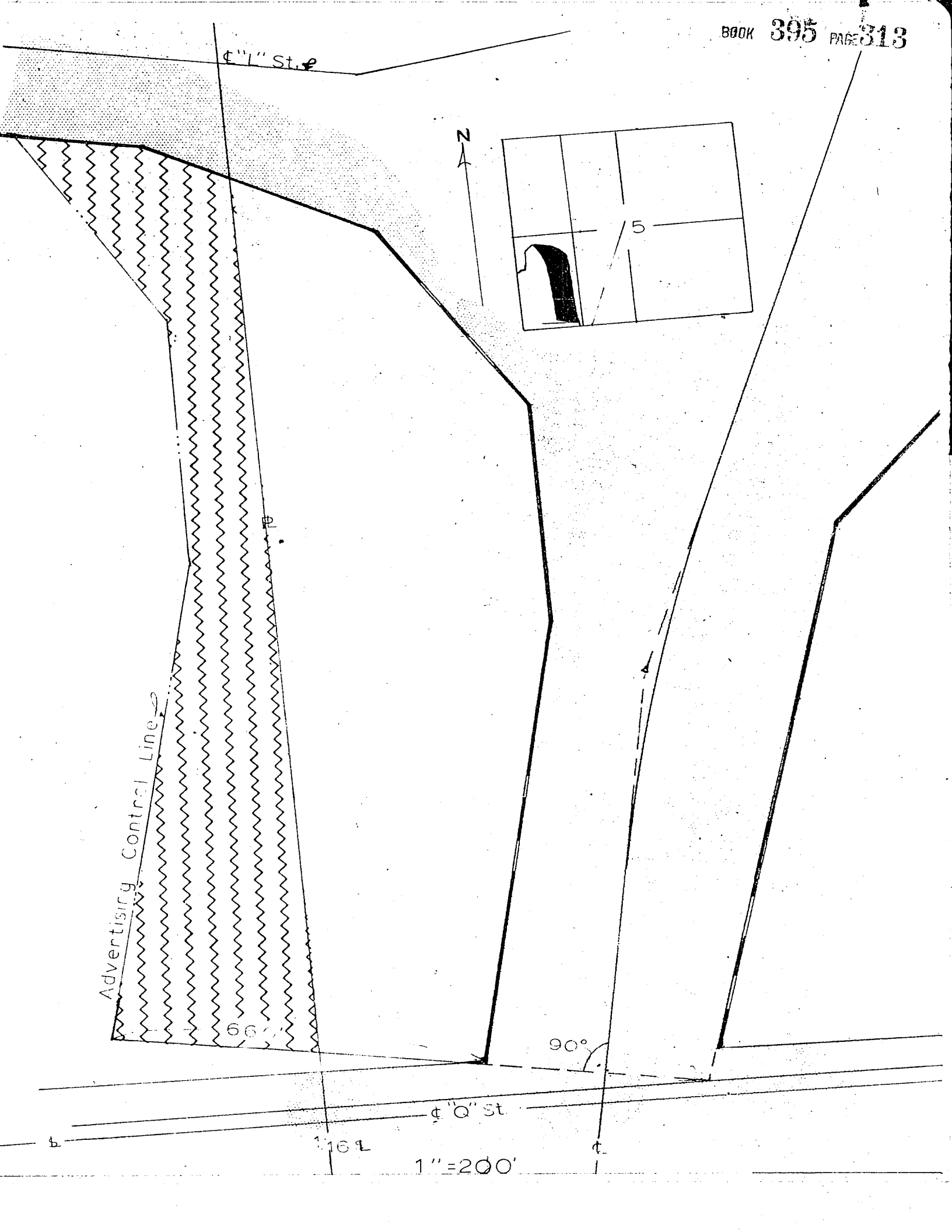

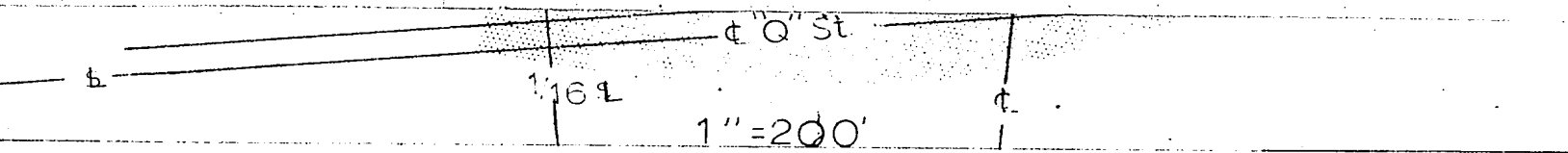

### ADVERTISING CONTROL

to be acquired for Interstate Highway Purposes  
 Project I-80-9(94) Douglas County A.F.E. R-172b  
 TRACT 214

Holder of record: BEVERLY SELDIN

Location: W<sup>2</sup>SW<sup>4</sup> Sec. 5-T14N-R12E

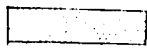
 ROW

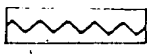
 ADV. CONTROL

 CONTR. ACCESS LINE

drawn <i>R.R.</i>
checked <i>BLT</i>
written <i>W.D.E.</i>
checked <i>d C.E.S.</i>

STATE of NEBRASKA

DEPARTMENT of ROADS

Section Line

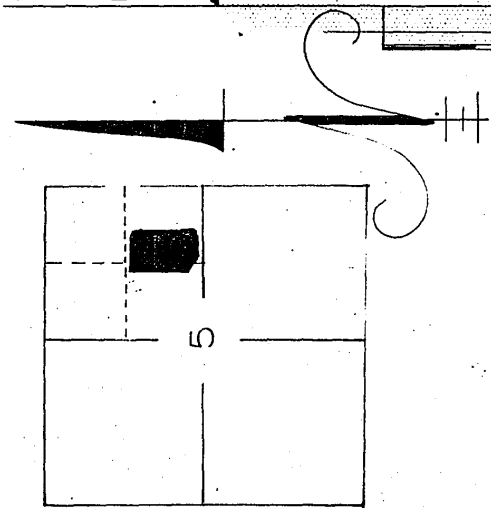

Adv. Control Line

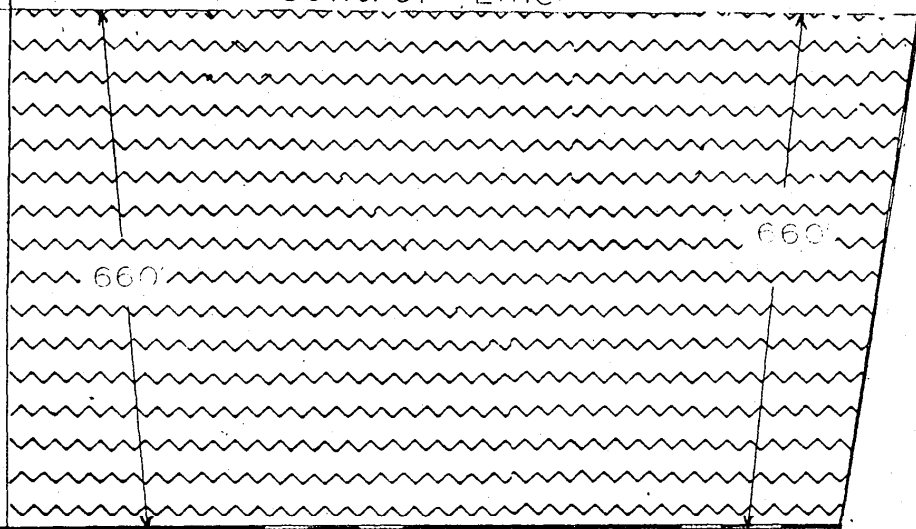

1/16 Section Line

1/4 Section Line

30°

90°

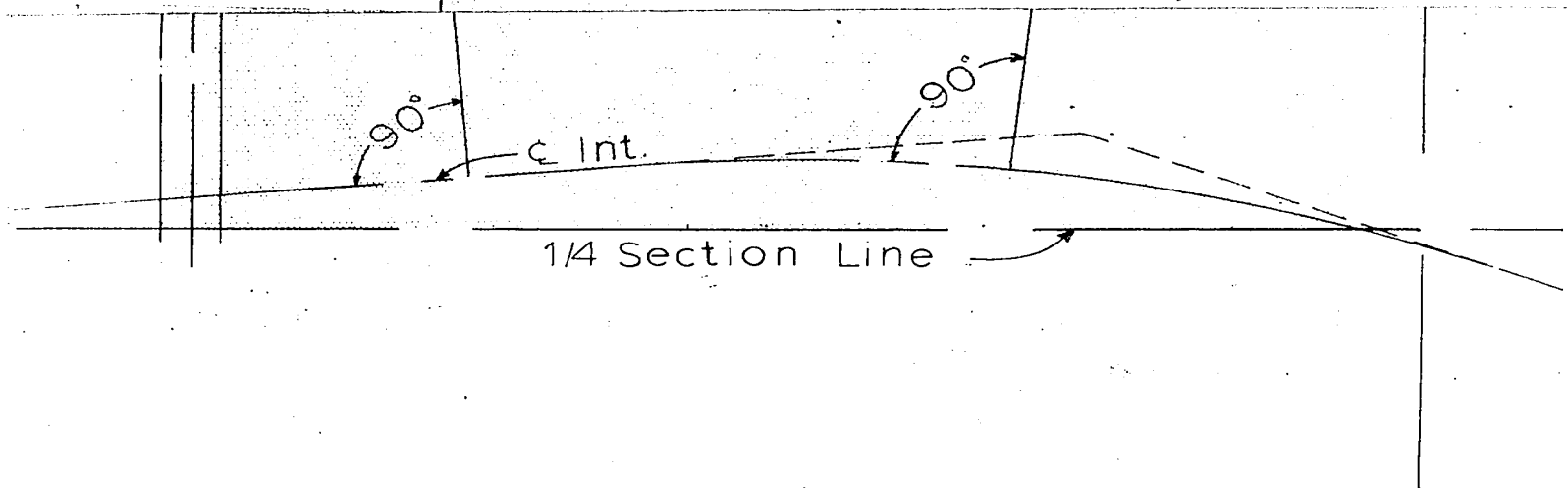

Scale: 1" = 200'

Advertising Easement  
 to be acquired for Interstate Highway purposes  
 Project I-80-9(94) DOUGLAS County AFE R-172b  
 Tract 218

Holder of Record: Irene J. Pinkall, etal  
 Location S1/2 NE 1/4, SEC. 5-T14N-R12E

-  OLD ROW
-  ADV. CONTROL
-  CONTR. ACCESS LINE

drawn	RBB
checked	CPB
written	WDE
checked	C.E.S.

STATE OF NEBRASKA

DEPARTMENT OF ROADS

## C O N D E M N A T I O N

Land Owners: Irene J. Pinkall; Ellene M. Gollehon; and Norma I. Gans, a single woman, Holders of Interest; Arthur Pinkall, husband of Irene Pinkall; and Eugene M. Gollehon, husband of Ellene M. Gollehon.

Project: I-80-9 (94) AFE: R-172b Douglas County, Nebraska

Permanent easement to a tract of land for the control of outdoor advertising as illustrated on the attached plat and being more particularly described as all that part of the South Half of the Northeast Quarter of Section 5, Township 14 North, Range 12 East of the 6th P.M., Douglas County, Nebraska, lying within 660 feet of the Interstate Highway Right of Way Controlled Access line as measured at right angles to the centerline of said Interstate Highway, and being in accordance with the provisions of Section 84-907, R.R.S. 1943; approved and filed on June 15, 1961.

## C O N D E M N A T I O N

Land Owners: Grover E. Nelson and Mary D. Nelson, husband and wife.

Project: I-80-9 (94) AFE: R-172b Douglas County, Nebraska

Permanent easement to a tract of land for the control of outdoor advertising as illustrated on the attached plat and being more particularly described as all that part of Lot 6 in the Southeast Quarter of the Southeast Quarter of Section 7 and the West Half of the Southwest Quarter of Section 8, both in Township 14 North, Range 12 East of the 6th P.M., Douglas County, Nebraska, lying within 660 feet of the Interstate Highway Right of Way Controlled Access line as measured at right angles to the centerline of said Interstate Highway, and being in accordance with the provisions of Section 84-907, R.R.S. 1943; approved and filed on June 15, 1961.

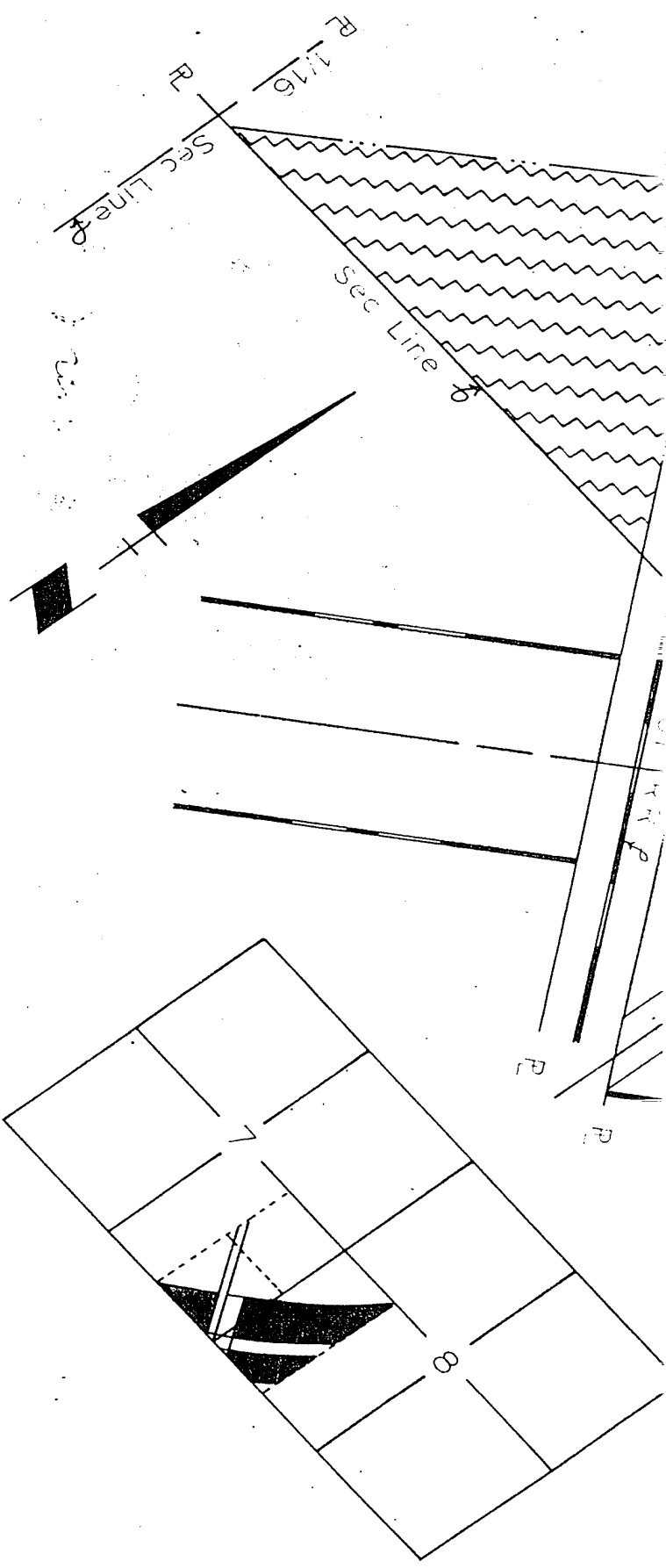

Scale: 1" = 200'

### Advertising Control

to be acquired for Interstate Highway purposes

Project: I-80-9(94) Douglas County A.F.E. R-172b

Tract: 211

Holder of Record: Grover E. Nelson

Location: Lot 6 in the SE 1/4 SE 1/4 Sec 7-T14N-R12E  
and the W 1/2 SW 1/4 Sec 8-T14N-R12E

-  Old ROW
-  Advertising Easement
-  Controlled Access

drawn	AKS
checked	CPG
written	WDE
checked	CEB



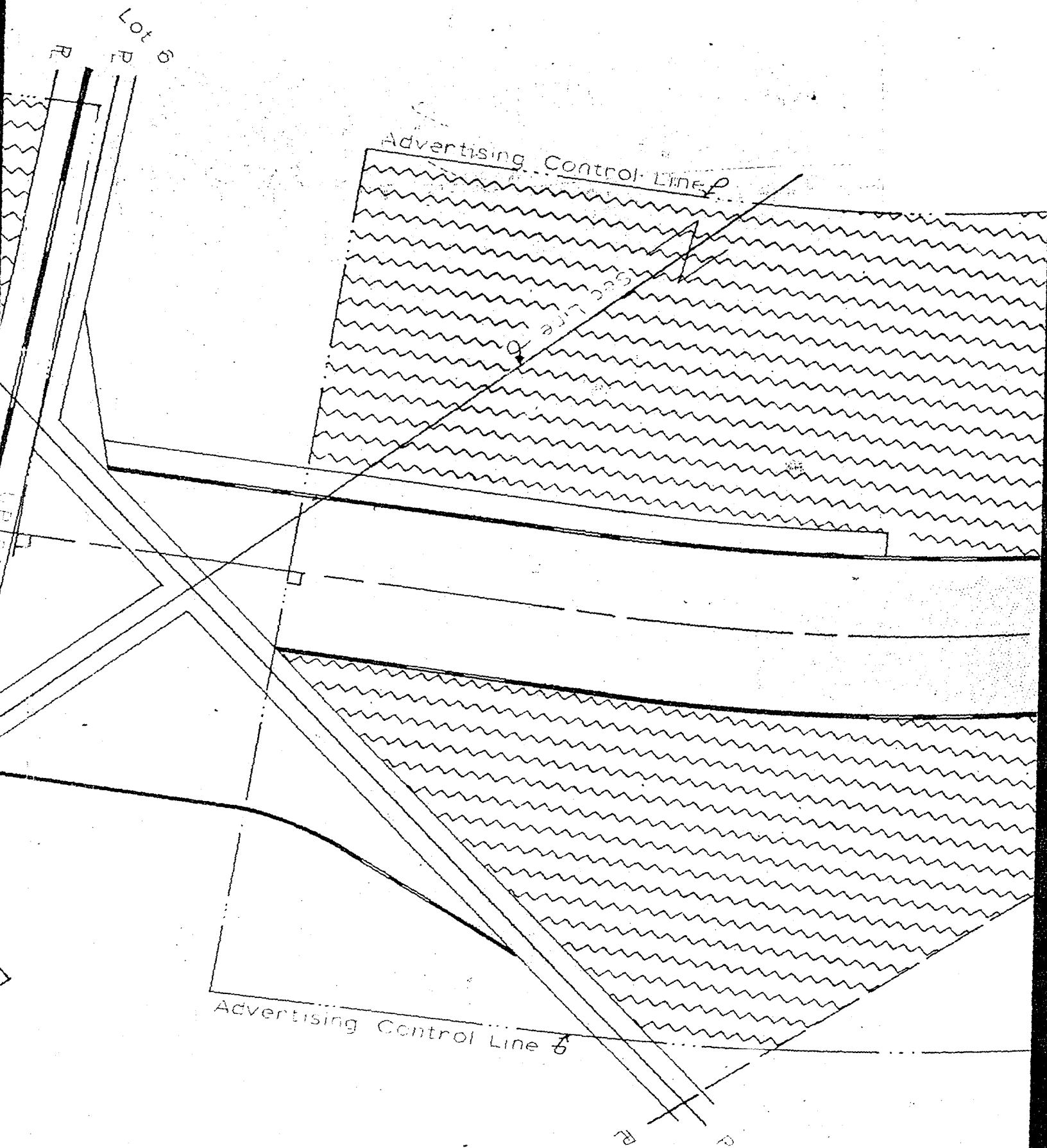

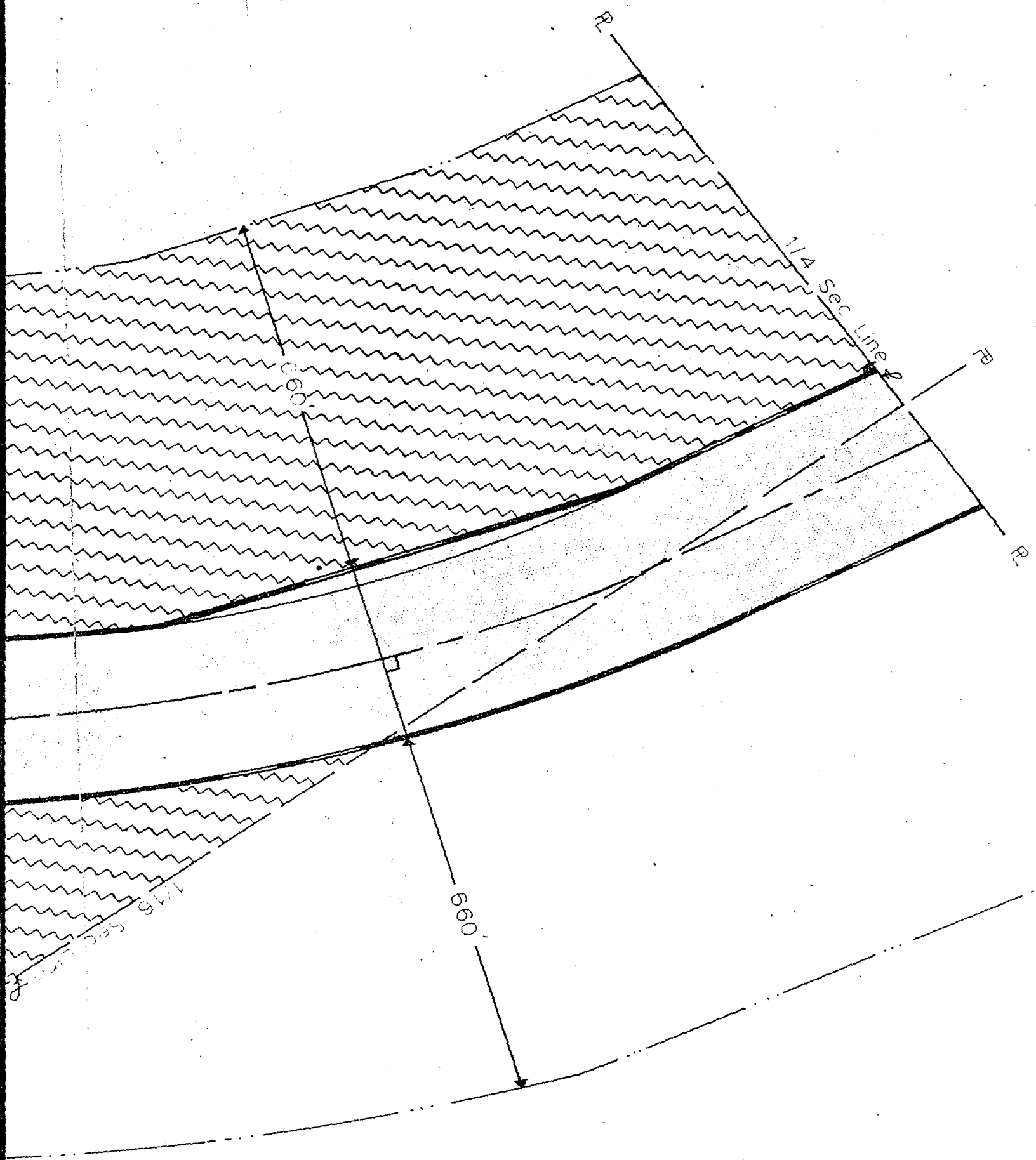



5  
7  
- 14-12

8-14-12  
5-14-12  
400  
14-12

*James J. Brennan*  
Register of Deeds

THE STATE OF NEBRASKA  
Douglas County  
Entered in Abstract filed and paid  
for Record in the office of the Register of  
Deeds of said County and recorded in  
Book 395 of Maps  
Page 311

THOMAS J. O'CONNOR  
REGISTER OF DEEDS  
DOUGLAS COUNTY, NEBR.

1963 APR 8 AM 10 03

RECEIVED

*Murphy*

STATE OF NEBRASKA, SS. I, Robert R. Troyer, County Judge  
COUNTY OF DOUGLAS of Douglas County, Nebraska, do  
hereby certify the foregoing copy, consisting of 89 pages,  
to be a full, true and correct copy of the original record  
thereof, now remaining on file in said court; that I have  
the legal custody and control of said original record; and  
that the seal of said court is hereto affixed.

WITNESS my hand and the seal of said Court at Omaha  
this 27th day of February 1963

ROBERT R. TROYER, County Judge

BY Joseph J. Belits  
Clerk of the County Court

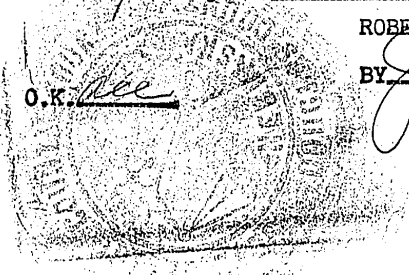

O.K. see