

HOUSING COMMUNITY & DEVELOPMENT DEPARTMENT
PERMITS & INSPECTIONS DIVISION

BOOK 625 PAGE 237

~~CONDEMNATION OF BUILDING~~

WORK SHEET

ADDRESS 4622 Douglas STRUCTURE Wd Frm
 TYPE Dug SIZE 26x30x22
 BASEMENT yes STORIES 2
 OCCUPANT Vacated
 CONDITION OF BUILDING: Fire Damaged

LOCATION: SHOW LOCATION OF STRUCTURE ON THE PLATTED BLOCK AS MEASURED FROM CENTER LINES OF STREETS TO CENTER LINE OF STRUCTURE.

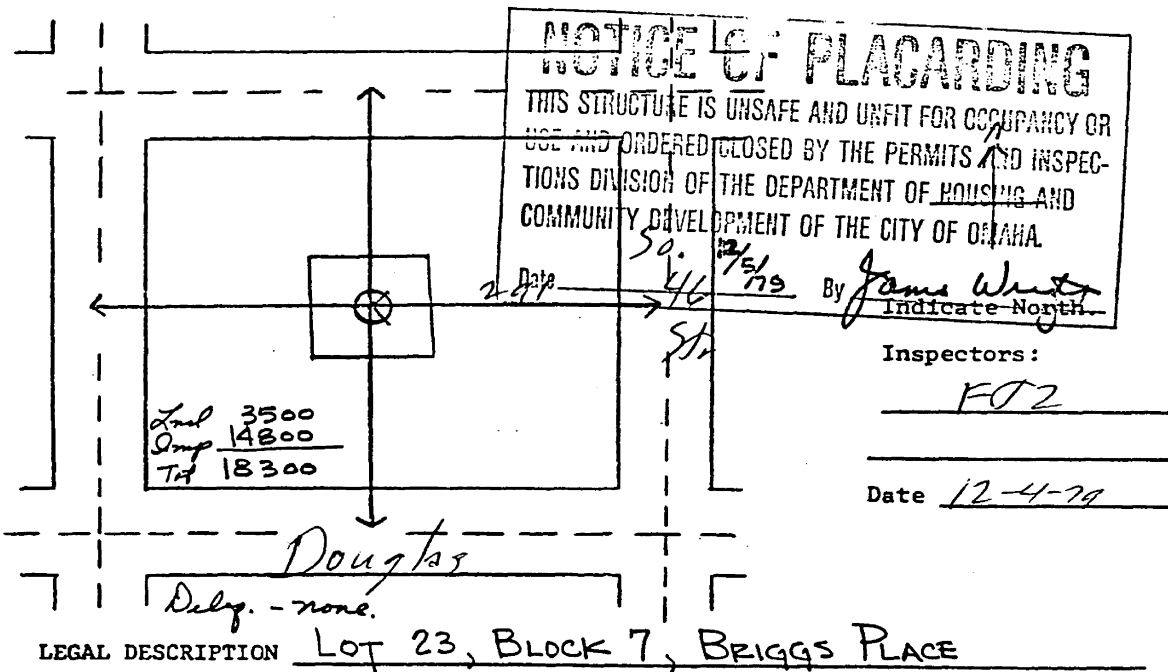

LEGAL DESCRIPTION LOT 23, BLOCK 7, BRIGGS PLACE

OWNER: HARRY LIPERT

ADDRESS: 4623 DODGE ST., OMAHA, NEBR 68132

- MITIGES. ① SECURITY NATIONAL BANK OF OMAHA, ATTN:
 BPI-164 05 3500 FARNAM ST., OMAHA, NEBR.
 ② ROBERT K. SILVERMAN, ATTY (ADM. OF EST. OF RICHARD O'REILLY)
 10050 REGENCY CIR., OMAHA, NEBR.
- Dec'd 16/175*
mtg 16/267

625

RECEIVED
 1979 DEC -5 PM 2:29
 C. HAROLD OSTLER
 REGISTER OF DEEDS
 DOUGLAS COUNTY, NEBR.

Book 625
 Page 237
 .02
 Fee
 Index
 Compt
 16-238
 16