

CAHN, METCALF & FARWELL'S

SUBDIVISION

Scale: 200 feet = one inch.

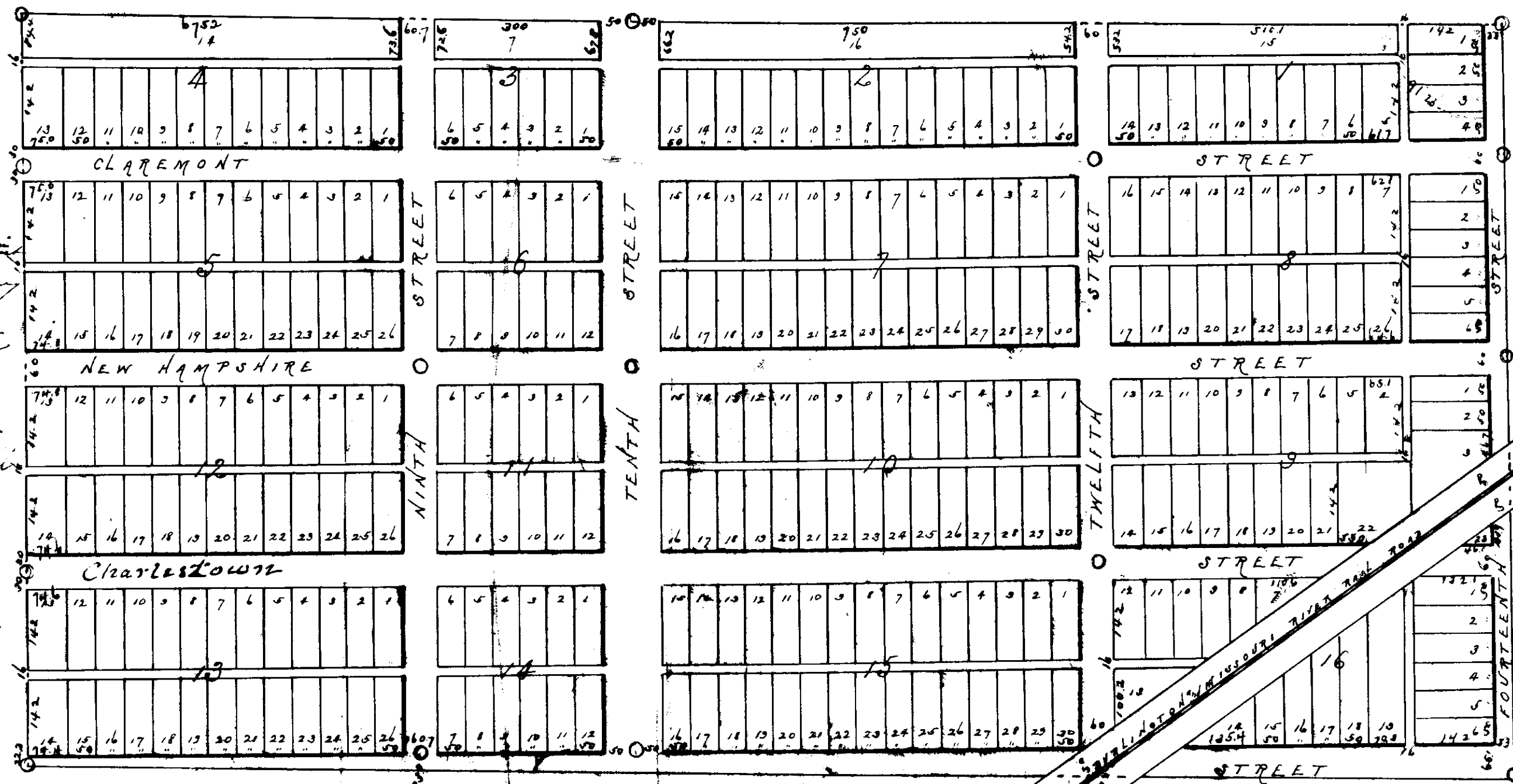
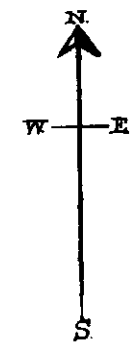

LEGEND:
 CAHN, METCALF & FARWELL'S SUBDIVISION comprises all of the North half of the NE 1/4 of Section 20, T. 10 N. R. 6 E. of the 6th P.M. Lancaster Co. Neb.
 Tenth Street is 100 feet wide being a continuation of Tenth Street in Lincoln.
 Ninth Street is 67 feet wide. The distance from center line of 9th Street to monument in center of 9th St. in North Lincoln being 4107 feet. CHARLESTOWN, Claremont, New Hampshire, 12th Streets are each 60 feet wide.
 11th Street has dimensions as marked on the plat the North line of 11th Street being 313 feet North of monument at center of 11th Street in North Lincoln.
 Fourteenth Street is 55 feet wide & is parallel to East line of 7th of the NE 1/4 of section 20.
 All street lines are parallel to or at right angles with the center line of 11th Street in Lincoln, except 12th Street & the South line of 11th Street.
 All alleys are 16 feet wide.
 All lots are subject to 142 feet except fractional lots on the North West boundaries of this subdivision, lots adjoining the right of way of the B. & M. R. R. Lots 19 & 20 in Block 1, lots 7 & 8 in Block 8, lots 11 & 12 in Block 16 which have dimensions as indicated on the plat.
 Stones with drill hole are set at points marked thus O.
 Oak stakes are set at all lot corners on the block lines except all lot corners between the South West corner of lot 4 in Block 2, the North West corner of lot 16 in Block 2, all lot corners between the North West corner of lot 10 & the North West corner of lot 10 in Block 7, corners on the South end of lots 11 Block 6 & the South West corner of lot 11 Block 14.
 Nov. 16, 1886.

The foregoing subdivision of the North half of the North East quarter of Section 20 T. 10 N. R. 6 E. of the 6th P.M. Lancaster Co. Neb. as appears on this plat, is with the free consent and in accordance with the desire of the undersigned owners and proprietors.
 Signed this 30th day of June 1886
 In presence of
 O. C. Bell
 Anna Metcalf
 Julia Metcalf
 Charles Farwell
 Julia Metcalf

The State of Nebraska }
 County of Lancaster }
 On this 30th day of November 1886 before me J. J. Greenwood a Notary Public duly commissioned and qualified for and residing in said county personally came Julia Metcalf and her wife to me known to be the identical persons who executed the foregoing plat and acknowledged the said instrument to be their voluntary act and deed.
 Witness my hand and Notarial Seal in said County and State, the day and year last above written.
 J. J. Greenwood
 Notary Public

The State of New Hampshire }
 County of Sullivan }
 On this 30th day of November 1886 before me Charles Farwell a Notary Public duly commissioned and qualified for and residing in said County personally came C. Farwell and his wife to me known to be the identical persons who executed the foregoing plat and acknowledged the said instrument to be their voluntary act and deed.
 Witness my hand and Notarial Seal in said County and State, the day and year last above written.

State of Nebraska }
 Lancaster County }
 On this 13th day of January 1886 before me O. C. Bell a Notary Public duly commissioned and qualified for and residing in said County personally came Anna Metcalf and Julia Metcalf their ally in fact to me known to be the identical persons who executed the foregoing plat and acknowledged the said instrument to be their voluntary act and deed.
 Witness my hand and Notarial Seal in said County and State, the day and year last above written.
 O. C. Bell
 Notary Public

