

COUNTER LM
VERIFY LM
FEES \$ 46.00
CHG SFILE
SUBMITTED NEBRASKA TITLE COMPANY-ON

FILED SARPY CO. NE.
INSTRUMENT NUMBER

2017-07541

2017 Apr 05 03:34:44 PM

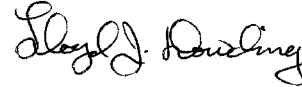

REGISTER OF DEEDS



RECORDATION REQUESTED BY: Intrust Bank, N.A., 105 N. Main, Wichita, KS 67202
WHEN RECORDED RETURN TO: Intrust Bank, N.A., 105 N. Main, Wichita, KS 67202; 316-383-1171

MEMORANDUM OF LEASE

This Memorandum of Lease is dated as of the 27th day of March, 2017, by and between Spaustat Energy Group, LLC, a Nebraska limited liability company ("Landlord"), and Mitchell Management Company, a Nebraska corporation ("Tenant").

1. Lease: Lease Agreement dated as of November 16, 2015, without amendment (the "Lease"), between Landlord and Tenant.

2. Description of Demised Premises: See **Exhibit "A" and Exhibit "B"** attached hereto and incorporated by reference.

3. Date of Lease Commencement: November 16, 2015.

4. Term: The Lease shall continue for ten (10) years, with four additional five-year extension periods.

5. Notice. The purpose of this Memorandum of Lease is to give record notice of the Lease and of the rights created thereby, all of which are hereby confirmed.

6. Landlord Consent: Landlord hereby consents to the granting of a Leasehold Mortgage covering the Demised Premises from Tenant in favor of INTRUST Bank, N.A., its successors and assigns.

7. Counterparts. This Memorandum may be executed on counterpart signature pages which, when attached to the original, shall be deemed a part thereof.

[Signatures appear on the following page.]

{581846-}

1

0272914

IN WITNESS WHEREOF this Memorandum of Lease is executed as of the date set forth above.

LANDLORD:
Spaustat Energy Group, LLC

By Karen Shramel
Name/Title: Member

TENANT:
Mitchell Management Company

By _____
Name/Title: _____

STATE OF Nebr.)

COUNTY OF Dodge)

The foregoing Memorandum was duly acknowledged before me by Karen Shramel as Member of Spaustat Energy Group, LLC, a Nebraska limited liability company, on the 21 day of March, 2017.

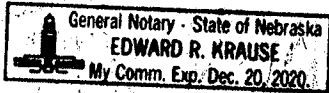

Edward R. Krause
Notary Public

My commission expires: Dec. 20, 2020

STATE OF _____)

COUNTY OF _____)

The foregoing Memorandum was duly acknowledged before me by _____, as _____ of Mitchell Management Company, a Nebraska corporation, on the ___ day of _____, 2017.

Notary Public

My commission expires: _____

IN WITNESS WHEREOF this Memorandum of Lease is executed as of the date set forth above.

LANDLORD:
Spaustat Energy Group, LLC

By _____
Name/Title: _____

TENANT:
Mitchell Management Company

By [Signature]
Name/Title: Mark Mitchell

STATE OF _____)

COUNTY OF _____)

The foregoing Memorandum was duly acknowledged before me by _____ as _____ of Spaustat Energy Group, LLC, a Nebraska limited liability company, on the ____ day of _____, 2017.

Notary Public
My commission expires: _____

STATE OF Nebraska)

COUNTY OF Douglas)

The foregoing Memorandum was duly acknowledged before me by Mark Mitchell, as President of Mitchell Management Company, a Nebraska corporation, on the 27th day of March, 2017.

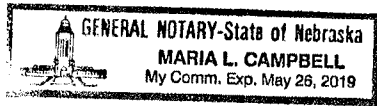

[Signature]
Notary Public
My commission expires: May 26, 2019

EXHIBIT A
SITE PLAN

R

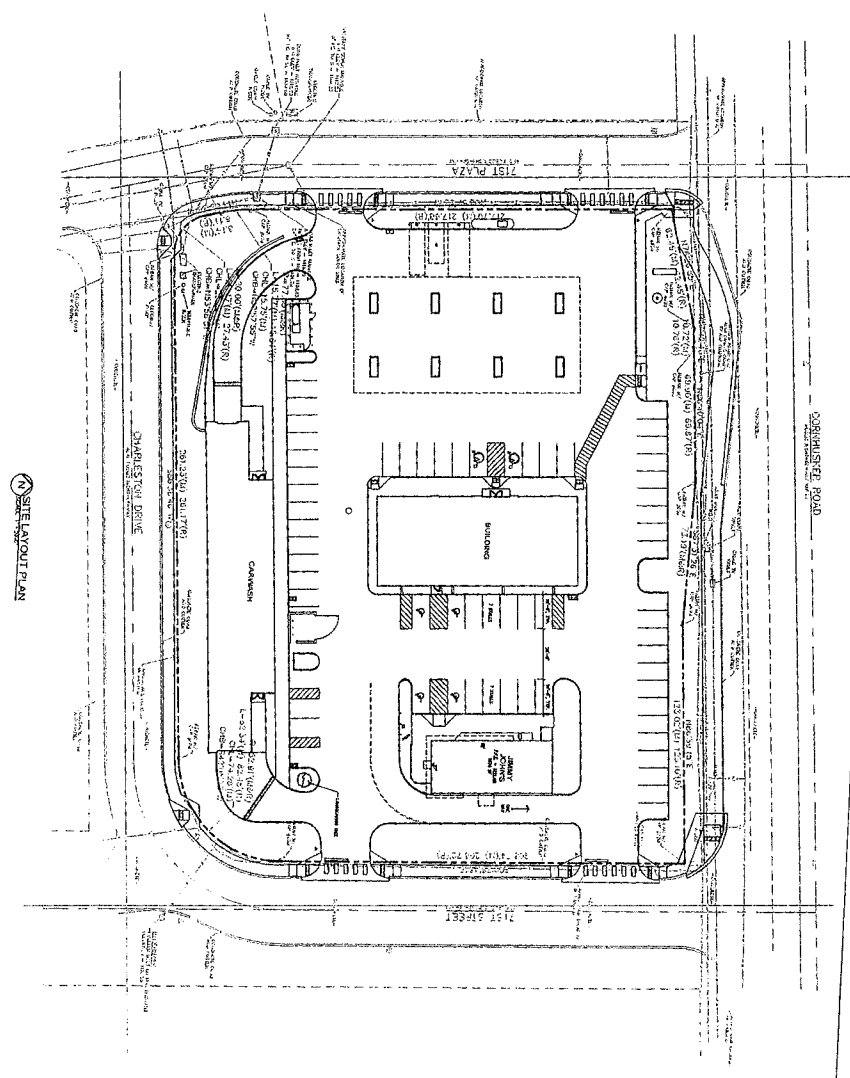

 NORTH
 SITE LAYOUT PLAN

NO.	REVISION	DATE
1	ISSUED FOR PERMIT	11/15/11
2	ISSUED FOR CONSTRUCTION	11/15/11
3	ISSUED FOR CONSTRUCTION	11/15/11
4	ISSUED FOR CONSTRUCTION	11/15/11
5	ISSUED FOR CONSTRUCTION	11/15/11
6	ISSUED FOR CONSTRUCTION	11/15/11
7	ISSUED FOR CONSTRUCTION	11/15/11
8	ISSUED FOR CONSTRUCTION	11/15/11
9	ISSUED FOR CONSTRUCTION	11/15/11
10	ISSUED FOR CONSTRUCTION	11/15/11

CONSTRUCTION DOCUMENTS FOR
JIMMY JOHN'S FRANCHISE, LLC
 LOT 1, WEST CORNHUSKER PLAZA
 PAPPILLION, NE

BLANKMAN
 ENGINEERING

C1.1

P

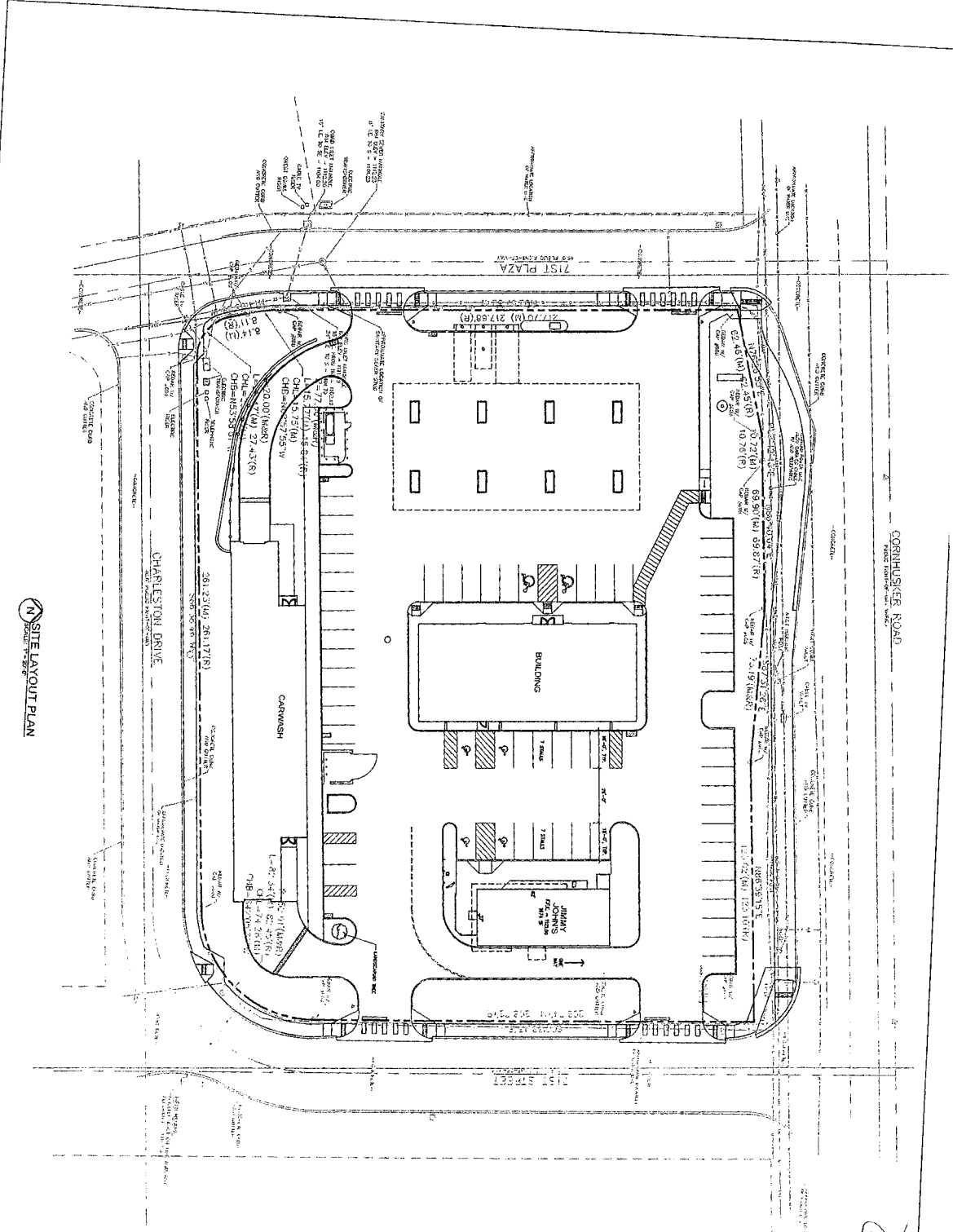

N SITE LAYOUT PLAN

2

EXHIBIT B

Lot One (1), West Cornhusker Plaza, a subdivision, Sarpy County, Nebraska.