

IOWA STATE HIGHWAY COMMISSION  
ENTRANCE PERMIT

(Application for Permit to Construct Entrance from Private Property  
to Primary Road or Primary Road Extension)

STATE OF IOWA, SIOUX COUNTY, SS.

Recorded SEP 28 1972

File No. 1972 Card No. 2351  
(Book) (Page)

Filed Records at 8:00 AM  
A. Van Roskel, Recorder AS

2351

Permit Number 9-768

County Sioux

Project 84

Highway Number Ia. #10

Applicant Robert Wassenaar (Owner or Owners of Record)

Address Orange City (Date) 10 July, 19 72

Iowa State Highway Commission  
Ames, Iowa

Gentlemen:

A permit is hereby requested to construct a two Type "B" entrance 30 feet in width, from right of way  
(Type "A", "B", or "C")  
line to primary road traveled way, including necessary drainage structure thereunder at Station 44+00  
45+00+50, north side.

PLAT OF ENTRANCE AS PROPOSED TO BE CONSTRUCTED IS ATTACHED  
TO AND IS A PART OF THIS APPLICATION. (Form 534)

Proposed entrance is located on Primary Road No. 10, Sec. 33, T. 95N, R. 44W, Sioux

County, Sioux, Miles east from Orange City more specifically described as follows:  
(Direction) (Place, Town, or Object)

Drives are to be located appx. 3668 and 3768 ft. east of  
the NW cor. Sec. 4-94-44, Sioux Co. at Highway Stations  
44+00 and 45+00.

The applicant agrees that if granted a permit to construct the above described entrance, the following stipulations shall govern.

1. Written approval of the Highway Commission shall be obtained before any change is made in the entrance or its location.

2. That the entrance, including drainage structure, grading and surfacing, shall be constructed by the applicant at the applicant's expense, in accordance with the plat attached hereto, and in conformity with the standard specifications of the Iowa State Highway Commission, and shall thereafter be kept in repair and maintained by the applicant at his own expense. Nothing in this stipulation, however, shall preclude the Iowa State Highway Commission from entering upon said entrance on highway right of way and performing necessary maintenance for the protection of the highway.

3. That the construction, of the entrance shall be completed by the 1st day of Oct., 19 72  
(The permit is null and void if drive is not completed by the above date unless extension is granted in writing by the Iowa State Highway Commission.)

4. That the construction, future repair or maintenance of said entrance shall be carried on in such a way as not to interfere with, or interrupt traffic on said highway, and the applicant shall take all reasonable precautions to protect and safeguard the lives and property of any person or persons, and shall save the State and State Highway Commission harmless of any damage or losses that may be sustained by any person or persons, on account of such construction, repair or maintenance operations.

5. That no filling will be permitted in the right of way of primary road No. 10 other than that necessary to construct the proposed entrance.

That the culvert pipe under the entrance shall be zinc coated corrugated metal or 1500D concrete pipe. It shall be 18 inches in diameter and 36 feet in length as shown on attached sketch, and of quality complying with Sec. 4141 and Sec. 4145 of the Iowa State Highway Commission Standard and Specifications, Series of 1964, or subsequent revisions. The pipe shall be installed at the elevation specified by the engineer.

The finished surface elevation of the driveway over the pipe or place where the pipe would normally be, shall be 4 inches lower than shoulder elevation at Station 44+00 to prevent water draining onto the pavement or travel way.  
45+00

6. That the applicant agrees to give the State Highway Commission forty-eight hours notice of his intention to start construction on the highway right of way. Said notice shall be in writing to the person whose name is shown on the reverse side.

7. That all provisions herein relating to future repair or maintenance shall be binding on all successors or assigns of the applicant.

8. Stipulations and requirements contained herein are not intended to waive greater requirements of local zoning ordinances.

9. Applicant's attention is directed to the fact that private property may not be used so as to obstruct or encumber the public highway-right of way, or interfere with the safety, comfort, and rights of public highway users.

10. \_\_\_\_\_  
\_\_\_\_\_  
\_\_\_\_\_

Signed x Robert Warren By SAME  
(Applicant) (Type name below line)  
Title Owner Address Orange City Ia

ACKNOWLEDGEMENT

STATE OF IOWA

On this 17<sup>th</sup> day of July A. D. 1972, before me Thomas J. De Jong, a Notary Public in and for said State of Iowa, personally appeared Robert Warren and \_\_\_\_\_ to be known to be the person(s) named in and who execute the foregoing instrument, and acknowledged, that he executed the same as voluntary act and deed.

Thomas J. De Jong  
Notary Public in and for said State

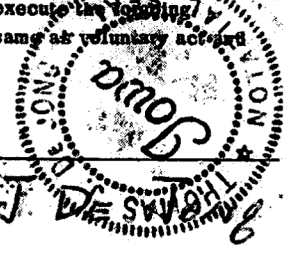

\*\*\*\*\*

Recommended for approval by Patrick H. Waters Recommended for approval for Orange City  
city or town  
Resident Maintenance Engineer, on Sept 22 1972 on September 5 1972 by Robert M. Dunlop  
Mayor  
Entrance Permit granted for the Iowa State Highway Commission by C. S. Lowe Authorized City Official  
District Engineer, on 9-25 1972 Zoning Officer Don E. Shaw

Notice of date construction is to start shall be sent by applicant to:  
Patrick H. Waters, Box 430, Rock Rapids, IA  
Name Address

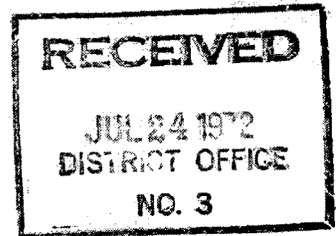

NOTATION OF RECORD

Filed for Record on the \_\_\_\_\_ day of \_\_\_\_\_, 19\_\_\_\_, at \_\_\_\_\_ o'clock \_\_\_\_\_ and Recorded in Book \_\_\_\_\_ of \_\_\_\_\_, on Page \_\_\_\_\_

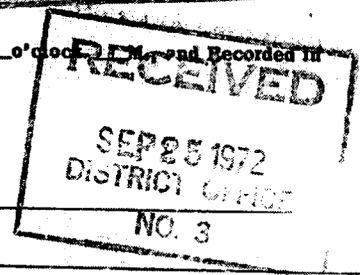

Recorder \_\_\_\_\_  
By \_\_\_\_\_ Deputy

(Four copies of the application and plat must be filed with the State Highway Commission at Ames, Iowa. If entrance requested is within a city or town five copies of application and plat are required.)

ACCESS PLAT

County Sioux

Project No. 84

SPECIAL PUBLIC ROAD CONNECTION (Access Rights Acquired)	CHECK	PRIVATE PROPERTY ENTRANCE (Access Rights NOT Acquired) EXHIBIT "A"
	X	
Attach to Form 539		Attach to Form 539

Location Description: Primary Road No. 10, Sec. 33, T. 95N, R. 44W.

Sioux County, 1/4 Miles east from Orange City  
(direction)

more specifically described as follows: Drives are to be located appx. 3668 & 3768 ft. east of the NW cor. Sec. 4-94-44, Sioux Co., at Highway stations 44+00 and 45+00.

SKETCH MAP (Show intersection, entrance and property line details and dimensions)

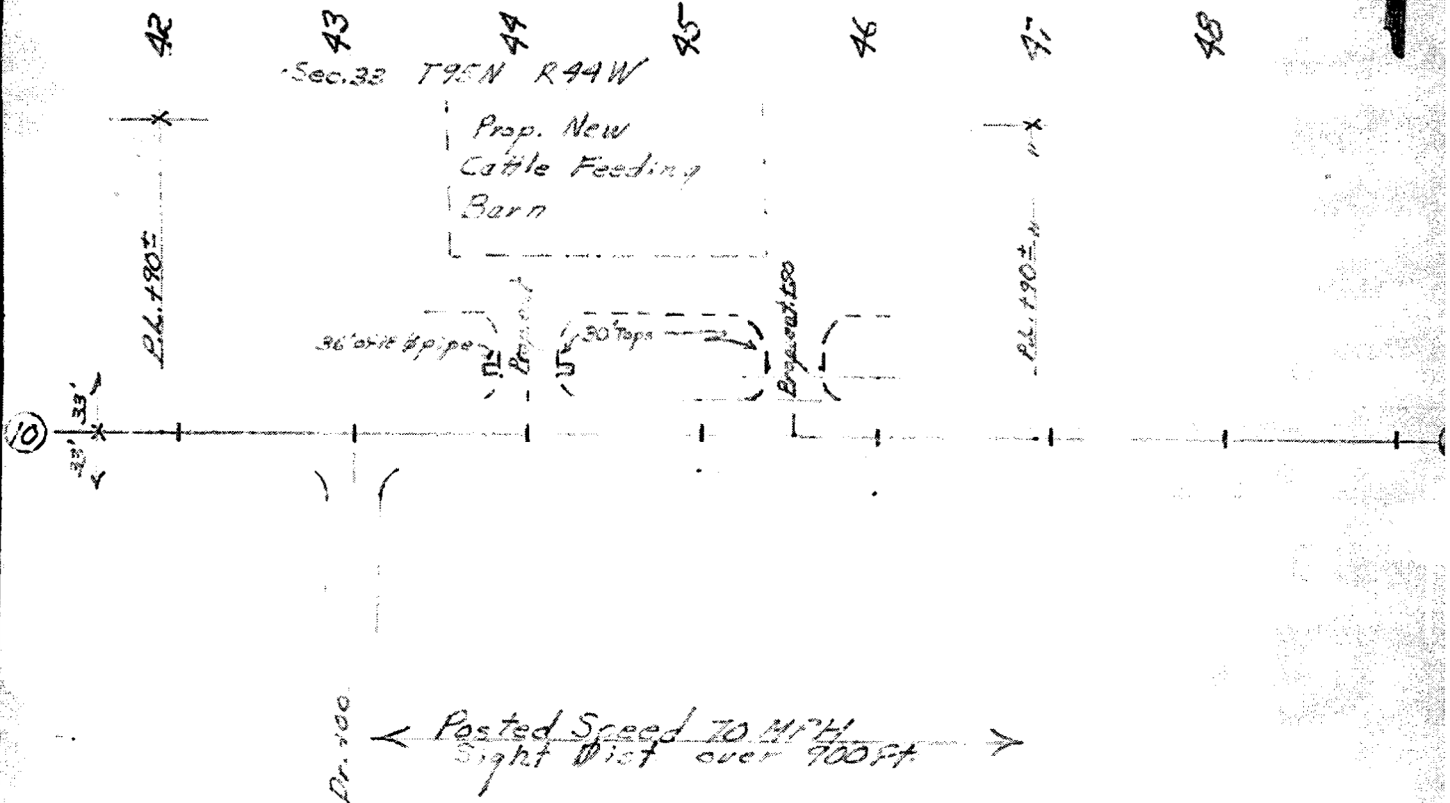

Scale 1"=100'

NOTE: The sketch shall include section of road of sufficient length to show the existing public roads on both sides and location of all accesses within the area which have previously been approved, including all special road connections.

CERTIFICATION

I hereby certify that this sketch was prepared by me or under my direct personal supervision and that I am a duly registered professional engineer under the laws of the State of Iowa.

Patrick H. Wata  
(Signature)  
Date July 10, 1972 Iowa Reg. No. 4446

APPLICANT

Name Robert Wassenaar  
By Robert Wassenaar  
(Signature)  
Address Orange City, IA

Date July 10, 1972