

| Parcel Information | |
|--------------------------|--|
| Parcel ID | 760022097 |
| Links | Photo #1 Sketch #1 |
| Map Number | 3923-00-0-20100-000-0430 |
| Cadastral # | 005-033-0048 |
| Current Owner | WANEK, CHRISTINE L |
| Mailing Address | 324 WEST 5TH PO BOX 351 WILBER, NE 68465- |
| Situs Address | 324 WEST 5TH STREET |
| Tax District | 10 |
| Tax ID | 005-033-0048 |
| School District | WILBER-CLATONIA 82 |
| Neighborhood | 9050 |
| Property Class | Single Family |
| Lot Width x Depth | 66 x 132 |
| Legal Description | WILBER CITY ALL LOT 410 & W 1/2 OF LOT 411 |

| Assessed Values | | | | |
|-----------------|-----------|----------|--------------|--------------|
| Year | Total | Land | Improvements | Outbuildings |
| 2018 | \$192,525 | \$13,700 | \$178,825 | \$0 |

| 2017 Tax Information | |
|----------------------|------------|
| Taxes | \$2,402.76 |
| Tax Levy | 1.900133 |

| 2017 Tax Levy | |
|-------------------------|----------|
| Description | Rate |
| AGRICULTURE SOC. | 0.004433 |
| CT HOUSE BOND (2015) | 0.010442 |
| ED SERV. UNIT #6 | 0.015870 |
| HISTORICAL SOC. | 0.000984 |
| JAIL BOND | 0.017700 |
| LOWER B BLUE NRD | 0.024370 |
| SALINE COUNTY | 0.265351 |
| SE COMM COLLEGE | 0.090700 |
| WILB CLAT AFFIL BD 2003 | 0.002507 |
| WILB CLAT BD K-6 2003 | 0.060065 |
| WILBER CITY | 0.409905 |
| WILBER CITY BOND | 0.040223 |
| WILBER-CLATONIA 82 | 0.957583 |

| 5 Year Sales History |
|---|
| No previous sales information is available. |

| Property Classification | | | |
|-------------------------|---------------|-------------------|-----------------|
| Status: | Improved | Location: | Urban |
| Property Class: | Single Family | City Size: | 800-2,500 |
| Zoning: | Single Family | Lot Size: | <10,000 sq. ft. |

| Land Information | | | | |
|------------------|-----------|--------------|------------|-----------|
| Lot Width | Lot Depth | Value Method | # of Units | Lot Value |
| 66 | 132 | Sq ft. | 8712 | 13700 |

| Historical Valuation Information | | | | | | | |
|----------------------------------|-------------------|----------|-----------|---------|-----------|-----------|------------|
| Year | Billed Owner | Land | Impr | Outbldg | Total | Taxable | Taxes |
| 2017 | WANEK/CHRISTINE L | \$11,110 | \$121,480 | \$0 | \$132,590 | \$132,590 | \$2,402.76 |
| 2016 | WANEK/CHRISTINE L | \$11,110 | \$121,480 | \$0 | \$132,590 | \$132,590 | \$2,348.76 |
| 2015 | WANEK/CHRISTINE L | \$11,110 | \$121,480 | \$0 | \$132,590 | \$132,590 | \$2,231.04 |
| 2014 | WANEK/CHRISTINE L | \$11,110 | \$121,480 | \$0 | \$132,590 | \$132,590 | \$2,343.90 |
| 2013 | WANEK/CHRISTINE L | \$11,110 | \$126,540 | \$0 | \$137,650 | \$137,650 | \$2,705.24 |

| Residential Datasheet | | | |
|----------------------------|-----------------------|----------------------|---------------------------|
| Type | Single-Family | Heat Type | 100 % WARM & COOLED AIR & |
| Quality / Condition | 35 Average+ / 40 Good | Foundation | Concrete Block/8 |
| Arch. Type | | Slab Area | 0 sq. ft |
| Year Built | 1924 | Crawl Area | 0 sq. ft |
| Actual Age | 94 | Basement Area | 2026sq. ft. |
| Ext. Wall 1 | 100 % VINYL | Min Finish | |
| Ext. Wall 2 | | Rec Finish | |
| Base Area | 2,026 sq. ft | Part Finish | 1,823 sq. ft |
| Total Area | 2,742 sq. ft | Bedrooms | 5 |
| Style 1 | | Bathrooms | 4 |
| Style 2 | | Garage Type | ATTACHED |
| Roof Type | COMP SHINGLES | Garage Area | 784 sq. ft |

| Miscellaneous Improvements | | |
|----------------------------|------|-------|
| Improvement | Year | Units |
| CONCRETE DRIVE | | 560 |
| CARPORT FT-RF | | 448 |
| UNDRGRND LAWN~SPRKLR | | 5227 |
| ROOFED VINYL DK | | 40 |
| DECK VINYL | | 336 |
| DECK VINYL | | 24 |

Photo/Sketch

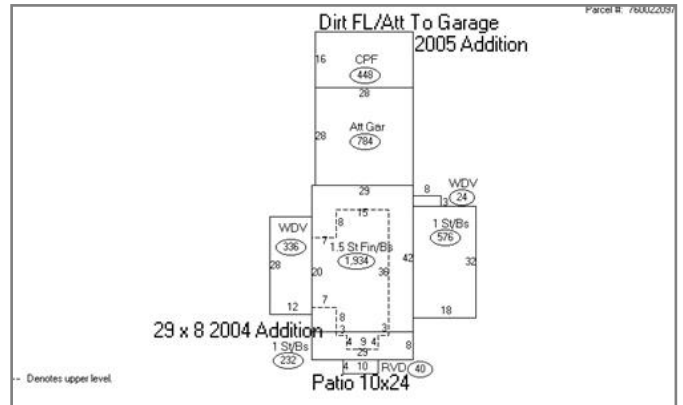

Tax Statement

Served by **WEBSERVER-TWO**

Saline County

0 **Step 4 of 8**

| | | |
|-----------------------------|--|--|
| Perm ID 760022097 | Name WANEK,CHRISTINE L 324 WEST 5TH PO BOX 351 WILBER, NE 68465 | Legal WILBER CITY ALL LOT 410 & W 1/2 OF LOT 411 324 \ WEST 5TH STREET |
|-----------------------------|--|--|

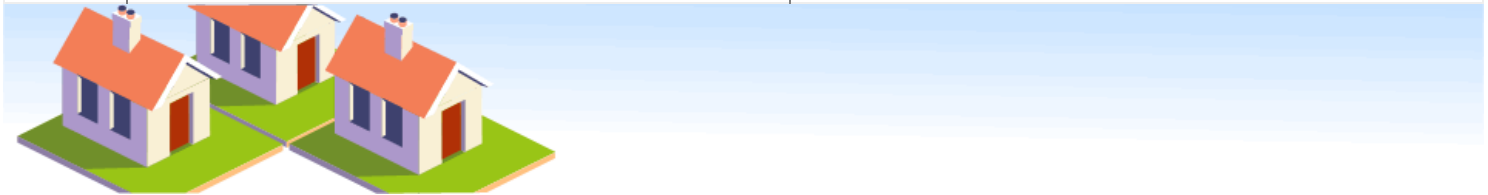

[Levy Graph](#)
[Value Graph](#)
[Tax Graph](#)

| Year | Statement | Value | Tax | Exemption | Net Tax | Balance Due |
|------|------------------------|------------|-------------|-------------|-------------|-------------|
| 2017 | 009205 | \$ 132,590 | \$ 2,519.38 | - \$ 116.62 | \$ 2,402.76 | \$ 1,201.38 |
| 2016 | 009163 | \$ 132,590 | \$ 2,467.52 | - \$ 118.76 | \$ 2,348.76 | \$ 0.00 |
| 2015 | 009098 | \$ 132,590 | \$ 2,355.80 | - \$ 124.76 | \$ 2,231.04 | \$ 0.00 |
| 2014 | 009067 | \$ 132,590 | \$ 2,438.76 | - \$ 94.86 | \$ 2,343.90 | \$ 0.00 |
| 2013 | 009056 | \$ 137,650 | \$ 2,796.04 | - \$ 90.80 | \$ 2,705.24 | \$ 0.00 |
| 2012 | 009054 | \$ 137,650 | \$ 2,801.20 | - \$ 98.42 | \$ 2,702.78 | \$ 0.00 |
| 2011 | 009034 | \$ 144,075 | \$ 2,999.02 | - \$ 108.50 | \$ 2,890.52 | \$ 0.00 |
| 2010 | 009052 | \$ 138,880 | \$ 2,881.00 | - \$ 109.60 | \$ 2,771.40 | \$ 0.00 |
| 2009 | 009042 | \$ 138,880 | \$ 2,900.10 | - \$ 114.18 | \$ 2,785.92 | \$ 0.00 |
| 2008 | 009022 | \$ 144,290 | \$ 3,105.10 | - \$ 124.28 | \$ 2,980.82 | \$ 0.00 |
| 2007 | 008999 | \$ 144,290 | \$ 3,137.92 | - \$ 120.08 | \$ 3,017.84 | \$ 0.00 |
| 2006 | 008921 | \$ 144,290 | \$ 3,184.90 | \$ 0.00 | \$ 3,184.90 | \$ 0.00 |
| 2005 | 008841 | \$ 98,645 | \$ 2,272.70 | \$ 0.00 | \$ 2,272.70 | \$ 0.00 |
| 2004 | 006589 | \$ 65,490 | \$ 1,525.12 | \$ 0.00 | \$ 1,525.12 | \$ 0.00 |
| 2003 | 002572 | \$ 65,490 | \$ 1,496.26 | \$ 0.00 | \$ 1,496.26 | \$ 0.00 |
| 2002 | 001812 | \$ 58,415 | \$ 1,217.94 | \$ 0.00 | \$ 1,217.94 | \$ 0.00 |
| 2001 | 008655 | \$ 58,415 | \$ 1,181.12 | \$ 0.00 | \$ 1,181.12 | \$ 0.00 |
| 2000 | 008608 | \$ 58,415 | \$ 1,197.34 | - \$ 17.84 | \$ 1,179.50 | \$ 0.00 |
| 1999 | 008579 | \$ 58,415 | \$ 1,163.86 | \$ 0.00 | \$ 1,163.86 | \$ 0.00 |
| 1998 | 002528 | \$ 58,415 | \$ 1,213.08 | \$ 0.00 | \$ 1,213.08 | \$ 0.00 |
| 1997 | 007503 | \$ 57,221 | \$ 1,377.68 | \$ 0.00 | \$ 1,377.68 | \$ 0.00 |
| 1996 | 006972 | \$ 55,293 | \$ 1,260.50 | \$ 0.00 | \$ 1,260.50 | \$ 0.00 |

The information provided in this site is the most recent and most accurate data available. All information contained herein is for informational purposes only. MIPS Inc does not warrant that such information is accurate and error free. This information is provided on an "as is" basis without warranties of any kind, either expressed or implied, including, but not limited to, the implied warranties of merchantability or fitness for a particular purpose. MIPS Inc shall not be liable for any direct, indirect, incidental, special or consequential damages arising out of the use of such information or the inability to use such information. MIPS also is not, nor shall be party to or subject to any warranty or any breach of any kind. The User acknowledges and agrees that the use of such information is at the sole risk of the User.

Copyright © 2004 Nebraska Association of County Officials. All rights reserved.