

Parcel Information	
<b>Parcel ID</b>	760041997
<b>Links</b>	<a href="#">Photo #1</a> <a href="#">Sketch #1</a>
<b>Map Number</b>	3981-00-0-80100-006-0003
<b>Cadastral #</b>	005-013-0007
<b>Current Owner</b>	RISCHLING, DEBRA J ETAL
<b>Mailing Address</b>	PO BOX 398 WESTERN, NE 68464-
<b>Situs Address</b>	103 NORTH EAST AVENUE
<b>Tax District</b>	49
<b>Tax ID</b>	005-013-0007
<b>School District</b>	MERIDIAN
<b>Neighborhood</b>	8100
<b>Property Class</b>	Single Family
<b>Lot Width x Depth</b>	100 x 140
<b>Legal Description</b>	WESTERN VILLAGE LOTS 6-7-8-9 BLK 6

Assessed Values				
Year	Total	Land	Improvements	Outbuildings
2018	\$43,170	\$1,630	\$41,540	\$0

2017 Tax Information	
<b>Taxes</b>	\$593.32
<b>Tax Levy</b>	1.462326

2017 Tax Levy	
Description	Rate
AGRICULTURE SOC.	0.004433
CT HOUSE BOND (2015)	0.010442
ED SERV. UNIT #5	0.015816
HISTORICAL SOC.	0.000984
JAIL BOND	0.017700
LOWER B BLUE NRD	0.024370
MERIDIAN	0.533688
SALINE COUNTY	0.265351
SE COMM COLLEGE	0.090700
WESTERN VILLAGE	0.498842

5 Year Sales History
No previous sales information is available.

Property Classification			
<b>Status:</b>	Improved	<b>Location:</b>	Urban
<b>Property Class:</b>	Single Family	<b>City Size:</b>	101-799

<b>Zoning:</b>	Single Family	<b>Lot Size:</b>	10,000-20,000 sq. ft.
----------------	---------------	------------------	-----------------------

Land Information				
Lot Width	Lot Depth	Value Method	# of Units	Lot Value
100	140	Sq ft.	14000	1630

Historical Valuation Information							
Year	Billed Owner	Land	Impr	Outbldg	Total	Taxable	Taxes
2017	RISCHLING/JAMES E	\$1,630	\$41,540	\$0	\$43,170	\$43,170	\$593.32
2016	RISCHLING/JAMES E	\$1,630	\$41,540	\$0	\$43,170	\$43,170	\$559.44
2015	RISCHLING/JAMES E	\$1,630	\$41,540	\$0	\$43,170	\$43,170	\$630.56
2014	RISCHLING/JAMES E	\$1,630	\$42,255	\$0	\$43,885	\$43,885	\$690.56
2013	RISCHLING/JAMES E	\$1,630	\$39,125	\$0	\$40,755	\$40,755	\$731.52

Residential Datasheet			
<b>Type</b>	Single-Family	<b>Heat Type</b>	100 % WARM & COOLED AIR &
<b>Quality / Condition</b>	30 Average / 30 Average	<b>Foundation</b>	Concrete Block/8
<b>Arch. Type</b>		<b>Slab Area</b>	0 sq. ft
<b>Year Built</b>	1909	<b>Crawl Area</b>	0 sq. ft
<b>Actual Age</b>	109	<b>Basement Area</b>	756sq. ft.
<b>Ext. Wall 1</b>	50 % SIDING	<b>Min Finish</b>	
<b>Ext. Wall 2</b>	50 % VINYL	<b>Rec Finish</b>	
<b>Base Area</b>	1,724 sq. ft	<b>Part Finish</b>	
<b>Total Area</b>	2,172 sq. ft	<b>Bedrooms</b>	4
<b>Style 1</b>		<b>Bathrooms</b>	2
<b>Style 2</b>		<b>Garage Type</b>	
<b>Roof Type</b>	COMP SHINGLES	<b>Garage Area</b>	

Miscellaneous Improvements		
Improvement	Year	Units
old garage df av 14x18		252
old garage cf av 16x24		384
SOLID WALL PORCH		208
COVERED RAISED OPEN		160
WD DECK PINE		276
cl shed df av		48

**Photo/Sketch**

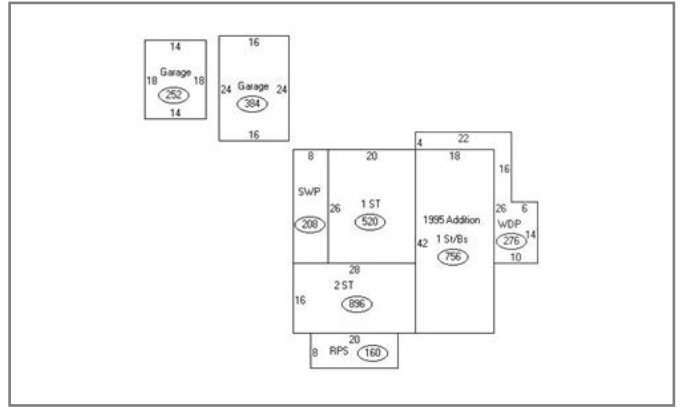

## Tax Statement

Served by WEBSERVER-ONE

## Saline County

Step 4 of 8

<b>Perm ID</b> 760041997	<b>Name</b> RISCHLING,JAMES E (LF EST) DEBRA J RISCHLING ETA PO BOX 398 WESTERN, NE 68464	<b>Legal</b> WESTERN VILLAGE LOTS 6-7-8-9 BLK 6 103 \ NORTH EAST AVENUE
-----------------------------	---	---



[Levy Graph](#) 
[Value Graph](#) 
[Tax Graph](#) 

Year	Statement	Value	Tax	Exemption	Net Tax	Balance Due
2017	<a href="#">007113</a>	\$ 43,170	\$ 631.28	- \$ 37.96	\$ 593.32	\$ 296.66
2016	<a href="#">007068</a>	\$ 43,170	\$ 598.10	- \$ 38.66	\$ 559.44	\$ 0.00
2015	<a href="#">007008</a>	\$ 43,170	\$ 671.18	- \$ 40.62	\$ 630.56	\$ 0.00
2014	<a href="#">006990</a>	\$ 43,885	\$ 721.96	- \$ 31.40	\$ 690.56	\$ 0.00
2013	<a href="#">006952</a>	\$ 40,755	\$ 758.40	- \$ 26.88	\$ 731.52	\$ 0.00
2012	<a href="#">006952</a>	\$ 46,090	\$ 958.34	- \$ 32.96	\$ 925.38	\$ 0.00
2011	<a href="#">006930</a>	\$ 48,930	\$ 1,044.30	- \$ 36.84	\$ 1,007.46	\$ 0.00
2010	<a href="#">006949</a>	\$ 48,930	\$ 1,061.10	- \$ 38.62	\$ 1,022.48	\$ 0.00
2009	<a href="#">006945</a>	\$ 48,930	\$ 1,050.02	- \$ 40.24	\$ 1,009.78	\$ 0.00
2008	<a href="#">006954</a>	\$ 50,505	\$ 1,119.70	- \$ 43.50	\$ 1,076.20	\$ 0.00
2007	<a href="#">006934</a>	\$ 55,470	\$ 1,168.00	- \$ 46.16	\$ 1,121.84	\$ 0.00
2006	<a href="#">006848</a>	\$ 64,395	\$ 1,359.34	\$ 0.00	\$ 1,359.34	\$ 0.00
2005	<a href="#">006759</a>	\$ 64,395	\$ 1,331.36	\$ 0.00	\$ 1,331.36	\$ 0.00
2004	<a href="#">008622</a>	\$ 58,475	\$ 1,184.88	\$ 0.00	\$ 1,184.88	\$ 0.00
2003	<a href="#">005215</a>	\$ 58,475	\$ 1,196.22	\$ 0.00	\$ 1,196.22	\$ 0.00
2002	<a href="#">003425</a>	\$ 42,700	\$ 923.38	\$ 0.00	\$ 923.38	\$ 0.00
2001	<a href="#">006588</a>	\$ 42,700	\$ 871.20	\$ 0.00	\$ 871.20	\$ 0.00
2000	<a href="#">006577</a>	\$ 42,700	\$ 887.22	- \$ 13.04	\$ 874.18	\$ 0.00
1999	<a href="#">006588</a>	\$ 42,700	\$ 887.32	\$ 0.00	\$ 887.32	\$ 0.00
1998	<a href="#">000292</a>	\$ 42,700	\$ 942.20	\$ 0.00	\$ 942.20	\$ 0.00
1997	<a href="#">001300</a>	\$ 38,872	\$ 988.36	\$ 0.00	\$ 988.36	\$ 0.00
1996	<a href="#">004594</a>	\$ 38,872	\$ 969.40	\$ 0.00	\$ 969.40	\$ 0.00

The information provided in this site is the most recent and most accurate data available. All information contained herein is for informational purposes only. MIPS Inc does not warrant that such information is accurate and error free. This information is provided on an "as is" basis without warranties of any kind, either expressed or implied, including, but not limited to, the implied warranties of merchantability or fitness for a particular purpose. MIPS Inc shall not be liable for any direct, indirect, incidental, special or consequential damages arising out of the use of such information or the inability to use such information. MIPS also is not, nor shall be party to or subject to any warranty or any breach of any kind. The User acknowledges and agrees that the use of such information is at the sole risk of the User.

Copyright © 2004 Nebraska Association of County Officials. All rights reserved.

Parcel Information	
<b>Parcel ID</b>	760042012
<b>Links</b>	<a href="#">Photo #1</a>
<b>Map Number</b>	3981-00-0-80100-006-0005
<b>Cadastral #</b>	005-013-0010
<b>Current Owner</b>	RISCHLING, DEBRA J ETAL
<b>Mailing Address</b>	PO BOX 398 WESTERN, NE 68464-
<b>Situs Address</b>	SUMNER STREET
<b>Tax District</b>	49
<b>Tax ID</b>	005-013-0010
<b>School District</b>	MERIDIAN
<b>Neighborhood</b>	8000
<b>Property Class</b>	Single Family
<b>Lot Width x Depth</b>	50 x 75
<b>Legal Description</b>	WESTERN VILLAGE W 1/2 OF LOTS 10-11-12 BLK 6

Assessed Values				
Year	Total	Land	Improvements	Outbuildings
2018	\$565	\$565	\$0	\$0

2017 Tax Information	
<b>Taxes</b>	\$7.76
<b>Tax Levy</b>	1.462326

2017 Tax Levy	
Description	Rate
AGRICULTURE SOC.	0.004433
CT HOUSE BOND (2015)	0.010442
ED SERV. UNIT #5	0.015816
HISTORICAL SOC.	0.000984
JAIL BOND	0.017700
LOWER B BLUE NRD	0.024370
MERIDIAN	0.533688
SALINE COUNTY	0.265351
SE COMM COLLEGE	0.090700
WESTERN VILLAGE	0.498842

5 Year Sales History
No previous sales information is available.

Property Classification			
<b>Status:</b>	Unimproved	<b>Location:</b>	Urban
<b>Property Class:</b>	Single Family	<b>City Size:</b>	101-799

<b>Zoning:</b>	Single Family	<b>Lot Size:</b>	<10,000 sq. ft.
----------------	---------------	------------------	-----------------

Land Information				
Lot Width	Lot Depth	Value Method	# of Units	Lot Value
50	75	Sq ft.	3750	565

Historical Valuation Information							
Year	Billed Owner	Land	Impr	Outbldg	Total	Taxable	Taxes
2017	RISCHLING/JAMES E	\$565	\$0	\$0	\$565	\$565	\$7.76
2016	RISCHLING/JAMES E	\$565	\$0	\$0	\$565	\$565	\$7.32
2015	RISCHLING/JAMES E	\$565	\$0	\$0	\$565	\$565	\$8.24
2014	RISCHLING/JAMES E	\$565	\$0	\$0	\$565	\$565	\$8.90
2013	RISCHLING/JAMES E	\$565	\$0	\$0	\$565	\$565	\$10.14

Residential Datasheet			
<b>Type</b>		<b>Heat Type</b>	100 % &
<b>Quality / Condition</b>		<b>Foundation</b>	
<b>Arch. Type</b>		<b>Slab Area</b>	
<b>Year Built</b>		<b>Crawl Area</b>	
<b>Actual Age</b>	N/A	<b>Basement Area</b>	sq. ft.
<b>Ext. Wall 1</b>		<b>Min Finish</b>	
<b>Ext. Wall 2</b>		<b>Rec Finish</b>	
<b>Base Area</b>		<b>Part Finish</b>	
<b>Total Area</b>		<b>Bedrooms</b>	
<b>Style 1</b>		<b>Bathrooms</b>	
<b>Style 2</b>		<b>Garage Type</b>	
<b>Roof Type</b>		<b>Garage Area</b>	

**Photo/Sketch**



8/15/2018

Saline County Assessor

**Tax Statement**

Served by WEBSERVER-ONE

**Saline County**

0 Step 4 of 8

<b>Perm ID</b> 760042012	<b>Name</b> RISCHLING,JAMES E (LF EST) DEBRA J RISCHLING ETA PO BOX 398 WESTERN, NE 68464	<b>Legal</b> WESTERN VILLAGE W 1/2 OF LOTS 10-11-12 BLK 6 \ SUMNER STREET
-----------------------------	---	--



[Levy Graph](#)
[Value Graph](#)
[Tax Graph](#)

Year	Statement	Value	Tax	Exemption	Net Tax	Balance Due
2017	<a href="#">007114</a>	\$ 565	\$ 8.26	- \$ 0.50	\$ 7.76	\$ 3.88
2016	<a href="#">007069</a>	\$ 565	\$ 7.82	- \$ 0.50	\$ 7.32	\$ 0.00
2015	<a href="#">007009</a>	\$ 565	\$ 8.78	- \$ 0.54	\$ 8.24	\$ 0.00
2014	<a href="#">006991</a>	\$ 565	\$ 9.30	- \$ 0.40	\$ 8.90	\$ 0.00
2013	<a href="#">006953</a>	\$ 565	\$ 10.52	- \$ 0.38	\$ 10.14	\$ 0.00
2012	<a href="#">006953</a>	\$ 565	\$ 11.74	- \$ 0.40	\$ 11.34	\$ 0.00
2011	<a href="#">006931</a>	\$ 565	\$ 12.06	- \$ 0.42	\$ 11.64	\$ 0.00
2010	<a href="#">006950</a>	\$ 565	\$ 12.26	- \$ 0.44	\$ 11.82	\$ 0.00
2009	<a href="#">006946</a>	\$ 565	\$ 12.12	- \$ 0.46	\$ 11.66	\$ 0.00
2008	<a href="#">006956</a>	\$ 565	\$ 12.52	- \$ 0.48	\$ 12.04	\$ 0.00
2007	<a href="#">006936</a>	\$ 265	\$ 5.58	- \$ 0.22	\$ 5.36	\$ 0.00
2006	<a href="#">006850</a>	\$ 265	\$ 5.60	\$ 0.00	\$ 5.60	\$ 0.00
2005	<a href="#">006761</a>	\$ 265	\$ 5.48	\$ 0.00	\$ 5.48	\$ 0.00
2004	<a href="#">008624</a>	\$ 225	\$ 4.56	\$ 0.00	\$ 4.56	\$ 0.00
2003	<a href="#">005217</a>	\$ 225	\$ 4.60	\$ 0.00	\$ 4.60	\$ 0.00
2002	<a href="#">003427</a>	\$ 225	\$ 4.86	\$ 0.00	\$ 4.86	\$ 0.00
2001	<a href="#">006590</a>	\$ 225	\$ 4.60	\$ 0.00	\$ 4.60	\$ 0.00
2000	<a href="#">006579</a>	\$ 225	\$ 4.68	- \$ 0.06	\$ 4.62	\$ 0.00
1999	<a href="#">006590</a>	\$ 225	\$ 4.68	\$ 0.00	\$ 4.68	\$ 0.00
1998	<a href="#">000296</a>	\$ 225	\$ 4.96	\$ 0.00	\$ 4.96	\$ 0.00
1997	<a href="#">001302</a>	\$ 225	\$ 5.72	\$ 0.00	\$ 5.72	\$ 0.00
1996	<a href="#">004596</a>	\$ 225	\$ 5.62	\$ 0.00	\$ 5.62	\$ 0.00

The information provided in this site is the most recent and most accurate data available. All information contained herein is for informational purposes only. MIPS Inc does not warrant that such information is accurate and error free. This information is provided on an "as is" basis without warranties of any kind, either expressed or implied, including, but not limited to, the implied warranties of merchantability or fitness for a particular purpose. MIPS Inc shall not be liable for any direct, indirect, incidental, special or consequential damages arising out of the use of such information or the inability to use such information. MIPS also is not, nor shall be party to or subject to any warranty or any breach of any kind. The User acknowledges and agrees that the use of such information is at the sole risk of the User.

Copyright © 2004 Nebraska Association of County Officials. All rights reserved.