

the Southwest Quarter; thence westerly on said North Line a distance of 326.4 feet to the northwest corner of said East Half of the Southwest Quarter; thence southerly on the West Line of said East Half of the Southwest Quarter a distance of 2,645.0 feet to the southwest corner of said East Half of the Southwest Quarter; thence easterly on the South Line of said East Half of the Southwest Quarter a distance of 1,325.5 feet to the point of beginning, containing 38.82 acres, more or less, which includes 2.36 acres, more or less, previously occupied as a public highway, the remaining 36.46 acres, more or less, being the additional acreage hereby secured.

There will be no ingress and egress from the above described tract onto the remaining portion of said East Half of the Southwest Quarter, except onto relocated 102nd Street.

To have and to hold the premises above described, together with all the Tenements, Hereditaments and Appurtenances thereunto belonging, unto the State of Nebraska and to its successors and assigns forever.

In witness whereof, the said W. D. Hosford, Jr. and Kathryn H. Hamilton, Tenants in Common; Mary H. Hosford, wife of W. D. Hosford and Frank T. Hamilton, husband of Kathryn H. Hamilton has hereunto set hand this _____ day of _____, 19 _____.

X W. D. Hosford, Jr.
X Mary H. Hosford
X Kathryn H. Hamilton Frank T. Hamilton

The State of Nebraska, hereby assents, agrees, and joins in said correction.

STATE OF NEBRASKA

W. M. Mempel
Right of Way Engineer

STATE OF Nebraska)
Douglas County)

On this 17 day of December, A.D., 1966, before me, the undersigned Thomas R. Henshaw a Notary Public, duly commissioned and qualified for and residing in said County, personally came

W. D. Hosford, Jr. and Mary H. Hosford, husband and wife the identical persons whose names are affixed to the foregoing instrument and acknowledged the same to be their voluntary act and deed.

Witness my hand and Notarial Seal the day and year last above written.

Thomas R. Henshaw
Notary Public

My Commission expires the 6 day of October, 1968.

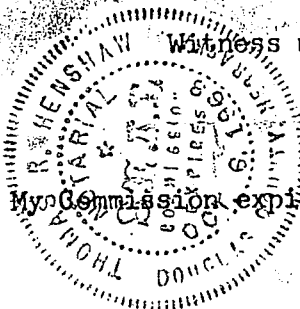

STATE OF OHIO)
HAMILTON County) ss.

On this 7TH day of DECEMBER, A.D., 1966.

WILLIAM J. CONNOR

before me, the undersigned _____

a Notary Public, duly commissioned and qualified for an residing in
said County, personally came Kathryn H. Hamilton and Frank T. Hamilton
_____ Wife and Husband

to me known to be the identical person s whose names are _____
affixed to the foregoing instrument as grantor s and acknowledged the
same to be _____ their _____ voluntary act and deed.

WITNESS my hand and Notarial Seal the day and year last

above written.

William J. Connor Notary Public
My commission expires the _____ day of _____, 19__.

WILLIAM J. CONNOR

Notary Public, Hamilton County, Ohio
My Commission Expires Mar. 13, 1968



326.4'

373.7'

174+59.7
175.2

1/4 Sec Line
998.6'

90°20'

91°28'

89°30'

802.0
798.1

3°51'

0°09'

27+16.77 R9'
120°

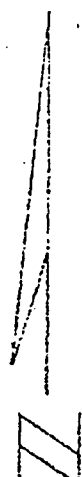

444.6'

1936.6'

(FOUND)

22+46.77 R9'
120°
7°56'

RE 1025.92

19+14.10 R9'
120°

120°59'

112°57'

15+20.00 R9'
120°

16+00.00 R9'
33' 47" C

140°

725.5-1416.7 C
60°

710.7

61°00'

68.2

132.55

31

39

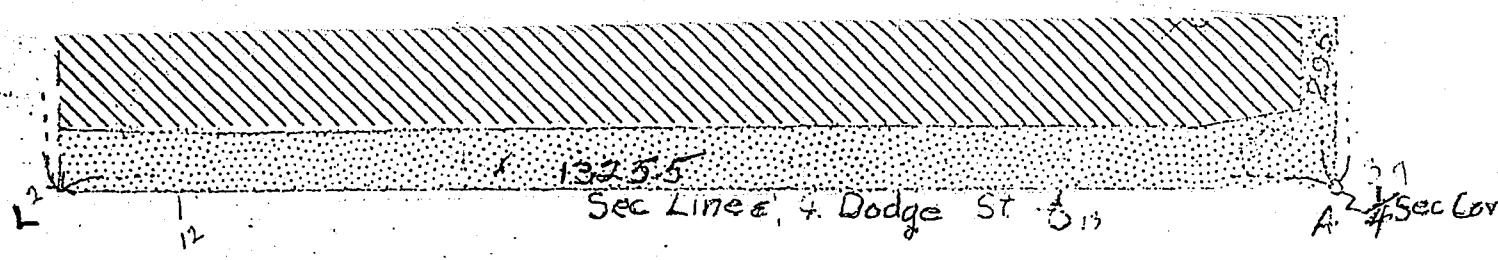

Scale: 1" = 200'

PROJ. I-B80 9(31)

A.F.E R-856a

TRACT 164

W. D. HOSFORD, JR & KATHRYN H. HAMILTON, T.C.
 E 1/2 SW 1/4 Sec 16-15-12 E
 Douglas Co.

	Old R.O.W.
	New R.O.W.
	Controlled Access
	Non-Controlled

Total Acreage	39.82 ac.
Previous Acreage	2.36 ac.
Additional Acreage	36.46 ac.

Drwn by	W.C.F.
Ckd by	ALF
Wrl'n by	W.C.R. 11/2
Ckd. by	F.B.H. 11/2

RIGHT OF WAY for STATE OF NEBRASKA, DEPT. OF ROADS, LINCOLN, NEBRASKA

I-580-9(31) R-857a

Deed of Conveyance

W. A. Hoeford, Jr.,
et. al.

to
State of Nebraska

Douglas County

13

Deed RECEIVED

1967 FEB 1 AM 11 13

THOMAS J. O'CONNOR
REGISTER OF DEEDS
DOUGLAS COUNTY, NEBR.

INDEXED
FILED
Entered in Computer Index and filed
for Record in the Office of the Register of
Deeds of said County and recorded in
Book 1309 of Deeds
Page 303

Handwritten signature

By _____ Deputy
M. A. Dept of Property
Lincoln, Neb.
CORRECTED
CORRECTED 16-15-72 925

16-15-72