

Parcel Information	
Parcel ID	010956000
Links	Photo #1 Photo #2 Photo #3 Sketch #1
Map Number	-00-0-10185-000-0000
Cadastral #	2002-0638
Current Owner	BARTLETT, BILL D JR
Mailing Address	611 N 9TH ST BEATRICE NE 68310-0000
Situs Address	00611 N 9TH
Tax District	157
School District	SCH 15 BEATRICE
Neighborhood	30
Property Class	Single Family
Lot Width x Depth	50 x 140
Legal Description	LOT 4 BLK 13 CROPSEYS ADD

Assessed Values				
Year	Total	Land	Improvements	Outbuildings
2017	\$62,555	\$9,800	\$52,755	\$0

2017 Tax Information	
Taxes	\$1,156.84
Tax Levy	1.937257

2017 Tax Levy	
Description	Rate
AGRICULTURE	0.004182
AIRPORT GENERAL	0.035031
BEATRICE CITY	0.381447
BIG BLUE NRD	0.024370
COUNTY GENERAL	0.297594
ESU #5	0.015816
HISTORICAL	0.000960
SCC GENERAL	0.090700
SCH 15 BEATRICE	1.087157

5 Year Sales History
No previous sales information is available.

Property Classification			
Status:	Improved	Location:	Urban
Property Class:	Single Family	City Size:	No Population
Zoning:	N/A	Lot Size:	N/A

Land Information				
Lot Width	Lot Depth	Value Method	# of Units	Lot Value
50	140	Sq. ft.	7000	9800

Historical Valuation Information							
Year	Billed Owner	Land	Impr	Outbldg	Total	Taxable	Taxes
2017	BARTLETT, BILL D JR	\$9,800	\$52,755	\$0	\$62,555	\$62,555	\$1,156.84
2016	BARTLETT, BILL D JR	\$9,800	\$47,960	\$0	\$57,760	\$57,760	\$1,053.50
2015	BARTLETT, BILL D JR	\$9,800	\$47,960	\$0	\$57,760	\$57,760	\$1,088.64
2014	BARTLETT, BILL D JR	\$9,800	\$47,960	\$0	\$57,760	\$57,760	\$1,124.82
2013	BARTLETT, BILL D JR	\$9,800	\$47,960	\$0	\$57,760	\$57,760	\$1,141.50

Residential Datasheet			
Type	Single-Family	Heat Type	100 % REV HEAT PUMP W/DUCT &
Quality / Condition	20 Fair / 20 Fair	Foundation	
Arch. Type	2 STORY	Slab Area	
Year Built	1910	Crawl Area	
Actual Age	108	Basement Area	400sq. ft.
Ext. Wall 1	100 % SIDING	Min Finish	
Ext. Wall 2		Rec Finish	
Base Area	720 sq. ft	Part Finish	
Total Area	1,440 sq. ft	Bedrooms	4
Style 1	100% Two-Story	Bathrooms	2
Style 2		Garage Type	DETACHED
Roof Type	COMP SHINGLES	Garage Area	560 sq. ft

Miscellaneous Improvements		
Improvement	Year	Units
SLAB W/ROOF &~STEPS		128

Photo/Sketch

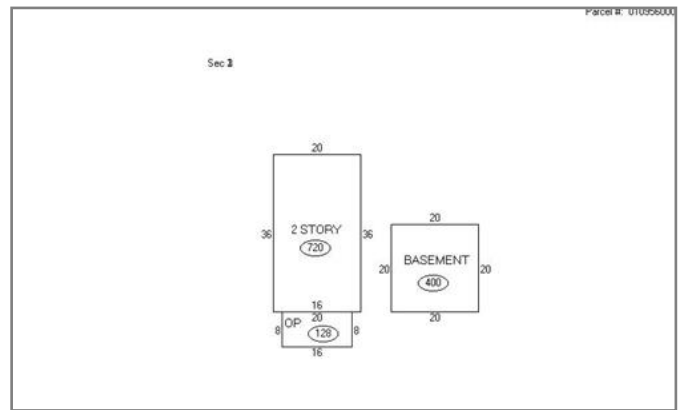

Tax Statement

Served by WEBSERVER-ONE

Gage County

Step 4 of 8

Perm ID 010956000	Name BARTLETT, BILL D JR 611 N 9TH ST BEATRICE NE 68310	Legal LOT 4 BLK 13 CROPSEYS ADD 00611 \N 9TH
-----------------------------	---	---



- Levy Graph
- Value Graph
- Tax Graph

Year	Statement	Value	Tax	Exemption	Net Tax	Balance Due
2017	011743	\$ 62,555	\$ 1,211.86	- \$ 55.02	\$ 1,156.84	\$ 1,156.84
2016	011689	\$ 57,760	\$ 1,105.24	- \$ 51.74	\$ 1,053.50	\$ 526.75
2015	011664	\$ 57,760	\$ 1,142.98	- \$ 54.34	\$ 1,088.64	\$ 0.00
2014	011657	\$ 57,760	\$ 1,166.14	- \$ 41.32	\$ 1,124.82	\$ 0.00
2013	011617	\$ 57,760	\$ 1,179.60	- \$ 38.10	\$ 1,141.50	\$ 0.00
2012	011619	\$ 57,760	\$ 1,196.96	- \$ 41.30	\$ 1,155.66	\$ 0.00
2011	001883	\$ 57,760	\$ 1,196.58	- \$ 43.50	\$ 1,153.08	\$ 0.00
2010	011590	\$ 57,760	\$ 1,195.22	- \$ 45.58	\$ 1,149.64	\$ 0.00
2009	011569	\$ 57,760	\$ 1,183.26	- \$ 47.50	\$ 1,135.76	\$ 0.00
2008	000724	\$ 57,760	\$ 1,183.68	- \$ 49.74	\$ 1,133.94	\$ 0.00
2007	011530	\$ 56,855	\$ 1,173.14	- \$ 47.32	\$ 1,125.82	\$ 0.00
2006	011431	\$ 56,855	\$ 1,111.88	\$ 0.00	\$ 1,111.88	\$ 0.00
2005	009921	\$ 30,795	\$ 614.00	\$ 0.00	\$ 614.00	\$ 0.00
2004	011310	\$ 30,795	\$ 616.28	\$ 0.00	\$ 616.28	\$ 0.00
2003	009792	\$ 30,795	\$ 620.22	\$ 0.00	\$ 620.22	\$ 0.00
2002	011207	\$ 30,350	\$ 606.52	\$ 0.00	\$ 606.52	\$ 0.00
2001	012004	\$ 30,350	\$ 598.54	\$ 0.00	\$ 598.54	\$ 0.00
2000	011971	\$ 29,085	\$ 607.24	- \$ 8.88	\$ 598.36	\$ 0.00
1999	011798	\$ 29,085	\$ 604.90	\$ 0.00	\$ 604.90	\$ 0.00
1998	011748	\$ 29,085	\$ 615.70	\$ 0.00	\$ 615.70	\$ 0.00
1997	011695	\$ 29,085	\$ 656.20	\$ 0.00	\$ 656.20	\$ 0.00
1996	011628	\$ 17,805	\$ 443.80	\$ 0.00	\$ 443.80	\$ 0.00
1995	011546	\$ 17,805	\$ 456.40	\$ 0.00	\$ 456.40	\$ 0.00
1994	010624	\$ 16,335	\$ 398.18	\$ 0.00	\$ 398.18	\$ 0.00
1993	011420	\$ 13,070	\$ 349.22	\$ 0.00	\$ 349.22	\$ 0.00
1992	011066	\$ 13,070	\$ 364.68	\$ 0.00	\$ 364.68	\$ 0.00
1991	010991	\$ 13,070	\$ 356.10	\$ 0.00	\$ 356.10	\$ 0.00
1990	010978	\$ 13,070	\$ 354.04	\$ 0.00	\$ 354.04	\$ 0.00
1989	010077	\$ 13,070	\$ 356.49	\$ 0.00	\$ 356.49	\$ 0.00

The information provided in this site is the most recent and most accurate data available. All information contained herein is for informational purposes only. MIPS Inc does not warrant that such information is accurate and error free. This information is provided on an "as is" basis without warranties of any kind, either expressed or implied, including, but not limited to, the implied warranties of merchantability or fitness for a particular purpose. MIPS Inc shall not be liable for any direct, indirect, incidental, special or consequential damages arising out of the use of such information or the inability to use such information. MIPS also is not, nor shall be party to or subject to any warranty or any breach of any kind. The User acknowledges and agrees that the use of such information is at the sole risk of the User.

Copyright © 2004 Nebraska Association of County Officials. All rights reserved.