



Parcel Information	
<b>Parcel ID</b>	011910000
<b>Links</b>	<a href="#">Photo #1</a> <a href="#">Photo #2</a> <a href="#">Photo #3</a> <a href="#">Photo #4</a> <a href="#">Sketch #1</a>
<b>Map Number</b>	4163-00-0-10310-006-0000
<b>Cadastral #</b>	001-007-064
<b>Current Owner</b>	ROBBINS, DANIEL W
<b>Mailing Address</b>	1400 PARK ST BEATRICE NE 68310-
<b>Situs Address</b>	01400 PARK
<b>Tax District</b>	157
<b>School District</b>	SCH 15 BEATRICE
<b>Neighborhood</b>	30
<b>Property Class</b>	Single Family
<b>Lot Width x Depth</b>	83 x 149
<b>Legal Description</b>	LOT 7 & S 33' LOT 8 BLK 6 GRABLE & BEACHLEYS 2ND ADD

Assessed Values				
Year	Total	Land	Improvements	Outbuildings
2018	\$106,745	\$15,655	\$91,090	\$0

2018 Tax Information	
<b>Taxes</b>	\$2,114.24
<b>Tax Levy</b>	2.067146

2018 Tax Levy	
Description	Rate
AGRICULTURE	0.004171
AIRPORT GENERAL	0.033529
BEATRICE CITY	0.399171
BIG BLUE NRD	0.024231
COUNTY GENERAL	0.419871
ESU #5	0.015000
HISTORICAL	0.000958
SCC GENERAL	0.090700
SCH 15 BEATRICE	1.079515

5 Year Sales History
No previous sales information is available.

Property Classification			
<b>Status:</b>	Improved	<b>Location:</b>	Urban
<b>Property Class:</b>	Single Family	<b>City Size:</b>	12,001-100,000
<b>Zoning:</b>	Single Family	<b>Lot Size:</b>	10,000-20,000 sq. ft.



Land Information				
Lot Width	Lot Depth	Value Method	# of Units	Lot Value
83	149	Sq ft.	12367	15655

Historical Valuation Information							
Year	Billed Owner	Land	Impr	Outbldg	Total	Taxable	Taxes
2018	ROBBINS, DANIEL W	\$15,655	\$91,090	\$0	\$106,745	\$106,745	\$2,114.24
2017	ROBBINS, DANIEL W	\$15,655	\$91,090	\$0	\$106,745	\$106,745	\$1,974.04
2016	ROBBINS, DANIEL W	\$15,655	\$91,090	\$0	\$106,745	\$106,745	\$1,946.94
2015	ROBBINS, DANIEL W	\$15,655	\$91,090	\$0	\$106,745	\$106,745	\$2,011.88
2014	ROBBINS, DANIEL W	\$15,655	\$91,090	\$0	\$106,745	\$106,745	\$2,078.74

Residential Datasheet			
<b>Type</b>	Single-Family	<b>Heat Type</b>	100 % WARM & COOLED AIR &
<b>Quality / Condition</b>	40 Good / 40 Good	<b>Foundation</b>	
<b>Arch. Type</b>	1 STORY	<b>Slab Area</b>	
<b>Year Built</b>	1920	<b>Crawl Area</b>	
<b>Actual Age</b>	99	<b>Basement Area</b>	958sq. ft.
<b>Ext. Wall 1</b>	100 % VINYL	<b>Min Finish</b>	
<b>Ext. Wall 2</b>		<b>Rec Finish</b>	
<b>Base Area</b>	1,198 sq. ft	<b>Part Finish</b>	
<b>Total Area</b>	1,198 sq. ft	<b>Bedrooms</b>	3
<b>Style 1</b>	100% One-Story	<b>Bathrooms</b>	1
<b>Style 2</b>		<b>Garage Type</b>	ATTACHED
<b>Roof Type</b>	COMP SHINGLES	<b>Garage Area</b>	546 sq. ft

Miscellaneous Improvements		
Improvement	Year	Units
SLAB W/ROOF		96
SINGLE 1/S FIRE~PL		1
WOOD DECK		184
PICNIC SHELTER		4000

### Photo/Sketch

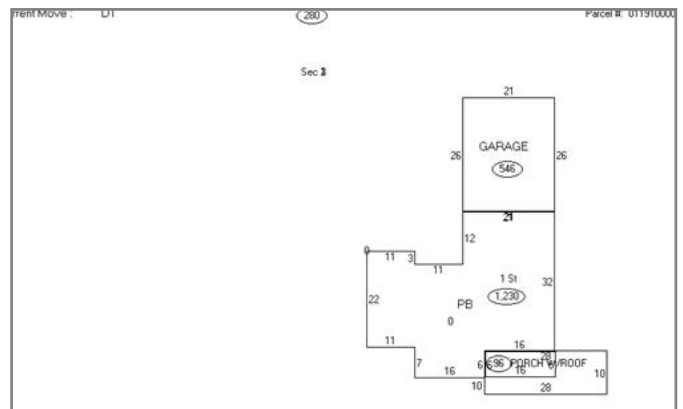

**Tax Statement**

Served by **WEBSERVER-TWO**

**Gage County**

**0** **Step 4 of 8**

<b>Perm ID</b> 011910000	<b>Name</b> ROBBINS, DANIEL W 1400 PARK ST BEATRICE NE 68310-	<b>Legal</b> LOT 7 & S 33' LOT 8 BLK 6 GRABLE & BEACHLEYS 2ND ADD 01400 \PARK
-----------------------------	--	---



- [Levy Graph](#)
- [Value Graph](#)
- [Tax Graph](#)

Year	Statement	Value	Tax	Exemption	Net Tax	Balance Due
2018	<a href="#">012900</a>	\$ 106,745	\$ 2,206.58	- \$ 92.34	\$ 2,114.24	\$ 2,114.24
2017	<a href="#">012882</a>	\$ 106,745	\$ 2,067.92	- \$ 93.88	\$ 1,974.04	\$ 0.00
2016	<a href="#">012838</a>	\$ 106,745	\$ 2,042.56	- \$ 95.62	\$ 1,946.94	\$ 0.00
2015	<a href="#">012811</a>	\$ 106,745	\$ 2,112.32	- \$ 100.44	\$ 2,011.88	\$ 0.00
2014	<a href="#">012807</a>	\$ 106,745	\$ 2,155.10	- \$ 76.36	\$ 2,078.74	\$ 0.00
2013	<a href="#">012763</a>	\$ 106,745	\$ 2,179.98	- \$ 70.42	\$ 2,109.56	\$ 0.00
2012	<a href="#">012754</a>	\$ 116,865	\$ 2,421.80	- \$ 83.56	\$ 2,338.24	\$ 0.00
2011	<a href="#">007435</a>	\$ 116,865	\$ 2,421.00	- \$ 88.02	\$ 2,332.98	\$ 0.00
2010	<a href="#">012722</a>	\$ 112,865	\$ 2,335.48	- \$ 89.06	\$ 2,246.42	\$ 0.00
2009	<a href="#">012702</a>	\$ 69,070	\$ 1,414.96	- \$ 56.78	\$ 1,358.18	\$ 0.00
2008	<a href="#">007032</a>	\$ 69,070	\$ 1,415.44	- \$ 59.48	\$ 1,355.96	\$ 0.00
2007	<a href="#">012661</a>	\$ 69,570	\$ 1,435.50	- \$ 57.90	\$ 1,377.60	\$ 0.00
2006	<a href="#">012556</a>	\$ 69,570	\$ 1,360.56	\$ 0.00	\$ 1,360.56	\$ 0.00
2005	<a href="#">012030</a>	\$ 68,840	\$ 1,372.54	\$ 0.00	\$ 1,372.54	\$ 0.00
2004	<a href="#">012411</a>	\$ 68,840	\$ 1,377.64	\$ 0.00	\$ 1,377.64	\$ 0.00
2003	<a href="#">011875</a>	\$ 68,840	\$ 1,386.48	\$ 0.00	\$ 1,386.48	\$ 0.00
2002	<a href="#">012301</a>	\$ 67,805	\$ 1,355.02	\$ 0.00	\$ 1,355.02	\$ 0.00
2001	<a href="#">013109</a>	\$ 67,805	\$ 1,337.20	\$ 0.00	\$ 1,337.20	\$ 0.00
2000	<a href="#">013067</a>	\$ 61,845	\$ 1,291.19	- \$ 18.89	\$ 1,272.30	\$ 0.00
1999	<a href="#">012891</a>	\$ 61,845	\$ 1,286.24	\$ 0.00	\$ 1,286.24	\$ 0.00
1998	<a href="#">012796</a>	\$ 61,845	\$ 1,309.20	\$ 0.00	\$ 1,309.20	\$ 0.00
1997	<a href="#">012737</a>	\$ 61,845	\$ 1,395.32	\$ 0.00	\$ 1,395.32	\$ 0.00
1996	<a href="#">012672</a>	\$ 31,400	\$ 782.64	\$ 0.00	\$ 782.64	\$ 0.00
1995	<a href="#">012579</a>	\$ 31,400	\$ 804.88	\$ 0.00	\$ 804.88	\$ 0.00
1994	<a href="#">011590</a>	\$ 28,545	\$ 695.80	\$ 0.00	\$ 695.80	\$ 0.00
1993	<a href="#">012412</a>	\$ 24,395	\$ 651.80	\$ 0.00	\$ 651.80	\$ 0.00

The information provided in this site is the most recent and most accurate data available. All information contained herein is for informational purposes only. MIPS Inc does not warrant that such information is accurate and error free. This information is provided on an "as is" basis without warranties of any kind, either expressed or implied, including, but not limited to, the implied warranties of merchantability or fitness for a particular purpose. MIPS Inc shall not be liable for any direct, indirect, incidental, special or consequential damages arising out of the use of such information or the inability to use such information. MIPS also is not, nor shall be party to or subject to any warranty or any breach of any kind. The User acknowledges and agrees that the use of such information is at the sole risk of the User.

Copyright © 2004 Nebraska Association of County Officials. All rights reserved.