

201403287
 APR 25 2014 11:08 P M

Book 414 of 05713-20
 11-23-2009-01
 RECORDED
 DANIEL L. BARTHO
 201403287

THE CAPITOL DISTRICT

Lots 1 through 5, inclusive, THE CAPITOL DISTRICT, Being a replating of Lots 1 through 8, inclusive Block 71, TOGETHER WITH Lots 1 through 8, inclusive Block 72, AND ALSO TOGETHER WITH the west 400 feet of Vacated 10th Street abutting Block 71 on the east, all of Vacated 11th Street right of way between said Blocks 71 and 72, the vacated east / west alley in said Block 72, all being located in the ORIGINAL CITY OF OMAHA, as surveyed and lithographed, in Douglas County, Nebraska. **AND ALSO**

LOCATED IN: NE 1/4 NE 1/4 SEC. 22-15-15

- NOTES**
1. ALL DISTANCES ARE SHOWN IN DECIMAL FEET.
 2. ALL DISTANCES SHOWN ALONG CURVES ARE ARC DISTANCES NOT CHORD DISTANCES.
 3. ALL ANGLES ARE 90° UNLESS OTHERWISE NOTED.
 4. DISTANCES AND ANGLES SHOWN IN PARENTHESES REFER TO EASEMENTS.
 5. EASEMENT FOR SEWERLINE CONFIGURATION AND LOCATION TO BE RECORDED BY OTHERS.

- LEGEND**
- BOUNDARY LINE
 - LOT LINE
 - EASEMENT LINE
 - STREET WACATION
 - EASEMENT TO BE RELEASED
 - MUD EASEMENT TO BE RELEASED

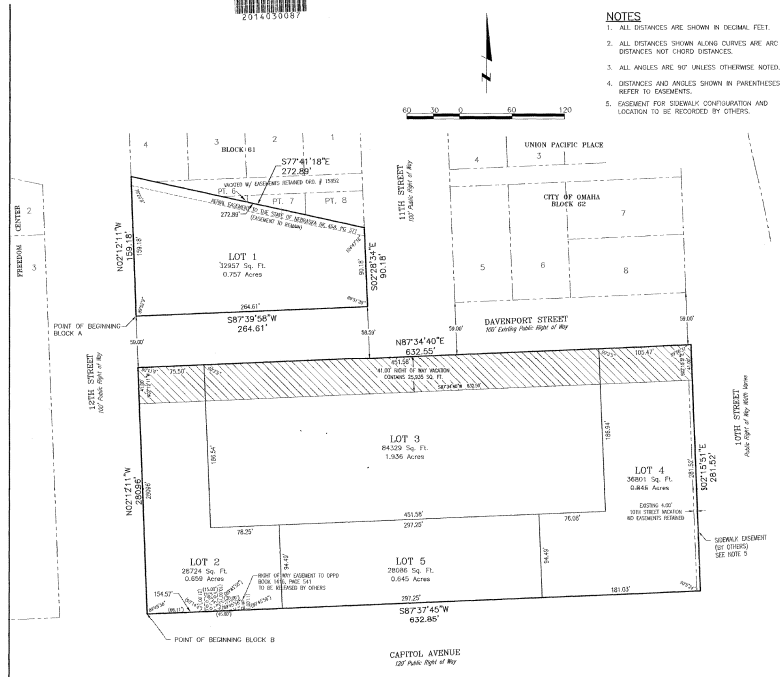

REVIEW BY DOUGLAS COUNTY ENGINEER
 This plat of THE CAPITOL DISTRICT, being a replating of Lots 1 through 8, inclusive Block 71, TOGETHER WITH Lots 1 through 8, inclusive Block 72, AND ALSO TOGETHER WITH the west 400 feet of Vacated 10th Street abutting Block 71 on the east, all of Vacated 11th Street right of way between said Blocks 71 and 72, the vacated east / west alley in said Block 72, all being located in the ORIGINAL CITY OF OMAHA, as surveyed and lithographed, in Douglas County, Nebraska, described as follows:
 Beginning at the southwest corner of said Lot 5, Block 72, also being the intersection of the north line of way line of Capitol Avenue with the east right of way line of 12th Street;
 Thence North 02°27'17" East (Course bearings) for 200.95 feet on said east right of way line;
 Thence North 87°32'45" East for 632.85 feet parallel with and 41.00 feet north of the south 150.00 feet right of way line of Davenport Street to the east line of the vacated west 400 feet of 10th Street extended north;
 Thence South 02°27'17" East for 281.22 feet on said east right of way line to the east line of Capitol Avenue;
 Thence South 87°32'45" West for 632.85 feet to the Point of Beginning.
 Contains 177,340 square feet or 4.000 acres.
 TOGETHER WITH
 All of Lot 5, parts of Lots 4, 6, 7 AND 8, in Block 61, ORIGINAL CITY OF OMAHA, as surveyed and lithographed, in Douglas County, Nebraska, 1700'x400' with full plat of the vacated alley in said Block 61, going south of the alleystone right-of-way, described as follows:
 Beginning at the southwest corner of said Lot 5, Block 61, Thence North 02°27'17" East for 190.00 feet on the east right of way line of 12th Street to the south line of the property owned by the State of Nebraska Department of roads of Interstate 480;
 Thence South 77°41'18" East for 272.89 feet on said south line to the east line of said Lot 8, Block 61 and the west right of way line of 11th Street;
 Thence South 02°27'17" East for 50.00 feet to the southwest corner of said Lot 8, Block 61 and the north right of way line of Davenport Street;
 Thence South 87°32'45" West for 264.61 feet to the Point of Beginning.
 Contains 32,957 square feet or 0.757 acres.
 Dated at OMAHA, NE, this 15th day of APRIL, 2013.
 Douglas County Engineer

COUNTY TREASURER'S CERTIFICATE
 I HEREBY CERTIFY that I find no regular or special taxes due or delinquent against the property described in the land Surveyor's Certificate and embraced in this plat, as shown by the assessment of this office, this 15th day of APRIL, 2013.
 Douglas County Treasurer

APPROVAL OF CITY ENGINEER OF OMAHA
 I HEREBY APPROVE this plat of THE CAPITOL DISTRICT, being a replating of Lots 1 through 8, inclusive Block 71, TOGETHER WITH Lots 1 through 8, inclusive Block 72, AND ALSO TOGETHER WITH the west 400 feet of Vacated 10th Street abutting Block 71 on the east, all of Vacated 11th Street right of way between said Blocks 71 and 72, the vacated east / west alley in said Block 72, all being located in the ORIGINAL CITY OF OMAHA, as surveyed and lithographed, in Douglas County, Nebraska, described as follows:
 Beginning at the southwest corner of said Lot 5, Block 72, also being the intersection of the north line of way line of Capitol Avenue with the east right of way line of 12th Street;
 Thence North 02°27'17" East (Course bearings) for 200.95 feet on said east right of way line;
 Thence North 87°32'45" East for 632.85 feet parallel with and 41.00 feet north of the south 150.00 feet right of way line of Davenport Street to the east line of the vacated west 400 feet of 10th Street extended north;
 Thence South 02°27'17" East for 281.22 feet on said east right of way line to the east line of Capitol Avenue;
 Thence South 87°32'45" West for 632.85 feet to the Point of Beginning.
 Contains 177,340 square feet or 4.000 acres.
 Dated at OMAHA, NE, this 15th day of APRIL, 2013.
 City Engineer

APPROVAL OF OMAHA CITY PLANNING BOARD
 This plat of THE CAPITOL DISTRICT, being a replating of Lots 1 through 8, inclusive Block 71, TOGETHER WITH Lots 1 through 8, inclusive Block 72, AND ALSO TOGETHER WITH the west 400 feet of Vacated 10th Street abutting Block 71 on the east, all of Vacated 11th Street right of way between said Blocks 71 and 72, the vacated east / west alley in said Block 72, all being located in the ORIGINAL CITY OF OMAHA, as surveyed and lithographed, in Douglas County, Nebraska, described as follows:
 Beginning at the southwest corner of said Lot 5, Block 72, also being the intersection of the north line of way line of Capitol Avenue with the east right of way line of 12th Street;
 Thence North 02°27'17" East (Course bearings) for 200.95 feet on said east right of way line;
 Thence North 87°32'45" East for 632.85 feet parallel with and 41.00 feet north of the south 150.00 feet right of way line of Davenport Street to the east line of the vacated west 400 feet of 10th Street extended north;
 Thence South 02°27'17" East for 281.22 feet on said east right of way line to the east line of Capitol Avenue;
 Thence South 87°32'45" West for 632.85 feet to the Point of Beginning.
 Contains 177,340 square feet or 4.000 acres.
 Dated at OMAHA, NE, this 15th day of APRIL, 2013.
 Chairman, Omaha City Planning Board

APPROVAL OF OMAHA CITY COUNCIL
 This plat of THE CAPITOL DISTRICT, being a replating of Lots 1 through 8, inclusive Block 71, TOGETHER WITH Lots 1 through 8, inclusive Block 72, AND ALSO TOGETHER WITH the west 400 feet of Vacated 10th Street abutting Block 71 on the east, all of Vacated 11th Street right of way between said Blocks 71 and 72, the vacated east / west alley in said Block 72, all being located in the ORIGINAL CITY OF OMAHA, as surveyed and lithographed, in Douglas County, Nebraska, described as follows:
 Beginning at the southwest corner of said Lot 5, Block 72, also being the intersection of the north line of way line of Capitol Avenue with the east right of way line of 12th Street;
 Thence North 02°27'17" East (Course bearings) for 200.95 feet on said east right of way line;
 Thence North 87°32'45" East for 632.85 feet parallel with and 41.00 feet north of the south 150.00 feet right of way line of Davenport Street to the east line of the vacated west 400 feet of 10th Street extended north;
 Thence South 02°27'17" East for 281.22 feet on said east right of way line to the east line of Capitol Avenue;
 Thence South 87°32'45" West for 632.85 feet to the Point of Beginning.
 Contains 177,340 square feet or 4.000 acres.
 Dated at OMAHA, NE, this 15th day of APRIL, 2013.
 Mayor, City of Omaha

LAND SURVEYOR'S CERTIFICATE
 I HEREBY CERTIFY that I have made a boundary survey of the parcel herein shown and that permanent monuments have been placed at all corners, angle points and ends of curves on the boundary on the east, north and west permanent monuments will be placed at all corners, angle points and ends of curves on all said streets within the subdivision to be known as Lots 1 through 5, inclusive, THE CAPITOL DISTRICT, being a replating of Lots 1 through 8, inclusive Block 71, TOGETHER WITH Lots 1 through 8, inclusive Block 72, AND ALSO TOGETHER WITH the west 400 feet of Vacated 10th Street abutting Block 71 on the east, all of Vacated 11th Street right of way between said Blocks 71 and 72, the vacated east / west alley in said Block 72, all being located in the ORIGINAL CITY OF OMAHA, as surveyed and lithographed, in Douglas County, Nebraska, described as follows:
 Beginning at the southwest corner of said Lot 5, Block 72, also being the intersection of the north line of way line of Capitol Avenue with the east right of way line of 12th Street;
 Thence North 02°27'17" East (Course bearings) for 200.95 feet on said east right of way line;
 Thence North 87°32'45" East for 632.85 feet parallel with and 41.00 feet north of the south 150.00 feet right of way line of Davenport Street to the east line of the vacated west 400 feet of 10th Street extended north;
 Thence South 02°27'17" East for 281.22 feet on said east right of way line to the east line of Capitol Avenue;
 Thence South 87°32'45" West for 632.85 feet to the Point of Beginning.
 Contains 177,340 square feet or 4.000 acres.
 TOGETHER WITH
 All of Lot 5, parts of Lots 4, 6, 7 AND 8, in Block 61, ORIGINAL CITY OF OMAHA, as surveyed and lithographed, in Douglas County, Nebraska, 1700'x400' with full plat of the vacated alley in said Block 61, going south of the alleystone right-of-way, described as follows:
 Beginning at the southwest corner of said Lot 5, Block 61, Thence North 02°27'17" East for 190.00 feet on the east right of way line of 12th Street to the south line of the property owned by the State of Nebraska Department of roads of Interstate 480;
 Thence South 77°41'18" East for 272.89 feet on said south line to the east line of said Lot 8, Block 61 and the west right of way line of 11th Street;
 Thence South 02°27'17" East for 50.00 feet to the southwest corner of said Lot 8, Block 61 and the north right of way line of Davenport Street;
 Thence South 87°32'45" West for 264.61 feet to the Point of Beginning.
 Contains 32,957 square feet or 0.757 acres.
 Dated at OMAHA, NE, this 15th day of APRIL, 2013.
 State of Nebraska, L.S. 561
 Daniel L. Bartho
 July 22, 2013

OWNER'S CERTIFICATION
 I HEREBY CERTIFY that I am the owner of the property as described in the surveyor's certificate and embraced within this plat, and have caused said plat to be subdivided into lots as shown on this plat.
 City of Omaha, a Municipal Corporation, OWNER
 Mayor, City of Omaha
 Daniel L. Bartho
 State of Nebraska

ACKNOWLEDGEMENT OF NOTARY
 State of Nebraska)
 County of Douglas)
 The foregoing instrument was acknowledged before me this 15th day of APRIL, 2013, by Daniel L. Bartho, Mayor, City of Omaha, and Daniel L. Bartho, Mayor, City of Omaha.
 Signature of Notary Public
 Daniel L. Bartho
 Notary Public

MINOR PLAT
 job number - flats
 011001101-003
 book page
 date 7-3-2013
 sheet 1 of 1

drawn by
 designed by
 reviewed by
 checked by
 reference
 revision

402.466.2498 P
 402.466.2730 F
 14710 West Dodge Road, Suite 100
 Omaha, Nebraska 68154-2027
 www.LRA-INC.com
LAMP RYNEARSON & ASSOCIATES
 THE CAPITOL DISTRICT (Lots 1 through 5, inclusive) OMAHA, DOUGLAS COUNTY, NEBRASKA