

COUNTER LM C.E. LM
VERIFY LM D.E. LM
PROOF a
FEES \$ 16.00
CHECK # _____
CHG EACG CASH _____
REFUND _____ CREDIT _____
SHORT _____ NCR _____

FILED SARPY COUNTY NEBRASKA
INSTRUMENT NUMBER

2016-30577

11/23/2016 2:11:38 PM

Lloyd J. Dowding

REGISTER OF DEEDS



**THIS PAGE ADDED
FOR RECORDING
INFORMATION.**

**DOCUMENT STARTS ON
NEXT PAGE.**

LLOYD J. DOWDING

SARPY COUNTY REGISTER OF DEEDS

Steven J. Stastny, Deputy

1210 GOLDEN GATE DRIVE, # 1230

PAPILLION, NE 68046-2842

402-593-5773

R.O.W. CURVE TABLE				
CURVE	RADIUS	LENGTH	TANGENT	DELTA
6	82.14'	95.31'	53.84'	66° 29' 07"
7	132.50'	42.78'	21.58'	18° 29' 49"
8	282.50'	88.26'	44.49'	17° 53' 59"
9	217.50'	92.97'	47.20'	24° 29' 25"
10	67.50'	79.76'	45.27'	67° 42' 07"
11	132.50'	212.00'	136.43'	91° 40' 24"
12	214.55'	100.79'	51.34'	26° 54' 56"

AFFIDAVIT OF CORRECTION

To add right-of-way curve information to the R.O.W. Curve Table of Royal View Apartment Community Replat 1 (Lots 1 and 2 inclusive & Outlots "A", "B" & "C"), being a replat of Lots 1 and 8, and also Outlot "A", Royal View Apartment Community, a subdivision located in the NE1/4 of the SE1/4 of Section 25; and also part of South 204th Avenue and Ridgemont Street right-of-way, located in said NE1/4 of the SE1/4 of Section 25, all located in Township 14 North, Range 10 East of the 6th p.m., Sarpy County, Nebraska.

The R.O.W. Curve Table only showed curves 6 thru 11 instead of 6 thru 12.

AFFIDAVIT

Correction to Royal View Apartment Community Replat 1 (Lots 1 and 2 inclusive & Outlots "A", "B" & "C"), being a replat of Lots 1 and 8, and also Outlot "A", Royal View Apartment Community, a subdivision located in the NE1/4 of the SE1/4 of Section 25; and also part of South 204th Avenue and Ridgemont Street right-of-way, located in said NE1/4 of the SE1/4 of Section 25, all located in Township 14 North, Range 10 East of the 6th p.m., Sarpy County, Nebraska.

I, John W. Von Dollen, do hereby submit the above drawing in order to correct the error in the Curve Table of Royal View Apartment Community Replat 1 (Lots 1 and 2 inclusive & Outlots "A", "B" & "C"), being a replat of Lots 1 and 8, and also Outlot "A", Royal View Apartment Community, a subdivision located in the NE1/4 of the SE1/4 of Section 25; and also part of South 204th Avenue and Ridgemont Street right-of-way, located in said NE1/4 of the SE1/4 of Section 25, all located in Township 14 North, Range 10 East of the 6th p.m., Sarpy County, Nebraska.

I certify that I am the same identical person whose name appears in the Surveyor's Certificate of said Royal View Apartment Community Replat 1 (Lots 1 and 2 inclusive & Outlots "A", "B" & "C"), Sarpy County, Nebraska.

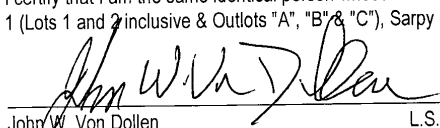
John W. Von Dollen

L.S. 579

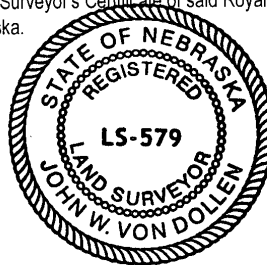

STATE OF NEBRASKA

} SS

COUNTY OF SARPY

On the 4 day of November, 2016, before me a Notary Public, qualified and commissioned in and for said County, personally appeared John W. Von Dollen, who is personally known to me to be the same identical person whose name is affixed to the above Affidavit, and he acknowledged the signing thereof to be his voluntary act and deed.

Witness my hand and official seal at Omaha, Nebraska, on this date last aforesaid

Commission Expires:

October 3, 2017

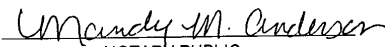
NOTARY PUBLIC

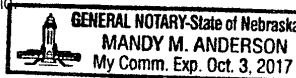

E & A CONSULTING GROUP, INC.

Engineering • Planning • Environmental & Field Services

10909 Mill Valley Road, Suite 100 • Omaha, NE 68154 Phone: 402.895.4700 • Fax: 402.895.3599

Drawn by: CJV Chkd by:

Date: 11-04-2016

Job No.: P2014.104.002

AFFIDAVIT OF CORRECTION

**LOT 1, ROYAL VIEW APARTMENTS
COMMUNITY REPLAT 1**

SARPY COUNTY, NEBRASKA