

MISC 2013080407

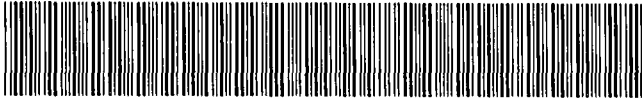

AUG 07 2013 12:34 P 7

misc
 FEE 46⁰⁰ FB 01-60000
 17 *BKPD*
 BKP36-16-12 EXAM
 1
 3
 IND SCAN PRF

Received - DIANE L. BATTIATO
 Register of Deeds, Douglas County, NE
 8/7/2013 12:34:52.61



2013080407

THIS PAGE INCLUDED FOR INDEXING

PAGE DOWN FOR BALANCE OF INSTRUMENT.

RETURN TO: EALG1

CHECK NUMBER

©

POST CONSTRUCTION STORMWATER MANAGEMENT PLAN MAINTENANCE AGREEMENT AND EASEMENT

WHEREAS, Omaha Public School District recognizes that stormwater management facilities (hereinafter referred to as "the facility" or "facilities") must be maintained for the development called Hartman Elementary Parking Addition located in the jurisdiction of the City of Omaha, Douglas County, Nebraska; and,

WHEREAS, the Property Owner (whether one of more) is the owner of

~~5530 N 66th Street, Omaha, NE 68104~~ (hereinafter referred to as "the Property"), and, **NE 1/4 OF SE 1/4 OF SW 1/4 OF SECTION 36, T 16 N, R 12 E OF THE 6th PRINCIPAL MERIDIAN.**

WHEREAS, the City of Omaha (hereinafter referred to as "the City") requires and the Property Owner, and its administrators, executors, successors, heirs, or assigns, agree that the health, safety and welfare of the citizens of the City require that the facilities be constructed and maintained on the property, and,

WHEREAS, the Post Construction Stormwater Management Plan, OMA 20130507-828-P, (hereinafter referred to as "PCSMP"), should be constructed and maintained by the Property Owner, its administrators, executors, successors, heirs, or assigns.

NOW, THEREFORE, in consideration of the foregoing premises, the covenants contained herein, and the following terms and conditions, the property owner agrees as follows:

1. The facility or facilities shall be constructed by the Property Owner in accordance with the PCSMP, which has been reviewed and accepted by the City of Omaha or its designee.
2. The Property Owner must develop and provide the "BMP Maintenance Requirements", attached here to as Exhibit "B", which have been reviewed and accepted by the City of Omaha or its designee. The BMP Maintenance Requirements shall describe the specific maintenance practices to be performed for the facilities and include a schedule for implementation of these practices. The Plan shall indicate that the facility or facilities shall be inspected by a professional qualified in stormwater BMP function and maintenance at least annually to ensure that it is operating properly. A written record of inspection results and any maintenance work shall be maintained and available for review by the City.
3. The Property Owner, its administrators, executors, successors, heirs, or assigns, shall construct and perpetually operate and maintain, at its sole expense, the facilities in strict accordance with the attached BMP Maintenance Requirements accepted by the City of Omaha or its designee.
4. The Property Owner, its administrators, executors, successors, heirs, or assigns hereby grants permission to the City, its authorized agents and employees, to enter upon the property and to inspect the facilities whenever the City deems necessary. The City shall provide the Owner copies of the inspection findings and a directive to commence with the repairs if necessary.

The City will require the Property Owner to provide, within 7 calendar days, a written response addressing what actions will be taken to correct any deficiencies and provide a schedule of repairs within a reasonable time frame. Whenever possible, the City shall provide notice prior to entry. The City shall indemnify and hold the Property Owner harmless from any damage by reason of the City's negligent acts during such entry upon the property.

5. The Property Owner its administrators, executors, successors, heirs, or assigns, agrees that should it fail to correct any defects in the facility or facilities within reasonable time frame agreed to in the response by the Property Owner for corrective actions, or shall fail to maintain the structure in accordance with the attached BMP Maintenance Requirements and with the law and applicable executive regulation or, in the event of an emergency as determined by the City of Omaha or its designee in its sole discretion, the City of Omaha or its designee is authorized to enter the property to make all repairs, and to perform all maintenance, construction and reconstruction as the City of Omaha or its designee deems necessary. Notwithstanding the foregoing, the City shall indemnify and hold the Property Owner harmless from any damage by reason of the City's negligent acts during such entry upon the property.

The City of Omaha or its designee shall have the right to recover from the Property Owner any and all reasonable costs the City of Omaha expends to maintain or repair the facility or facilities or to correct any operational deficiencies subject to the provisions of the immediately preceding sentence relating to negligent acts of the City. Failure to pay the City of Omaha or its designee all of its expended costs, after forty-five days written notice, shall constitute a breach of the agreement. The City of Omaha or its designee shall thereafter be entitled to bring an action against the Property Owner to pay, or foreclose upon the lien hereby authorized by this agreement against the property, or both. Interest, collection costs, and reasonable attorney fees shall be added to the recovery to the successful party.

6. The Property Owner shall not obligate the City of Omaha to maintain or repair the facility or facilities, and the City of Omaha shall not be liable to any person for the condition or operation of the facility or facilities.
7. The Property Owner, its administrators, executors, successors, heirs, or assigns, hereby indemnifies and holds harmless the City and its authorized agents and employees for any and all damages, accidents, casualties, occurrences or claims that may arise or be asserted against the City from the construction, presence, existence or maintenance of the facility or facilities by the Property Owner. In the event a claim is asserted against the City, its authorized agents or employees, the City shall promptly notify the Property Owner and the Property Owner shall defend at its own expense any suit based on such claim unless due solely to the negligence of the City in which event the City shall be required to defend any such suit at its own expense. Notwithstanding the foregoing, if any claims are made against both the City of Omaha and the Property Owner, each will be required to defend any such suit or claim against it at its own expense. Each shall be responsible for payment of any recovery to the extent determined in such suit. If any judgment or claims against the City, its authorized agents or employees shall

be allowed, the Property Owner shall pay for all costs and expenses in connection herewith except to the extent of the negligent act of the City.

8. The Property Owner shall not in any way diminish, limit, or restrict the right of the City of Omaha to enforce any of its ordinances as authorized by law.
9. This Agreement shall be recorded with the Register of Deeds of Douglas County, Nebraska and shall constitute a covenant running with the land and shall be binding on the Property Owner, its administrators, executors, successors, heirs, or assigns, including any homeowners or business association and any other successors in interest.

IN WITNESS WHEREOF, the Property Owner (s) has/ have executed this agreement this 23 day of MAY, 2013.

INDIVIDUAL, PARTNERSHIP and/or CORPORATION

Omaha Public Schools
Name of Individual, Partnership and/or Corporation

MARK WARNEKE
Name

DIR. BUILDINGS & GROUNDS
Title

Signature

Name

Title

Signature

Name

Title

Signature

Name

Title

Signature

ACKNOWLEDGMENT

Nebraska)
State
Douglas)
County

On this 23 day of MAY, 2013 before me, a Notary Public, in and for said County, personally came the above named:

MARK WARNER
O.P.S. AIR BUILDING & GROUNDS

who is (are) personally known to me to be the identical person(s) whose name(s) is (are) affixed to the above instrument and acknowledged the instrument to be his, her (their) voluntary act and deed for the purpose therein stated.

WITNESS my hand and Notarial Seal the day and year last above written.

Donna Rae Scott

Notary Public



Notary Seal

EXHIBIT "A"

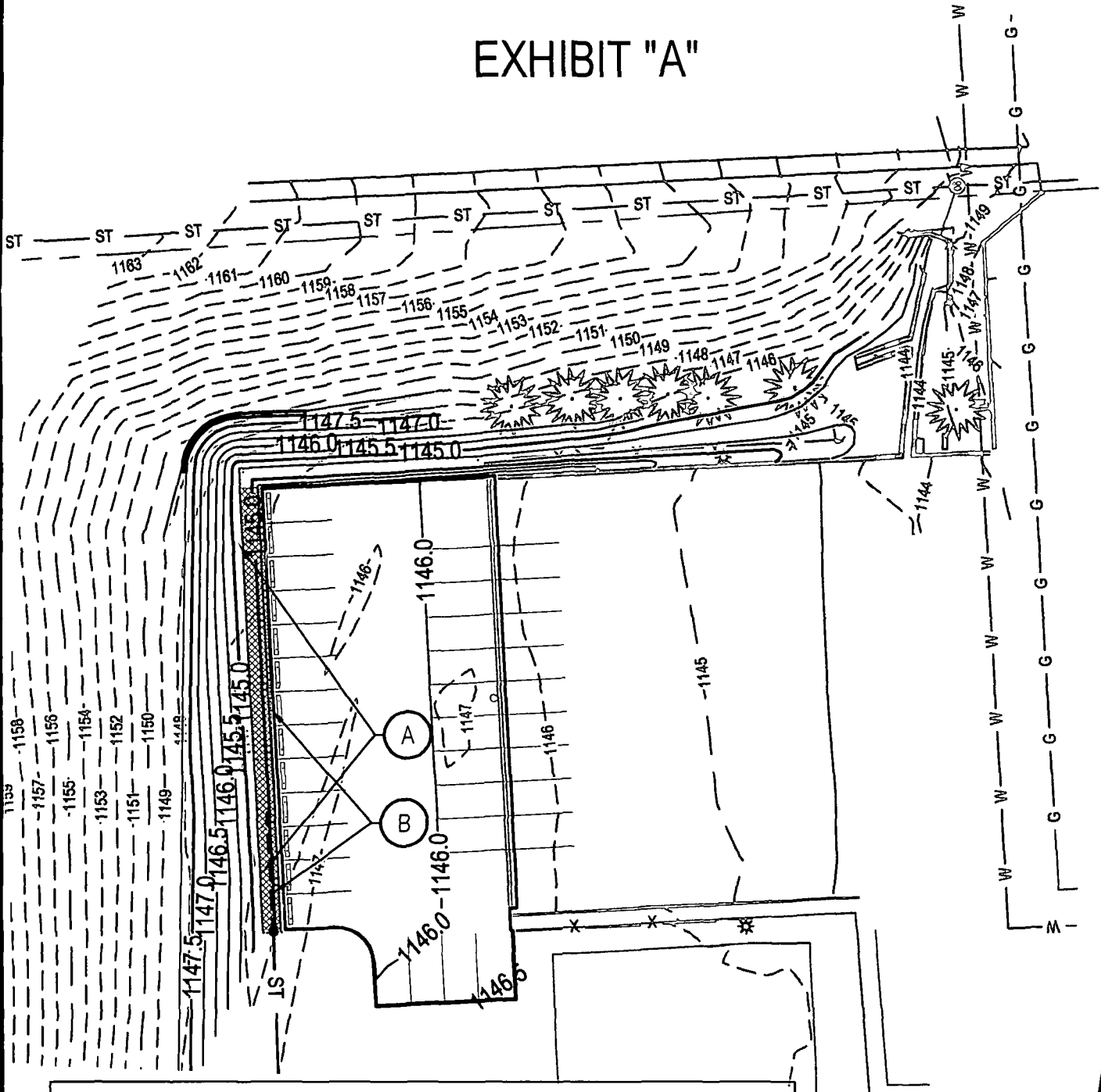

BMP TABLE

BMP ID	DESCRIPTION	LOCATION
A	CONDITIONED SOIL	41°18'36"N / 96°00'58"W
B	SUBSURFACE DETENTION	41°18'36"N / 96°00'58"W

E & A CONSULTING GROUP, INC.

Engineering • Planning • Environmental & Field Services
330 North 117th Street Omaha, NE 68154 Phone: 402.895.4700

Job No.: P2012.446.001

Drawn by: BJW

Date: 7/21/2013

HARTMAN ELEMENTARY

5530 NORTH 66TH STREET
OMAHA, NEBRASKA



Hartman Elementary School
 Parking Lot Addition
 OMA-20130507-828-P

Exhibit 'B'

Name and Location:

Project Name: Hartman Elementary School Parking Lot Addition
 Address: 5330 N 66th Street, Omaha, NE 68104
 PCWP Project Number: OMA-20130204-767-P
 PWD Grading Permit #: Not Applicable. Less than one acre disturbance

Site Data

Total Site Area: 9.40 Acres
 Total Disturbed Area: 0.34 Acres
 Total Undisturbed Area: 9.16 Acre
 Impervious Area Before Construction: 25%
 Impervious Area After Construction: 30%

BMP Information

BMP ID	Type of BMP	Latitude / Longitude
A	Conditioned Soil	41°18' 35.8164" N / 96° 0' 57.9162" W
B	Bioretention Basin	41°18' 35.599" N / 96° 0' 57.8766" W

BMP Maintenance Requirements

Conditioned Soil Maintenance Tasks and Schedule	
Task	Schedule
Remove trash and debris	Monthly
Check and repair any eroded areas	Monthly
Mowing	As Needed
Check vegetation and replace any damaged plant materials	Monthly
Inspect for ponding, washed out areas, soil conditions	Monthly
Replace poorly draining soil	As needed
Reseed or re-sod damaged areas	As needed
Remove sediment	As needed

Bioretention Maintenance Tasks and Schedule	
Task	Schedule
Remove trash and debris	Monthly
Check and repair any eroded areas	Monthly
Check vegetation and replace any damaged plant materials	Monthly
Inspect for ponding, washed out areas, soil conditions	Monthly
Perimeter mowing	Monthly
Inspect collection system for proper functioning	Quarterly
Weeding and Pruning	Annually
Replace poorly draining soil	As needed
Reseed grass swale or border	As needed
Repair broken pipes	As needed
Replace filtration rip rap that is chocked with sediment	As needed
Remove sediment	As needed