

98-51655

COMPARED

INST # 18588
RECORDING FEE no fee
AUDITOR FEE _____
RMA FEE _____

FILED IN RECORD
POTTAWATTAMIE CO. IA.
96 MAY 29 AM 8:10
JOHN SCIRTINO
RECORDER

Document prepared by Pottawattamie County Engineer's Office

EASEMENT FOR PUBLIC HIGHWAY

KNOW ALL MEN BY THESE PRESENTS

That Katherine Williams, ET AL.
148 DeLong Avenue, Council Bluffs, IA 51503

of Pottawattamie County, State of Iowa, in consideration of the sum of
Six hundred seventy-five and 00/100 DOLLARS
in hand paid by Pottawattamie County, do hereby sell and convey unto POTTAWATTAMIE COUNTY, for road
purposes and for use as a Public Highway, the following described premises situated in the County of Pottawattamie,
State of Iowa, to-wit:

See attached legal description.

and we hereby covenant with the said POTTAWATTAMIE COUNTY that we are lawfully seized of said
premises; that they are free from incumbrance; that we have good and lawful authority to sell and convey the
same, and we do hereby covenant to warrant and defend the said premises against the lawful claims of all per-
sons whomsoever, and the said Katherine Williams, ET AL.
heroby relinquishes right of dower in and to the premises hereinbefore conveyed.

Signed this _____ day of _____ A.D. 19 98

Katherine Williams
Katherine Williams
C.H. Peters
C. H. Peters Sandra Hamilton by C.H.P.
POA

State of Iowa,
Pottawattamie County,

ss. }

On this _____ day of _____ A.D. 19 98, before me _____

a Notary Public in and for Pottawattamie County, State of Iowa personally appeared

Katherine Williams, ET AL.

to me known to be the person they named in and who executed the foregoing instrument, and acknowledged
that they executed the same as their voluntary act and deed.

Notary Public in and for said County

INSTRUCTIONS: IF THERE BE ANY ENCUMBRANCES, FILL OUT BLANK WAIVERS ON REVERSE SIDE

COMPARED RIGHT OF WAY ACQUISITION PLAT

PARCEL NO. 2

ACQUIRED FROM KATHERINE WILLIAMS, ETAL

I hereby certify that the foregoing plat was prepared and the record survey was performed by me or under my direct personal supervision and that I am a duly Licensed Land Surveyor under the laws of the State of South Carolina.

JOSEPH C. THORNTON, L.S.
 License number 11702
 My license renewed date is December 28, 1999
 Pages of sheets covered by this plat.

LEGAL DESCRIPTION
SEE ATTACHED EXHIBIT A

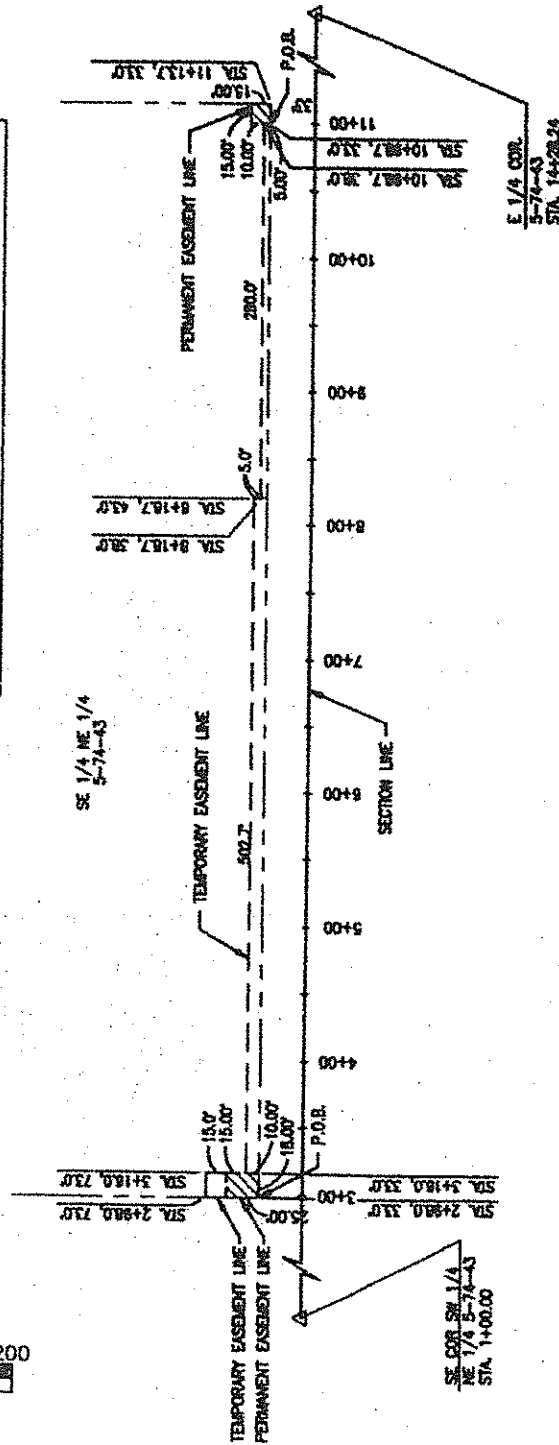
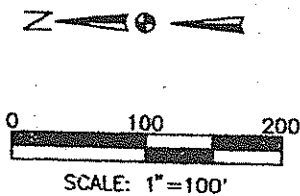

FROM & STA. 2+98.0 TO & STA. 11+13.7 R.O.W. TEMP. = 7372 SF.
 SECTION 5 TWP 74N RANGE 43W PERM. = 675 SF.
 CIVIL TWP LEWIS ACQUIRED BY EASEMENT BORROW ACRES CONSIDERATION \$
 CONTRACT DATED _____

98-51656

COMPANED

EXHIBIT A

PARCEL 2

TWO PERMANENT EASEMENTS DESCRIBED AS FOLLOWS:

COMMENCING AT THE SOUTHWEST CORNER OF THE SOUTHEAST 1/4 OF THE NORTHEAST 1/4 OF SECTION 5-74-43, THENCE ALONG THE SOUTH LINE OF THE SOUTHEAST 1/4 OF THE NORTHEAST 1/4 OF SECTION 5-74-43 EAST 198.0 FEET THENCE NORTHERLY 33 FEET TO THE POINT OF BEGINNING, THENCE CONTINUING NORTHERLY 25 FEET, THENCE EAST 18 FEET, THENCE SOUTHERLY 25 FEET, THENCE WEST 18 FEET TO THE POINT OF BEGINNING.

COMMENCING AT THE SOUTHEAST CORNER OF THE SOUTHWEST 1/4 OF THE NORTHWEST 1/4 OF SECTION 4-74-43, THENCE ALONG THE SOUTH LINE OF THE SOUTHWEST 1/4 OF THE NORTHWEST 1/4 OF SECTION 4-74-43 AND THE SOUTH LINE OF THE SOUTHEAST 1/4 OF THE NORTHEAST 1/4 OF SECTION 5-74-43 WEST 1633.5 FEET, THENCE N $0^{\circ}01'30''$ W 33 FEET TO THE POINT OF BEGINNING, THENCE CONTINUING N $0^{\circ}01'30''$ W 15 FEET, THENCE WEST 15 FEET, THENCE S $0^{\circ}01'30''$ E 15 FEET, THENCE EAST 15 FEET TO THE POINT OF BEGINNING.

THE TWO PERMANENT EASEMENTS DESCRIBED CONTAINS 675 SQUARE FEET.

A TEMPORARY EASEMENT BEING A PART OF THE SOUTHEAST 1/4 OF THE NORTHEAST 1/4 OF SECTION 5-74-43 NORTH OF GREENVIEW ROAD RIGHT OF WAY DESCRIBED FROM CENTER LINE AS FOLLOWS:

BEGINNING AT A POINT 33 FEET LEFT OF CENTER LINE STATION 2+98.0, THENCE TO A POINT 73 FEET LEFT OF CENTER LINE STATION 2+98.0, THENCE TO A POINT 73 FEET LEFT OF CENTER LINE STATION 3+16.0, THENCE TO A POINT 43 FEET LEFT OF CENTER LINE STATION 3+16.0, THENCE TO A POINT 43 FEET LEFT OF CENTER LINE STATION 8+18.7, THENCE TO A POINT 38 FEET LEFT OF CENTER LINE STATION 8+18.7, THENCE TO A POINT 38 FEET LEFT OF CENTER LINE STATION 10+98.7, THENCE TO A POINT 48 FEET LEFT OF CENTER LINE STATION 10+98.7, THENCE TO A POINT 48 FEET LEFT OF CENTER LINE STATION 11+13.7, THENCE TO A POINT 33 FEET LEFT OF CENTER LINE STATION 11+13.7, THENCE TO A POINT 33 FEET LEFT OF CENTER LINE STATION 2+98.0 BEING THE POINT OF BEGINNING.

THE TEMPORARY EASEMENT DESCRIBED CONTAINS 7372 SQUARE FEET.

98-51657