

2/29/41
Telen Depert James A. Sheppard 1092/303-7/60-WD

29/327

DEPARTMENT OF HOUSING & COMMUNITY DEVELOPMENT

Do Co. re James A. Sheppard. 491/285-7/70 BOOK 582 PAGE 231

(Adm of Est)

PERMITS & INSPECTION DIVISION

CONDEMNATION OF BUILDINGS

WORK-SHEET

Deceased
Records
Sent to Helen

0345
14
2806

ADDRESS 1146 N. 20 St STRUCTURE Wd Fin
 TYPE Det SIZE 20 X 48 X 3
 BASEMENT Partial STORIES
 OCCUPANT Vacant

CONDITION OF BUILDING: Demo - Debris

LOCATION: SHOW LOCATION OF STRUCTURE ON THE PLATTED BLOCK AS MEASURED FROM CENTER LINES OF STREETS TO CENTER LINE OF STRUCTURE.

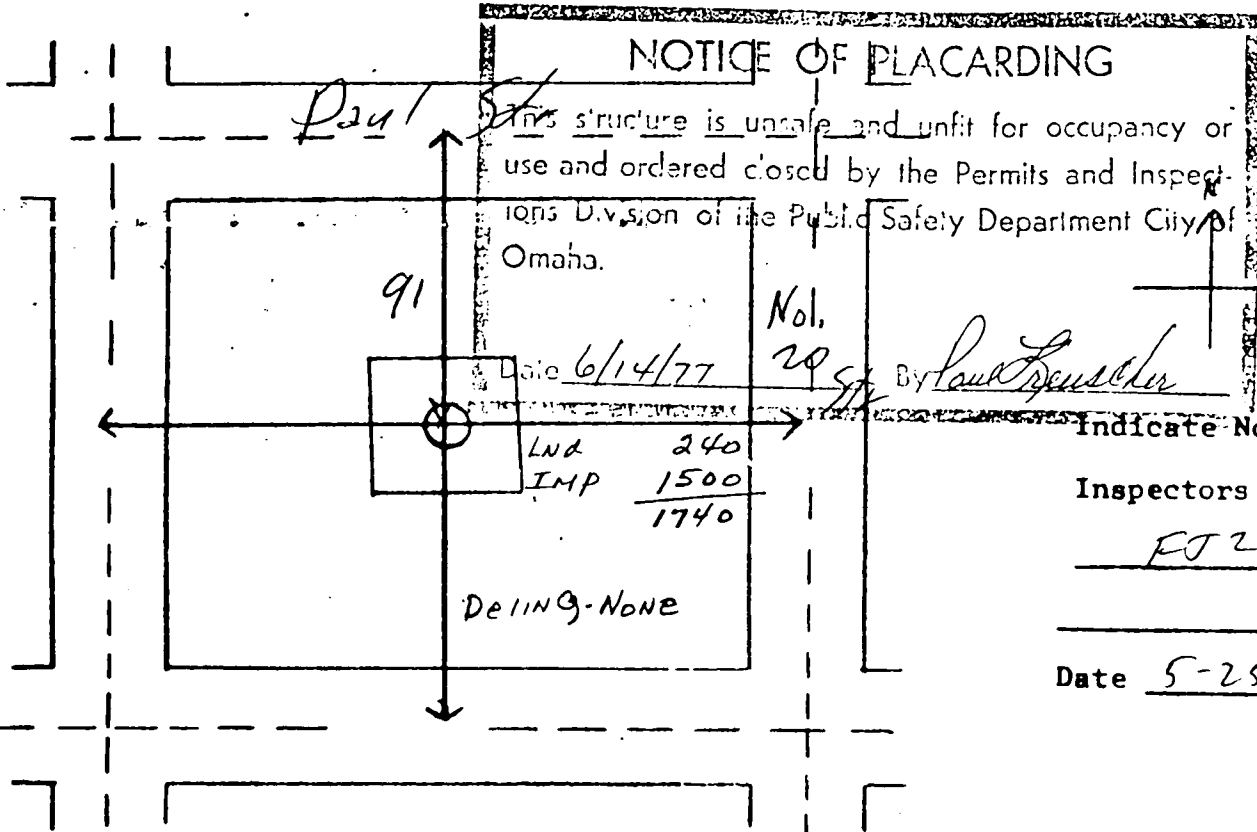

LEGAL DESCRIPTION N 12 E 68 L 5 + S 12 E 68 L 6. B 7 Horbacks 2nd
deceased (see oppr) Add Ext

OWNER: James A. Sheppard Georgia Sheppard.

ADDRESS: 2711 Ohio 68111

BPI-164 OS e.c. - Paul E. Crouse
411 Farm Credit Bldg.

31 April

RECEIVED
1977 JUN 14 PM 1:27
E. HAROLD ESTER
REGISTER OF DEEDS
DOUGLAS COUNTY, NEBR.

Book 582
Page 231
of 2100

Fee Deputy
Index
Comped
N 29-42

29
14