

HOUSING COMMUNITY & DEVELOPMENT DEPARTMENT
PERMITS & INSPECTIONS DIVISION

BOOK 665 PAGE 542

WORK SHEET

ADDRESS 315 So 24 St STRUCTURE Brk. Ord
 TYPE Com. Bldg. SIZE 28 X 52 X 11
 BASEMENT Partial STORIES 1
 OCCUPANT Vacant - Minor
 CONDITION OF BUILDING: Minor Interior Vandal - Ramsacked

LOCATION: SHOW LOCATION OF STRUCTURE ON THE PLATTED BLOCK AS MEASURED FROM CENTER LINES OF STREETS TO CENTER LINE OF STRUCTURE.

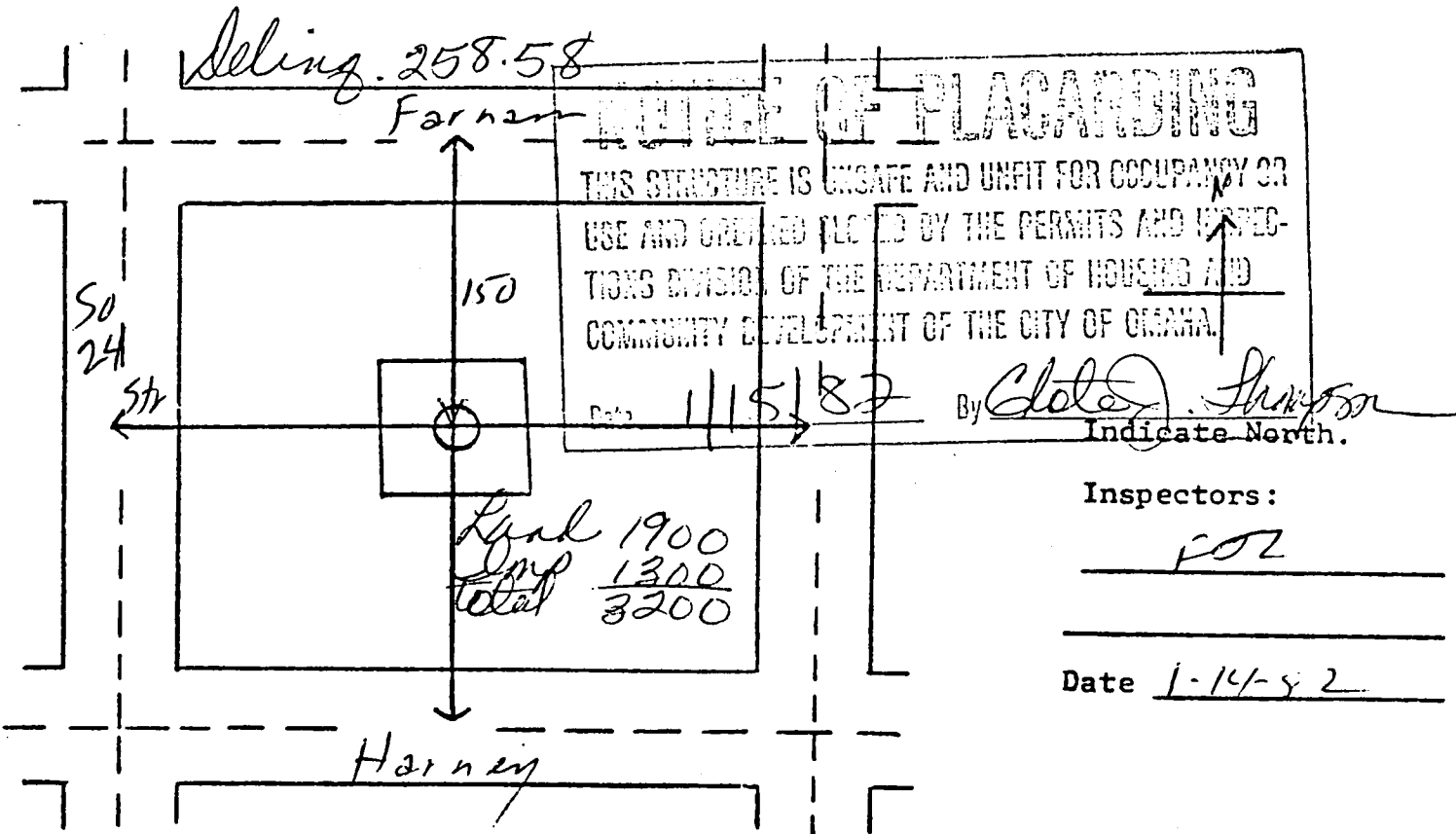

LEGAL DESCRIPTION N 12 BT S 1/2 SUB 3 LOT 7, CAPITOL
Add

OWNER: SEBASTIANO SALERNO

ADDRESS: 1937 S. 10th STREET, OMAHA, NE 68108

L.C. LOYD C. GRANDSINGER

BPI-164 OS 317 S. 24 STREET
OMAHA, NE 68102

Deed 58/343
Mlgr 1/9917A/167 C.C. SHERIFF DELING. TAX DEPT

17 years

RECEIVED
1982 JAN 15 AM 10:56

C. HAROLD OSTLER
REGISTER OF DEEDS
DOUGLAS COUNTY, NE BR.

BOOK 665
PAGE 542
AS. 7 (M.D.)
No Fee
INDEXED
CORDED
58-385
58-343