

PLAT AND DEDICATION FOR STREET WIDENING

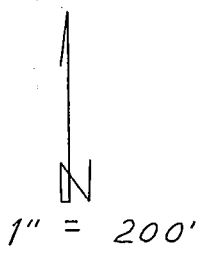
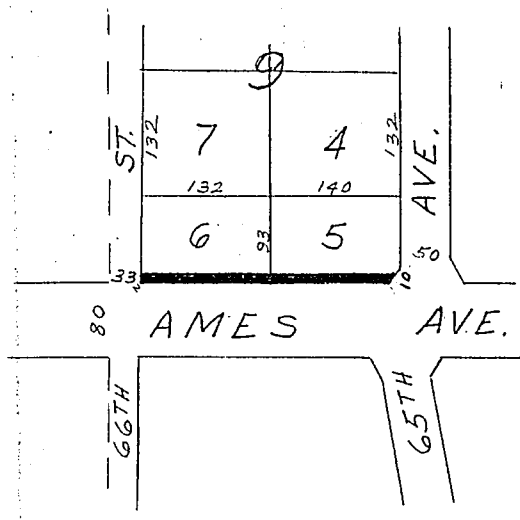

DEDICATION: KNOW ALL MEN BY THESE PRESENTS: That (we) (I) the undersigned Peter W. Hornig and Esther M. Hornig, sole owners of the 10 foot strip of land described below and embraced within the above plat and shown as additional right of way for Ames Avenue hereby dedicate (s) to the public for public use the said 10 foot strip for street purposes to be hereafter known as Ames Avenue, and (we) (I) hereby ratify and approve of this disposition of our land and (we) (I) hereby dedicate to the public use the lane as shown.

LEGAL DESCRIPTION:

The South Ten (10) feet of the North Ninety-three (93) feet of Lots Five (5) and Six (6), in Block Nine (9), Bensonvale Acres, an addition to the City of Omaha, Douglas County, Nebraska, as surveyed, platted and recorded.

Peter W. Hornig Jr.  
OWNER  
Esther M. Hornig

State of Nebraska )  
County of Douglas ) S.S.

On this 11th day of April 1968, before me a Notary Public, duly qualified and commissioned in and for said County and State, personally appeared Peter W. Hornig and Esther M. Hornig, who (are) (is) personally known to me to identical person (s) whose name (s) are affixed to the foregoing instrument and they acknowledged the signing of the same to be their voluntary act and deed.

Leon J. Arundel  
NOTARY PUBLIC



MORTGAGE RELEASE: That \_\_\_\_\_ Mortgagee (s) under Mortgage dated \_\_\_\_\_ day of \_\_\_\_\_ 19 \_\_\_\_\_ recorded at \_\_\_\_\_ Book No. \_\_\_\_\_, Page No. \_\_\_\_\_, Mortgage Records, Douglas County, Nebraska covering \_\_\_\_\_ foot of land above described hereby consent to and approve of plat and dedication and release from said mortgage the \_\_\_\_\_ foot strip dedicated for street purposes without prejudice to the lien of mortgage on the remaining real estate.

State of Nebraska ) S.S.  
County of Douglas )

MORTGAGEE

On this \_\_\_\_\_ day of \_\_\_\_\_ 19 \_\_\_\_\_ before me a Notary Public, duly qualified and commissioned in and for said County and State, personally appeared \_\_\_\_\_ who (are) (is) personally known to me to be identical person (s) whose name (s) are affixed to the foregoing instrument and they acknowledged the signing of the same to be their voluntary act and deed, and who is duly authorized to sign same.

Acknowledgment by Corporation

State of Nebraska ) S.S.  
County of Douglas )

NOTARY PUBLIC

On this \_\_\_\_\_ day of \_\_\_\_\_, 19 \_\_\_\_\_, before me, the undersigned, a notary public in and for said county, personally came \_\_\_\_\_, president of the \_\_\_\_\_ Company, a corporation, to me personally known to be the president and identical person whose name is affixed to the above \_\_\_\_\_, and he acknowledged the execution thereof to be his voluntary act and deed as such officer, and the voluntary act and deed of said corporation. Witness my hand and notarial seat at \_\_\_\_\_, in said county, the day and year last above written.

Acknowledgment by Corporation

State of Nebraska ) S.S.  
County of Douglas )

NOTARY PUBLIC

On this \_\_\_\_\_ day of \_\_\_\_\_, 19 \_\_\_\_\_, before me, the undersigned, a notary public in and for said county, personally came \_\_\_\_\_, president of the \_\_\_\_\_ Company, a corporation, to me personally known to be the president and identical person whose name is affixed to the above \_\_\_\_\_, and he acknowledged the execution thereof to be his voluntary act and deed as such officer, and the voluntary act and deed of said corporation. Witness my hand and notarial seat at \_\_\_\_\_, in said county, the day and year last above written.

THE STATE OF NEBRASKA  
Douglas County  
Entered in the Office of the Register of Deeds of said County, recorded in Book 466 Page 129  
Miss

9 Mac  
R

RECEIVED

By \_\_\_\_\_  
MAIL City Clerk  
N  
Compared 46-36-37  
46/9

No. 2807 ✓  
Plat and dedication covering a 10' strip of right-of-way on the north side of Ames Avenue, between 65th Avenue and 66th Street, to be known as Ames Avenue.  
INSIDE CITY

60

RECEIVED  
Presented to Council:  
JUN 25 1968  
JUL 9 1968  
Mary Gallagher Corvett  
City Clerk

APPROVALS: Above plat and dedication recommended for approval: by:

City Engineer \_\_\_\_\_ Date 6/18/68  
Planning Director \_\_\_\_\_ Date 6/18/68

This plat and dedication approved and accepted by the City Council of the CITY OF OMAHA this day of JUL 9 1968 19 \_\_\_\_\_

ATTEST \_\_\_\_\_ City Clerk  
MAYOR \_\_\_\_\_ 7-10-68  
PRESIDENT, CITY COUNCIL \_\_\_\_\_