



BK 1372 PG 004-006



MISC 2001 03250

Nebr Doc Stamp Tax
Date
\$
By

*lots 3+4
Cattail Creek
of [unclear]*

WILLIAM H. TAYLOR
REGISTER OF DEEDS
DOUGLAS COUNTY, NE

01 MAR -9 AM 11:21

RECEIVED

PERMANENT
AND
TEMPORARY NON-EXCLUSIVE
EASEMENTS AND RIGHTS-OF-WAY

Use 3

FEE	FB
BKP	C/O COMP
DEL	SCAN dc FV

THIS INDENTURE, made this 28 day of February, 2009, between CELEBRITY HOMES, INC., a Nebraska Corporation, ("Grantor"), and METROPOLITAN UTILITIES DISTRICT OF OMAHA, a Municipal Corporation, ("Grantee"),

WITNESS:

That Grantor, in consideration of the sum of Two Dollars (\$2.00) and other valuable consideration, receipt of which is hereby acknowledged, does hereby grant to Metropolitan Utilities District of Omaha, its successors and assigns, a permanent non-exclusive easement and right-of-way to lay, maintain, operate, repair, relay and remove, at any time, pipelines for the transportation of water and all appurtenances thereto, including but not limited to fire hydrants, vault lids, and valve boxes, and a temporary easement for construction purposes, together with the right of ingress and egress on, over, under and through lands described as follows:

Tracts of land in the Southeast Quarter (SE ¼) of the Southwest Quarter (SW ¼) of Section 5, Township 14 North, Range 11 East of the 6th P.M., in Douglas County, Nebraska and being described as follows:

TEMPORARY EASEMENT

Commencing at the southeast corner of the Southeast Quarter of the Southwest Quarter of Section 5, Township 14 North, Range 11 East; thence N0°45'33"E, 50.00 feet to the Point of Beginning; thence N0°45'33"E, 15.00 feet; thence N89°14'29"W, 100.00 feet; thence S0°45'33"W, 15.00 feet; thence S89°14'29"E, 100.00 feet to the Point of Beginning.

This temporary easement contains 0.034 of an acre, more or less, and is shown on the drawing attached hereto and made a part hereof by this reference.



PERMANENT EASEMENT

Commencing at the southeast corner of the Southeast Quarter of the Southwest Quarter of Section 5, Township 14 North, Range 11 East; thence N0°45'33"E, 33.00 feet to the Point of Beginning; thence N0°45'33"E, 17:00 feet; thence N89°14'29"W, 100.00 feet; thence S0°45'33"W, 17:00 feet; thence S89°14'29"E, 100.00 feet to the Point of Beginning.

This permanent easement contains 0.039 of an acre, more or less, and is shown on the drawing attached hereto and made a part hereof by this reference.

*Return to: Susan Ragan
M.U.D.
1723 Harney Street
Omaha, NE 68102*

✓ 6809

METROPOLITAN UTILITIES DISTRICT OMAHA, NEBRASKA	
EASEMENT ACQUISITION	
FOR W.C.P. 9061	
LAND OWNER CELEBRITY HOMES, INC.	
P.O. BOX 390485 OMAHA, NE. 68139-0485 (402) 896-3100	
TOTAL ACRE PERMANENT 0.039 ± TOTAL ACRE TEMPORARY 0.034 ±	LEGEND  PERMANENT EASEMENT  TEMPORARY EASEMENT
PAGE 1 OF 1	
DRAWN BY _____ D.R.B. DATE 12-6-00 CHECKED BY _____ DATE _____ APPROVED BY _____ DATE _____ J.E.V. REV. CHK'D. BY J.E.V. DATE 12-7-00 REV. APPROV. BY _____ DATE _____	

SOUTHEAST ONE QUARTER OF THE
 SOUTHWEST ONE QUARTER OF
 SECTION 5, TOWNSHIP 14 NORTH,
 RANGE 11 EAST

PROP. 15' x 100' TEMP.
 M.U.D. ESMT.

PROP. 17' x 100' PERM.
 M.U.D. ESMT.

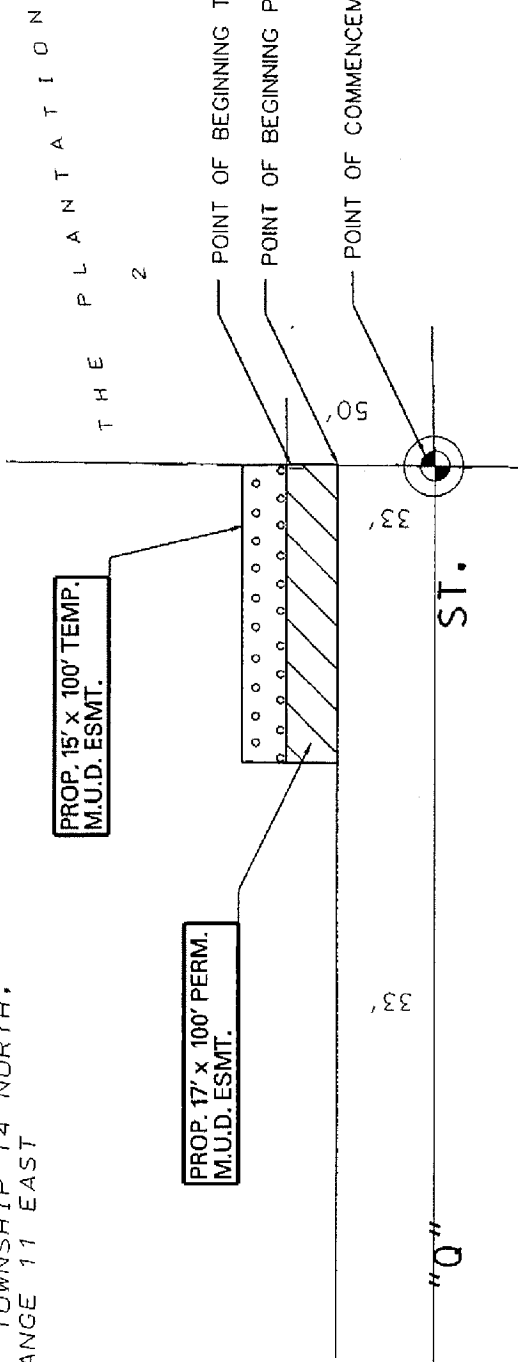

NO SCALE
 "O" ST.; 180th ST. TO 190th ST.

MOUNT AUBURN CEMETERY