

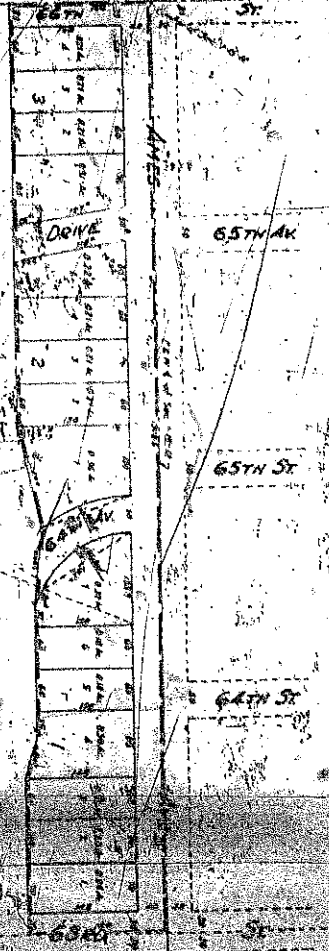

ENTERED IN GENERAL INDEX AND RECORDED IN THE REGISTER OF DEEDS  
FOR THE COUNTY OF DODGE, NEBRASKA, THIS 15th DAY OF APRIL, 1912.

# CAMENZIND HEIGHTS

BEING A SUBDIVISION OF PART OF NW 1/4  
OF SE 1/4 OF SECT. 1-15-12



This plat of Camenzind Heights was approved by the City Plan Commission of the City of Omaha, Nebraska, on January 22, 1912.

*Henry D. Dreyfus*  
City Engineer

This is to certify that the above plat of Camenzind Heights, the same being a subdivision of part of the NW 1/4 of SE 1/4 of Section 15-12-12, Township 12 North, Range 15 West, 12th Meridian, Nebraska, was approved by the City Plan Commission of the City of Omaha, Nebraska, on January 22, 1912, and that the same is hereby approved by me, Henry D. Dreyfus, City Engineer of the City of Omaha, Nebraska, on this 15th day of April, 1912.

Approved by the City Plan Commission of the City of Omaha, Nebraska, on January 22, 1912.

*Henry D. Dreyfus*  
City Engineer

Approved by the City Plan Commission of the City of Omaha, Nebraska, on January 22, 1912.

*Henry D. Dreyfus*  
City Engineer

State of Nebraska, ss  
County of Douglas) ss  
I, *Henry D. Dreyfus*, City Engineer of the City of Omaha, Nebraska, do hereby certify that the above plat of Camenzind Heights, the same being a subdivision of part of the NW 1/4 of SE 1/4 of Section 15-12-12, Township 12 North, Range 15 West, 12th Meridian, Nebraska, was approved by the City Plan Commission of the City of Omaha, Nebraska, on January 22, 1912, and that the same is hereby approved by me, Henry D. Dreyfus, City Engineer of the City of Omaha, Nebraska, on this 15th day of April, 1912.

Approved by the City Plan Commission of the City of Omaha, Nebraska, on January 22, 1912.

*Henry D. Dreyfus*  
City Engineer

Approved by the City Plan Commission of the City of Omaha, Nebraska, on January 22, 1912.

*Henry D. Dreyfus*  
City Engineer

Approved by the City Plan Commission of the City of Omaha, Nebraska, on January 22, 1912.

*Henry D. Dreyfus*  
City Engineer