

91-20193

ASSIGNMENT

KNOW ALL MEN BY THESE PRESENTS: That Nebraska Public Power District, a public corporation and political subdivision of the State of Nebraska, hereinafter called District, in consideration of the performance of the terms and conditions of an Agreement for Sale of Electric Facilities by Nebraska Public Power District to Omaha Public Power District, and the benefits to accrue to both parties set forth therein, the receipt whereof is hereby acknowledged, does hereby sell, assign, and transfer unto Omaha Public Power District, a public corporation and political subdivision of the State of Nebraska, and its successors and assigns, hereinafter called OPPD, all of the right, title and interest in and to the District's easements, together with all of the rights and privileges pertaining thereto, located within the area described as follows:

The Easements for approximately 4.0 miles of 115 KV transmission line, said easements which begin at Structure # 657 located in the W1/4 of Section 21, T14N, R13E in Sarpy County, Nebraska, and extend south and east through portions of Sections 21, 28, 27, 26, 25, 36 all in T14N, R13E ending at Structure # 29 west of the Kramer Substation. Specific interests in said easements are more fully described in the attached Exhibit "B". Said transmission line route is outlined on attached Exhibit "A".

To have and to hold said easement interests unto OPPD, its successors and assigns forever.

In witness whereof, the District has caused this Assignment to be executed by its duly authorized corporate officers this 2nd day of December, 1991.

ATTEST:

NEBRASKA PUBLIC POWER DISTRICT

[Signature]
Secretary

By *William A. Merrill*
Title Vice-President Operations *[Signature]*

STATE OF NEBRASKA }
COUNTY OF PLATTE } ss.

Before me, a notary public qualified in said county, personally came William A. Merrill, Vice President of Operations of Nebraska Public Power District, a corporation, known to me to be the officer and identical person who signed the foregoing instrument, and acknowledged the execution thereof to be his voluntary act and deed as such officer and the voluntary act and deed of said corporation and that its corporate seal was thereto affixed by its authority.

Witness my hand and notarial seal on Dec. 2, 1991.

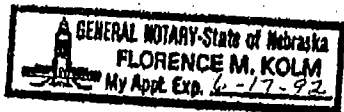

[Signature]
Notary Public

20193

250
1004
ckg.

91-20193A

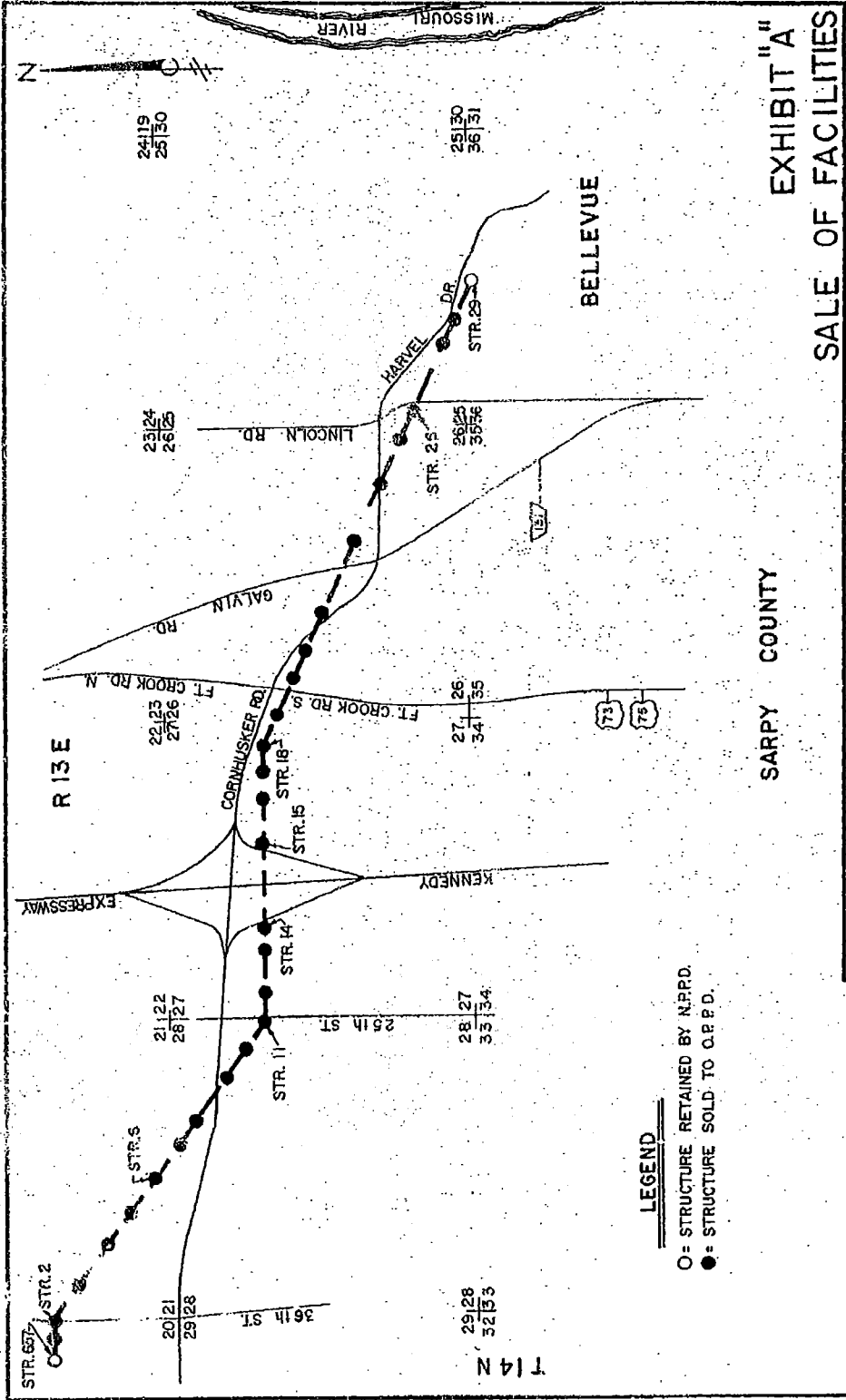

LEGEND
 O = STRUCTURE RETAINED BY N.R.P.D.
 ● = STRUCTURE SOLD TO O.P.P.D.

EXHIBIT "A"
SALE OF FACILITIES

SECURITY NUMBER GROUP	011580	7410		
FREMONT - KRAMER TL 1158 LINE SALE BETWEEN STR. 657 AND 29				
DRAWN	DATE	Nebraska Public Power District		
D.J.Y.	4-3-90	CHECKED	DATE	REVISION
		L.S.S.	4-11-90	
		APPROVED	DATE	
		2800	4-11-90	
		FILED	4-20-90	
				NA66480

NO.	REVISION
1	ADDED STR. 14 & 15
	B MODIFIED LEGEND
	D.J.Y. 4-11-90
	CRD. MAY
	FILED
	05-21-90

TRANSFER TO
 OMAHA PUBLIC POWER DISTRICT
 1991 RETIREMENT
 FREMONT-KRAMER 115KV
 FACILITY #011580
 P.O. 48348
 SARPY COUNTY

91-20193 B

Search Number	Owners Name	Location	Sec.	Twp.	Reg.	Acq. Pat.	Acq. Type	Record Info.	Date Signed	Grantee
21038-1132	O'Keefe, Elizabeth	SW $\frac{1}{4}$ SW $\frac{1}{4}$ NW $\frac{1}{4}$ SW $\frac{1}{4}$	21	14N	13E	\$300.00	Easement	470827, Misc. Book 13, Page 346	470418	LRPPD
21038-1136	Blue Ridge Land Company	SW $\frac{1}{4}$ SW $\frac{1}{4}$ NW $\frac{1}{4}$ SW $\frac{1}{4}$	21	14N	13E	\$1.00	Partial Release of Easement	620813, Misc. Book 30, Page 259	626725	LRPPD
21038-1142	Laduke, Laura	NE $\frac{1}{4}$ SW $\frac{1}{4}$ SE $\frac{1}{4}$ SW $\frac{1}{4}$	21	14N	13E	\$100.00	Easement	470827, Misc. Book 13, Page 345	470718	LRPPD
21038-1144	Rock Island Railroad	SE $\frac{1}{4}$ SW $\frac{1}{4}$ SW $\frac{1}{4}$ SW $\frac{1}{4}$	21	14N	13E		Permit			
21038-1145	Murphy Joseph F. Etc.	NE $\frac{1}{4}$ SW $\frac{1}{4}$ SE $\frac{1}{4}$ SW $\frac{1}{4}$ SW $\frac{1}{4}$ SW $\frac{1}{4}$ NW $\frac{1}{4}$ SE $\frac{1}{4}$	21	14N	13E	\$500.00	Condemnation	510915, Misc. Book 15, Page 63	510915	LRPPD
21038-1166	Weisinger, Earle W.	NW $\frac{1}{4}$ NE $\frac{1}{4}$	28	14N	13E	\$800.00	Condemnation	510915, Misc. Book 15, Page 63	510915	LRPPD
21038-1174	Strike, Charles O. Etc.	NW $\frac{1}{4}$ NE $\frac{1}{4}$	28	14N	13E	\$75.00	Easement	510911, Misc. Book 15, Page 56	510807	LRPPD
21038-1178	Weisinger, Raymond	NE $\frac{1}{4}$ NE $\frac{1}{4}$	28	14N	13E	\$350.00	Condemnation	510915, Misc. Book 15, Page 63	510915	LRPPD
21038-1184	Vandusen, Dana B.	SE $\frac{1}{4}$ NE $\frac{1}{4}$	28	14N	28E	\$1,050.00	Condemnation	510915, Misc. Book 15, Page 63	510915	LRPPD

91-20193C

Transfer to ORPD - 1991 Retirement
 Fresno-Kramer 11547 - Facility #011580
 H.O. 48345 - Siskiyou County

Search Number	Owners Name	Location	Sec.	Trp.	Eng.	Acq. Part.	Acq. Type	Record Info.	Date Signed	Grantee
21038-1189	Pratt, Willard Etc.	SW $\frac{1}{4}$	27	14N	13E	\$1,050.00	Condemnation	510915, Misc. Book 15, Page 63	510915	LRPPD
21038-1192	Meadow Green Co.	NW $\frac{1}{4}$	27	14N	13E		Quit-Claim	740208, Book of Deeds 149, Page 1008	740208	LRPPD
21038-1200	Hall Investment Co.	NE $\frac{1}{4}$	27	14N	13E	\$1,650.00	Condemnation	510915, Misc. Book 15, Page 63	510915	LRPPD
21038-1206	Union Pacific Railroad	SE $\frac{1}{4}$ NE $\frac{1}{4}$	27	14N	13E	\$5.00	Permit		530529	
21038-1211	Petersen, Michael P. Etc.	SE $\frac{1}{4}$ NE $\frac{1}{4}$	27	14N	13E	\$1,850.00	Condemnation	511013, Misc. Book 15, Page 81	510927	LRPPD
21038-1233	Petersen, Michael P. Etc.	SW $\frac{1}{4}$ NW $\frac{1}{4}$	26	14N	13E	\$1,850.00	Condemnation	511003, Misc. Book 15, Page 81	510927	LRPPD
21038-1250	Real Construction Co. Inc.	SW $\frac{1}{4}$ NW $\frac{1}{4}$	26	14N	13E		Partial Release of Easement	730522, Misc. Book 46, Page 275	730430	WRPD
21038-1253	Grobeck, Etc.	SW $\frac{1}{4}$	26	14N	13E	\$30.00	Passaway	471024, Misc. Book 13, Page 409	470925	
21038-1255	Petersen, Arthur P. Etc.	SE $\frac{1}{4}$	26	14N	13E	\$800.00	Condemnation	511003 Misc. Book 15, Page 81	510927	
21038-1281	Hansen, Chris Etc.	SW $\frac{1}{4}$ SE $\frac{1}{4}$ NW $\frac{1}{4}$ SE $\frac{1}{4}$	26	14N	13E	\$800.00	Condemnation	511003 Misc. Book 15, Page 81	510927	
21038-1294	Hansen, Chris Etc.	SW $\frac{1}{4}$ SW $\frac{1}{4}$	25	14N	13E	\$75.00	Condemnation	511003 Misc. Book 15, Page 81	510927	
21038-1307	Petersen, Michael P.	SE $\frac{1}{4}$ SW $\frac{1}{4}$ SW $\frac{1}{4}$ SE $\frac{1}{4}$ SW $\frac{1}{4}$ SE $\frac{1}{4}$ SW $\frac{1}{4}$ NE $\frac{1}{4}$ NW $\frac{1}{4}$ NE $\frac{1}{4}$ NW $\frac{1}{4}$	26	14N	13E	\$410.00	Condemnation	511003 Misc. Book 15, Page 81	510927	

91-20193 D

Transfer to OPD - 1981
Present-Kramer 115W - Seriality #01188
N.C. 48048 - Sarpy County

Search Number	Grantors Name	Location	Sec.	Twp.	Eng.	Acq. Pct.	Acq. Type	Record Info.	Date Signed	Grantee
21038-1325	St. Columban's Foreign Mission Society	SW 1/4	25	14N	13E	\$50.00	Easement	480716, Misc. Book 13, Page 648	471107	

FILED - SARPY CO. NE.
INSTRUMENT NUMBER
91-20193

91 DEC 18 AM 11:17

Carol A. Gavin
REGISTER OF DEEDS

Proof	_____
D.E.	_____
Verify	_____
Filmed	_____
Checked	_____
Fee \$	2800